

Aladdin Temp-Rite®

...better by degrees.

P.O. Box 2978, Hendersonville, TN 37077-2978
1-800-888-8018 or 615-537-3600
Fax 1-888-812-9956
www.aladdintemprite.com



ENCLOSED STAINLESS STEEL TRAY TRANSPORT CABINET

ET**PT Series



Manual P/N 99369
Rev. G 11/10/2014

INSTALLATION, OPERATION & SERVICE MANUAL

I. INTRODUCTION

Advanced Meal Systems from Aladdin Temp-Rite® offers two different enclosed stainless steel tray transport cabinets to suit your specific requirements. The enclosed design of these cabinets allows finished meals or soiled trays to be transported in a protected, enclosed environment. These versatile cabinets are designed to accommodate one tray per shelf per side. Cabinets are constructed of durable, sanitary stainless steel to provide years of trouble free service.

Standard Features:

- All stainless steel construction
- Side panels are recessed inside frame for added protection
- One continuous hinge for doors
- Durable and easy to clean
- All models have 6" balloon-type non-marking casters, 2 swivel with brake and 2 rigid
- Four corner non-marking bumpers
- Fabricated center assembly keeps hot food items and cold food items separated during transport.
- All models have full 270° door swing with a magnetic catch for the open position
- NSF listed

Available option:

Retractable Tow hitch (on 24 meal model ONLY)

Specifications:

Model:	ET24PT	ET30PT
Height	55.579" (141.2 cm)	73" (185.42 cm)
Width	30.875" (78.4 cm)	30.875" (78.4 cm)
Depth	34.10" (86.6 cm)	34.10" (86.6 cm)
Weight	225 lbs (102 kg)	253 lbs (145 kg)
Tray capacity (including bottom shelf)	24	30
Shelf spacing	3.5" (8.8 cm)	3.5" (8.8 cm)

II. RECEIVING INSPECTIONS

Your Aladdin enclosed stainless steel transport cabinet is factory tested for performance and is free from defects when shipped. The utmost care has been taken in packaging this product to protect against damage in transit.

You should carefully inspect your transport cabinet to assure that no damage has occurred in transit. If however, damage is detected see the following damaged goods policy. Under no condition may a damaged unit be returned to Aladdin Temp-Rite without first obtaining written permission (return authorization). No credit will be issued for claims not reported to Aladdin within ten (10) business days from receipt of shipment.

ALADDIN DAMAGED GOODS POLICY

There are two types of damaged merchandise:

- Visual Damage
- Concealed Damage

Visual Damage – When the product being received is visibly damaged.

1. Receiver should not accept merchandise with visual damage.
2. Receiver must sign delivery receipt “refused merchandise due to damage” and specify damage.
3. Receiver should call Aladdin Customer Service immediately after refusal.
4. Carrier will notify Aladdin Traffic Department and a claim will be filed.
5. Carrier will send acknowledgement of claim within 7 days after receiving.

Concealed Damage – When damaged merchandise cannot be externally detected.

Any receiving operation should be looking for this type of damage. Sometimes, however, depending on the type of product, it is almost impossible to notice.

1. Merchandise must not be removed from point of delivery and all packaging must be kept intact.
2. Receiver must contact Aladdin customer service to report damage.
3. Aladdin traffic department will request inspection based on the dollar value of the cargo.
4. Aladdin traffic department will file a claim based on the findings of the inspection.

Failure to comply with these policies will result in the customer’s responsibility to file claims.

III. SAFETY

In accordance with generally accepted product safety labeling guidelines the following three signal words are used throughout this manual to alert you to potential hazards and to tell you how to avoid them.

WARNING: The word "Warning" identifies a potentially hazardous situation which if not avoided COULD result in death or serious personal injury.

CAUTION: The word "Caution" identifies a potentially hazardous situation which if not avoided MAY result in minor or moderate injury. The word "Caution" may also be used to alert against unsafe practices and property damage only accidents.



"Important" is used to identify installation, operation or maintenance information which is important but not hazard related.

IV. OPERATION

- A. For best results, insert loaded trays into the cart as quickly as possible. Doors should be opened only when necessary in order to help keep foods at the proper temperature and prevent contamination of foods from outside sources.
- B. Avoid bumping carts into doors, walls or obstructions of any kind.
- C. Never move cart unless all doors are securely closed. Serious damage to hinges, latches and doors may result if bumped into walls or other equipment when doors are open.

V. CLEANING



CAUTION



Harsh chemicals and insufficiently diluted sanitizers will damage stainless steel surface. Never use cleaning agents that contain phosphates or chlorides. These chemicals will cause permanent damage to the stainless steel finish, and void equipment warranty. Do not use abrasive cleansers that will scratch the surface of the stainless steel.

The Aladdin Stainless Steel Tray Transport Cabinets should be sanitized and cleaned after each use using the following method:

1. Tray slide assemblies are easily removed, without tools, for cleaning; simply lift up the slide to release from attachment pins and pull off pins. The assemblies can now be pulled out of the door opening. The assemblies should be hand washed.
2. Wipe walls, handles, and sides with a soft clean cloth, using warm water and a mild detergent. (It is recommend that you wipe with the grain of the surface to avoid scratches.)
3. Use a soft nylon brush on any food buildup and in corners.
4. Sanitize with a properly diluted sanitizer (according to manufacturers recommendations).
5. Dry thoroughly with a dry cloth to remove moisture.
6. Never use sharp objects, abrasives or scrapers.
7. Do not wash cart in a pressurized wash system.

VI. MAINTENANCE / TROUBLESHOOTING

LATCHES

1. Lubricate latches regularly with WD-40, silicone spray, graphite or other commercial lubricants for stainless steel products. **DO NOT** use oil.

TROUBLE SHOOTING

Performance problems often result from minor incidents that can be found and corrected by checking and following the basic points mentioned in the table below.

SYMPTOM	PROBABLE CAUSE	CORRECTION
Cart hard to push/pull.	Debris in caster.	Remove debris.
Difficulty in opening/closing doors.	Hinges require lubrication.	Lubricate hinges.
Trays do not slide easily into cart.	Tray slides dirty. Tray slides not seated properly.	Remove slides and clean. Correct alignment of tray slides.
Latch "sticky" - does not operate smoothly.	Residue buildup.	Clean and lubricate latch.

VII. PARTS LIST / DRAWINGS

No.	Part #	Description
1	93052	Bumper, corner
2	97579	Caster, rigid, 6"
3	97581	Caster, swivel, w/brake 6"
4a	99360	ET24PT tray slide left & right
4b	99458	ET30PT tray slide left & right
5a	10637	Bolt 8/32 x 1"
5b	10635	Magnet square neodymium
5c	10636	Spacer nylon
5d	96689	Nut, 8-32 acorn SS
5*	99939	Magnetic catch Al
6*	12581	Latch gravity w/ handle
6b*♣	11495	SS handle
6c*♣	97225	Knob, door latch
7*	97222	Plate, striker (outside of door)
8	99365	Top arm
9	99366	Middle arm (shelves 2-11)
10	99362	Bottom brace
11a♥	10524	ET24PT Upper cross brace

No.	Part #	Description
11b	99363	ET24PT Upper cross brace
11c♥	10598	ET30PT Upper cross brace
11d	99456	ET30PT Upper cross brace
12a♥	10525	ET24PT Lower cross brace
12b	99364	ET24PT Lower cross brace
12c♥	10599	ET30PT Lower cross brace
12d	99458	ET30PT Lower cross brace
13*◇	99242	Tow hitch
14*	99368	Hitch retaining pin (tow hitch part)
15a*♣	99111	Magnet asy, door retention
15b*♣	99112	Plate,striker (inside of door)
16*	97224	Bumper, door
*Item Not Shown		
♥ for SN starting with ET**PTA11015		
♣ for units before SN ET**PTG13071		
♠ for units between SN ET**PTG13071 to ET**PTK14151		
◇24 Meal option		

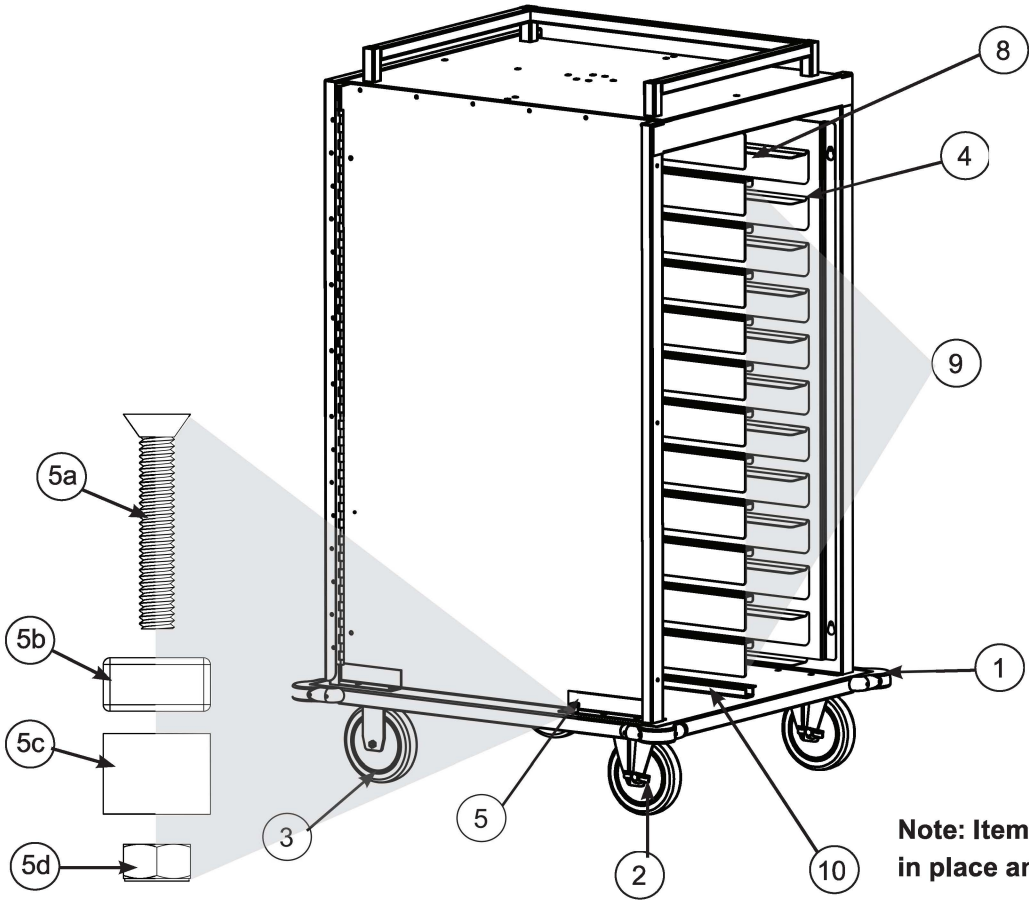

Note: Item 10, 11, 12 should be riveted in place and gaps sealed with silicon.

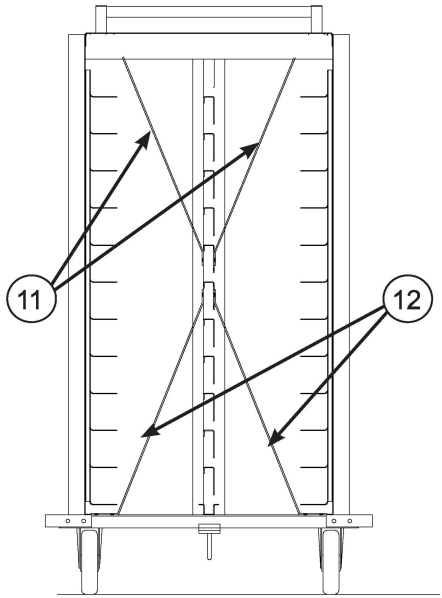

VIII. WARRANTY

ALADDIN TEMP-RITE
EQUIPMENT
LIMITED WARRANTY

Effective September, 2008

Aladdin Temp-Rite ("ATR") warrants to the original purchaser that the equipment listed below shall be free from defects in material and workmanship under normal use for the applicable warranty term set forth below. ATR's obligation under this warranty is limited to the repair or replacement, at the sole option of ATR, of any part which upon inspection and examination by ATR or its authorized agent is found to be defective. A written description detailing the nature of the claimed defect, together with the equipment claimed to be defective if required by ATR, must be delivered to ATR or its authorized agent within 30 days of discovery of the claimed defect (but in no event later than 30 days after the expiration of the applicable warranty term).

EQUIPMENT	WARRANTY TERM*	
	PARTS	LABOR
ET24PT	1 Year	90 DAYS
ET30PT	1 Year	90 DAYS

*The warranty term commences 30 days after the date of ATR's invoice for the equipment.

THE WARRANTIES AND REPRESENTATIONS OF ATR CONTAINED HEREIN ARE EXPRESSLY IN LIEU OF, AND THE BUYER WAIVES, ANY AND ALL OTHER WARRANTIES EXPRESS OR IMPLIED, INCLUDING THE WARRANTIES OF MERCHANTABILITY AND FITNESS FOR A PARTICULAR PURPOSE, AND ANY OTHER REMEDIES AGAINST ATR, WHETHER BASED UPON CONTRACT, NEGLIGENCE, STRICT LIABILITY OR OTHERWISE. ATR SHALL NOT BE LIABLE FOR ANY CONSEQUENTIAL OR INCIDENTAL DAMAGES OR ECONOMIC LOSS OF ANY NATURE (INCLUDING WITHOUT LIMITATION LOSS OF REVENUES AND/OR PROFITS) THAT MAY BE CLAIMED TO RESULT FROM ANY NEGLIGENCE OR BREACH OF WARRANTY OR CONTRACT BY ATR.

Exceptions and Exclusions

This warranty is issued only to the original purchaser, and is not transferable and applies only to the products installed within the United State of America, its territories and Canada. During the term of any labor warranty, ATR will pay all pre-approved shipping charges incurred in returning defective equipment to ATR and labor costs incurred in the removal and reinstallation of such equipment. Contact ATR before returning any defective equipment or otherwise performing any warranty repairs. ATR assumes no liability for any work or repair performed without its prior approval. After the expiration of any labor warranty, the original purchaser is responsible for all shipping charges incurred in returning defective equipment to ATR and labor for removing and reinstalling such equipment. ATR shall not be responsible for the replacement of expendable items like lamps and fuses or product failure resulting from normal wear and tear, improper installation, misuse, sabotage, abuse, neglect, accident, unauthorized alterations to repair, or other factors beyond the control of ATR. Neither this warranty, nor the liability of ATR may be modified or extended by action of any agent, distributor or other person or by custom or practice.

CALL ATR TOLL FREE AT 1-800-888-5426 IF YOU HAVE ANY QUESTIONS ABOUT THIS WARRANTY OR YOUR ATR PRODUCT.