

MBC80GR

REV 01.2025

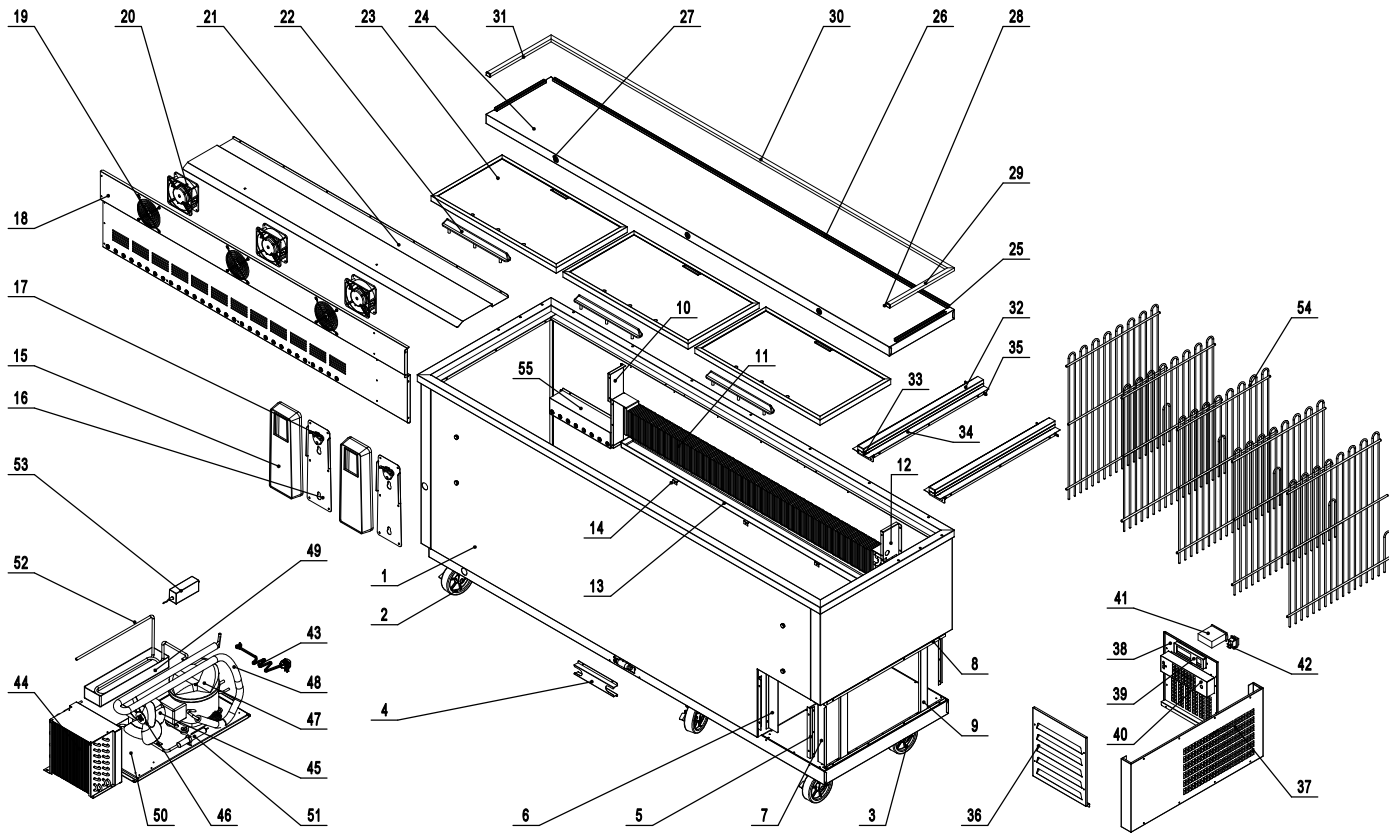

No.	Old Part #	New Part #	Part Name	Qty	No.	Old Part #	New Part #	Part Name	Qty
1	MBC00802060100	#N/A	Cabinet Assembly	1	20	W0301112	R03001000015	Evap Fan Motor	3
2	B0604434	R06001000016	2" M8 Stem Caster W/ Brake	3	21	MBC80-0141	#N/A	Cabinet Air Deflector	1
3	B0604433	R06001000015	2" M8 Stem Caster W/O Brake	3	22	W0401025	R04001000003	Handle	3
4	MKC58-0705	MKC0058106015430	Tee Drain Pipe Cover	1	23	01MBC8000-01+	#N/A	Sliding Lid	3
5	MBC50-0510	#N/A	Front Air Vent Frame Support	4	24	MBC80-0111	#N/A	Counter Top Assembly	1
6	MBC50-0513	#N/A	Condenser Air Baffle	1	25	W041000077	R04012000105	Short Plastic Trim Base	2
7	MBC50-0512	#N/A	Right Condenser Air Baffle	1	26	W041000125	R04012000143	Long Plastic Trim Base	1
8	MBC50-0508	#N/A	Right Air Vent Frame Support	2	27	W0604007	R06003000004	Lock&Key	3
9	MBC50-0509	#N/A	Unit Frame Support	2	28	W040900065	R04011000031	Plastic Trim Base End	2
10	MBC50-0602	#N/A	Evap Left Cover	1	29	W041000063	R04012000095	Right Short Plastic Trim	1
11	W0202063	R02002000022	Evaporator	1	30	W041000119	R04012000137	Long Plastic Trim	1
12	MBC50-0603	#N/A	Evap Right Cover	1	31	W041000062	R04012000094	Left Short Plastic Trim	1
13	W0411094	#N/A	Evap Drain Pan	1	32	MBC50-0133	#N/A	Middle Plastic Trim Top Cover	2
14	MBC50-0612	#N/A	Evap Front Cover Bracket	3	33	W041000069	#N/A	Middle Plastic Trim	2
15	W040900066	R04011000032	Bottle Opener Bracket Cover	2	34	MBC50-0132	#N/A	Plastic Sliding Part	6
16	MBC50-0609	MBC0050106013500	Bottle Opener Bracket	2	35	MBC50-0131	#N/A	Middle Trim Support	2
17	W0604117	R13999000015	Bottle Opener	2	36	MBC50-0502	MBC0050111001430	Front Air Vent Cover	1
18	MBC80-0601	#N/A	Evap Front Cover	1	37	MBC50-0503	MBC0050112001430	Unit Side Air Vent Cover	1
19	W0604065	R06005000008	Evap Fan Guard	3	38	MBC50-0504	MBC0050106008430	Back Air Vent Cover	1

No.	Old Part #	New Part #	Part Name	Qty
39	MBC50-0505	#N/A	Back Air Vent Controller Bracket	1
40	MKC58-0704	#N/A	Power Cord Box	1
41	W0302173	R03002000042	Digital Controller	1
42	W0308019	R03008000008	Power Switch	1
43	W0305134	R03005000012	Power Cord	1
44	W0203065	R02005000014	Condenser	1
45	W0301905-1	R03001000100	Condenser Fan Motor	1
46	W0301060	R03000000013	Condenser Fan Blade	1
47	W0201042	R02000000007	Compressor	1
48	W0210391	#N/A	Suction Tube	1
49	W0411208	EPF3462104015201	Condenser Drian Pan	1
50	MBC50-0501	#N/A	Condensing Unit Base Board	1
51	W0204100	R02014000002	Filter Drier	1
52	W0210390	#N/A	Condenser Coil	1
53	W0399116	R03024000004	Power Supply/Transformer	1
54	W0402360	R06004000021	Shelf	5
55	MBC80-0613	#N/A	Shelf Installation Box	1