

SECTION 3. PARTS INFORMATION

3-1. INTRODUCTION

This section lists the replaceable parts of Henny Penny Model CW-216 and CW-114 Display Counter Warmers.

3-2. GENUINE PARTS

Use only genuine Henny Penny parts in your cabinet. Using a part of lesser quality or substitute design may result in cabinet damage or personal injury.

3-3. HOW TO FIND PARTS

To find items you want to order from the Parts List, proceed as follows:

1. Referring to the illustration in this section, find the part item number of the part needed.
2. Find the item number in the parts list, which shows the Henny Penny part number, a description of the part, any model or usage limitations, and the quantity of parts used.

3-4. HOW TO ORDER

Once the parts you want to order have been found in the Parts List, write down the following information:

Example:

| | |
|-------------|-------------|
| Item number | 66 |
| Part number | 25183 |
| Description | Thermometer |

From the date plate list the following information:

Example:

| | |
|----------------|---------|
| Product number | CW216.0 |
| Serial number | 00155 |
| Phase | 3 |
| Voltage | 208 |

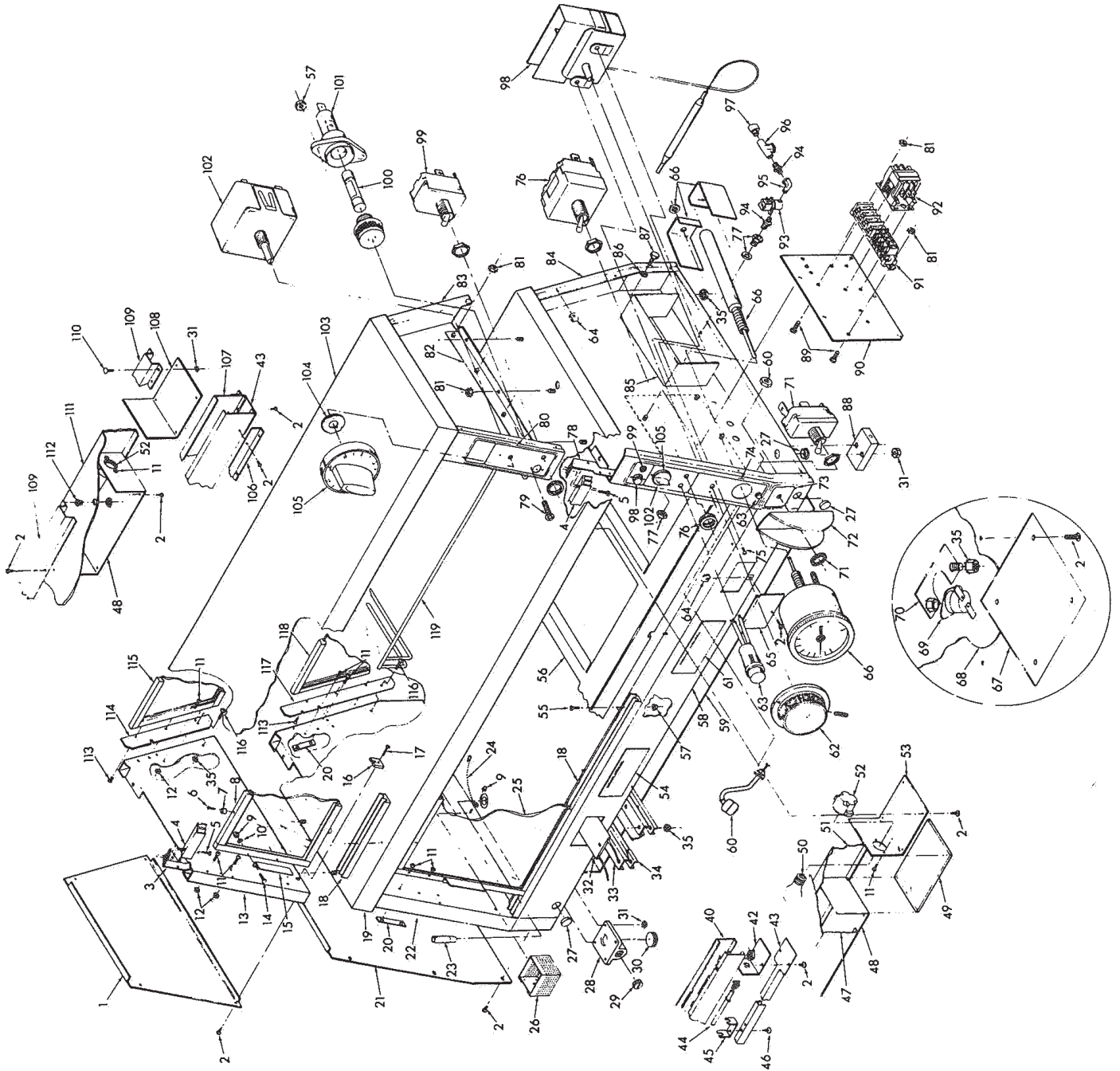

3-9. PARTS LIST

| Item No. | Part Number | Description | Qty. |
|----------|-------------|---|------|
| 1 | 22525 | Panel - Top End | 2 |
| 2 | SC02-023 | Screw #8-B x 3/8" PH Thd. | * |
| 3 | 23295 | Brkt. Weld Assembly - Right | 2 |
| 4 | 23555 | Track - Door Upper | 2 |
| 5 | SC01-034 | Screw - #8-32 x 3/8" PH Thd. S | * |
| 6 | SC04-001 | Screw - #6-32 x 3/8" PHD Type FC | * |
| 7 | 22225 | Door Glide | * |
| 8 | 22884 | Door Assembly - Top Sliding | 2 |
| 9 | NS03-016 | Nut #6-32 B Acorn | * |
| 10 | LW01-007 | Lockwasher - Split Ring #6 S | * |
| 11 | SC01-053 | Screw - #8-32 x 1/2" PH Rhd. S | * |
| 12 | NS02-007 | Nut - #8-32 Hex Keps C | * |
| 13 | 22889 | End Channel - Top (1-1/2) - SN: IY503JB & Above | 1 |
| 13 | 14403 | Kit - End Channel - Top (1-1/2) - SN: IY502JB & Below | 1 |
| 14 | SC01-082 | Screw - #6-32 x 5/8 Ph Thd. S | * |
| 15 | 23284 | Handle - Sliding Door | 4 |
| 16 | 22088 | Support Rack | 2 |
| 17 | SC01-075 | Screw - #10-32 x 3/4 PH Thd. | 2 |
| 18 | 23555 | Track - Sliding Door | 2 |
| 19 | 22599 | Middle Shelf Sub-Assembly | 1 |
| 20 | 22669 | Nutsert Brkt. Assembly | 4 |
| 21 | 22519 | Panel - End | 2 |
| 22 | 22887 | End Channel - Bottom (1-1/2)- SN: IY503JB & Above | 1 |
| 22 | 14401 | Kit - End Channel - Bottom (1-1/2)- SN: IY502JB & Below | 1 |
| √ 23 | 28071 | Tube - Overflow | 1 |
| 24 | 22802 | Retaining Chain Assembly | 1 |
| 25 | 22885 | Door Assembly - Bottom Sliding | 2 |
| 26 | 67852 | Screen Assembly | 1 |
| 27 | PL01-006 | Plug (1-1/8" dia.) | 3 |
| 28 | 22472 | Block - Drain | 1 |
| 29 | FP01-009 | Plug (3/4" pipe) - Brass | 1 |
| 30 | FP01-021 | Plug (1" pipe) | 1 |
| 31 | NS02-006 | Nut - #10-24 Hex Keps | * |
| √ 32 | 22648 | Strip Heater (230 volt, 1020 watt) - Specify | 2 |
| √ 32 | 22649 | Strip Heater (208 volt, 1020 watt) - Specify | 2 |
| 33 | 22430 | Clamp - Heater | 4 |
| 34 | 22429 | Brace - Heater Clamp | 4 |
| 35 | NS02-002 | Nut - 1/4-20 Hex Keps | * |
| 37 | SC02-023 | Screw #8-B x 3/8" PH Thd. | * |
| 40 | 22550 | Reflector - Heater Housing | 1 |
| 42 | 22536 | Cover - Terminal | 4 |

√ recommended parts

3-9. PARTS LIST (Continued)

| Item No. | Part Number | Description | Qty. |
|----------|-------------|--|------|
| 43 | 22578 | Deflector - Heater | 2 |
| √ 44 | 22644 | Heater - Radiant - Lower (230 volt, 1000 watt) - <i>Specify</i> | 1 |
| √ 44 | 22645 | Heater - Radiant - Lower (208 volt, 1000 watt) - <i>Specify</i> | 1 |
| √ 44 | 22646 | Heater - Radiant - Upper (230 volt, 400 watt) - <i>Specify</i> | 1 |
| √ 44 | 22647 | Heater - Radiant - Upper (208 volt, 400 watt) - <i>Specify</i> | 1 |
| 45 | 22629 | Bracket - Heater Support | 2 |
| 46 | SC02-016 | Screw #8-AB x 1/2" PH Phd. | * |
| 47 | 22548 | Ceiling Panel - Bottom | 1 |
| 48 | 22542 | Mounting Plate - Lamp Socket | 8 |
| 49 | 22679 | Glass | 12 |
| √ 50 | BL01-004 | Light Bulb - 120V-60 Watt | 12 |
| √ 50 | BL01-005 | Light Bulb - 240V-60 Watt - CE | 12 |
| 51 | 22546 | Side Plate - Light Box | 2 |
| √ 52 | 28294 | Socket - Light | 12 |
| √ 52 | 54041 | Socket - Light - CE | 12 |
| 53 | 22437 | Mounting Plate - Lamp Socket | 4 |
| 54 | 22617 | Plate - Cleaning Instruction | 1 |
| 55 | SC01-062 | Screw - #6-32 x 3/8 PH Fhd. | 6 |
| 56 | 22879 | Pan Support - Formed | * |
| 57 | NS02-005 | Nut #6-32 Hex Keps | 1 |
| 58 | 22551 | Stud Assy - Water Pan Base - (before 5/87) | 1 |
| 58 | 69699 | Assy - Water Pan Base w/o Sld Drs - CE | 1 |
| 58 | 70487 | Stud Assy - Water Pan w/ Sld Drs - CE | 1 |
| 58 | 14382 | Kit - Water Pan - (Dom - after 5/87; CE - SN: IR022JB and below) | 1 |
| 59 | 22590 | Cover - Wire | 1 |
| √ 60 | 14630 | Kit - Float Switch - SS | 1 |
| 61 | 22618 | Plate - Operating Instructions | 1 |
| 62 | 16731 | Knob - Dual Thermostat | 1 |
| √ 63 | 16624 | Light - Indicator - Red | 2 |
| √ 63 | 54085 | Light - Indicator - Green - CE | 2 |
| 64 | NS03-017 | Nut #8 U-type Chip | * |
| 65 | 22589 | Plate Access (Strip Heater) | 2 |
| √ 66 | 14250 | Thermometer | 1 |
| 67 | 22509 | Plate - Access (High Limit) | 1 |
| 68 | 22526 | Pan - Bottom | 1 |
| √ 69 | 22601 | Switch - High Limit | 1 |
| 70 | 22514 | Bracket - High Limit Clamp | 1 |
| √ 71 | 22673 | Switch - 3 position | 1 |
| 72 | 15302 | Guard - Switch | 1 |
| 73 | 22674 | Decal - Water Control Switch | 1 |
| 74 | 22602 | Decal - Bottom Control Decal | 1 |
| 75 | SC01-023 | Screw #6-32 x 1/4 PH Rhd. | 2 |
| √ 76 | 22604 | Switch Assembly - Power | 1 |
| 77 | FP01-013 | Bulkhead Adapter | 1 |
| 78 | 23294 | Bracket Weld Assembly Left | 2 |
| 79 | SC01-010 | Screw #6-32 x 1/4 PH Rhd. | 4 |
| 80 | 22612 | Decal - Top Control Panel | 1 |
| 81 | NS02-001 | Nut #10-32 Hex Keps | * |
| 82 | 22508 | Angle - Channel Mount (Upper) | 2 |

3-9. PARTS LIST (Continued)

| Item No. | Part Number | Description | Qty. |
|----------|-------------|---|------|
| 83 | 22891 | End Channel Assembly (3-1/2" top) - SN: IY503JB & Above | 1 |
| 83 | 14413 | Kit - End Channel Assembly (3-1/2" top) - SN: IY503JB & Below | 1 |
| 84 | 22886 | End Channel Assembly (3-1/2") - SN: IY503JB & Above | 1 |
| 84 | 14402 | Kit - End Channel Assembly (3-1/2") - SN: IY503JB & Below | 1 |
| 85 | 22667 | Guard - Splash | 1 |
| 86 | LW02-004 | Lockwasher (1/4" Ext.) | * |
| 87 | SC01-022 | Screw #1/4-20 x 3/4 | 8 |
| 88 | 22588 | Mounting Block | 1 |
| 89 | SC01-002 | Screw #10-32 x 1/2 PH Trn. | 2 |
| 90 | 66670 | Plate - Electric Component | 1 |
| 91 | 22607 | Terminal Block Assembly | 1 |
| √ 92 | 19405 | Contactor | 1 |
| √ 93 | 25147 | Valve - Solenoid (120 volt) | 1 |
| √ 93 | 25409 | Valve - Solenoid - 240V-60Hz & 220V-50Hz | 1 |
| √ 93 | 49461 | Valve - Solenoid - CE (SN: JA0703045 & BELOW) | 1 |
| √ 93 | 72117 | Valve - Solenoid - CE (SN: JA0703046 & ABOVE) | 1 |
| 94 | FP01-012 | Nipple - Reducing | 2 |
| 95 | FP01-014 | Elbow (1/8 " Brass) | 1 |
| √ 96 | 25208 | Strainer - Water | 1 |
| 97 | FP05-005 | Elbow (1/4" NPT to 1/4" NPT) | 1 |
| √ 98 | 64103 | Thermostat Control | 1 |
| √ 99 | 22198 | Switch - Power | 1 |
| √ 100 | EF02-007 | Fuse (15 amp.) (SN: JB0705002 & below) | 2 |
| √ 101 | EF02-006 | Fuse Holder (SN: JB0705002 & below) | 2 |
| √ 101 | EF02-125 | Breaker - Push Button Reset (SN: JB0705003 & above) | 2 |
| √ 102 | 23560 | Infinite Regulator (240 volt) | 2 |
| 103 | 22615 | Top Cap Assembly | 1 |
| 104 | EF02-011 | Nut - Infinite Regulator | 2 |
| 105 | 22046 | Knob - Infinite Switch | 2 |
| 106 | 22543 | Support Glass | 2 |
| 107 | 22549 | Heater Housing - Upper | 1 |
| 108 | 22539 | Plate Cover | 4 |
| 109 | 22544 | Hat Section | 2 |
| 110 | SC01-015 | Screw #10-24 x 1/2 Carriage | * |
| 111 | 22547 | Ceiling Panel - Top | 1 |
| 112 | EF01-011 | Nipple - Chase (3/8") | 8 |
| 113 | SC01-003 | Screw #6-32 x 3/8 Flat Hd. | 12 |
| 114 | 22876 | Plate - Top R.H. | 1 |
| 114 | 22877 | Plate - Top L.H. (not shown) | 1 |
| 115 | 22883 | Window Assembly - Top | 1 |
| 116 | SC01-059 | Screw #1/4-20 x 1/2 PH - Truss Hd. | 4 |
| 117 | 22875 | Bracket - Mounting Bottom R.H. | 1 |
| 117 | 22874 | Bracket - Mounting Bottom L.H. (not shown) | 1 |
| 118 | 22882 | Window Assembly Bottom | 1 |
| 119 | 22868 | Support - Pan Top | 1 |
| √ 120 | 34528 | Relay - Float Switch - 120v (not shown) | 1 |
| √ 120 | 30723 | Relay - Float Switch - 240v (not shown) | 1 |
| 121 | 14627 | Kit - Insul. End Channel - CW (not shown) | 1 |
| 122 | 67816 | Insul - Side 4.5 x 24 x 1 - CW End (not shown) | 1 |
| 123 | 67827 | Insul - Side 2.5 x 24 x 1 - CW End (not shown) | 1 |