

Operation Manual

Product Holding Bin
DHB JIB Series

Product Identification

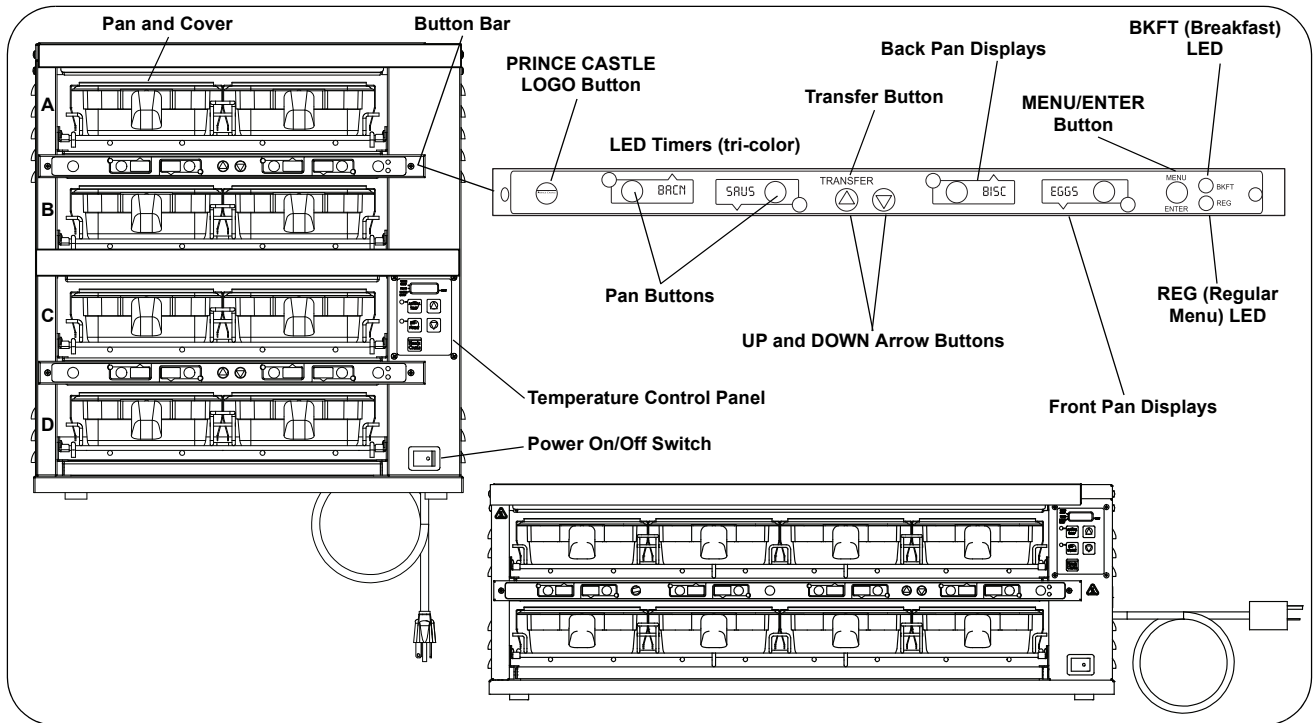

LIMITED WARRANTY

This product is warranted to be free from defects in material and/or workmanship for a period of one (1) year from date of original installation (with the exception of racks, pans, and covers). Any component which proves to be faulty in material and/or workmanship will be replaced or repaired (at the option of Prince Castle, Inc.) without cost to the customer for parts or labor. This warranty covers on location service (i.e. trip charges and/or mileage). Travel mileage is limited to 100 miles (200 kilometers -International) round trip (one trip warranty) from an authorized service agency or its sub-service agency.

This warranty is subject to the following exceptions/conditions:

- Use of any non-genuine Prince Castle parts voids this warranty.
- All labor shall be performed during regular work hours. Overtime premium will be charged to the buyer.
- Damage caused by carelessness, neglect, and/or abuse (e.g., dropping, tampering or altering parts, equipment damaged in shipment, by fire, flood or an act of God) is not covered under this warranty.

TABLE OF CONTENTS

Product Identification	1
Specifications	2
Safety Information	2
Installation	2
Operation	3
Cleaning	4
Programming	5 – 14
Troubleshooting	14
Exploded View and Parts List	15
Wiring Diagrams	16 – 19



PRINCE CASTLE LLC
WORLDWIDE

355 East Kehoe Blvd. • Carol Stream, IL 60188 USA
Telephone: 630-462-8800 • Toll Free: 1-800-PCASTLE
Fax: 630-462-1460 • www.princecastle.com

Specifications

Model	Voltage	Watts	Hertz
DHB2PT-18JB	120	1700	60
DHB4SS-20JB	120	1700	60
DHB2PT-33JB	208 – 240	2500	50/60
DHB2SS-33JB	208 – 240	2500	50/60
DHB4PT-20JB	120	1700	60

Safety Information



WARNING

Indicates information important to the proper operation of the unit. Failure to observe may result in damage to the equipment and/or severe bodily injury or death.



CAUTION

Indicates information important to the operation of the unit. Failure to observe may result in damage to the equipment.

Installation

- A. Remove the unit from the carton and inspect for signs of damage. If there is damage to the unit:
- notify the carrier within 24 hours of delivery
 - save carton and packaging materials for inspection purposes
 - contact your local dealer, or if purchased directly, the Prince Castle Sales Department at 800-722-7853 or 1-630-462-8800 to arrange for a replacement unit.

NOTE: When installing this unit, the ambient temperature at the mounting site should not exceed 100°F.

- B. Place the bin on a counter and seal the base to the counter with food-approved sealant.
- C. Plug the power cord into the bin and connect the plug into the proper electrical outlet (15 amp, 120 Volt). All connections must be in accordance with local electrical codes and any other applicable codes.

NOTE: The electrical receptacle should be a dedicated outlet. No other equipment should be operating on the line (refrigerators, fryers, etc.).

- D. Install the racks, pans and pan covers into the cavities.
- E. Turn the power switch to ON. Allow 30 minutes for warm-up.

Prince Castle reserves the right to change specifications and product design without notice. Such revisions do not entitle the buyer to corresponding changes, improvements, additions or replacements for previously purchased equipment.

Operation

1 Turn power On/Off switch to ON position.

Load pan covers (if used) onto pan racks and insert racks into the unit.

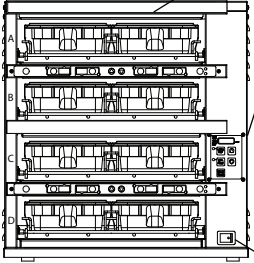

Allow **30 minutes** for heaters to reach operating temperature. The Temperature Display will show temperature as unit warms up to the operating temperature.

Power On/Off Switch

2 Press all PAN buttons (if applicable).



The PAN DISPLAYS will show the assigned product name.

BKFT (Breakfast) or REG (Regular Menu) will be lit depending on pre-programmed menu.

If no product is assigned, the display will be dim and show "----". Pressing the PAN button will not activate the timer if "----" is displayed. Pressing PAN button when product name is displayed will start timing cycle.

3 LED Timing Status



LED Timers

- RED** (flashing) = Discard product
- GREEN** (steady) = Oldest product, use first
- GREEN** (flashing) = Cook more product
- YELLOW** (steady) = Newer product, use green first
- YELLOW** (flashing) = Cook more product

4 To begin timing cycle, load product and press the PAN button.

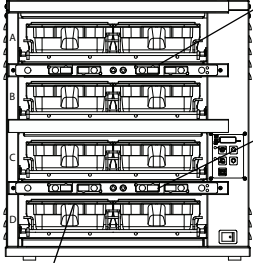

If no other pan is active for a product, the LED for the first pan loaded will turn **GREEN**.

The LED for the 2nd pan (3rd pan, etc.) loaded will turn **YELLOW**.

An LED timer can be stopped (cancelled) at any time by pressing and releasing the corresponding PAN button.

If only one pan is active for a product, the LED will turn **GREEN**.

Operation (continued)

5 When any of the timer LEDs flash, cook more product or remove and discard product as indicated.

GREEN Flashing = Cook more product

YELLOW Flashing = Cook more product

RED Flashing = Discard product



WARNING

Hot surfaces.

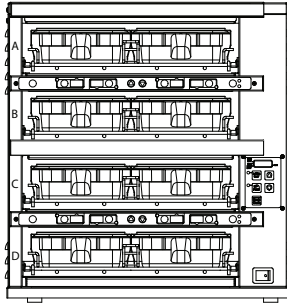

6 Product, along with any remaining time, can be transferred from one cavity to another as follows:

A. Press and release the **TRANSFER** button on the timer bar of the product to be moved. Displays for all pans available for transfer will be brightly lit. All others will be dimly lit.

C. Press and release the **TRANSFER** button on the bar where the product will be moved. All available pan locations on the bar will be brightly lit.

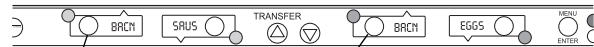

B. Press and release the **PAN** button of the product to be moved.

D. Press and release the **PAN** button for the new location. The new location will finish timing the product. When the transferred pan time expires, the location will revert back to the original menu settings.

NOTE: If product transfer is not completed within a pre-programmed transfer time, the transfer will be cancelled. See your Manager.

7 To shut down the unit, turn the power On/Off switch to OFF.

NOTE: To load preset times/menus:

- Turn power switch to OFF.
- Press and hold both the UP and DOWN Arrow buttons.
- Turn power switch ON.
- When the four right-most displays show PRESET LOADED, release the buttons.

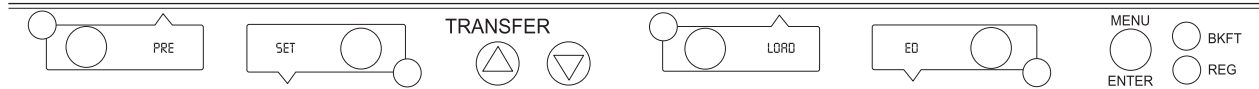

Cleaning



WARNING

Before performing any maintenance, turn the power switch to the **OFF** position and unplug the power cord from the electrical receptacle.



CAUTION

This unit is not watertight. Do not clean with a water jet/jet spray. Do not immerse the unit in water.

- Turn the unit off and unplug the power cord from the electrical receptacle.
- Remove the pan covers and pan racks. Wipe all parts and unit with a damp cloth. **DO NOT** use a green Scotch Bright pad cleaner, ice or water.

Setting the Temperature

- The unit has four shelves, each with an upper and lower heater (eight heaters total).
The factory pre-set for the upper heaters is 325°F.
The factory pre-set for the lower heaters is 225°F.
Each upper heater has a programmable range of 150° – 325°F.
Each lower heater has a programmable range of 150° – 225°F.
Use the control below and the following steps to set the setpoint temperatures for each heater.

UPPER HEATER LED
This LED will be lit to indicate upper shelf is selected.

PROG LED
This LED will be lit to indicate unit is in Program Mode.

LOWER HEATER LED
This LED will be lit to indicate lower shelf is selected.

ACTUAL TEMP BUTTON and LED
Press to display actual temperature for the selected heater. LED will be lit when actual temperature is displayed.

SETPOINT BUTTON and LED
Press to display setpoint temperature of a selected heater. LED will be lit when setpoint temperature is displayed.

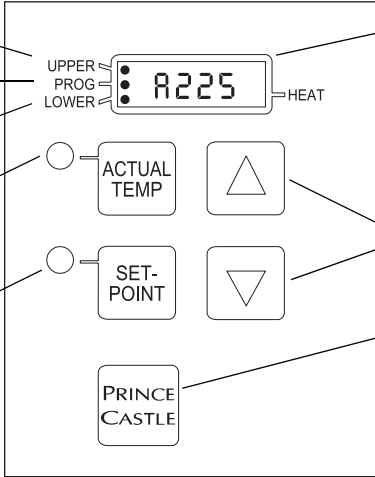

TEMPERATURE DISPLAY
A, b, C or d Shelf

NOTE: The unit is preset to display temperature in Fahrenheit. To display in Celsius, press and hold the DOWN Arrow button immediately after turning on the power switch. To switch back to Fahrenheit, press and hold the UP Arrow button after turning on the power switch.

UP/DOWN ARROW BUTTONS
Used with other buttons to scroll through heater and temperature selections.

PRINCE CASTLE LOGO BUTTON
Press to enter temperature selections.

CAUTION
DISPLAYED TEMPERATURES
ARE HEATER TEMPERATURES
AND DO NOT INDICATE ACTUAL
FOOD TEMPERATURES.

NOTE: To reset all times and temperatures to the factory settings, turn the unit off, then press and hold the UP and DOWN Arrow buttons simultaneously while turning the unit back on. A "P" will appear in the display and all times and temperatures will be reset to original factory settings.

- Press the UP or DOWN Arrow button until the desired shelf (A, b, C or d) LED and upper or lower heater is selected.

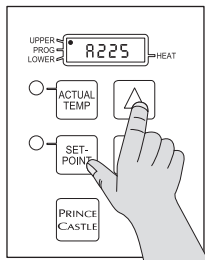

- Press and hold the SETPOINT button and the PRINCE CASTLE LOGO button for 5 seconds. The Program LED will light.

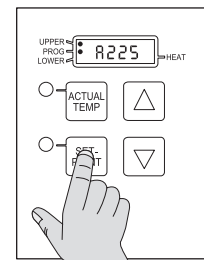

- Press the UP or DOWN Arrow button until the desired setpoint temperature is displayed.

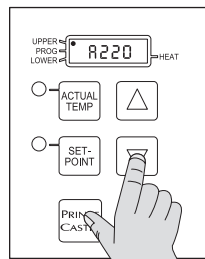

- Press the PRINCE CASTLE LOGO button to save the new setpoint value. Repeat Steps 2 – 5 to change the setpoint for any other heater.

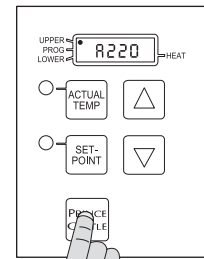

Calibrating Heaters

- 1** Use the following steps to calibrate the individual heaters.

NOTE: Allow sufficient amount of time for temperatures to stabilize before starting calibration.

Press the UP or DOWN Arrow button until the desired heater LED and shelf is selected.

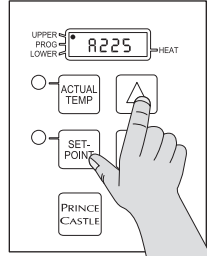

- 2** Take a temperature reading within the shelf near the center of the heater surface.

Use a stand-alone temperature meter (not supplied).



WARNING

Hot surfaces. Use caution when taking temperature readings within the shelf.

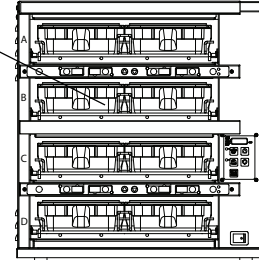

- 3** A. Press and hold the PRINCE CASTLE LOGO and ACTUAL TEMP buttons for 5 seconds. The colon (:) LED indicator will light. The temp displayed is the actual heater temperature sensed by the controller.
B. To clear any offset readings, press the SETPOINT button.

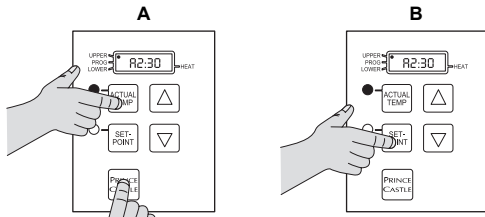

- 4** A. Press the UP or DOWN Arrow button until the temperature displayed matches the reading obtained in Step 2.
B. Press the PRINCE CASTLE LOGO button to save the temperature value and exit the Calibration Mode.

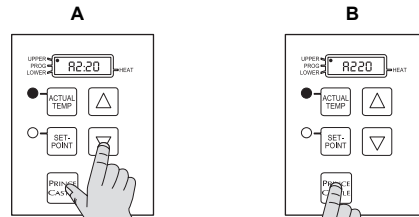

Selecting Breakfast and Regular Menus

- 1** There are six menus available:
BKFT LED ON = Menu1 or Menu6
REG LED ON = Regular2, Regular3, Regular4, or Regular5
Press and hold the MENU/ENTER button, then use the UP or DOWN Arrow button to scroll through the 6 menus.

When scrolling, menu numbers appear in this display.

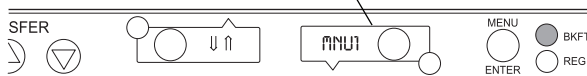

- 2** When the desired menu is displayed, release the MENU/ENTER button. The food products for the menu will be displayed in the upper and lower PAN displays.

When timers for a different menu are still active, those BKFT or REG LEDs will flash until they are all cancelled.

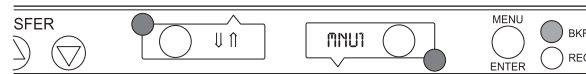

Programming the Menus

- 1** Press and hold the PRINCE CASTLE LOGO button (on the button bar) until all the displays show PROG.



- 2** Press and hold the MENU/ENTER button. The display next to the MENU/ENTER button will show the menu choices. Use the UP or DOWN Arrow button to scroll through the 6 menus. Release the MENU/ENTER button when the desired menu is displayed.

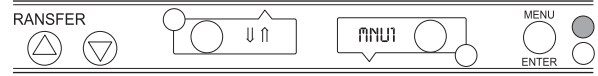

When the MENU/ENTER button is released, all displays will again show PROG.



- 3** A. Press the PAN button next to the display to be changed. The LED will turn YELLOW and the display will change from PROG to the assigned product choice.



- B. Press the UP or DOWN Arrow button to scroll to the desired product choice.
C. Press the MENU/ENTER button to save the selection. All displays will show PROG.



- 4** A. Repeat Steps 2 and 3 as required.
B. Press the PRINCE CASTLE LOGO button to exit the Program Mode and return to the Run Mode.

NOTE: Up to six items (one for each menu) may be programmed for each PAN button. A pan may be set as "not used" by assigning "----" as its product.



Changing the Hold and Cook-More Times

- 1** A. The SET PRODUCT TIME menu is used to change the Hold and Cook-More times.
B. Press and hold the PRINCE CASTLE LOGO button, then immediately press and hold the MENU/ENTER button until the display shows one of the programming menus.
C. Use the UP or DOWN Arrow button to scroll to the PROD TIME ↑ ↓ ENTR menu. (*NOTE: Units with 6 or 8 Pan displays will show SET PRODUCT TIME ↑ ↓ ENTR.*)

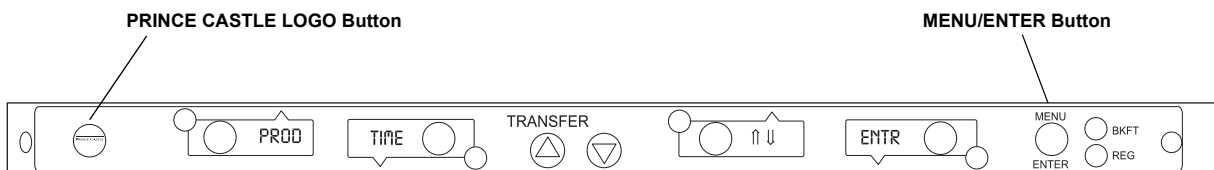

Changing the Hold and Cook-More Times (continued)

- 2** A. Press and release the MENU/ENTER button to enter the Set Product Time menu. The display will show, for example, EGGS TIME ↑↑ ENTR.
- B. Use the UP or DOWN Arrow button to scroll through the list of products. When the desired product is displayed, press the MENU/ENTER button to select it.

Refer to the Product Menu Details on page 11 for a list of products and their corresponding display names.



NOTE: Holding the UP or DOWN Arrow button for longer than 2 seconds will cause the product list to automatically scroll up or down.

- 3** A. The display now shows the current Hold time.



- B. Use the UP or DOWN Arrow button to scroll to the desired Hold time. When the desired Hold time is displayed, press the MENU/ENTER button to save the desired Hold time.



NOTE: Hold time cannot be reduced to less than the Cook-More time plus one minute.

- 4** A. The display will now show current Cook-More time. Use the UP or DOWN Arrow button to scroll to the desired Cook-More time.



- B. When the desired Cook-More time is displayed, press the MENU/ENTER button to save it.



NOTE: Cook-More time cannot be increased to more than the Hold time minus one minute.

- 5** A. The display will show PROD TIME ↑↓ ENTR. Repeat Steps 2 – 4 for any other product.

- B. Press and release the PRINCE CASTLE LOGO button at any time to exit the Program Mode and return to the Run Mode.

NOTE: If the MENU/ENTER button has not been pressed to save any changes, the program will revert to the original values.



Setting the Alternating Display Interval

- A. The Alternating Display Interval allows the timer bar displays to alternate between the product name and remaining Hold time. The default setting is 5 seconds.
- B. Press and hold the PRINCE CASTLE LOGO button, then immediately press and hold the MENU/ENTER button until the display shows one of the programming menus.
- C. Use the UP or DOWN Arrow button to scroll to the DISP ALT TIME menu. Press MENU/ENTER button.
- D. Use the UP and DOWN Arrow buttons to adjust the interval setting from 0 to 15 seconds. Press MENU/ENTER to save the change.
- E. Press and hold the PRINCE CASTLE LOGO button at any time to exit the Program Mode.

PRINCE CASTLE LOGO Button

MENU/ENTER Button



Changing Product Names

- 1** A. The EDIT PRODUCT NAME menu is used to change a default product name to one of your own choosing.
 B. Press and hold the PRINCE CASTLE LOGO button, then immediately press and hold the MENU/ENTER button until the display shows one of four programming menus.
 C. Use the UP or DOWN Arrow button to scroll to the PROD NAME ↑ ↓ ENTR menu.
NOTE: The default names available for editing are listed on page 11.

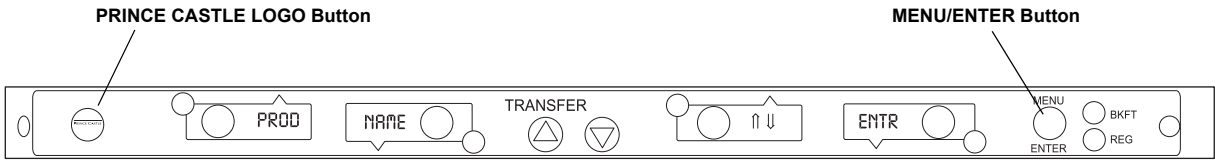

- 2** A. Press and release the MENU/ENTER button to enter the Edit Product Name menu.
 The display will read PROD XXXX ↑ ↓ ENTR.
 B. Use the UP or DOWN Arrow button to scroll through the list of products.
 C. When the desired product is displayed, press the MENU/ENTER button to select it. The first letter (in this case, the E) will start blinking.



- 3** A. To change the blinking E, use the UP or DOWN Arrow button to scroll to the desired letter/number/symbol.
 B. When the desired selection is displayed, press the PAN button (to the left or right of the selected display) to move to the next digit.
 C. Repeat for all digits.



NOTE: Holding the UP or DOWN Arrow button for longer than 2 seconds will cause the selected digit to automatically scroll up or down.

- 4** When all four digits have been changed, press the MENU/ENTER button to save the new name.



- 5** A. The display will show PROD NAME ↑ ↓ ENTR. Repeat Steps 2 – 4 for any other product.
 B. Press and release the PRINCE CASTLE LOGO button at any time to exit the Program Mode and return to the Run Mode.
NOTE: If the MENU/ENTER button has not been pressed to save any changes, the program will revert to the original names.



Set Maximum Transfer Time

- 1** A. The Set Maximum Transfer Time menu is used to set the amount of time allowed to make a product transfer from one pan to another.
- B. Press and hold the PRINCE CASTLE LOGO button, then immediately press and hold the MENU/ENTER button until the display shows one of the programming menus.
- C. Use the UP or DOWN Arrow button to scroll to the XFR TIME ↑ ↓ ENTR menu. (*NOTE: Units with 6 or 8 pan displays will show MAX XFR TIME ↑ ↓ ENTR.*)

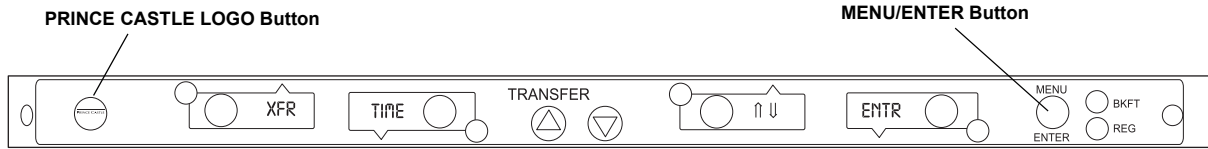

- 2** A. Press and release the MENU/ENTER button to enter the Set Maximum Transfer Time menu.
- B. The display shows XFR :20 ↑ ↓ ENTR. This shows a value of 20 seconds.



- 3** A. To change the time, use the UP or DOWN Arrow button to scroll to the desired time. When the desired selection is displayed, press the MENU/ENTER button to enter the selection.
 - B. Press and release the PRINCE CASTLE LOGO button at any time to exit the Program Mode and return to the Run Mode.
- NOTE: If the MENU/ENTER button has not been pressed to save any changes, the program will revert to the original time.*

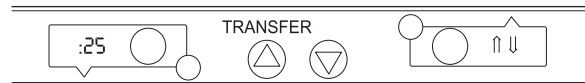

Set Volume Level

- 1** A. The default setting for the volume level is OFF.
- B. Press and hold the PRINCE CASTLE LOGO button, then immediately press and hold the MENU/ENTER button until the display shows one of the programming menus.
- C. Use the UP or DOWN Arrow button to scroll to the Set Vol 0 ↑ ↓ ENTR menu.

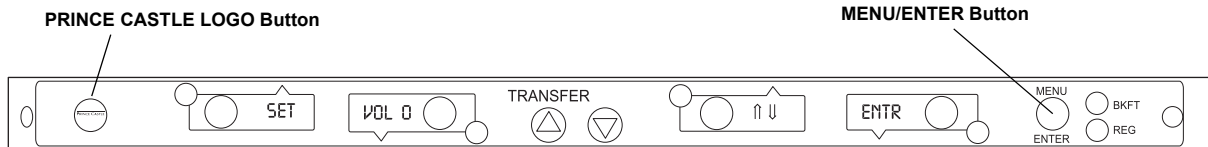

- 2** A. Press and release the MENU/ENTER button to enter the Set Volume menu.
 - B. The display shows SET VOL 0 ↑ ↓ ENTR. This shows that the volume is currently turned off.
- The volume may be set for Vol 0 (off) or for volume levels Vol 1 through Vol 3.

- 3** A. To change the volume level, use the UP or DOWN Arrow button to scroll to the desired level. When the desired selection is displayed, press the MENU/ENTER button.
 - B. Press and release the PRINCE CASTLE LOGO button at any time to exit the Program Mode and return to the Run Mode.
- NOTE: If the MENU/ENTER button has not been pressed to save any changes, the program will revert to the original time.*

Set Bar Position

- 1** To check the timer position on the main bar, press and hold the PRINCE CASTLE LOGO button and the DOWN Arrow button. The current timer bar position will be displayed in the far right timer display as POS X.

NOTE: X = the setting.

To change the timer bar position, proceed to Step 2.

To check the timer position on the aux bar press and hold the logo only.

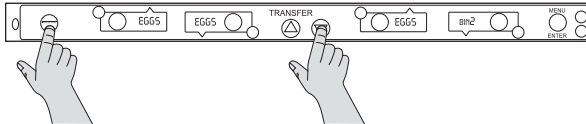

- 2** To change the main timer bar position, press and hold the PRINCE CASTLE LOGO button and the DOWN Arrow button for approximately 6 seconds or until the display shows POSN 1 ↓ ENTR POS X.

The address number will blink on/off.

NOTE: X = current bar position setting. SET will not show on the 4 channel bar.

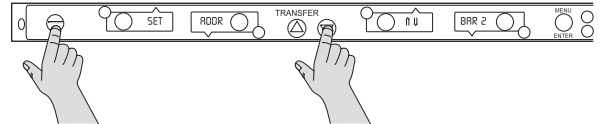

- 3** Use the UP or DOWN Arrow button to scroll to the desired position. The right most display shows the position letter to be selected. Press the MENU/ENTER button to store the new position and return to normal Operating Mode.

NOTE: The position choices for 2 cavity bins are A and B. The position choices for 4 cavity bins are A through F.

If the bin has a corresponding aux timer bar on the back, the aux bar will automatically update itself to match the position selection of its main bar.

NOTE: To cancel at any time with saving changes, press the LOGO button.

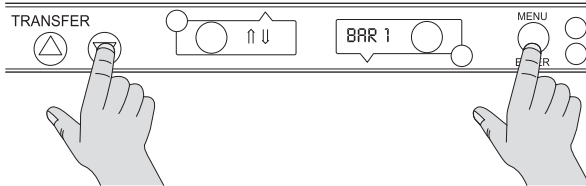

- 4** To check the current position setting on the main timer bar without making a change, press and hold the LOGO and the DOWN buttons simultaneously. On the aux timer bar, press and hold the LOGO button only.

One of the displays will show POS X to indicate the current position setting, where X is the setting.

Product Menu Details

Product	Display Name ²	Hold — Minutes ¹	Cook More — Minutes ¹
Regular	REGU	8	0
Jumbo	JMBO	8	0
Premium	PREM	8	0
Eggs	EGGS	8	0
Sausage	SAUS	30	0
Onions	ONIO	30	0
Fajita	FAJI	30	0
Chicken	CHIC	30	0
Bacon	BACN	30	0
Ham	HAM	30	0
Spicy Chicken	SPCY	30	0
Crispy Chicken	CRSP	30	0
Chicken Strips	STRP	30	0
Special 1	SPC1	30	0
Special 2	SPC2	30	0

Product	Display Name ²	Hold — Minutes ¹	Cook More — Minutes ¹
Special 3	SPC3	30	0
Special 4	SPC4	30	0
Special 5	SPC5	30	0
Special 6	SPC6	30	0
Special 7	SPC7	30	0
Special 8	SPC8	30	0
Special 9	SPC9	30	0
Special A	SPCA	30	0
Special B	SPCB	30	0
Special C	SPCC	30	0

- 1) Hold and Cook-More times may be reprogrammed — see instructions.
- 2) Product abbreviations may be reprogrammed — see instructions.
- 3) Sound enabled.

Menus

DHB4SS-20JB

Position A, Address 1

Main	Timer	4	3	2	1
Aux	Timer	3	4	1	2
MNU1	*Bkft	EGGS	EGGS	EGGS	EGGS
MNU2	Reg	JMBO	JMBO	JMBO	JMBO
MNU3	Reg	JMBO	JMBO	JMBO	JMBO
MNU4	Reg	JMBO	JMBO	JMBO	JMBO
MNU5	Reg	JMBO	JMBO	JMBO	JMBO
MNU6	Bkft	EGGS	EGGS	EGGS	EGGS

Position B, Address 2

Main	Timer	4	3	2	1
Aux	Timer	3	4	1	2
MNU1	*Bkft	EGGS	EGGS	EGGS	EGGS
MNU2	Reg	REGU	REGU	REGU	REGU
MNU3	Reg	REGU	REGU	REGU	REGU
MNU4	Reg	REGU	REGU	REGU	REGU
MNU5	Reg	REGU	REGU	REGU	REGU
MNU6	Bkft	EGGS	EGGS	EGGS	EGGS

Position C, Address 3

Main	Timer	4	3	2	1
Aux	Timer	3	4	1	2
MNU1	*Bkft	SAUS	SAUS	SAUS	SAUS
MNU2	Reg	PREM	PREM	PREM	PREM
MNU3	Reg	PREM	PREM	PREM	PREM
MNU4	Reg	PREM	PREM	PREM	PREM
MNU5	Reg	PREM	PREM	PREM	PREM
MNU6	Bkft	SAUS	SAUS	SAUS	SAUS

Position D, Address 4

Main	Timer	4	3	2	1
Aux	Timer	3	4	1	2
MNU1	*Bkft	JMBO	JMBO	JMBO	JMBO
MNU2	Reg	EGGS	EGGS	SAUS	SAUS
MNU3	Reg	EGGS	EGGS	SAUS	SAUS
MNU4	Reg	EGGS	EGGS	SAUS	SAUS
MNU5	Reg	EGGS	EGGS	SAUS	SAUS
MNU6	Bkft	JMBO	JMBO	JMBO	JMBO

DHB2PT-18JB

Position E, Address 5

Main	Timer	4	3	2	1
Aux	Timer	3	4	1	2
MNU1	*Bkft	SPCY	SPCY	CRSP	CRSP
MNU2	Reg	SPCY	SPCY	CRSP	CRSP
MNU3	Reg	SPCY	SPCY	CRSP	CRSP
MNU4	Reg	SPCY	SPCY	CRSP	CRSP
MNU5	Reg	SPCY	SPCY	CRSP	CRSP
MNU6	Bkft	SPCY	SPCY	CRSP	CRSP

Position F, Address 6

Main	Timer	4	3	2	1
Aux	Timer	3	4	1	2
MNU1	*Bkft	SPCY	SPCY	CRSP	CRSP
MNU2	Reg	SPCY	SPCY	CRSP	CRSP
MNU3	Reg	SPCY	SPCY	CRSP	CRSP
MNU4	Reg	SPCY	SPCY	CRSP	CRSP
MNU5	Reg	SPCY	SPCY	CRSP	CRSP
MNU6	Bkft	SPCY	SPCY	CRSP	CRSP

DHB2PT-33JB

Position A, Address 1

Main	Timer	8	7	6	5	4	3	2	1
Aux	Timer	7	8	5	6	3	4	1	2
MNU1	*Bkft	EGGS	EGGS	EGGS	EGGS	EGGS	EGGS	EGGS	EGGS
MNU2	Reg	JMBO	JMBO	JMBO	JMBO	JMBO	JMBO	JMBO	JMBO
MNU3	Reg	JMBO	JMBO	JMBO	JMBO	JMBO	JMBO	JMBO	JMBO
MNU4	Reg	JMBO	JMBO	JMBO	JMBO	JMBO	JMBO	JMBO	JMBO
MNU5	Reg	JMBO	JMBO	JMBO	JMBO	JMBO	JMBO	JMBO	JMBO
MNU6	Bkft	EGGS	EGGS	EGGS	EGGS	EGGS	EGGS	EGGS	EGGS

Position B, Address 2

Main	Timer	8	7	6	5	4	3	2	1
Aux	Timer	7	8	5	6	3	4	1	2
MNU1	*Bkft	SAUS	SAUS	SAUS	SAUS	JMBO	JMBO	REGU	REGU
MNU2	Reg	PREM	PREM	PREM	PREM	REGU	REGU	EGGS	EGGS
MNU3	Reg	PREM	PREM	PREM	PREM	REGU	REGU	EGGS	EGGS
MNU4	Reg	PREM	PREM	PREM	PREM	REGU	REGU	EGGS	EGGS
MNU5	Reg	PREM	PREM	PREM	PREM	REGU	REGU	EGGS	EGGS
MNU6	Bkft	SAUS	SAUS	SAUS	SAUS	JMBO	JMBO	REGU	REGU

Timer Bar Positions on Bins

DHB4SS-20JB
Four cavity bin with four 4-channel timer bars:

Timer Bar Position A, Address 1

Timer Bar Position B, Address 2

Timer Bar Position C, Address 3

Timer Bar Position D, Address 4

DHB2PT-33JB
Two cavity bin with two 8-channel timer bars:

Timer Bar Position A, Address 1

Timer Bar Position B, Address 2

DHB2PT-18JB
Two cavity bin with two 4-channel timer bars:

Timer Bar Position E Address 5

Timer Bar Position F, Address 6

Bar Address

To check the bar address on the main timer bar, press and hold the LOGO button and the DOWN Arrow simultaneously. On the aux bar press and hold the LOGO only button. The bar address is shown as BARY as on other bars where y is the address.

The Timer Bar address is automatically set when the Bar Position is selected as follows:

Position	Address Default
A	1
B	2
C	3
D	4
E	5
F	6

The address can be changed at power on as on other bars, but loading presets will change the address back to the default in the list above. Loading presets will not change the selected position.

Special Programming Mode

- 1** A. Press and hold the PRINCE CASTLE LOGO button then immediately press and hold the MENU/ENTER button. Hold both buttons for six seconds. The displays will change to show the first menu — depending on model.
B. Press and release the UP and DOWN buttons to scroll through the list of Special Modes.

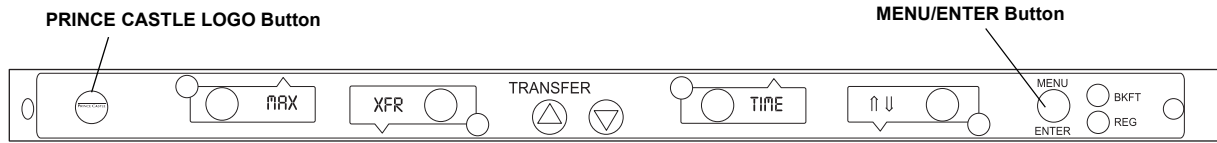

- 2 Set Link Group**
NOTE: Preset link group is set to GRP1 from factory.
- A. When the displays show SET LINK GRPx ↑ ↓ ENTR, the X indicates the currently assigned Link Group. Press and release the MENU/ENTER button to set the Link Group Mode.
B. The link group number (X) will flash. Press and release the UP or DOWN Arrow button to change the group number. The maximum number allowed is 3, and the minimum is 0. When a Timer Bar is assigned to Link Group 0, it is isolated and not associated with any other Timer Bar (linking is disabled).
C. When the desired link group is displayed, press and release the MENU/ENTER button to save it. The program will revert to Set Link Group Mode.



Troubleshooting

PROBLEM	PROBABLE CAUSE	SOLUTION
Display flashes Opn and rEL.	Open relay. Circuit inoperable.	Consult an authorized Service Technician.
Display flashes SHr and rEL.	Shorted relay. Circuit inoperable. Open heater. Unplugged ribbon cable between power and main circuit boards.	Consult an authorized Service Technician.
Display flashes Opn and rEL.	Temperature is below 75°F. Heater inoperable. Probe inoperable. Relay inoperable.	Consult an authorized Service Technician.
Display shows HHH for an extended period of time and heater surface temperature is hot.	Temperature is above 300°F (abnormal operation).	Consult an authorized Service Technician.
Display shows HHH for an extended period of time and heater surface temperature is cool.	Probe is inoperable.	

Exploded View and Parts List

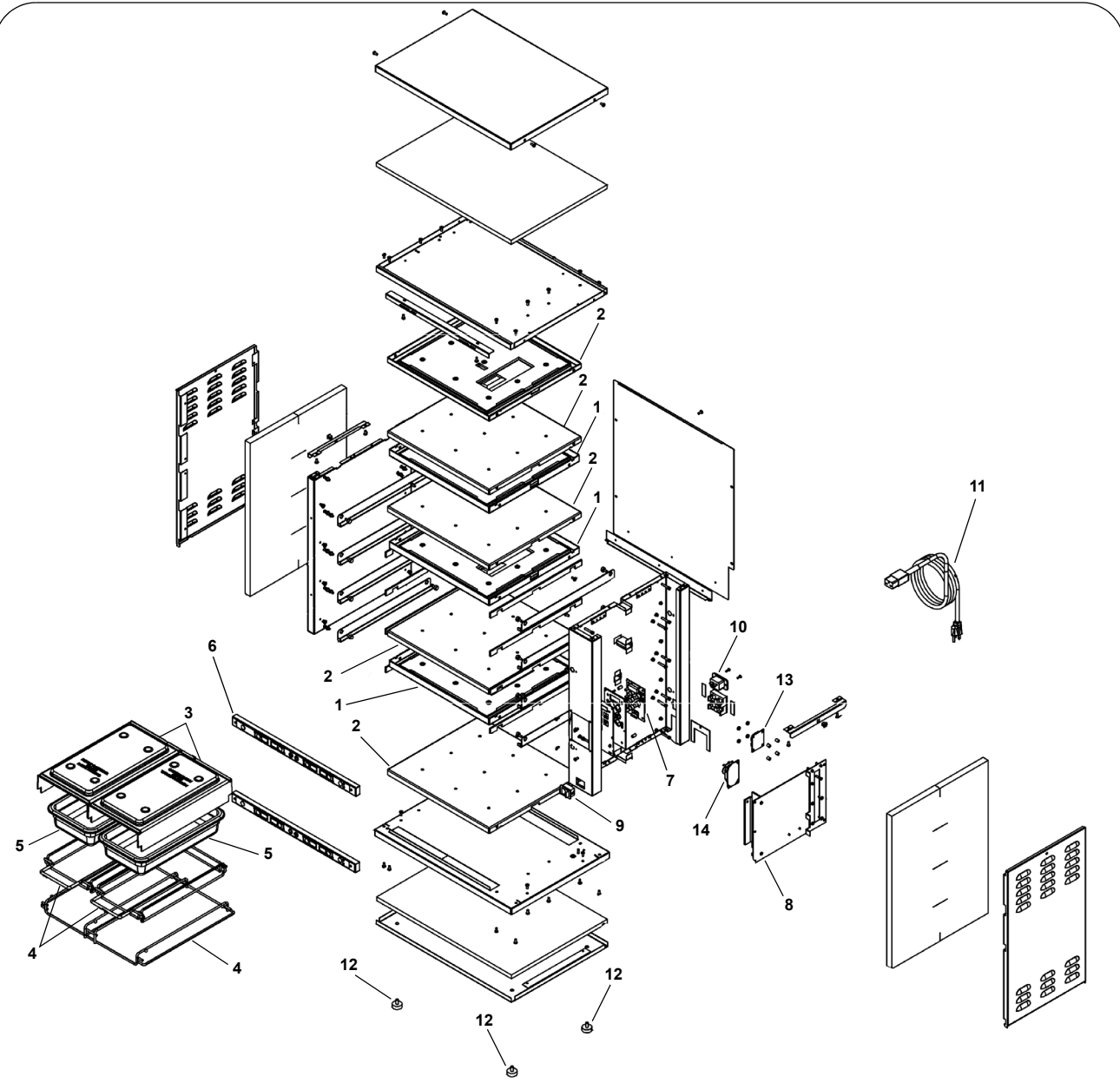

Ref.	Part No.	Description
1	541-376S	Upper Heater Assy Kit (2PT-33JB/2SS-33JB)
	542-154S	Upper Heater Assy Kit (4SS-20JB)
2	541-375S	Lower Heater Assy Kit (2PT-33JB/2SS-33JB)
	542-153S	Lower Heater Assy Kit (4SS-20JB)
3	542-286S	Lid
4	542-293S	Rack Kit (2PT-33JB/2SS-33JB)
	542-184S	Rack Kit (4SS-20JB)
5	541-1095S	Pan (2SS-33JB/4SS-20JB)
	541-442S	Pan (2PT-33JB)
6	541-1241S	Main Timer Bar Kit (2PT-33JB/2SS-33JB)
	541-1240S	Main Timer Bar Kit (4SS-20JB)
7	541-719S	Display PCB
8	541-864S	Main PCB (2PT-33JB/2SS-33JB)
	541-1106S	Main PCB (4SS-20JB)

Ref.	Part No.	Description
9	78-219S	Lighted Rocker Switch
10	88-609S	Power Inlet Connector Kit
11	72-200-25S	Power Cord Kit (2PT-33JB/2SS-33JB)
	72-200-15S	Power Cord Kit (4SS-20JB)
12	197-232S	Rubber Foot (Pkg of 4)
13	88-709-2-11S	Speaker Kit
13	88-709-2-10-5S	Speaker Kit (For DHB4PT-20JB Only)
14	741-650S	Audio PCB Interface Assy
*Not shown (Overlay for Button Bar)		
*	541-757S	Main (33")
*	541-758	Aux (33")
*	541-1242S	Aux Timer Bar (2PT-33JB)
*	541-743S	Overlay Kit (4SS-20JB)
*	541-1243S	Aux Timer Bar Kit (DHB4PT-20JB)

Wiring Diagrams

DHB4SS-20JB

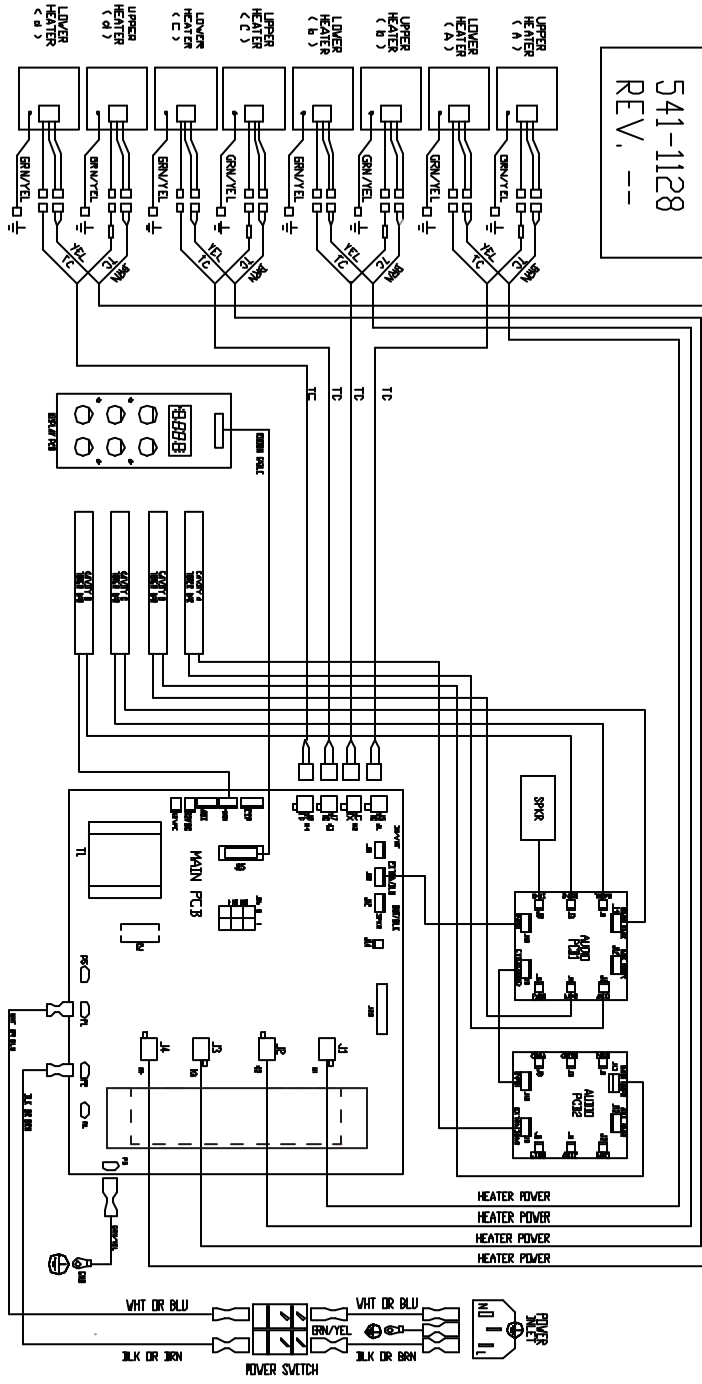

541-1128
REV. ---

Wiring Diagrams (continued)

DHB2PT-33JB

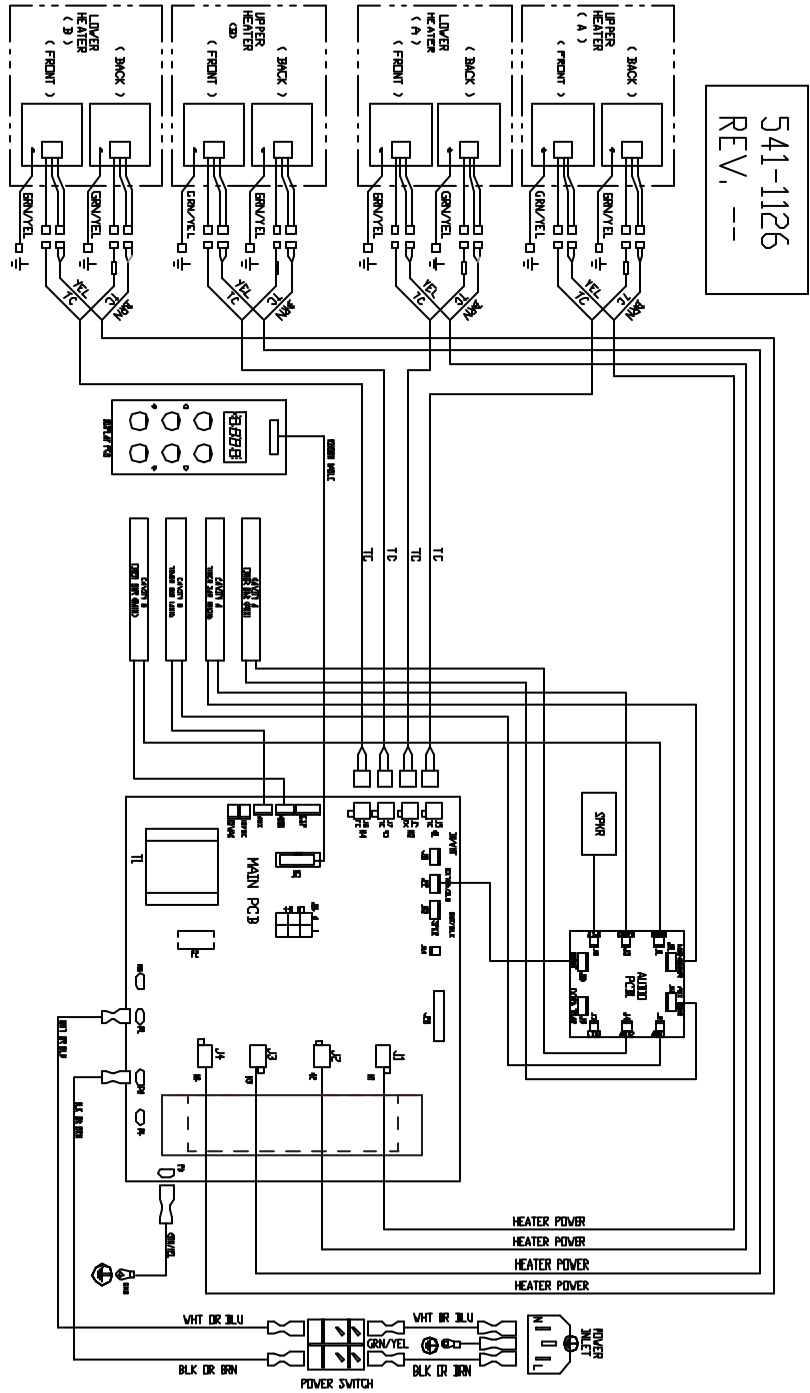



Wiring Diagrams (continued)

DHB2PT-18JB

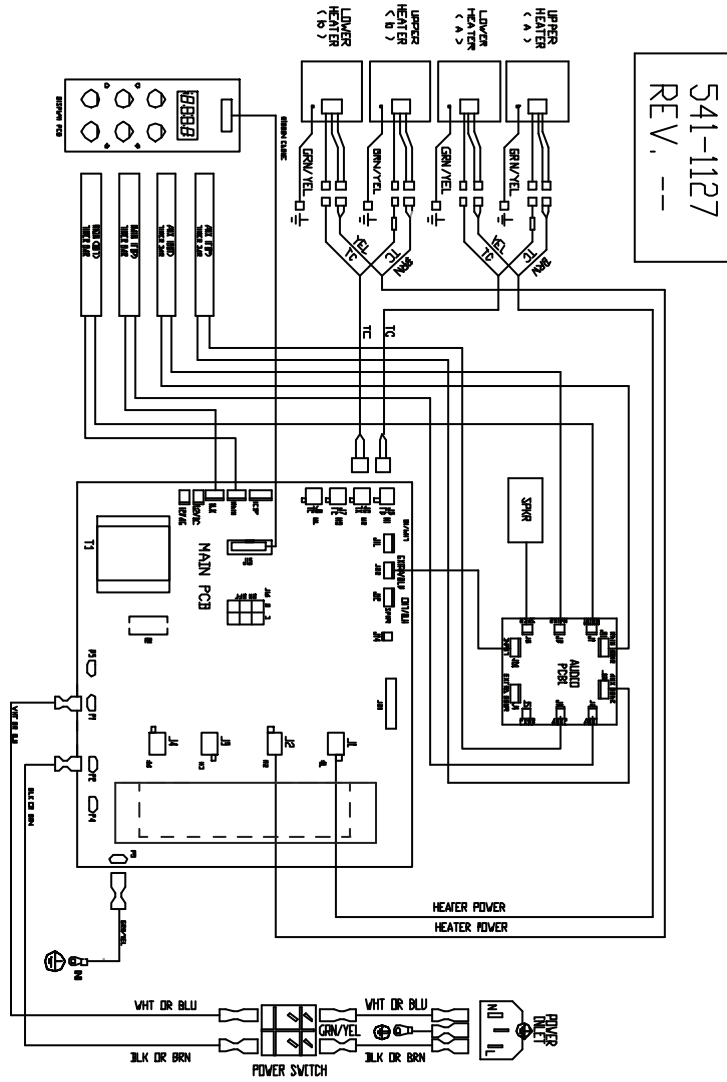

Wiring Diagrams (continued)

DHB2SS-33JB

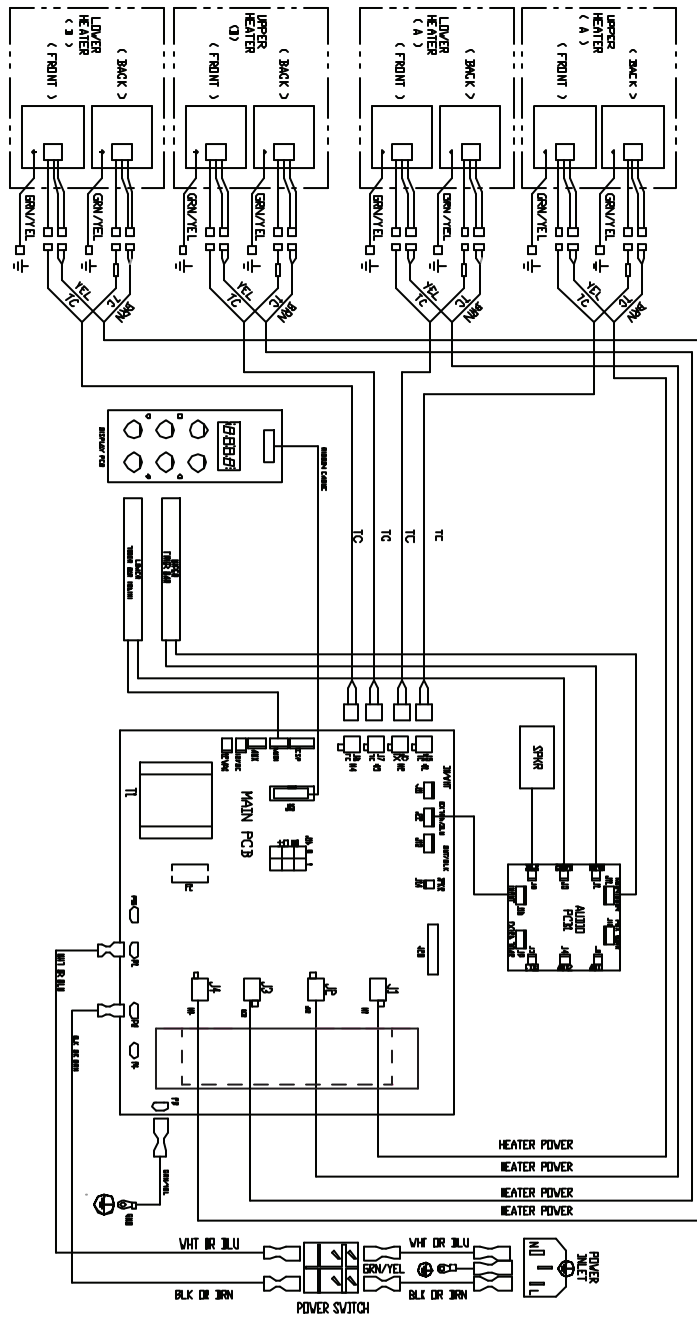

541-1125
REV. --

Wiring Diagrams (continued)

DHB4PT-20JB

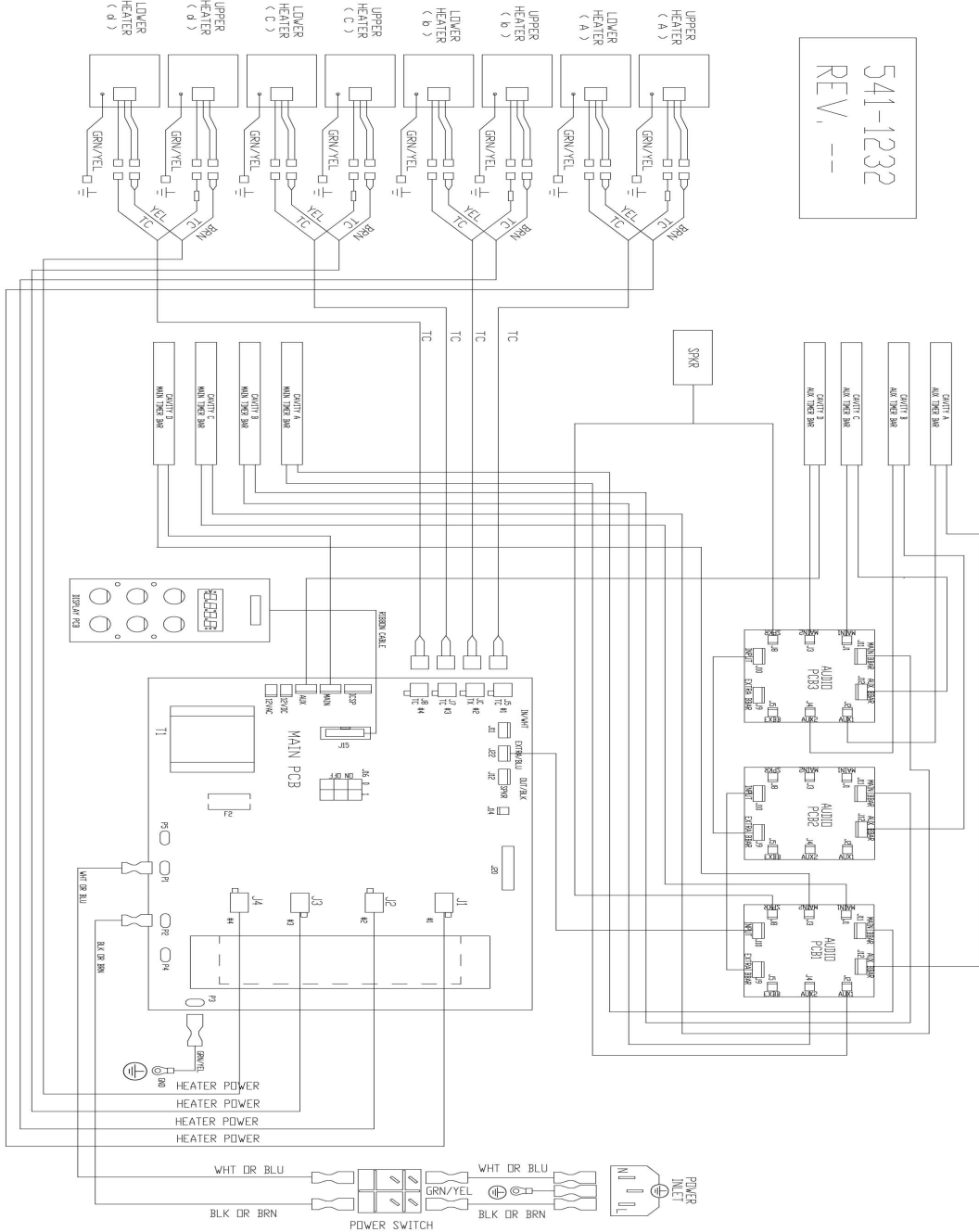

541-1232
 REV. ---