

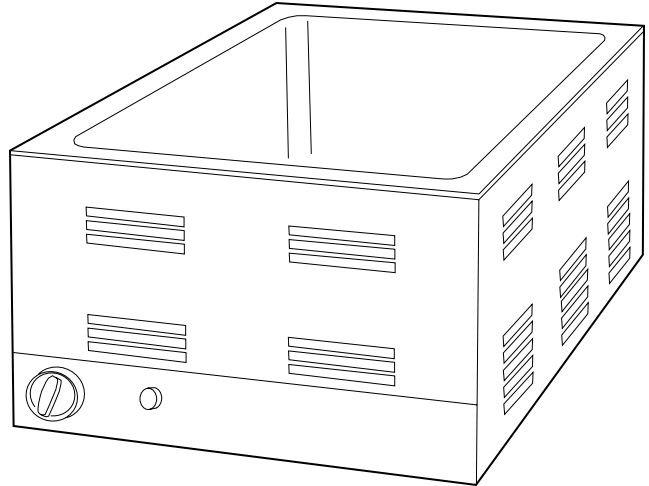

Your Solutions Partner

Illustrated Parts List



COUNTERTOP WARMER

MODEL
ACTW-I

*This manual is Copyright © 2020 Duke Manufacturing Company. All rights reserved.
Reproduction without written permission is prohibited. Duke is a registered
trademark of the Duke Manufacturing Company.*

Duke Manufacturing Company

**2305 N. Broadway
St. Louis, MO 63102
Phone: 314-231-1130
Toll Free: 1-800-735-3853
Fax: 314-231-5074
www.dukemfg.com**

COUNTERTOP WARMER—PARTS LIST

| ITEM | QTY. | PART NUMBER | DESCRIPTION |
|-------------------|------|--------------------------|--|
| 1 | 1 | 230069 | Back |
| 2 | 4 | 224053 | Rubber Foot |
| 3 | 1 | 230070 | Bottom |
| 4 | 1 | 215550 | Pilot Light 125 VAC Amber |
| 5 | 1 | 5580-2 | Infinite Switch 120 VAC |
| 6 | 1 | 223592 | Knob |
| 7 | 1 | 230162 | Element Pan (See 230162-K Below) |
| 8 | 1 | 230072 | Element Holder (See 230162-K Below) |
| Not Shown | 1 | 230162-K | Kit, Element Pan & Holder Assy (Ref- 230162 & 230072) |
| 9 | 1 | 212931 | Element 120 VAC 1200W |
| 10 | 1 | 155045 | Hi-Limit Thermostatic Switch |
| 11 | 1 | 230068 | Body Wrapper |
| 12 | 1 | 154444 | Wiring Harness |
| Not Shown | 1 | 154451 | Power Cord & Plug, 18-3 15A 125V |
| Not Shown | 1 | 212034 | Bushing, Power Cord |

Note: Liner is not replaceable.

COUNTERTOP WARMER—PARTS LIST

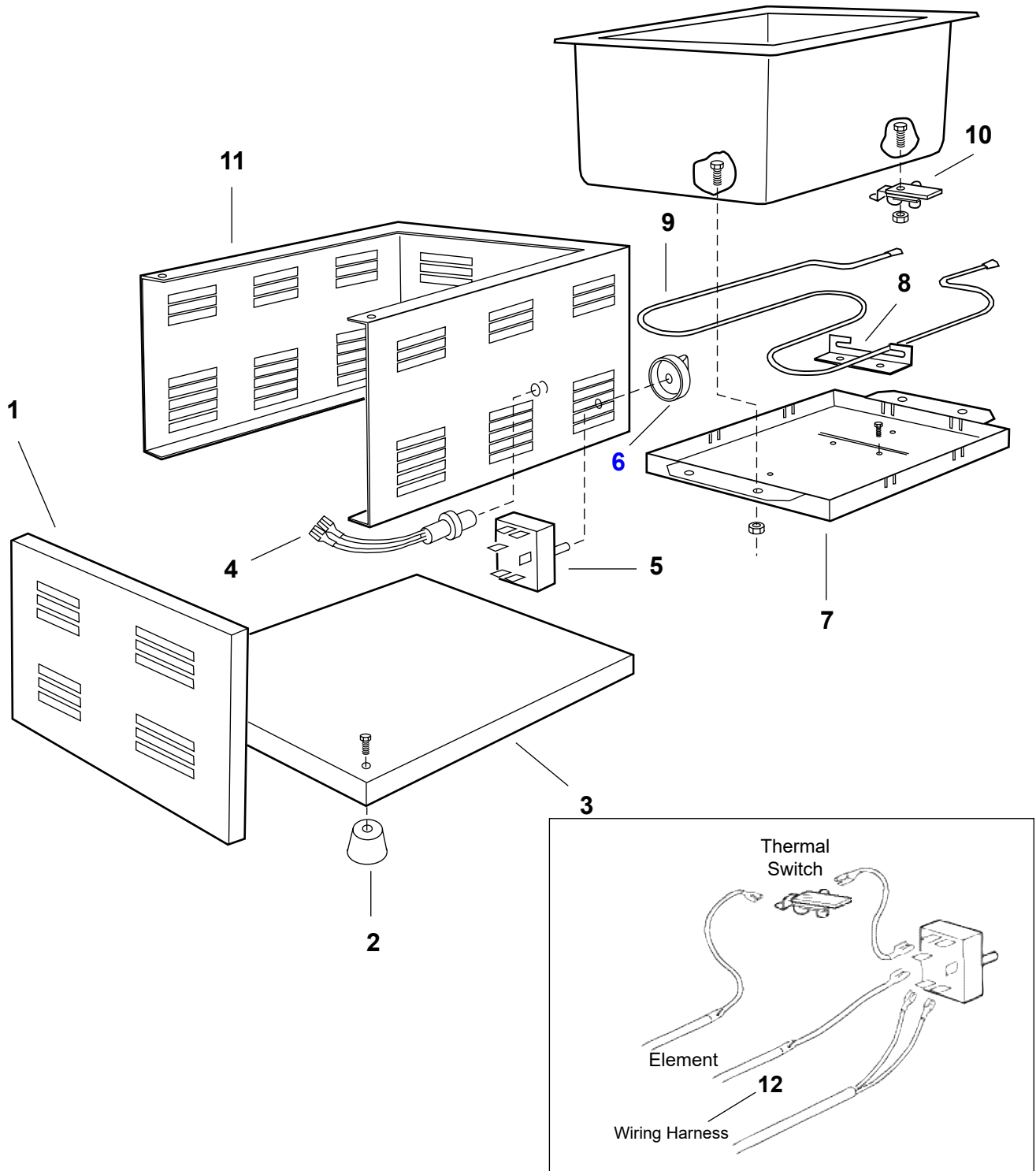



Your Solutions Partner

Duke Manufacturing Company

**2305 N. Broadway
St. Louis, MO 63102
Phone: 314-231-1130
Toll Free: 1-800-735-3853
Fax: 314-231-5074
www.dukemfg.com**