



Your Solutions Partner

Crispy Station

DK-FRY-27-S-DQ

DK-FRY-27-D-DQ

DK-FRY-36-S-DQ

DK-FRY-36-D-DQ

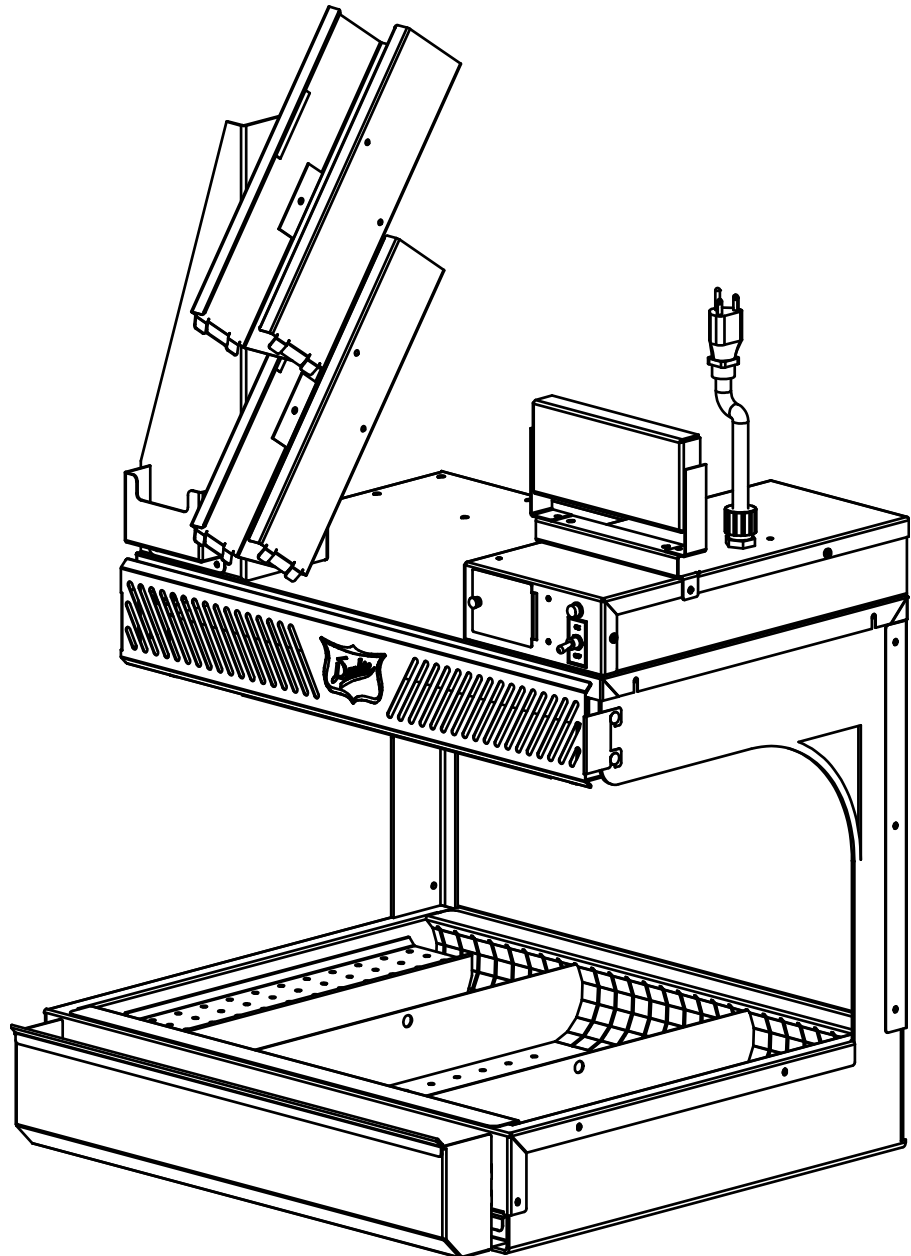

CAUTION: Please read this manual completely before attempting to install, operate or service this equipment

 **WARNING:** Cancer and Reproductive Harm - www.p65warnings.ca.gov

*This manual is Copyright © 2020 Duke Manufacturing Co. All rights reserved.
Reproduction without written permission is prohibited. Duke is a registered
trademark of the Duke Manufacturing Co.*

CLEANING

!WARNING Do not use any highly caustic cleaners, acids or ammonia. These may cause corrosion and/or damage to the stainless steel.

CAUTION ⚡ Electrical shock hazard. Do not wash with water jet or hose.

Daily:

General Cleaning Instructions

1. Turn Unit off and allow to cool.
2. Always clean equipment thoroughly before first use. Clean unit daily, use warm, soapy water or mild detergent.
3. Remove and clean: Fry Basket, Crumb Tray, Dividers and Small-ware Trough.
4. Wipe down all metal surfaces with a water-dampened, non-abrasive cloth.
 - Stubborn stains may be removed using a good stainless steel or non-abrasive cleaner.
 - Clean hard to reach areas using a small brush and mild soap.

NOTICE: DO NOT USE STEEL WOOL.

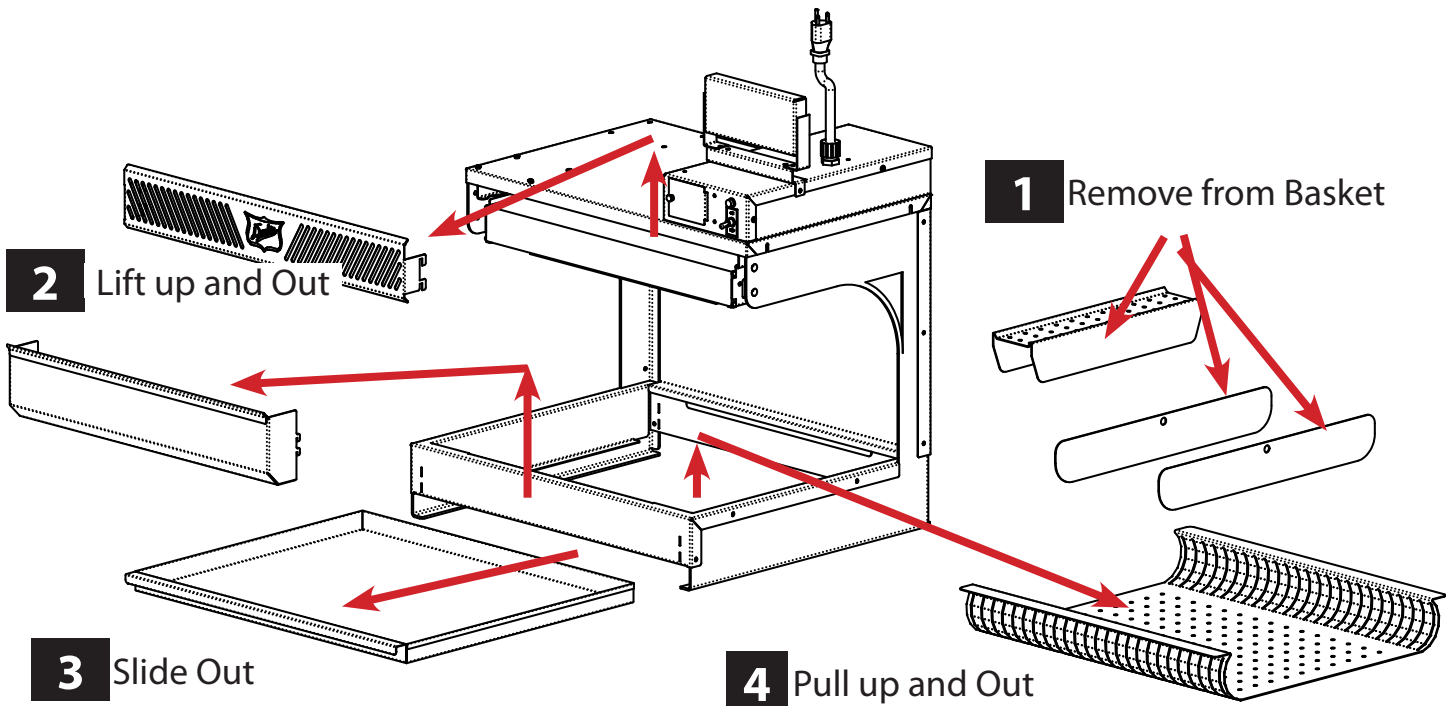

CLEANING - continued

Weekly:

- 1 Lift grill up and out to remove for cleaning.

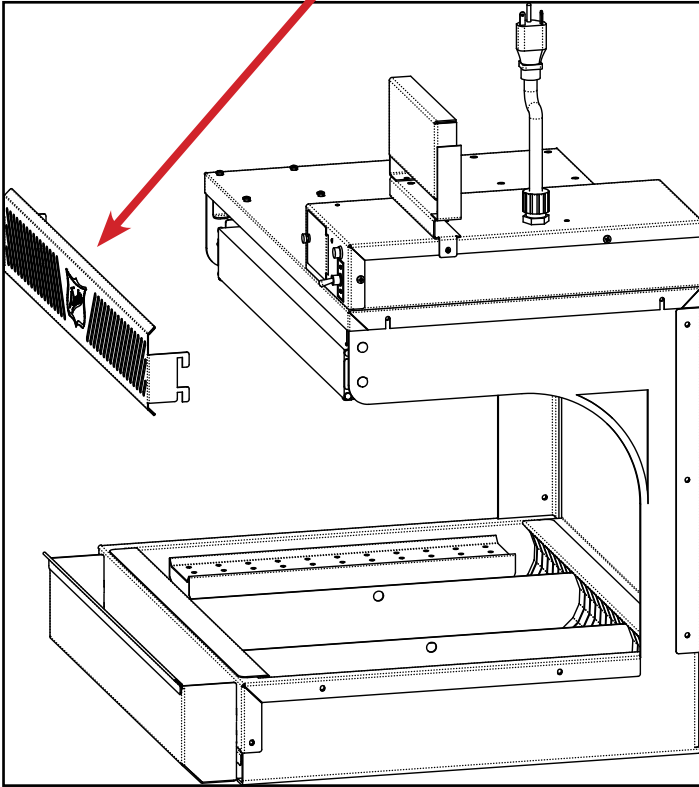

- 2 Using a soft cloth remove any oil or debris from top of heater.

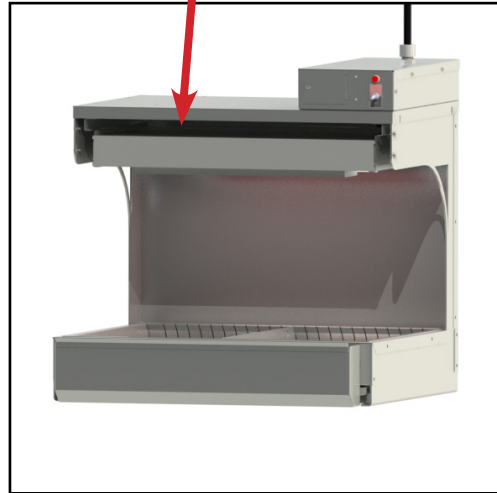

- 3 Re-install top grill cover.

⚠ WARNING

Failure to complete this step could result in bodily injury

PREVENTIVE MAINTENANCE

Follow the cleaning procedures in the cleaning section to avoid maintenance issues.

REPLACING DISPLAY LIGHT BULBS

⚠ WARNING

Use only light bulbs that meet or exceed National Sanitation Foundation (NSF) standards and are specifically designed for holding areas. Breakage of light bulbs not specially coated could result in personal injury and or food contamination.

The display light is an incandescent bulb that illuminates the warming area. These bulbs have a special coating to guard against injury and food contamination in the event of breakage.

To replace a display light bulb:

1. Disconnect the power supply and wait until unit has cooled.
2. Unscrew the light bulb from the unit and replace it with a new, specially-coated incandescent or optional halogen bulb.

NOTE: *Hatco shatter-resistant light bulbs meet NSF standards for food holding and display.*

- *For 120, 120/208, and 120/240 volt appliances use Hatco P/N 02.30.043.00.*



Duke Manufacturing Co.
2305 N. Broadway
St. Louis, MO 63102

Phone: 314-231-1130
Toll Free: 1-800-735-3853
Fax: 314-231-5074

www.dukemfg.com