

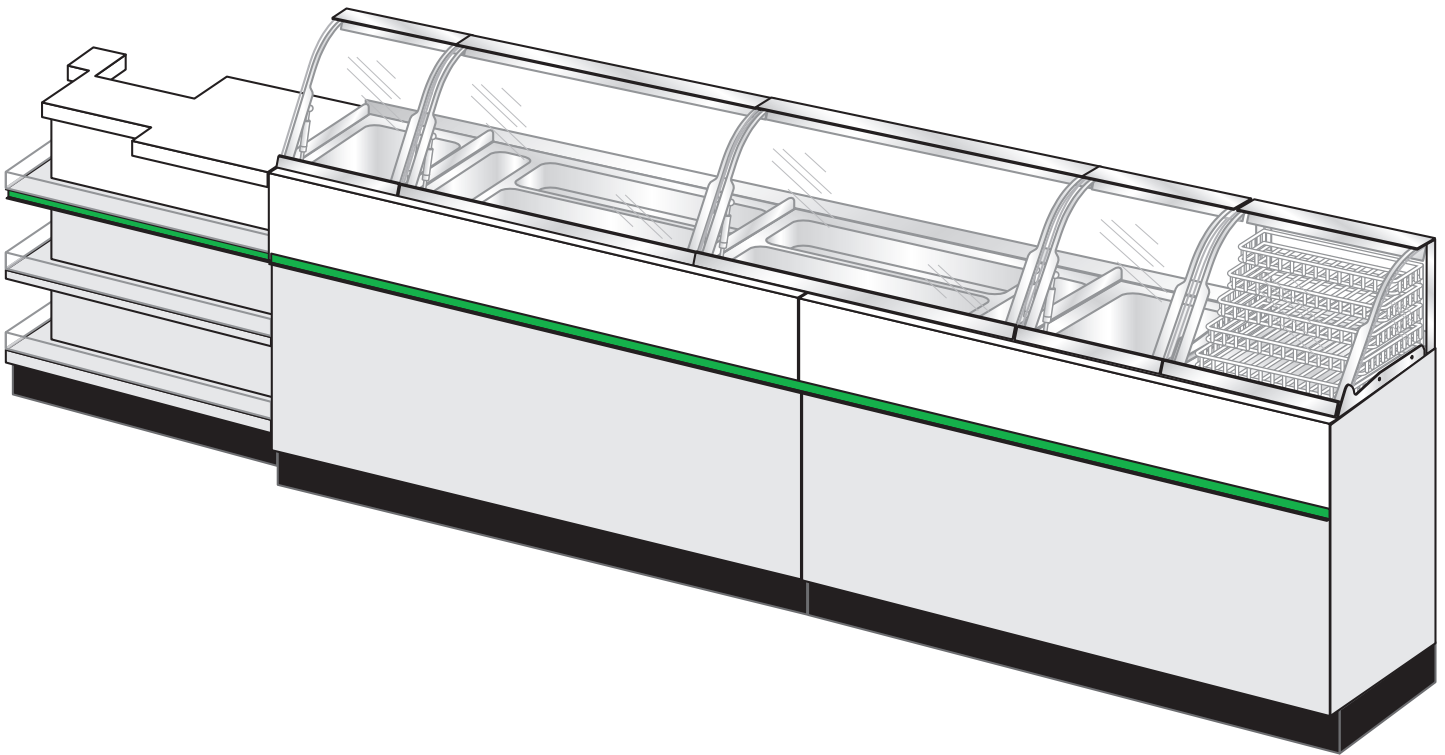

Your Solutions Partner

Installation Instructions

Front Counter Decor & Cashier Top



To view a video Scan
the QR code above

CAUTION: Please read this manual completely before attempting to install, operate or service this equipment

*This manual is Copyright © 2018 Duke Manufacturing Co. All rights reserved.
Reproduction without written permission is prohibited. Duke is a registered
trademark of the Duke Manufacturing Co.*



TABLE OF CONTENTS

Safety Instructions2

Tools Needed - not included3

I. Removal of Old Decor Panels (retro Fit only)4

II. Notching Hot Food Unit (with Bread Display Only)4

III. Level All Units4

IV. Front Decor Panels5

V. Side Decor Panel - Without Chip Rack.....9

VI. Installing Solid Surface Top11

IMPORTANT SAFETY INSTRUCTIONS

Throughout this manual, you will find the following safety words and symbols that signify important safety issues with regards to operating or maintaining the equipment.



Indicates a hazardous situation which, if not avoided, could result in death or serious injury.



Indicates a hazardous situation which, if not avoided, could result in minor or moderate injury.



Indicates Important Information



Indicates electrical shock hazard which, if not avoided, could result in death or serious injury and/or equipment damage.



Indicates hot surface which, if not avoided, could result in minor or moderate injury.

In addition to the warnings and cautions in this manual, use the following guidelines for safe operation of the unit.

- Read all instructions before using equipment.
- Install or locate the equipment only for its intended use as described in this manual.
- Do not use corrosive chemicals in this equipment.
- This equipment should be serviced by qualified personnel only. Contact the nearest Duke authorized service facility for adjustment or repair.
- Do not block or cover any openings on the unit.

The following warnings and cautions appear throughout this manual and should be carefully observed.

- The procedures in this manual may include the use of chemical products. You must read the Material Safety Data Sheets before using any of these products.
- Disposal of the unit must be in accordance with local environmental codes and/or any other applicable codes.
- This appliance is not intended for use by persons (including children) with reduced physical, sensory or mental capabilities, or lack of experience and knowledge, unless they have been given supervision or instruction concerning use of the appliance by a person responsible for their safety.

Tools Needed - not included



Caulking Gun



Adjustable Wrench



Cordless Drill



Socket Set

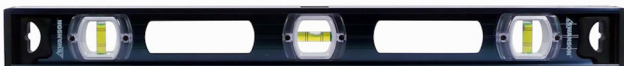

Level



Phillips Screw Driver

Front Counter Decor Installation

I. Removal of Old Decor Panels - If Retro Fit

NOTE: If this is not a retrofit move on to next section "Notching Hot Food Unit"

CAUTION Damage/Injury could result if two persons are not used for this Installation.

Step 1 Removing front panels

A. Remove two screws at each end of the unit.

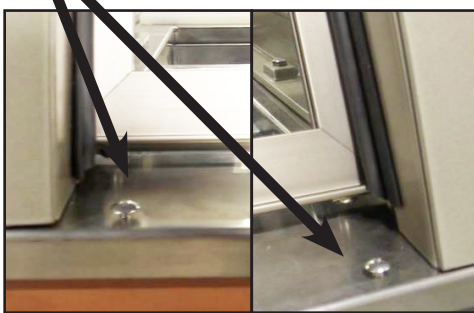

B. Lift Decor panel up and pull out bottom.

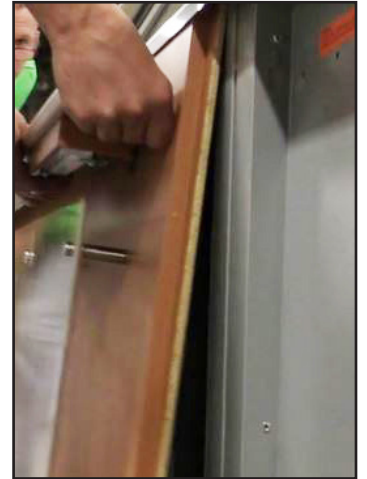

Note: Make sure to unplug the front light cord.

II. Notching Hot Food Unit - If Bread Unit to be Installed

NOTE: If there is no Bread Display then skip to next section "III Level all Units"

NOTE: Will need the side that has the turn down flange.

Step 1 Mark the hot food unit.

Step 2 Using a grinding wheel, cut out section to make room for the Decor Panel.

Step 3 Clean up any burrs and smooth sharp edges.



III. Level all Units

NOTE: All units must be leveled before front panels are installed starting with cold pan and working outward.

CAUTION Failure to level all units may result in Decor Panels not lining up.

Line up all cabinets in approximate final location and start bolts that are used to fasten bodies to each other. **Note: Do not fully tighten bolts**

Make sure all units are level and aligned with each other. Tighten all bolts to secure units. See installation instructions supplied with equipment.

Front Decor Installation - continued

IV. Front Decor Panels

⚠ CAUTION Damage/Injury could result if two persons are not used for this Installation.

Note: Make sure all electrical is complete before installing front panels

Step 1 Mounting front panels

A. Ensure all brackets on back of panel are adjusted as shown on the right. It is adjusted correctly when you can see the open center (where the bolt is) with the lower flange up above (see Red arrows).

NOTE: (3/8" From bottom of bracket to offset)

NOTE: The adjustment bracket allows the decor panel to sit on the kick plate angle when installing the front panel and during adjustment.

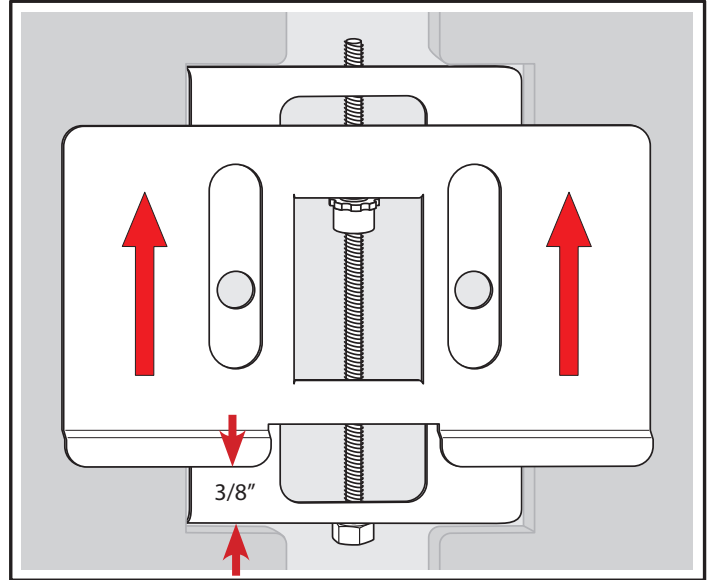

Part Number - ROT-ADJ-DECOR-BKT

B. Start with the notched panel. (the notched side should be adjacent to the cash unit)

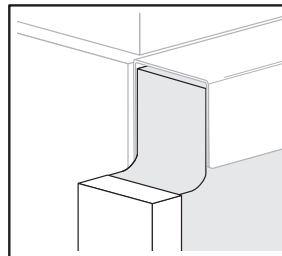

Note: Pictures may be reversed based on type of store.

C. Slide the panel up into the channel at the top of the unit. Using the brackets hang the panel on the metal lip at the bottom of the unit.

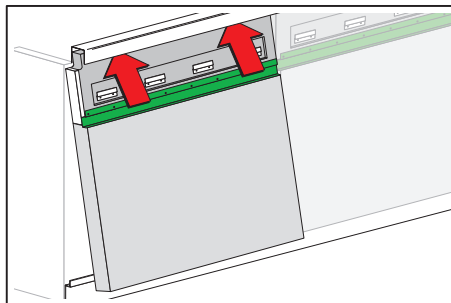

⚠ CAUTION Pull on bottom of panel to ensure engagement with bracket.

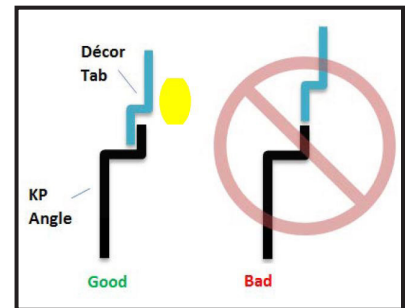

D. Using a Socket and ratchet adjust the panel to be flush against the top.

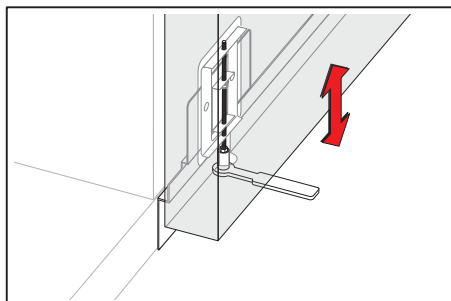

E. Repeat steps for all panels.

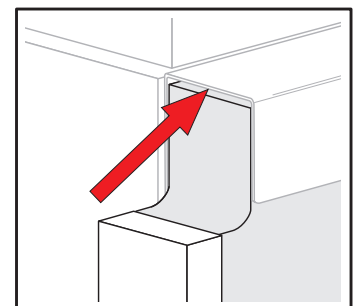

Front Decor Installation - continued

Step 2 Alignment of panels

A. Use the adjustment bolts to line up the green channel where the two panels have a seam.

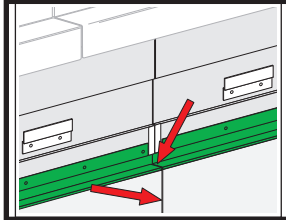

Note: Make sure the vertical seam is closed.

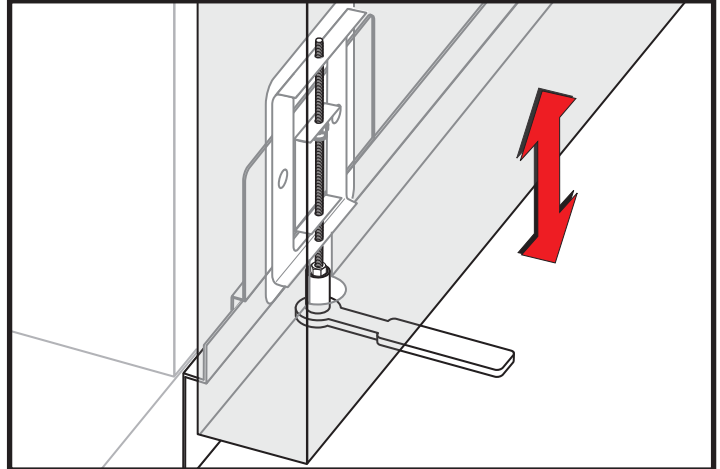

Step 3 Secure Panels Together

Use the metal plate with four holes and four (4) flat head sheet metal screws #8X3/4" packaged with the top caps to connect the front panels.

Note: This will assist to pull the seams together and flush on the front.

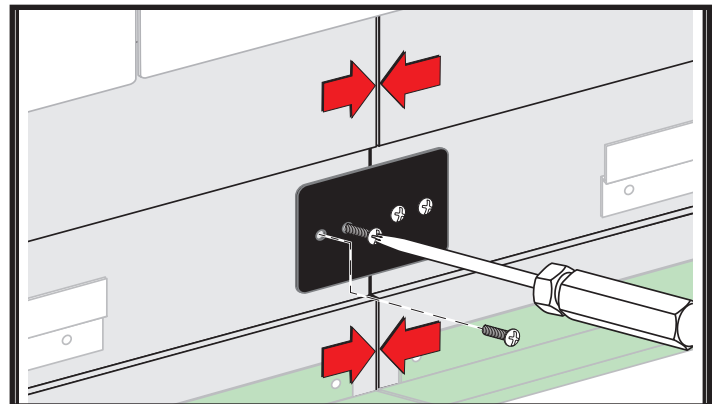

Step 4 Installing the Filler Panel

A. Remove the Grommet on the sandwich unit next to the cashier unit.

B. Prior to installing the chip shelf, locate the 6" panel/filler. Secure with double sided tape on back of panel. This panel is to be installed on the end of the unit adjacent to the cashier and **perpendicular** to the notched décor panel. **Note:** (4) 1-1/2 Screws available if needed. Using panel mark and drill (4) 1/8" holes.

C. Silicon any and all gaps as needed.

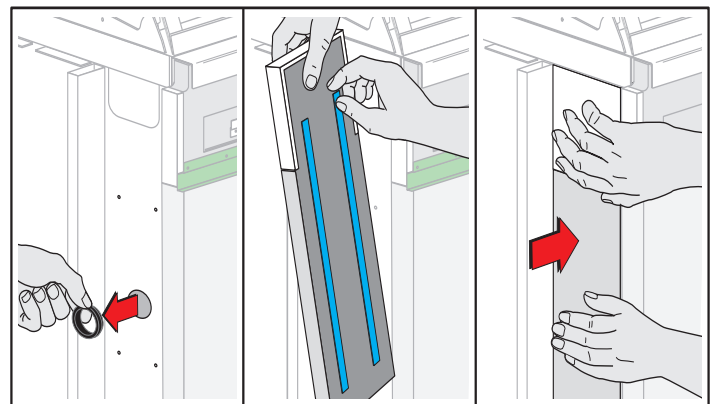

A

B

C

Front Decor Installation - continued

Step 5 Installing the Chip Rack

The chip shelf for the cashier sits on the bottom shelf of the cashier unit and slides up to the notched front panel. The outside edge should be flush to the end panel on the unit (see below).

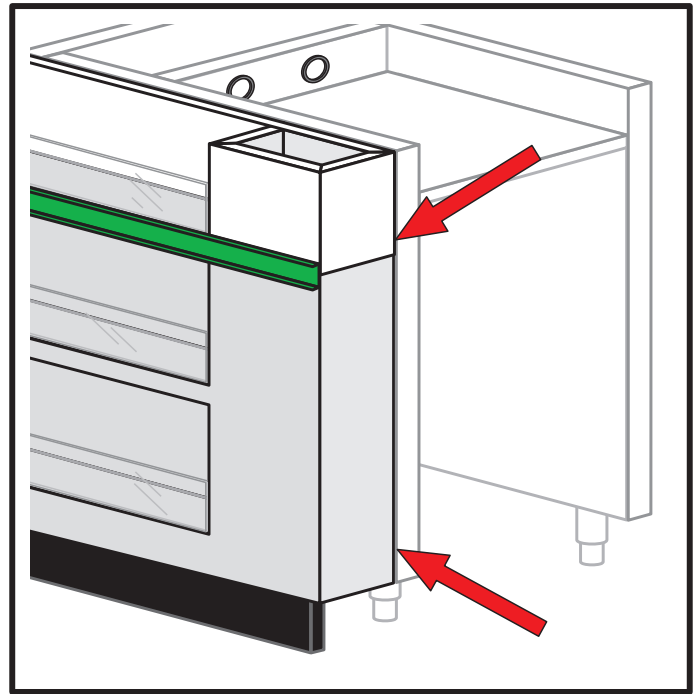
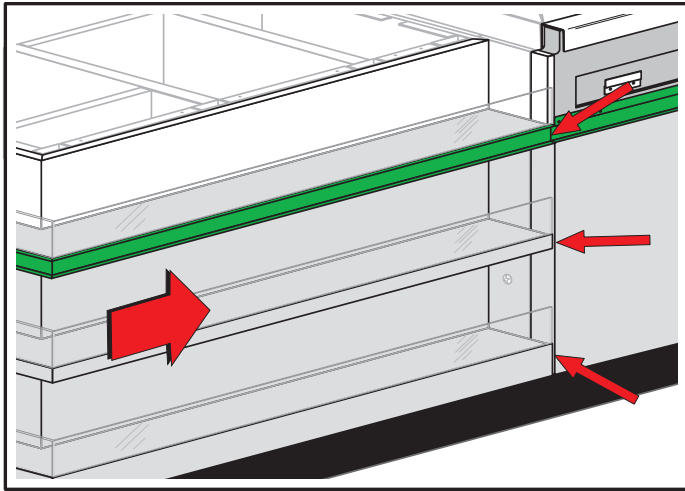

Chip Shelf flush with Backside Cashier Stand

NOTE: There are one or two stiffening rails on the back of the Cashier shelves that **DO NOT** attach to any part of the frame.

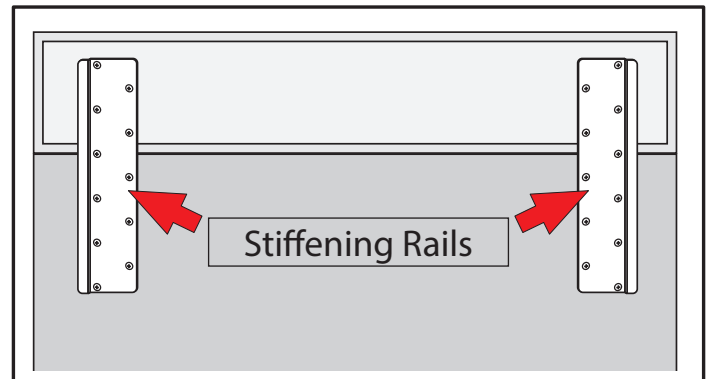

Step 6 Installing the Top Cap

A. The upper portions of the front panels have a hanging brackets that “hook/lap over” with the brackets on the back side of the white solid surface top caps.



CAUTION Damage/Injury could result if two persons are not used for this step.

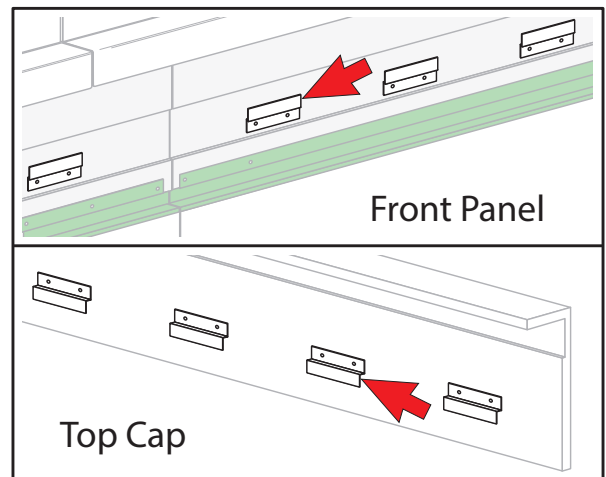

Front Decor Installation - continued

B. Using **two persons**, set the top cap roughly into position with the front panels. Holding the top cap between 0.5"-1" above the stainless top, press the lower portion of the top cap into the groove of the front panel.

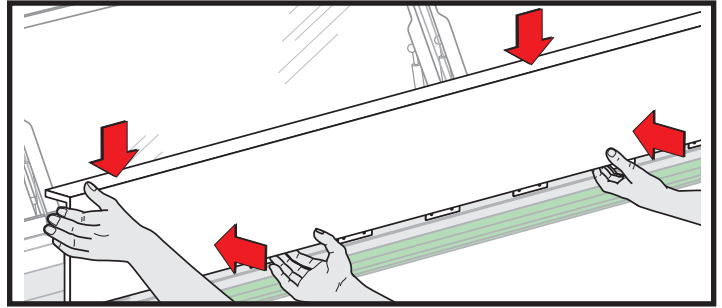

C. Carefully push down the top cap until it is seated within the channel on the front panels.

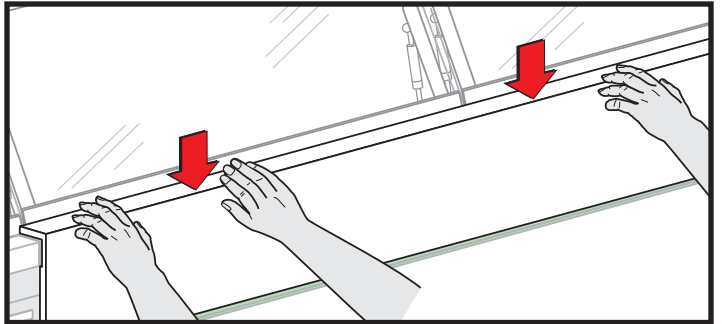

D. Ensure the top cap is installed correctly by **slightly** pulling on the bottom of the top cap to make sure it is seated.

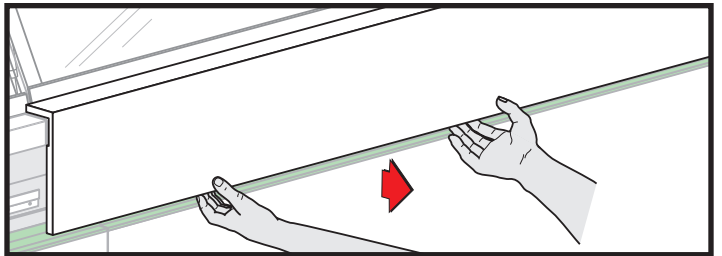

CAUTION DO NOT PULL TOO HARD AS THE PANEL MATERIAL CAN BREAK

E. Repeat steps for balance of top caps.

Step 6 Securing Front Panels

Once all panels have been installed and adjusted. From back side under counter secure panels by using 3/4" wood screws.

NOTE: Minimum of four screws per unit.

CAUTION Failure to complete this step could cause bodily injury.

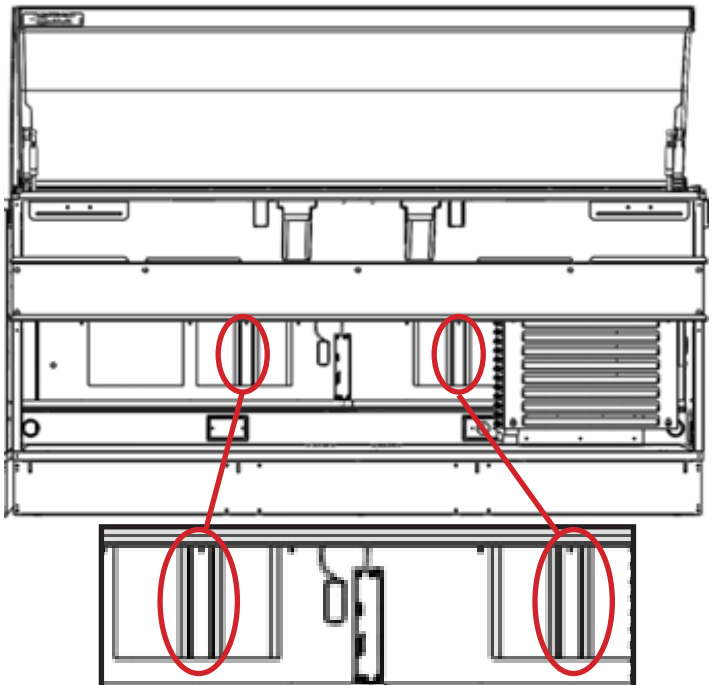

Front Decor Installation - continued

V. Side Decor Panel - Without Chip Rack

Step 1

Ensure all brackets on back of panel are adjusted as shown on the right. It is adjusted correctly when you can see the open center (where the bolt is) with the lower flange up above (see Red arrows). (3/8" From bottom of bracket to offset)

NOTE: The adjustment bracket allows the decor panel to sit on the kick plate angle when installing the front panel and during adjustment.

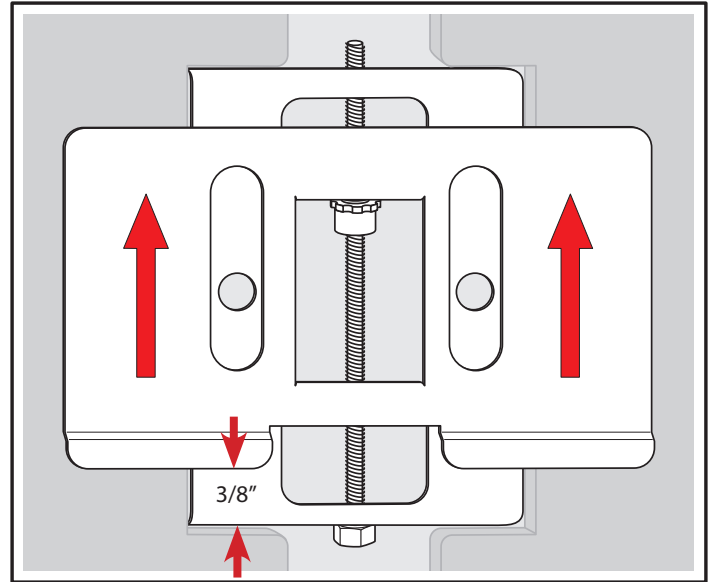

Step 2

Using brackets on back of panel set panel on kick-plate making sure bracket is engaged.

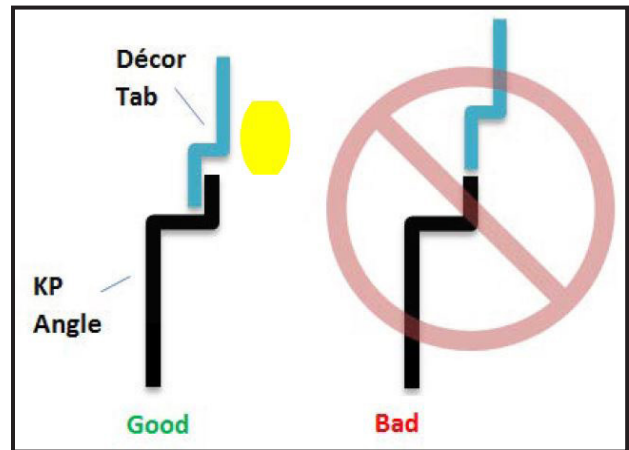
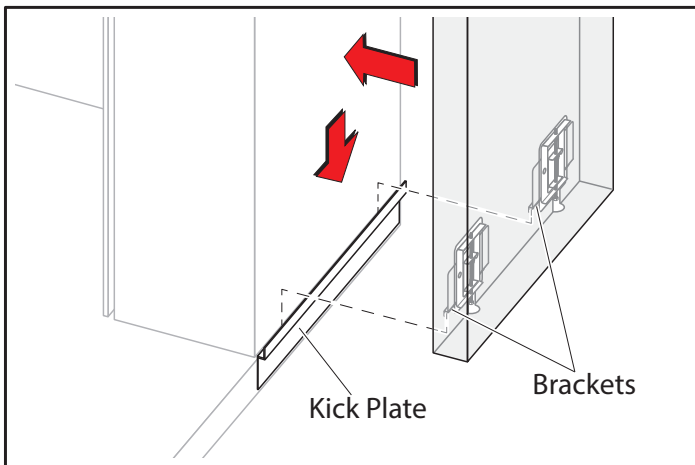

Step 3

Using Masking Tape hold panel in place.

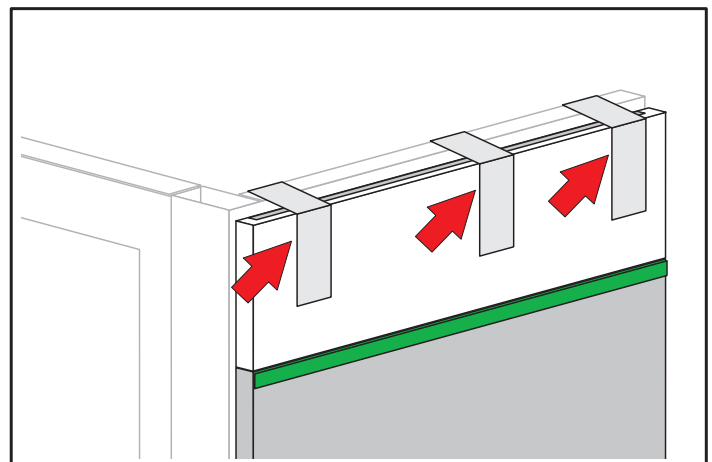

Front Decor Installation - continued

Step 4

Using a Socket and ratchet adjust the panel to be flush against the top.

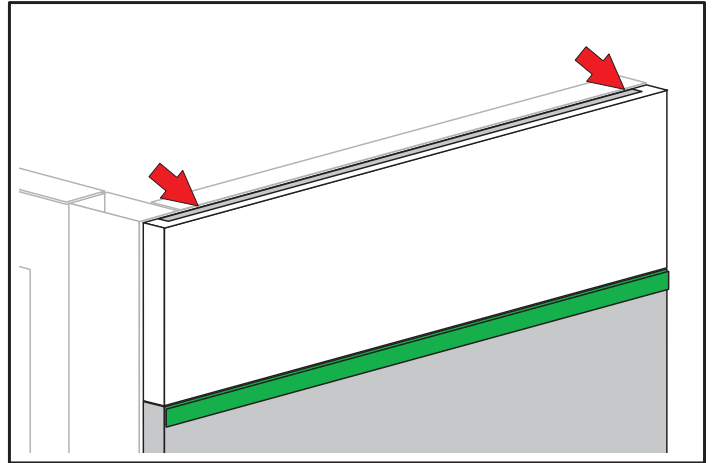
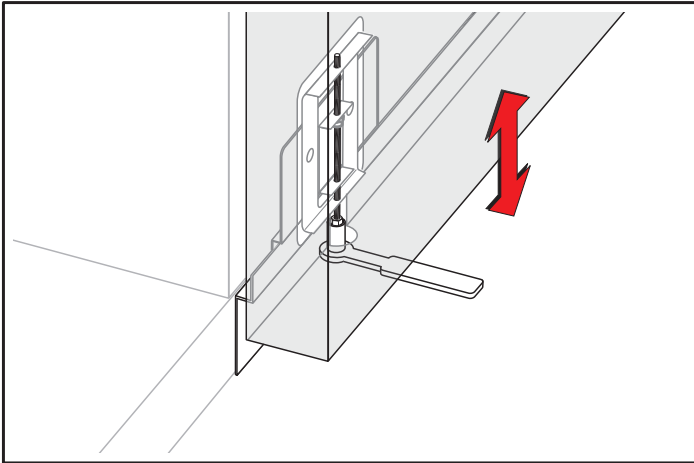

Step 5

Using four (4) #8 X 3/4" Wood Screws secure panel to counter from inside unit.

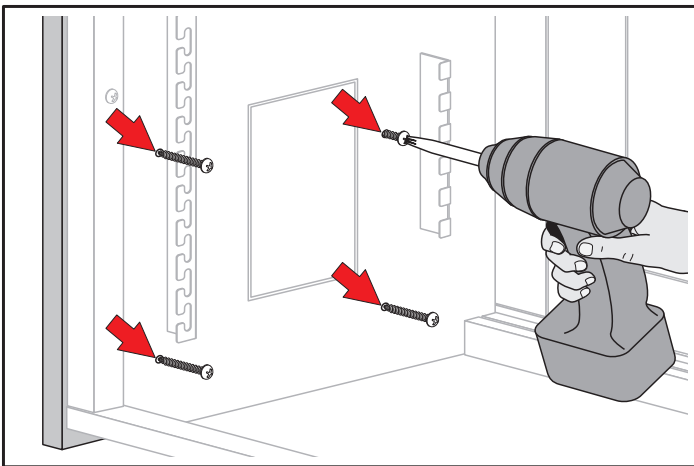

Front Decor Installation - continued

VI. Installing Solid Top

Step 1 Apply Silicone

CAUTION Dry fit top before installing to make sure everything lines up.

A. Before placing the top, trace the top frame with silicone along the top surfaces of the cashier station.

NOTE: Your top may be different than pictured based on order.

CAUTION THE TOP DOES NOT COME FULLY INSTALLED AND CAN SLIDE AROUND.

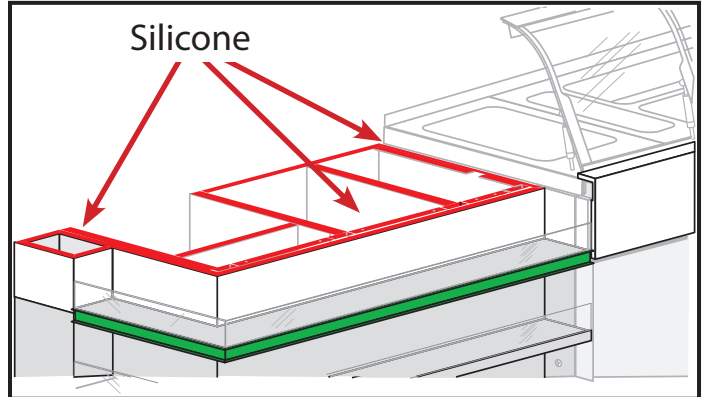

Step 2 Place Top

B. Set solid top in place and align with front edges and counter line.

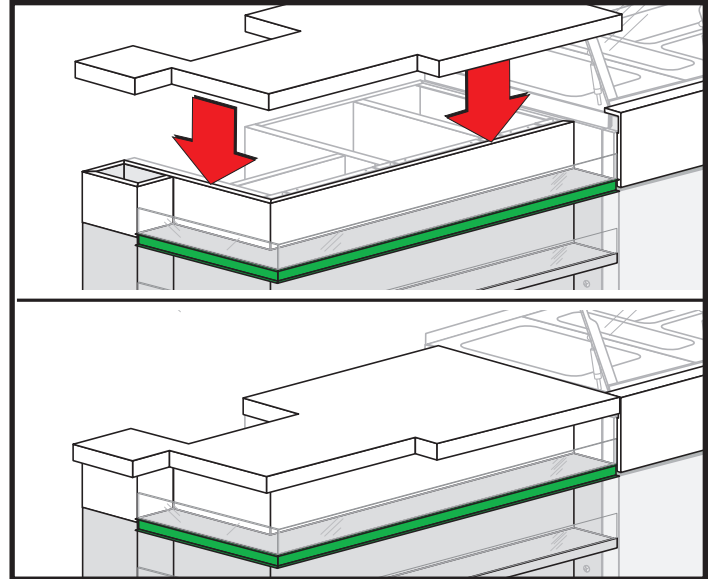

NOTES



Duke Manufacturing Co.
2305 N. Broadway
St. Louis, MO 63102

Phone: 314-231-1130
Toll Free: 1-800-735-3853
Fax: 314-231-5074

www.dukemfg.com