



Your Solutions Partner

INSTALLATION INSTRUCTIONS

MAIN CONTROLLER REPLACEMENT INSTRUCTIONS FOR:

DUKE KITS

600309 - TSC-6/18M

600546 - PBC-6/18M

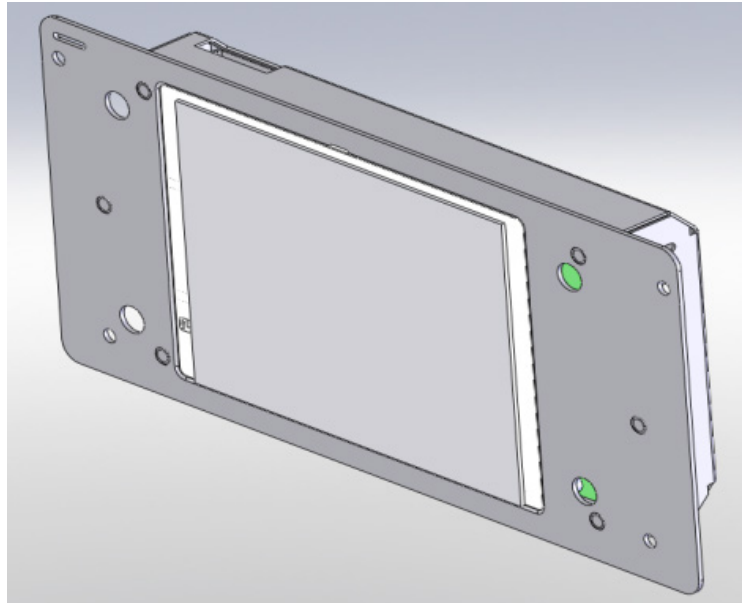

This kit contains:

Main Control Module Assembly For:

- ELC0017-1 - PCB, TSC, TSCM
OR
- ELC0017-7 - PCB, TSC, PBC
- 512418 Strap, Disposable Wrist ESD

Items required for this installation:

- #2 Phillips Screw Driver
- 11/32" Nut-driver
- ESD Wrist Strap (included in kit)

CAUTION: Please read this manual completely before attempting to install, operate or service this equipment

*This manual is Copyright © 2019 Duke Manufacturing Co. All rights reserved.
Reproduction without written permission is prohibited. Duke is a registered
trademark of the Duke Manufacturing Co.*

P/N 120107
REV C 05/22/2019

REMOVAL OF OLD CONTROL

1. Verify the Main Control Module Assembly requires replacement prior to proceeding. Reference Service Manual Troubleshooting Guide.
2. Verify recipe settings (recipe names and set points) with store staff prior to replacement. Record recipe setting for reference to reprogram any variance in recipes names and set points on the new control after replacement.
3. Turn OFF the unit's Power Switch on the left side middle of the oven.

 **NOTE:** The Main Control Module Assembly is 12VDC supplied only and is isolated from dangerous or high voltages by inner safety cover inside the controls cavity behind the exterior controls panel.

4. Loosen, but do not remove the bottom and rear screws on the slide out. Remove top left and top right screws.

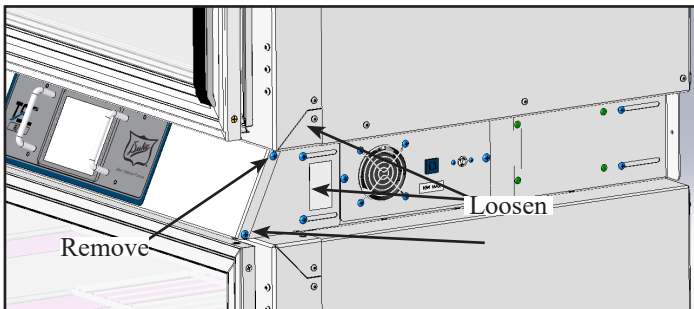

5. Slide the control panel forward and tilt down the control panel.

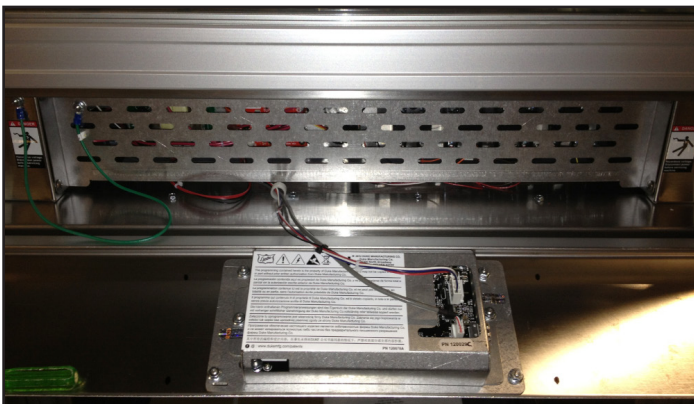

6. Connect ESD Wrist strap to Unit in location shown.

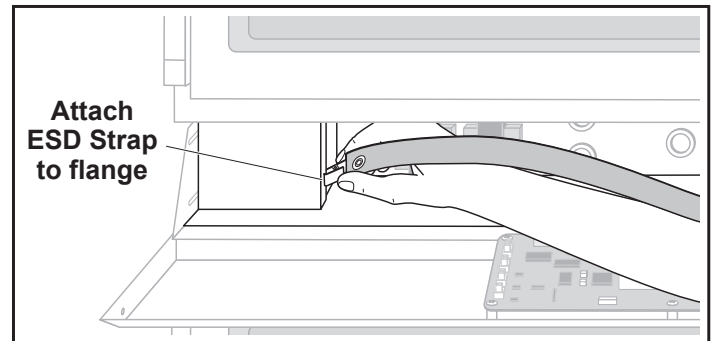

7. Place ESD strap on wrist and tighten. Strap must be tight around wrist to be effective.

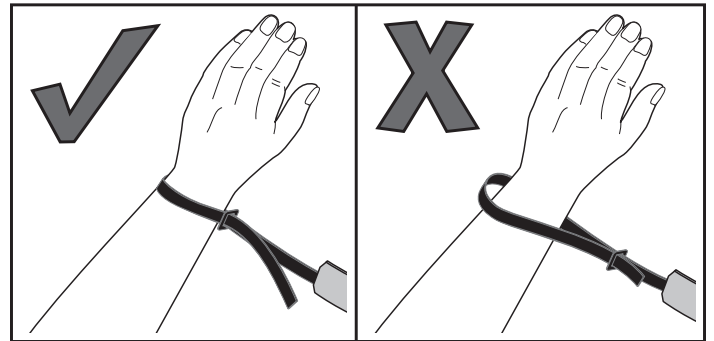

8. Unplug the two connectors on the back of the Main Control assembly in the unit.

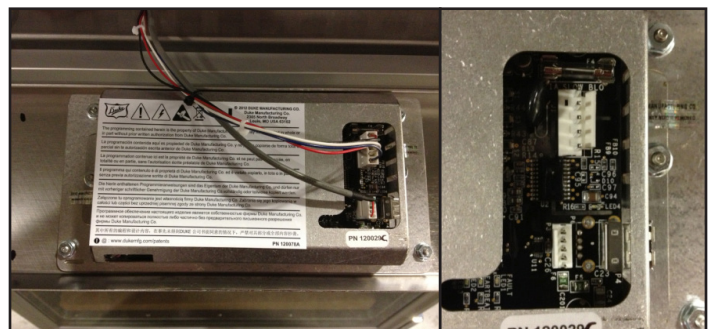

- Remove the outer 4 corner retaining nuts that mount the Main Control Module Assembly to the inner controls panel.

WARNING

Do not remove the center nuts or PCB cover of the Main Control Module Assembly. Warranty may be voided if cover has been removed or tampered with.

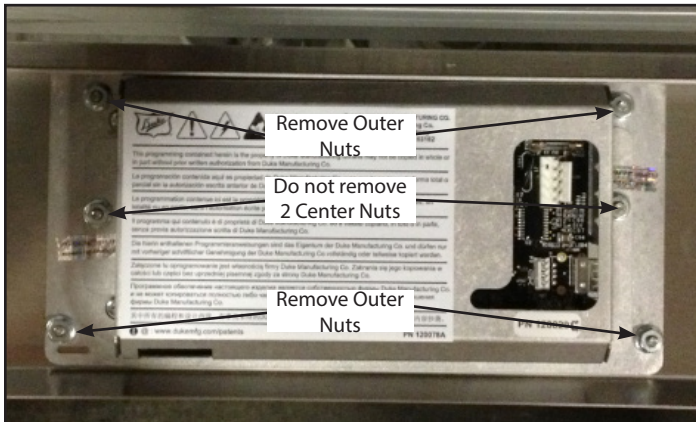

- To prevent static cling between the display and overlay, lightly dust the display glass with baby powder or talc powder. Gently remove powder by brushing with a cosmetic brush (as shown below). Do not wipe the display with hands or any cloth as this may scratch the glass. Additionally, do not put any powder on the overlay.



INSTALLING NEW CONTROL

- Using proper ESD procedures, remove the replacement Main Control Module Assembly from the shipping box. Visually inspect the new Main Control Module Assembly for damage. If damage is identified, do not install the new control and immediately contact Duke Service Department for instruction.
- A display glass protector must be removed from the new Main Control Module Assembly display glass before installing. The protector is a clear transparent plastic layer over the glass which is easily removed by hand. Contact Duke Service if you have question about the glass protector.

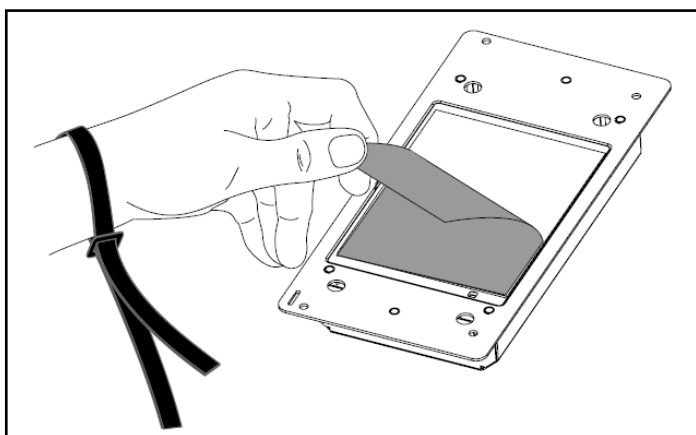

- Remove the prior / damaged Main Control Module Assembly from the mounting studs and place the new replacement Main Control Module Assembly. Verify the new Main Control Module display is centered in the control panel window. Reinstall the 4 retaining nuts and reconnect the 2 PCB header connections.

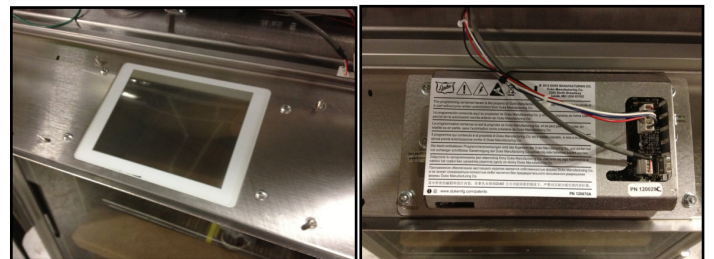

- Repack the prior / damaged Main Control Module Assembly in the ship packaging for return shipment to Duke Manufacturing.
- Remove the ESD Wrist Strap.
- Turn ON the left side power switch and verify the LED indicators on the new Main Control Module PCB Assembly are active (viewed through the rear cover window. The PCB LED's will activate as the control boots and while running. Go to the Troubleshooting Guide if LEDs do not activate.

Main Controller Replacement Instructions:
TSC-6/18 and PBC-6/18

8. Tilt up and slide back the control panel. Replace the Top 2 screws and tighten all 8 screws on both sides. Verify the Duke logo screen or the "gray" button start screen is properly displayed.



NOTE: Verify wiring is not trapped or visible under the controls panel after fully slid into position.

9. Turn OFF and turn back ON the left side power switch while watching the control display. Record the software version identifier (Example "A005.88F") at the bottom of the Duke Logo screen. Repeat Off / On cycle if the software version I.D. is missed during the automatic logo screen view.
10. From the "gray" screen, select either the Oven icon or an Oven recipe and verify the Oven lights turn ON and verify fault messages are not displayed in the top tool bar of the display. Go to the Troubleshooting Guide if Oven lights do not turn ON.
11. Select either the Proofer icon or a Proofer recipe and verify the Proofer lights turn ON and verify fault messages are not displayed in the top tool bar of the display. Go to the Troubleshooting Guide if Proofer light do not turn ON.

12. Touch / select the top right "info" button (circled exclamation point) on the display. Touch / select the upper left "User" icon. Touch / select the "System Status" button and verify input levels and output loads are functioning as expected.
13. Exit to the PIN code screen and program the prior recorded recipe names and set points if they are different from the new Main Control Module Assembly's recipe settings.
14. Allow the unit to run until Preheat cycles are complete and the Oven and Proofer are in "READY" modes. Verify Proofer RH is active via proofer door glass visual. Verify Oven and Proofer temperatures reasonably correlate with other temperature measurement equipment.



NOTE: The units controls and sensors are high precision and should not require to be recalibrated. Up to 10% variances between the measurement device and the units controls are most probably due to measurement equipment accuracy and not the units control system. Contact Duke Service should any sensor calibration questions arise.



Duke Manufacturing Co.
2305 N. Broadway
St. Louis, MO 63102

Phone: 314-231-1130
Toll Free: 1-800-735-3853
Fax: 314-231-5074

www.dukemfg.com