

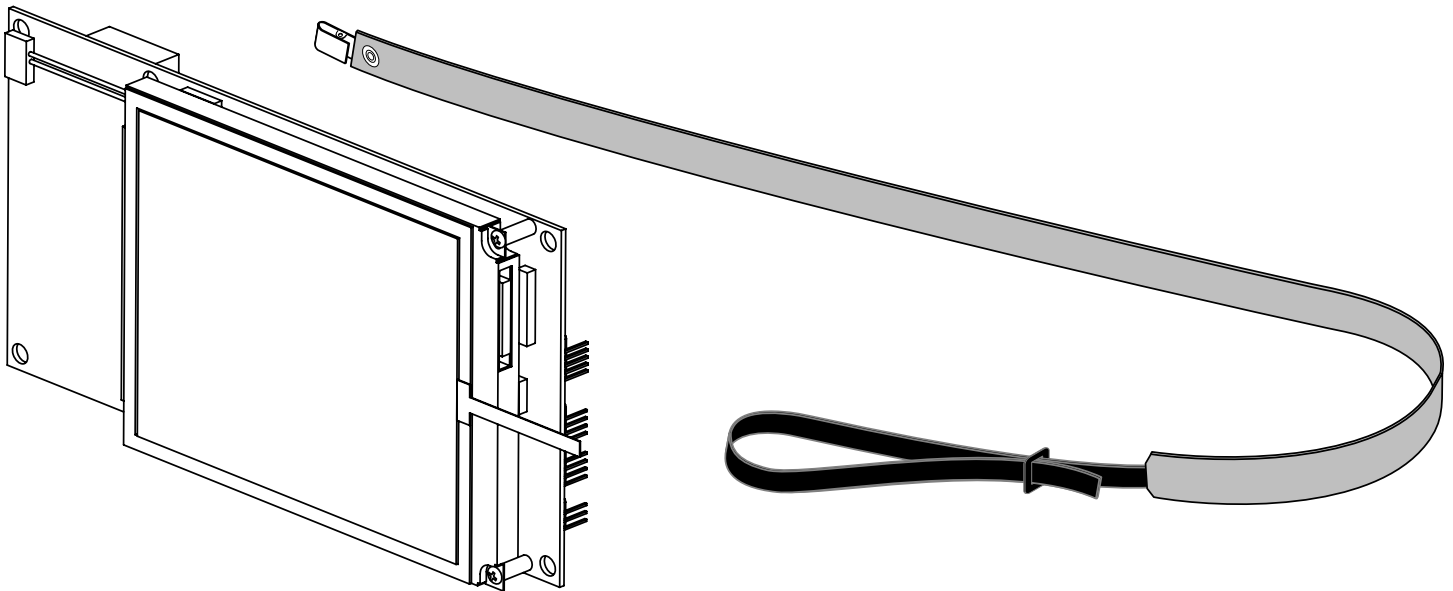

Your Solutions Partner

Installation Instructions

TSC PROOFER OVEN CONTROLLER REPLACEMENT INSTRUCTIONS FOR DUKE KIT# 600183`



CAUTION: Please read this manual completely before attempting to install, operate or service this equipment

*This manual is Copyright © 2017 Duke Manufacturing Co. All rights reserved.
Reproduction without written permission is prohibited. Duke is a registered
trademark of the Duke Manufacturing Co.*

Duke Manufacturing Co.

2305 N. Broadway
St. Louis, MO 63102
Phone: 314-231-1130
Toll Free: 1-800-735-3853
Fax: 314-231-5074

www.dukemfg.com

P/N 512417
REV E 11/10/2017

TABLE OF CONTENTS

Tools needed for Installation..... 2

Important Safety Instructions..... 2-3

Removing Old Control 4

Installing New Control..... 5

Tools Needed for Installation

Items required for this installation:

- Phillips screw driver
- Sheet Metal Vise Grips
- ESD Wrist Strap (Included with Kit)



IMPORTANT SAFETY INSTRUCTIONS

Throughout this manual, you will find the following safety words and symbols that signify important safety issues with regards to operating or maintaining the equipment.

WARNING

Indicates a hazardous situation which, if not avoided, could result in death or serious injury.

CAUTION

Indicates a hazardous situation which, if not avoided, could result in minor or moderate injury.

CAUTION

Indicates Important Information



Indicates electrical shock hazard which, if not avoided, could result in death or serious injury and/or equipment damage.



Indicates hot surface which, if not avoided, could result in minor or moderate injury.

CAUTION

Electrical shock hazard. Do not wash with water jet or hose.



Your Solutions Partner

In addition to the warnings and cautions in this manual, use the following guidelines for safe operation of the unit.

- Read all instructions before using equipment.
- For your safety, the equipment is furnished with a properly grounded cord connector. Do not attempt to remove or disconnect the grounded connector.
- Install or locate the equipment only for its intended use as described in this manual.
- Do not use corrosive chemicals in this equipment.
- Do not use caustic cleaners, acids, ammonia products or abrasive cleaners or abrasive cloths. These can damage the stainless steel and plastic surfaces.
- Do not operate this equipment if it has a damaged cord or plug, if it is not working properly, or if it has been damaged or dropped.
- This equipment shall be serviced by qualified personnel only. Contact the nearest Duke authorized service facility for adjustment or repair.
- Do not block or cover any openings on the unit.
- Do not immerse cord or plug in water.
- Keep cord away from heated surfaces.
- Do not allow cord to hang over edge of table or counter.
- If the supply cord is damaged, it must be replaced by a special cord assembly available from Duke Manufacturing Co. or its service agent.

Note: Refer to the specifications data plate when ordering or replacing a cord set.

The following warnings and cautions appear throughout this manual and shall be carefully observed.

- Turn the unit off, disconnect the power source and allow unit to cool down before performing any service or maintenance on the unit.
- The procedures in this manual may include the use of chemical products. You must read the Material Safety Data Sheets before using any of these products.
- The unit shall be grounded according to local electrical codes to prevent the possibility of electrical shock. It requires a grounded receptacle with dedicated electrical lines, protected by fuses or circuit breaker of the proper rating, in accordance with all applicable regulations.
- Disposal of the unit must be in accordance with local environmental codes and/or any other applicable codes.
- This appliance is not intended for use by persons (including children) with reduced physical, sensory or mental capabilities, or lack of experience and knowledge, unless they have been given supervision or instruction concerning use of the appliance by a person responsible for their safety.
- CAUTION: Never use a high-pressure water wash for this cleaning procedure as water can damage electrical components



A. Removing The Old Control

1. Turn unit off with Control Power Switch and turn off external mains supply disconnect. Use Lock/Out Tag/Out procedures if needed. **DO NOT UNPLUG UNIT.**
2. Loosen 3 screws and remove upper screw on both sides of the electrical compartment to access TSC Controller.



HAZARDOUS VOLTAGE RISK OF ELECTRIC SHOCK

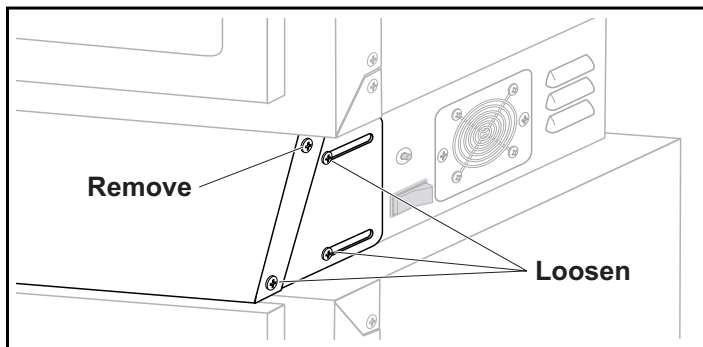

3. Pull forward then pivot down controller access cover.

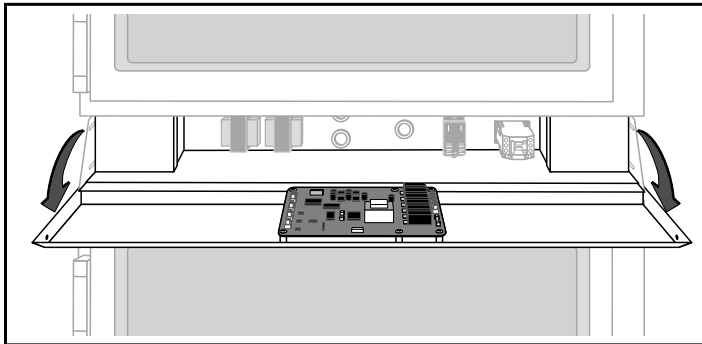

4. Place ESD strap on wrist and tighten. Strap must be tight around wrist to be effective.

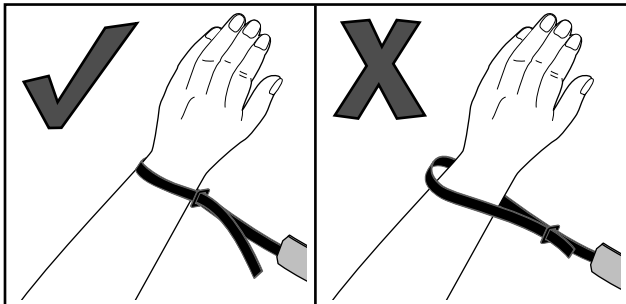

5. Connect ESD Wrist strap to Unit in location shown.

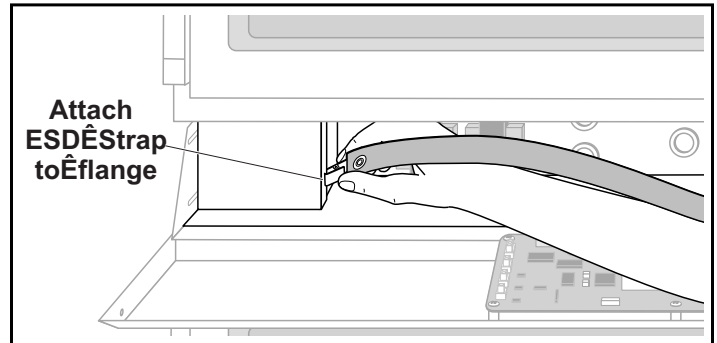

6. Remove 7 Connectors from TSC Control board starting with the power supply connection. The power supply connection is on the right side of the board.

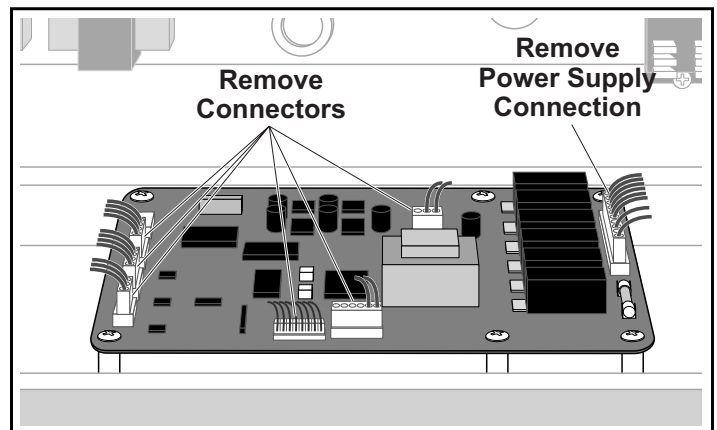

7. Remove six screws holding TSC Controller in place. Remove old controller and set aside.

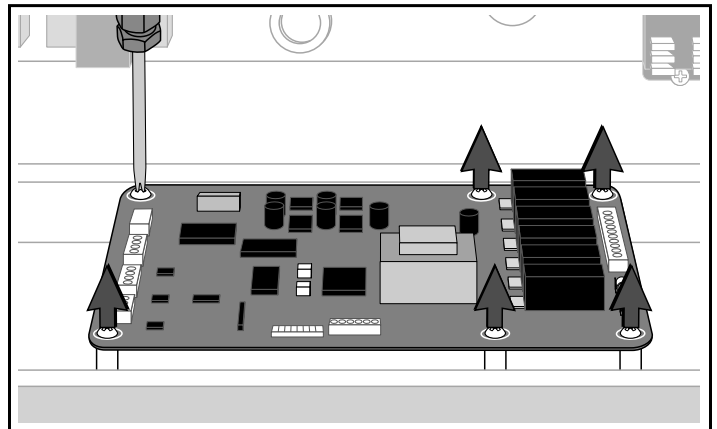

B. Installing the New Control

1. Remove new TSC Controller from box and silver static bag.

CAUTION GLASS DISPLAY

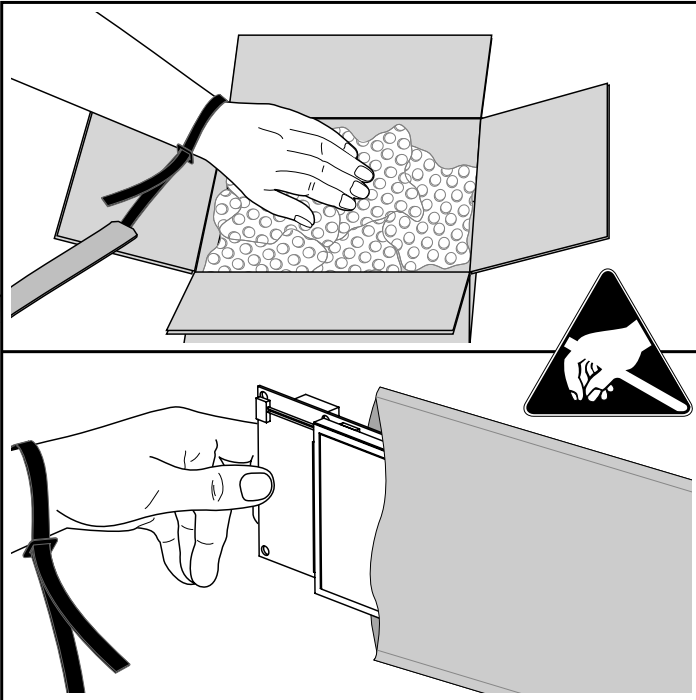

2. Remove thin plastic protector from glass if necessary. Make sure display and inner overlay are clean using a lint free cloth.

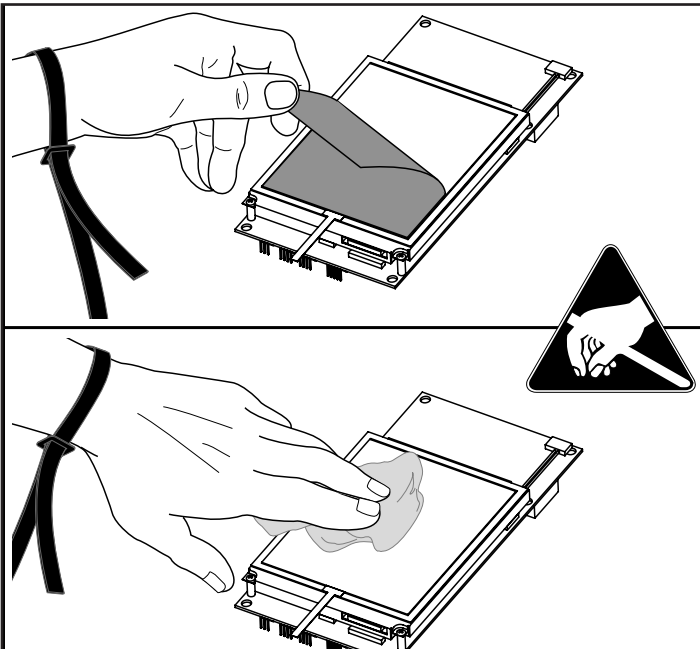

3. Using a pair of sheet metal vise grips, bend the metal flange on the oven to the rear so the components on the new control board will not touch the metal flange when closed up.

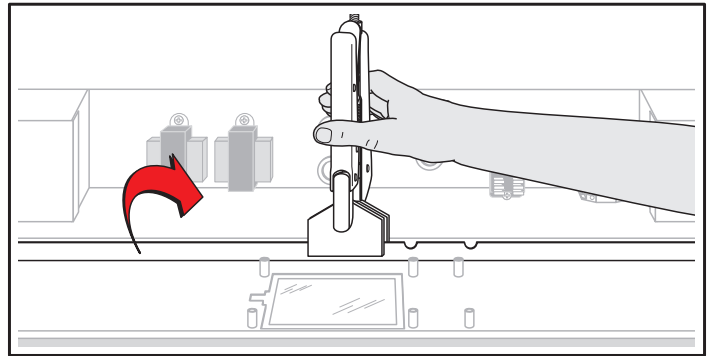

4. Set in place on frame.

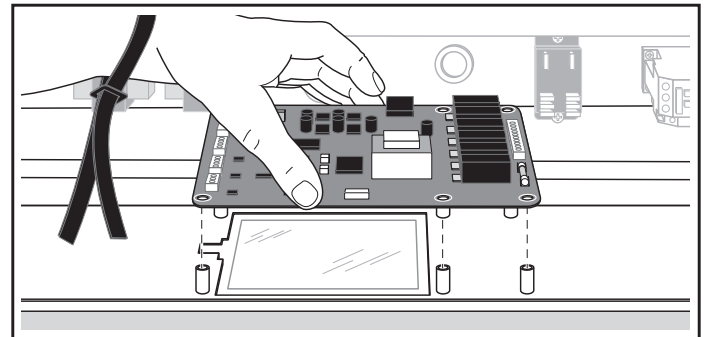

CAUTION

5. Before securing control board, confirm that the small circuit board on the bottom of the main control is not touching the metal flange at the bottom of the fold down front panel. If it is repeat step 3 above until it is not touching.



B. Installing the New Control - continued

6. Reinstall six screws. Make sure screws are centered in white circle outline to insure proper placement of TSC controller.

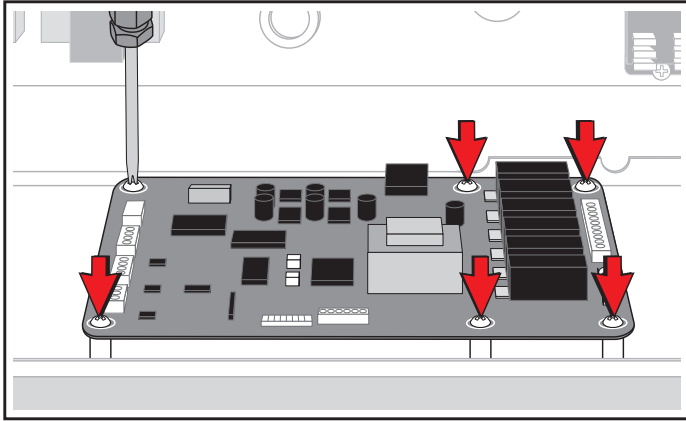

NOTE: Proper alignment of screw in TSC control board

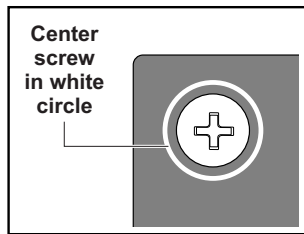

8. Pivot up control housing, push in and replace two top screws and tighten all 8 screws. Pivot up control housing, push in and replace two top screws and tighten all 8 screws.

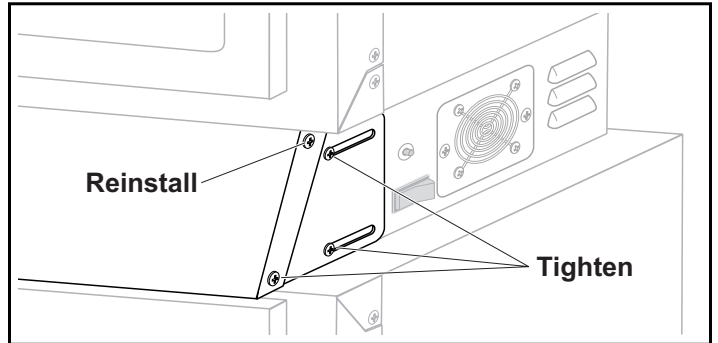
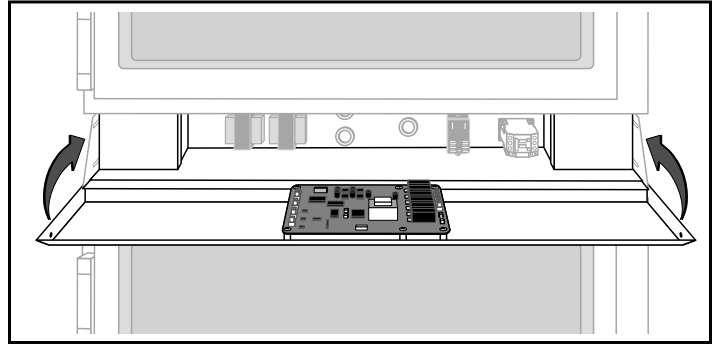

7. Reconnect seven wire harnesses.

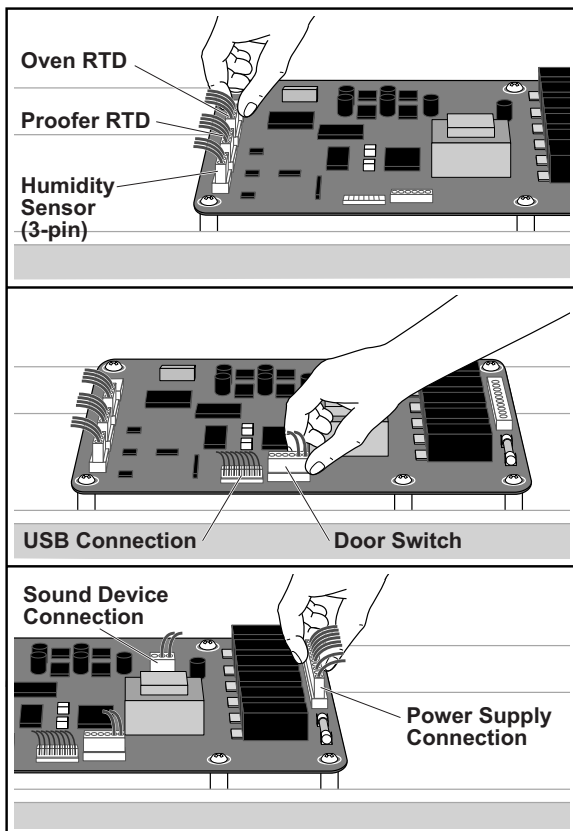

9. Turn on Mains then turn on Control Power Switch. Verify display power & software version. Turn on oven & proofer. Verify lights turn on. Verify screen contrast. See Contrast Adjustment Process to make any needed adjustments.



Duke Manufacturing Co.

Duke Corporate, Canada, Latin America
2305 N. Broadway
St. Louis, MO 63102
Phone: 314-231-1130
Toll Free: 800-735-3853
Fax: 314-231-5074
www.dukemfg.com

Duke EMEA - Europe, Middle East, Africa, Russia
Duke Manufacturing CR, s.r.o.
Zdebradska 92
Jazlovice, Ricany
Building number DC 4 on the
ProLogis Park Prague D1 West
Prague 251 01
Czech Republic
Phone: +420 257 741 033
Fax: +420 257 741 039

Duke EMEA – UK, Ireland, Nordic Countries
Duke Manufacturing UK Ltd.
Unit 10, Greendale Business Park
Woodbury Salterton
Exeter, EX5 1EW
Phone: +44 (0) 1395 234140
Fax: +44 (0) 1395 234154

Duke Asia Pacific
Duke Manufacturing
No.3 Building
Lane 28, Yu Lv Road
Malu Town, Jiading District
Shanghai 201801, China
Phone: +86 21 59153525 / 59153526
Fax: +86 21 33600628



Your Solutions Partner

Duke Manufacturing Co.

2305 N. Broadway
St. Louis, MO 63102
Phone: 314-231-1130
Toll Free: 1-800-735-3853
Fax: 314-231-5074
www.dukemfg.com