

# ESPLOSO\_Esploso\_Atom\_W\_65

18/03/2024

ESGR-2592-02v2410

220V - 60Hz

230/240V - 50Hz

110V - 60Hz

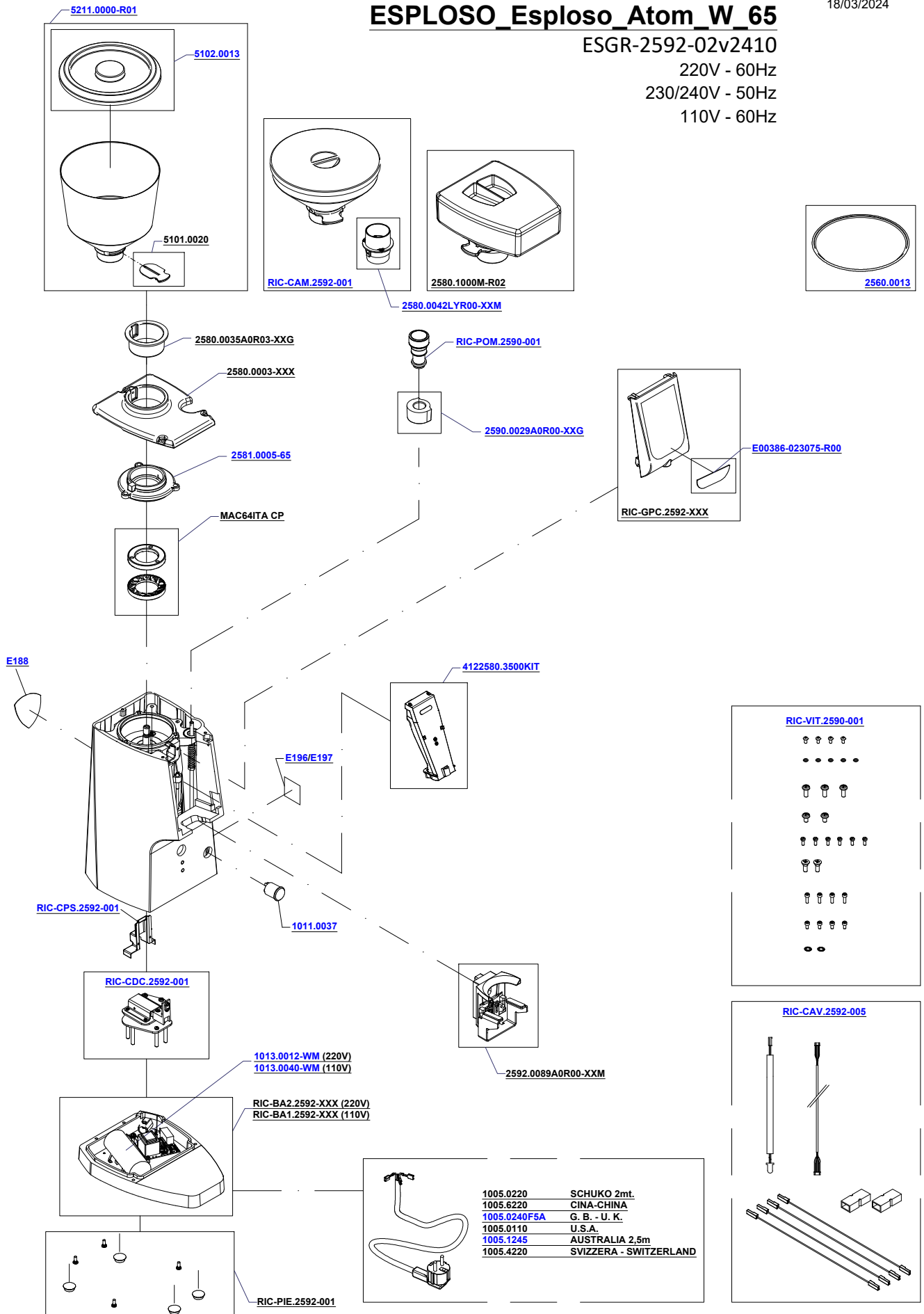

N.B. : DOVE INDICATO CON "XXX" SI RICHIEDE DI SPECIFICARE IL COLORE  
 PLEASE NOTE : WHERE "XXX" IS INDICATED YOU HAVE TO SPECIFY THE COLOUR



**YOUR COFFEE  
EXPERIENCE**

**Listino ricambi/ Spare Parts Price List  
ATOM W 65**

<b>ARTICOLO/ITEM N°</b>	<b>DESCRIZIONE/DESCRIPTION</b>
1005.0110	CABLAGGIO UL/CSA V110 USA/CANADA PLUG V110
1005.0220	CABLAGGIO MONOFASE spina schuko SCHUKO PLUG 2 mt V220
1005.0240F5A	CABLAGGIO VOLT. 240 per GB + fus. 5 AU.K. PLUG V230-240
1005.1245	CABLAGGIO VOLT. 240 per Australia 2,5mt AUSTRALIA PLUG V230-240 2,5mt
1005.4220	CABLAGGIO MONOFASE per Svizzera SWITZERLAND PLUG V220-230
1005.6220	CABLAGGIO MONOFASE per Cina CHINA PLUG V220-230
1011.0037	INTERRUTTORE ANTIVANDALO 15A ANTI-VANDAL SWITCH
1013.0012-WM	COND. 12MF 600Vac 50/60Hz S2 (UL) CAPACITOR 12 $\mu$ F
1013.0040-WM	COND. 40MF 250Vac 50/60Hz (UL) CAPACITOR 40MF 250Vac 50/60Hz (UL)
2560.0013	PIATTINO ACCIAIO/INOX RACCOGLI CAFFE' <b>STAINLESS STEEL COFFEE GROUNDS TRAY</b>
2580.0003-001	COPERCHIO ATOM VERN. NERO OPACO TOP COVER (BLACK)
2580.0003-055	COPERCHIO ATOM VERN. GRIGIO new TOP COVER (GREY)
2580.0003-101	COPERCHIO ATOM VERNICIATO BIANCO TOP COVER (WHITE)
2580.0003-251	COPERCHIO ATOM VERN. ROSSO F. /RED TOP COVER (RED F. /RED)



**YOUR COFFEE  
EXPERIENCE**

## Listino ricambi/ Spare Parts Price List ATOM W 65

<b>ARTICOLO/ITEM N°</b>	<b>DESCRIZIONE/DESCRIPTION</b>
2580.0003-951	COPERCHIO ATOM CROMATO TOP COVER (CHROME)
2580.0035A0R03-XXG	GUARNIZIONE CAMPANA x ATOM BEAN HOPPER SEAL
2580.0042LYR00-XXM	ADATT LATTA ILLY + ADATT CAMPANA x ATOM ILLY CAN ADAPTER + BELL ADAPTER x ATOM
2580.1000M-R02	CAMPANA completa ATOM confezionata REV 2 ATOM PACKED BELL REV 2
2581.0005-65	PORTAMACINE SUP. 65mm ATOM AG/05 UPPER BURR HOLDER 65mm
2590.0029A0R00-XXG	GUARNIZIONE POMELLO ATOM EXC/BAR ATOM KNOB SEAL
2592.0089A0R00-XXM	GRUPPO FORCELLA ATOM W 65/75 ATOM W 65/75 FORK GROUP
4122580.3500KIT	KIT GRUPPO SCIVOLO CAFFE' ATOM 65 COFFEE EXIT SLIDE GROUP
5211.0000-R01	CAMPANA COMPLETA ZENITH CLUB R01 BEAN HOPPER
E00386-023075-R00	ETICHETTA ATOM W 65 LABEL ATOM W 65
E188	ETICHETTA SCUDETTO "EUREKA 1920" R/W EUREKA 1920 ATOM LABEL
MAC64ITA CP	COPPIA MACINA PIANA mm.65 HS FLAT BURRS SET 65mm
RIC-BA1.2592-002	RIC. BASE110 ATOM_W_65 C.001 RIC. BASE110 ATOM_W_65 C.001
RIC-BA1.2592-003	RIC. BASE110 ATOM_W_65 C.055 RIC. BASE110 ATOM_W_65 C.055



**YOUR COFFEE  
EXPERIENCE**

**Listino ricambi/ Spare Parts Price List  
ATOM W 65**

<b>ARTICOLO/ITEM N°</b>	<b>DESCRIZIONE/DESCRIPTION</b>
RIC-BA1.2592-004	RIC. BASE110 ATOM_W_65 C.101 RIC. BASE110 ATOM_W_65 C.101
RIC-BA1.2592-005	RIC. BASE110 ATOM_W_65 C.251 RIC. BASE110 ATOM_W_65 C.251
RIC-BA1.2592-006	RIC. BASE110 ATOM_W_65 C.951 RIC. BASE110 ATOM_W_65 C.951
RIC-BA2.2592-005	RIC. BASE220 ATOM_W_65 C.001 RIC. BASE220 ATOM_W_65 C.001
RIC-BA2.2592-006	RIC. BASE220 ATOM_W_65 C.055 RIC. BASE220 ATOM_W_65 C.055
RIC-BA2.2592-007	RIC. BASE220 ATOM_W_65 C.101 RIC. BASE220 ATOM_W_65 C.101
RIC-BA2.2592-008	RIC. BASE220 ATOM_W_65 C.251 RIC. BASE220 ATOM_W_65 C.251
RIC-BA2.2592-009	RIC. BASE220 ATOM_W_65 C.951 RIC. BASE220 ATOM_W_65 C.951
RIC-CAM.2592-001	RIC. CAMPANA BASSA_ATOM_W_75+ADATT. RIC. BELL LOW_ATOM_W_75+ADAPT.
RIC-CAV.2592-005	RIC. CAVI ATOM_W_65_220V/110V RIC. CABLES ATOM_W_65_220V/110V
RIC-CDC.2592-001	RIC. CELLA DI CARICO ATOM_W_65/75 RIC. LOAD CELL ATOM_W_65/75
RIC-CPS.2592-001	RIC. CARTER PROTEZ. SK ATOM_W_65/75 RIC. CARTER PROTECTION. SK ATOM_W_65/75
RIC-GPC.2592-005	RIC. GR.PANN.COMANDI_ATOM W 65 C.001 RIC. GR.PANN.CONTROLS_ATOM W 65 C.001
RIC-GPC.2592-006	RIC. GR.PANN.COMANDI_ATOM W 65 C.101 RIC. GR.PANN.CONTROLS_ATOM W 65 C.101



**YOUR COFFEE  
EXPERIENCE**

## Listino ricambi/ Spare Parts Price List ATOM W 65

<b>ARTICOLO/ITEM N°</b>	<b>DESCRIZIONE/DESCRIPTION</b>
<a href="#">RIC-GPC.2592-007</a>	RIC. GR.PANN.COMANDI_ATOM W 65 C.055 RIC. GR.PANN.CONTROLS_ATOM W 65 C.055
<a href="#">RIC-GPC.2592-008</a>	RIC. GR.PANN.COMANDI_ATOM W 65 C.251 RIC. GR.PANN.COMMANDS_ATOM W 65 C.251
<a href="#">RIC-GPC.2592-009</a>	RIC. GR.PANN.COMANDI_ATOM W 65 C.951 RIC. GR.PANN.CONTROLS_ATOM W 65 C.951
<a href="#">RIC-PIE.2592-001</a>	RIC. PIEDINI BASE ATOM_W_110/220V RIC. BASE FEET ATOM_W_110/220V
<a href="#">RIC-POM.2590-001</a>	RIC. POMELLO_ATOM EXCELLENCE_STD ATOM EXCELLENCE KNOB
<a href="#">RIC-VIT.2592-001</a>	RIC. KIT VITI_ATOM_W_65/75 RIC. KIT SCREWS_ATOM_W_65/75

- Gli articoli evidenziati sono i ricambi delle parti soggette a maggiore usura, e quindi il loro approvvigionamento è particolarmente consigliato
  - Tutti i prezzi si intendono IVA esclusa
  - La merce viene venduta franco fabbrica a Sesto Fiorentino (FI) e viaggia a rischio del committente.
- The items highlighted are the spare parts of the pieces subject to greater wear, and therefore their supply is particularly recommended
  - All prices are intended VAT excluded
  - Goods are sold ex works from Sesto Fiorentino (FI), Italy and travel at the risk of the Customer