

A	SAFETY INSTRUCTIONS	Page 4
B	GENERAL RECOMMENDATIONS	Page 5
B1.	Handling	Page 5
B2.	Unpacking	Page 5
B3.	Disposal	Page 5
B4.	Technical data	Page 6
C	INSTRUCTIONS FOR THE INSTALLER/MAINTENANCE PERSON	Page 7
C1.	Water connection	Page 7
C2.	Electrical connection	Page 7
C3.	Warning messages displayed on the control panel	Page 8
C4.	Detergent/rinse-aid dispensers and settings	Page 9
C5.	Setting the dispensers	Page 10
C6.	Maintenance	Pag. 11
D	INSTRUCTIONS FOR THE USER	Page 12
D1.	Starting	Page 12
D2.	Wash cycles	Page 13
D3.	Operation	Page 13
D4.	End of work and daily cleaning	Page 13
D5.	Warning messages displayed on the control panel	Page 14
E	TROUBLESHOOTING	Page 15

To reduce the risk of fire, electrical shock, or injury when using your dishwasher, follow basic precautions including the following:

- Read all instructions before using your dishwasher.
- This Manual does not cover every possible condition and situation that may occur. Use common sense and caution when installing, operating and maintaining any appliance.
- Keep children and infants away from dishwasher when it is operating.
- Do not let children abuse, sit, stand or play on door or racks of a dishwasher.
- Store dishwasher detergent and rinse agents out of the reach of children.
- Do not store or use combustible materials, gasoline or other flammable vapors and liquids in the vicinity of this or any other appliance.
- Your dishwasher uses hot water to clean and sanitize a variety of wares. Machine surfaces and wares become hot during and immediately following normal operations. Operators should use caution when loading and unloading wares from the machine.
- Do not touch the heating element during or immediately after use.
- The installation of this unit must conform to local codes or, in the absence of local codes, to all National Codes governing plumbing, sanitation, safety and good trade practices.
- Before servicing, disconnect the electrical service and place a red tag at the disconnect switch to indicate work is being done on that circuit.

**SAVE THESE
INSTRUCTIONS**

B

GENERAL RECOMMENDATIONS

WARNING:

CAREFULLY READ THE INSTALLATION, OPERATING AND MAINTENANCE INSTRUCTIONS BEFORE INSTALLING THIS APPLIANCE. INCORRECT INSTALLATION, ADAPTATIONS OR ALTERNATIONS COULD CAUSE DAMAGE TO PROPERTY OR INJURY TO PERSONS. MALICIOUS DAMAGE, DAMAGE DUE TO NEGLIGENCE, OR TO FAILURE TO COMPLY WITH INSTRUCTIONS AND REGULATIONS, OR TO INCORRECT CONNECTIONS OR UNAUTHORISED TAMPERING INVALIDATE ANY WARRANTY AND RELIEVE THE MANUFACTURER OF ALL LIABILITY.

1. Carefully read this instructions booklet, as it contains important advice for safe installation, operation and maintenance.
Keep this booklet to hand in a safe place for future reference by other operators.
2. **Installation should be carried out by qualified engineers, in accordance with current regulations and with the manufacturer's instructions.**
3. The appliance should only be used by persons specifically trained in this operation.
4. Switch off the appliance in the event of failure or malfunctioning.

Only have the appliance repaired by a service centre authorised by the manufacturer and ask for original spare parts.

B1. HANDLING

Use suitable means to move the appliance: a lift truck or fork pallet trucks (the forks should reach more than halfway beneath the appliance).

B2. UNPACKING

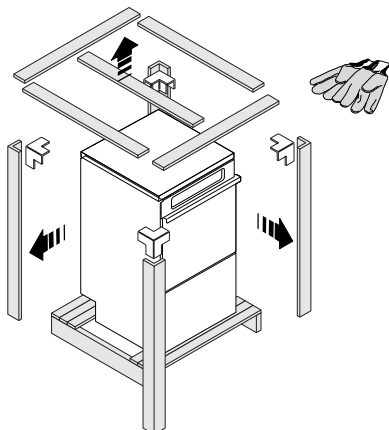

Wear protective gloves to unpack.

Lift the appliance using a lift truck,

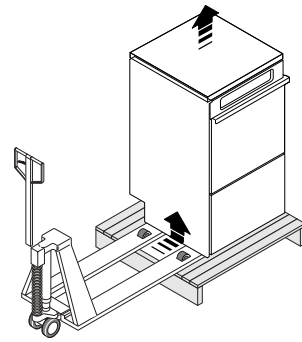

remove the base and position the appliance where it is to be installed.

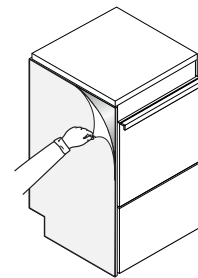

Remove the protective film and ensure that the packaging material is disposed of correctly in compliance with the regulations in force in the country where the product is to be used.

B3. DISPOSAL

All the packaging materials are environment friendly. They may be kept without danger, recycled or burned in a special waste incineration plant. Recyclable plastic components are marked as follows:



polyethylene: external wrapping film, instruction bag.



polypropylene: top packaging panels, straps.



polystyrene foam: protective surround elements.

Wood and cardboard components may be disposed of according to local regulations in force. Appliances that have reached the end of their service life should be suitably disposed of. The appliance should be dismantled according to regulations in force. All metal parts are in stainless steel (AISI 304) and are removable. Plastic parts are marked with the symbol of the material.

B4. TECHNICAL DATA

MODEL		LS6AH / WT30H	LS6AH / WT30H
Supply voltage:	V	208 1N~	240 1N~
convertible to	V	208 3~	240 3~
Frequency	Hz	60	60
Max. power input	kW	6.85	6.85
Boiler heating elements	kW	6.0	6.0
Tank heating elements	kW	2.2	2.2
Water supply pressure	psi [kPa]	7.25 ...101 [50...700]	7.25 ...101 [50...700]
Water supply temp.	°F [°C]	122 [50]	122 [50]
Water supply hardness	ppm (CaCO ₃) [°fH]	140 [14] max	140 [14] max
Rinse cycle water consumption	gal. [l]	1 [3.8]	1 [3.8]
Boiler capacity	gal. [l]	3 [12]	3 [12]
Tank capacity	gal. [l]	6 [23]	6 [23]
Standard cycle time with water supply at 122 °F [50°C]	sec.	120-180-240	120-180-240
Legal noise level Leq	dB(A)	<65	<65
Protection rating		IP X4	IP X4
Net weight	lb [kg]	150 [68]	150 [68]
MCA	A	34	30

	208V 1N or 240V 1N		208V 3~ or 240V 3~	
	C	S	C	S
6,85 kW	3WIRES AWG8 [8,35 mm ²] Type SOOW	40A 1P+N	4WIRES AWG10 [5,27 mm ²] Type SOW	25A 3P

C = Power supply cable
S = On/Off switch

Standard cycle time may vary should the inlet water temperature be different from that indicated above.

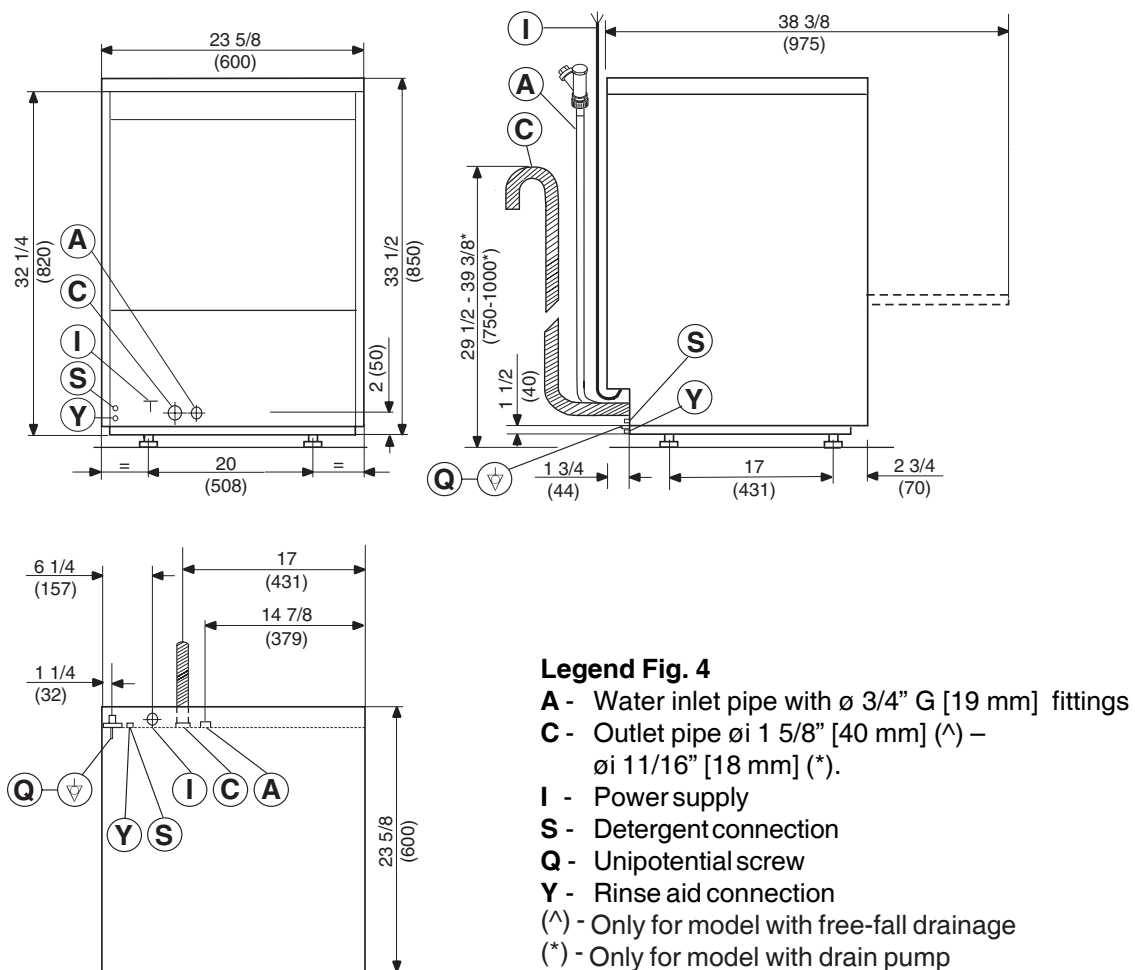

Fig. 4

C INSTRUCTIONS FOR THE INSTALLER/MAINTENANCE PERSON

Install a disconnecting switch with a capacity at least equal to that given in the technical data table, a 30mA residual current circuit breaker and an overcurrent device (magnetothermal cut-out with manual reset or fuse) between the appliance and the mains power outlet.

RATING PLATE

The rating plate contains identification and technical data and is located on the right-hand side panel of the appliance (Fig. 5).

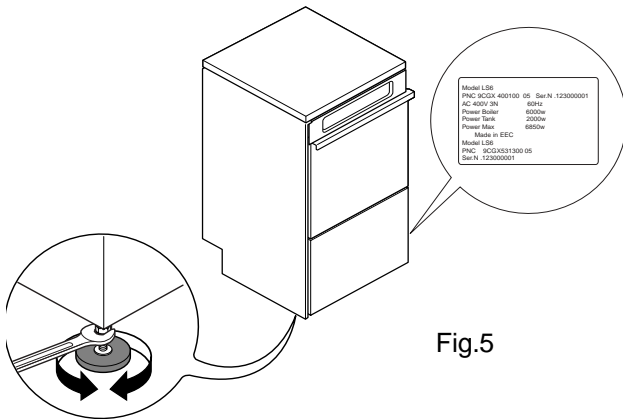

Fig.5

C1. WATER CONNECTION

- Position the dishwasher and level the appliance by turning the relative height-adjustable feet (Fig. 5).
- Connect the appliance water supply pipe "A" (Fig.4) to the mains, fitting a cut-off cock, the filter provided and a pressure gauge between the appliance and the mains (Fig. 6).

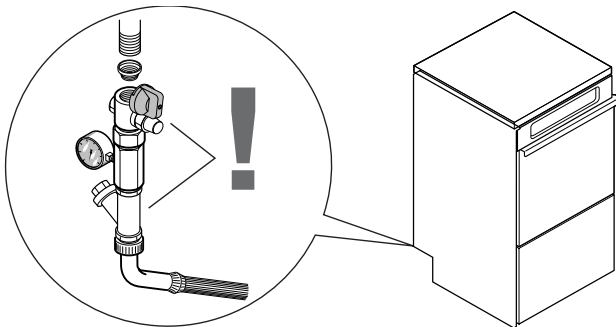

Fig.6

- Check that the **dynamic** water supply **pressure**, measured between the appliance and the main, **between 7.25 and 101 psi [50 and 700 kPa]** (test while dishwasher tank or boiler is filling with water).
If the pressure is too high, fit a suitable pressure reducer on the inlet pipe.

Position the outlet pipe at a height anywhere between 29 1/2" and 39 3/8" [750 and 1000 mm] from the floor. Check that about 1 gallon [4 litres] of water flow out of the outlet pipe during the rinse cycle.

Make sure drain hose does not kink or not squeeze/twist, resulting in a water flow restriction.

C2. ELECTRICAL CONNECTION

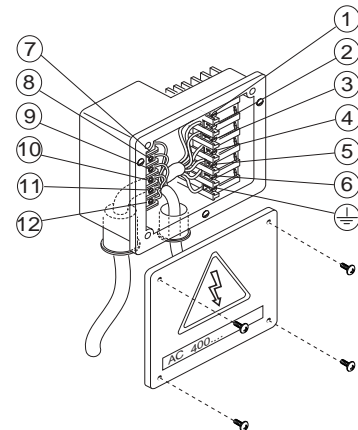

CAUTION: THE EARTH AND ELECTRICAL CONNECTIONS MUST BE IN COMPLIANCE WITH NATIONAL REGULATIONS.

The installation of this unit must conform to local codes or, in the absence of local codes, to all National Codes governing plumbing, sanitation, safety and good trade practices.

- Before carrying out the electrical connection, check that the voltage and frequency on the appliance rating plate correspond to those of the mains electricity supply.
- The earth wire at the terminal end must be longer (max. 3/4" [20 mm]) than the phase wires.
- Connect the earth wire of the power supply cable to an efficient earth clamp. The appliance must also be included in a unipotential system, the connection being made through the screw "Q" (Fig.4) marked with the symbol "⏏". The unipotential wire must have a cross section of AWG 8 [8,35 mm²].

WARNING: Before servicing, disconnect the electrical service and place a red tag at the disconnect switch to indicate work is being done on that circuit.

Power supply 208V 1N or 240V 1N

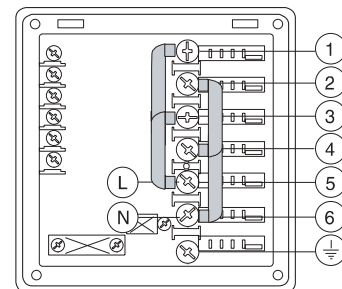

Open the power supply terminal board and insert the jumpers provided as follows: two jumpers between terminals 1, 3, 5 and another two between terminals 2, 4 and 6. Using a suitable power supply cable (see technical data table), connect the phase and neutral to terminals 5 and 6 respectively and the earth wire to the terminal ⏏.

Power supply 208V 3 or 240V 3

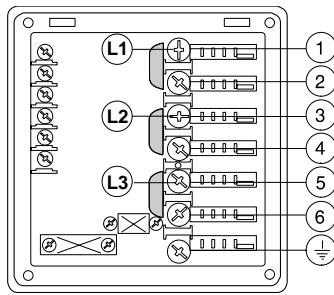

Open the power supply terminal board and insert the jumpers provided as follows: one jumper between terminals 1 and 2, one between terminals 3 and 4 and another between terminals 5 and 6. Using a suitable power supply cable (see technical data table), connect the three phases to terminals 1, 3 and 5 and the earth wire to the terminal \perp .

Connections provided for energy control.

This appliance is designed for an external energy consumption control.

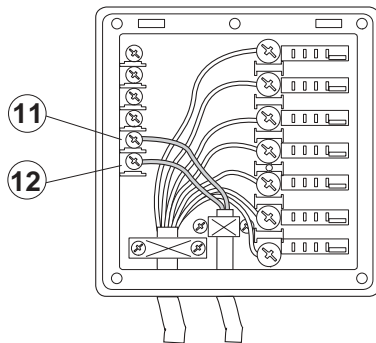

Connect the energy peak controller across terminals 11 and 12.



CAUTION: A normally open (n.o.) contact of the controller must be connected across terminals 11 and 12. When this contact closes the boiler heating elements are disconnected. Using the dishwasher in these conditions may increase the cycle time.

Safety devices

- An automatic reset thermoamperometric protective device incorporated in the windings of the electric pump cuts off the electricity supply in the case of malfunctioning.
- In the event of water mains failure, a device prevents water in the boiler from returning into the mains.
- An overflow pipe, connected to the drainage outlet, maintains the water in the tank at a constant level.
- On models with a drain pump, a supplementary level control device activates if the main level control device is faulty.

Failure to comply with safety rules and regulations relieves the manufacturer of all liability.

C3. WARNING MESSAGES DISPLAYED ON THE CONTROL PANEL

A1 NO WATER

- Check that the cock is open
- Check that the water inlet filter is clean
- Check the minimum mains pressure (not less than 7.25 psi [50 kPa])
- Check that the overflow pipe is inserted (for appliances without drain pump only)

B1 INEFFICIENT DRAINAGE

- Check if the overflow has been removed.
- Check for obstruction on the waste outlet pipe and the overflow aperture.

B2 TANK WATER LEVEL TOO HIGH

- Check for obstruction on the waste outlet pipe and the overflow aperture.

C1..C8 CALL THE SERVICE CENTRE

E1..E8 CALL THE SERVICE CENTRE

- The appliance continues to operate, but appropriate checks by a technician are recommended.

C4. DETERGENT/RINSE-AID DISPENSERS AND SETTINGS

If the appliance is connected to a water softener or osmotic device, contact the detergent supplier for a specific product. Peristaltic dispensers (rinse-aid and detergent) require periodic maintenance. The internal hose of the rinse-aid dispenser should undergo periodic maintenance (at least once or twice a year).

1) Dishwasher with incorporated detergent dispenser pump (Fig. 10)

Pump "R" dispenses about 0.021 oz/s [0.6 g/s] of detergent. When the appliance is filled with water for the first time in the day, it dispenses 1.058 oz [30 g] of detergent in 50 sec., thereby providing a concentration of 0.046 oz/qt [1.3 g/l]. Pump "R" dispenses 0.169 oz [4.8 g] in 8 sec. at each cycle. Dispenser operating time may be changed, following the instructions given in the next paragraph. Insert the hose provided in the kit into the detergent container.

2) Dishwashers with incorporated peristaltic rinse-aid dispenser pump (Fig. 10)

Pump "S" dispenses about 0.0046 oz/s [0.13 g/s] of rinse-aid. It dispenses 0.018 oz [0.52 g] in 4 sec. at each rinse. Dispenser operating time may be changed, following the instructions given in the next paragraph. Insert the hose provided in the kit into the rinse-aid container (in the versions without incorporated rinse-aid dispenser only).

Connections for automatic detergent dispenser (Fig. 10)

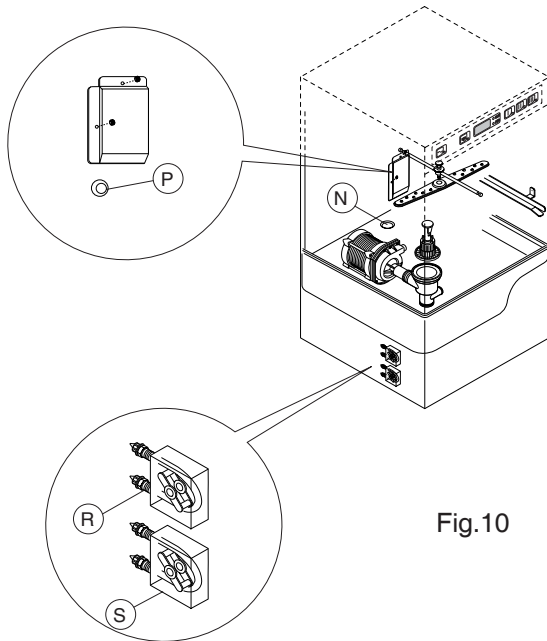

Fig. 10

There is a ready-made impression "N" to be perforated (Ø 5/16" [8 mm]) for positioning the detergent concentration measuring sensor.

Inside the tank there is a hole "P" (Ø 3/8" [10 mm]) closed with a plug, which may be used for mounting a liquid detergent injector.

The sensor and liquid detergent injector should be installed without prejudicing the watertightness of the appliance.

Electrical connections for automatic detergent and rinse-aid dispensers.

Terminals are available on the power supply terminal board

for the electrical connection of external dispensers working at 208V or 240 V. Max. power 30 VA.

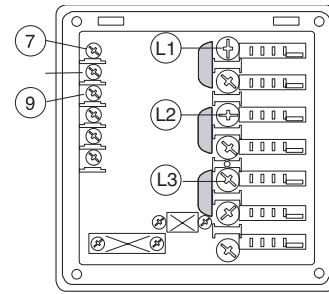

· Connect the **detergent dispenser** between terminals 7 and 9. These connection points are live for a set time during filling of the tank and at the start of the wash cycle (see paragraph "Setting the dispensers").

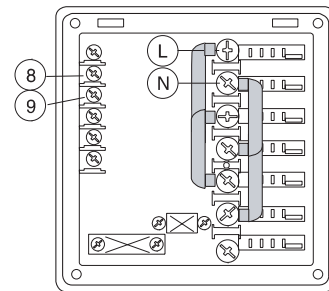

· Connect the **rinse-aid dispenser** between terminals 8 and 9. These connection points are live during filling of the tank and at the end of the rinse cycle for a set time (see "setting the dispensers" paragraph).

MANUAL ACTIVATION

Whenever the detergent containers are replaced, it may be necessary to activate the dispensers manually in order to fill the hoses and eliminate any air.

Simultaneously press the buttons, as shown in the figures below. If necessary, repeat this operation several times.

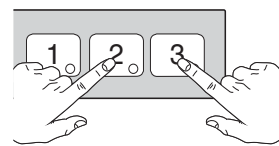

DETERGENT DISPENSER

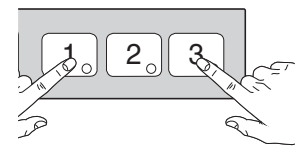

RINSE-AID DISPENSER

In the appliances with pressure boiler, the diaphragm dispenser pump may be manually activated by pressing screw "D" (Fig. 10).

C5. SETTING THE DISPENSERS

1) Peristaltic dispensers

All operations should be carried out with the appliance switched on, the door open and no cycle selected.

LEGEND

↑ = increase

↓ = decrease

☞ = confirm or select next parameter

SEQUENTIAL START

Press the indicated buttons simultaneously for 5 seconds:



Display of programming mode:

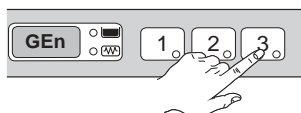

Initial amount of detergent:



Setting the activation time:

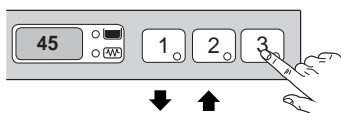

Initial amount of rinse-aid:



Setting the activation time:

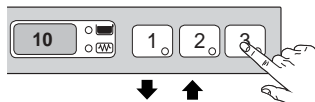

Amount of detergent during the cycle:



Setting the activation time:

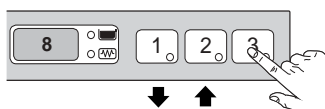

Amount of rinse-aid during the cycle:



Setting the activation time:

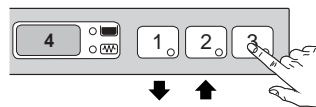

Exit from programming mode:

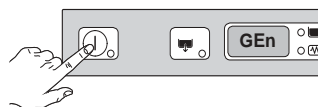

Notes for external dispensers:

- if **dEt = 181** the **detergent dispenser** only operates during **wash pump** operation; terminals **7-9** of the main terminal board are powered at the same time.
- if **dEt = 182** the **detergent dispenser** only operates during **filling electrovalve** operation for restoring the boiler level; terminals **7-9** of the main terminal board are powered at the same time.
- if **rAi = 61** the **rinse-aid dispenser** only operates during **filling electrovalve** operation for restoring the boiler level; terminals **8-9** of the main terminal board are powered at the same time.
- if **rAi = 62** the **rinse-aid dispenser** only operates during **wash pump** operation; terminals **8-9** of the main terminal board are powered at the same time.

For connections, see the wiring diagram.

Example:

Supposing that an external detergent dispenser has been connected with a tank concentration measuring sensor, a standard setting could be as follows:

dIn = 0 the dispenser is not activated during filling of the tank

dEt = 181 the dispenser is activated during wash pump operation and, thanks to the concentration measured by the conduction sensor, the correct amount of detergent is dispensed.

Suggestion: to check the effectiveness of the rinse-aid, look at freshly washed glasses against the light. Drops of water remaining on the glass indicate an insufficient amount while streaks indicate an excess.

Changing the detergent/rinse-aid type.

If changing to a **different detergent/rinse-aid type** (even one by the same manufacturer), you must rinse the suction and pressure hoses with fresh water before connecting the new detergent/rinse-aid container. Otherwise, the mixing of different types of detergent/rinse-aid will cause crystallisation, which may result in a breakdown of the dosing pump. Failure to observe this condition will invalidate the guarantee and product liability.

C6. MAINTENANCE

- Descale the boiler, the internal surfaces of the tank and the appliance water piping once or twice a year.
- Descale the rinse and wash jets every month using vinegar or a descaling agent.
- The internal hose of the rinse-aid and detergent peristaltic dispenser should undergo periodic maintenance (once or twice a year).

Prolonged period of inactivity

If the dishwasher is not to be used for a long time, proceed as follows:

- Close the water supply cock.
- Completely drain the tank.
- Remove and carefully clean the filters.
- Completely drain the incorporated dispenser hoses, removing them from the containers. Repeat the procedure described in the paragraph "Manual activation" at least 3 times.
- Completely drain the boiler by simultaneously pressing the buttons as shown in the figure.

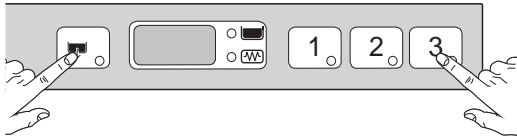

A buzzer indicates completion of drainage.

- Spread a thin film of Vaseline oil over all the stainless steel surfaces.

Preventive maintenance

The preventive maintenance call may be activated (see service manuals).

Upon reaching the set number of cycles (e.g. 20000),

CAII ☺ appears on the display.

This message advises calling a qualified technician for a general check-up of the state of the appliance.

D INSTRUCTIONS FOR THE USER

Our appliances have been studied and optimised to give high performance. This appliance must be used exclusively for the purpose for which it has been designed, i.e. for washing dishes with water and specific detergents. Any other use is to be considered improper.

This appliance does not carry out the rinse cycle should there be no supply water; it stops all functions with an error message "A1" (also see "Warning messages").

TIPS

- Carry out a couple of cycles without dishes to flush out any industrial grease which has remained in the tank and piping.
- Avoid washing decorated dishes.
- Do not allow silverware to come into contact with other metals.
- Do not allow food to dry on the dishes.
- Remove large food scraps from the dishes to prevent clogging the filters.
- Pre-wash the dishes by spraying them with cold or lukewarm water, without using any detergent.
- Use automatic dispensers for the detergent.
- If there is no automatic dispenser, pour a non-foaming detergent into the tank when the water has reached the washing temperature.

CONTROL PANEL

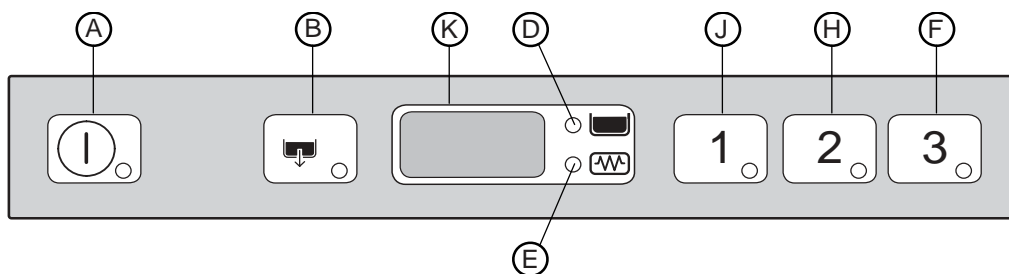

LEGEND:

A = on/off

B = drain/self-cleaning cycle

K = display

D = "tank" indicator light

Fig.11

E = "boiler" indicator light

J = wash cycle 1

H = wash cycle 2

F = wash cycle 3

The temperature shown on the display is that of the boiler if the indicator light "E" is on or of the tank if the light "D" is on. The tank temperature is displayed during the wash cycle and the boiler temperature during the rinse cycle.

D1. STARTING

- Open the water supply cock.
- Switch on at the mains.
- Open the door and check that all the components are in their correct position.
- Close the door and press button "A".

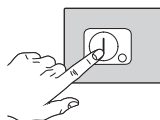

The indicator light of button "A" (Fig. 11) comes on, indicating that the dishwasher is powered and that water is being introduced and heated. The word "FILL" is shown on the display during the entire filling and heating stage:



through several consecutive hot rinse cycles, while the display shows the message FILL (flowing). This system let save up to 30% of time than traditional models.

If the door is opened during this stage the message "CLOSE" will appear on the display:



The filling and heating stage has finished when the display shows the tank temperature:

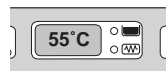

To display the boiler temperature during heating of the tank, open the door and press the button "J" (Fig. 11).

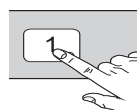

 **Warning**, this dishwasher does the first tank filling

D2. WASH CYCLES

The wash cycle includes one wash with hot water and detergent (min 150°F [66°C]) and one rinse with hot water and rinse-aid (min 180°F [82°C]).

Table of times

Standard cycle time with supply water at 122° F [50 °C].

LS6AH / WT30H	120''	180''	240''

A device lengthens the cycle time if the water in the boiler has not reached the minimum temperature for correct rinsing. The cycle times and the temperature may be personalised (e.g. increase of the rinse time and temperature). The cycle times should only be set by a specialised technician.

D3. OPERATION

The filling and heating stage has finished when the display shows the tank temperature:

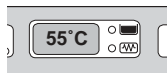

The appliance is then ready for use:

- Open the door.
 - Pour the required amount of detergent into the tank (in models without automatic dispenser).
 - Insert the rack containing the dirty dishes.
- Close the door and select the suitable wash cycle; the corresponding indicator light comes on and the wash cycle starts:

- Cycle I

For lightly soiled dishes: press button "J" (Fig. 11) (see table of times).

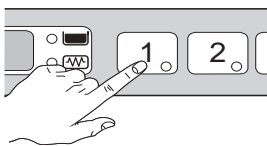

- Cycle II (recommended)

For normally dirty dishes: press button "H" (Fig. 11) (see table of times).

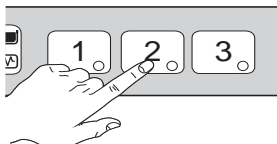

- Cycle III

For very dirty dishes: press button "F" (Fig. 11) (see table of times).

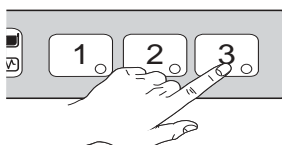

- To stop the wash cycle, just press the selected cycle button or open the door.
- To continue the wash cycle, just press the selected cycle button or close the door. The cycle starts again from where it stopped.
- At the end of the wash, the dishwasher emits a series of beeps and "END" blinks on the display:

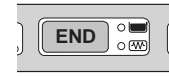

Open the door and remove the rack containing the clean dishes.

WARNING: The appliance will not remove burnt food deposits from dishes. Dishes with burnt-on food deposits should be cleaned mechanically/chemically (for example, pre-wash under running water) before putting them in the dishwasher.

Change the water in the tank at least twice a day.

Important: make sure the dishes are arranged in accordance with the manufacturer's instructions for the baskets being used.

D4. END OF WORK AND DAILY CLEANING

The appliance is designed to carry out an automatic cleaning cycle to help flush out any residues and to guarantee greater health and hygiene:

- Open the door and take out the rack containing the clean dishes.
- Remove the tank filters and the overflow "W".

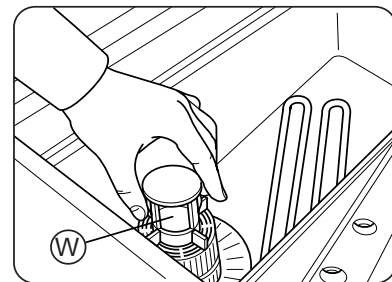

- Close the door.
- Select the drain cycle by pressing button "B" (Fig. 11).

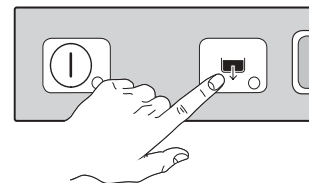

The message "CLE" ("CLEAN") will be displayed throughout the drain cycle:

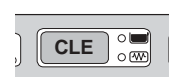

- After a few minutes, 3 beeps indicate the end of the cleaning cycle and “END” blinks on the display:



- Switch off the dishwasher by pressing button “A” (Fig. 11).

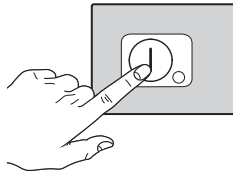

- Switch off at the mains.
- Close the water supply cock.
- Replace the filters and the overflow.
- Remove the top and bottom jets “F” and “I”, unscrewing the ring nut “H”.

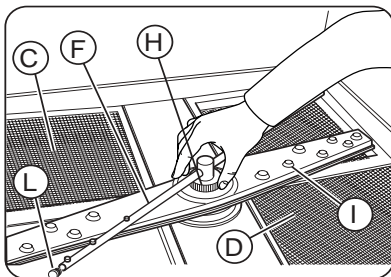

- Unscrew plugs “L” from the rinse jets and clean using a water spray. Do not use sharp implements to clean the nozzle holes, which could otherwise be damaged.
- Remove filters “C” and “D” and clean them under a water spray.
- Remove the filter “Z” and clean away any remained food in order to avoid blocking the draining system.

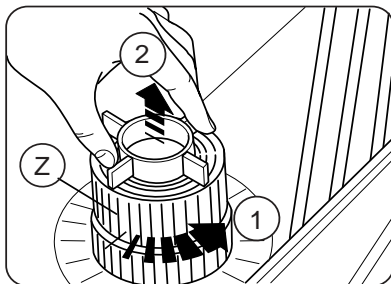

Upon completion of cleaning operations, replace the parts removed previously.

Cleaning the exterior surfaces

Before carrying out any cleaning operations, turn off the power at the mains.

Clean the stainless steel surfaces using warm soapy water; never use detergents containing abrasive substances nor steel scrapers, common wire wool, brushes or scrapers; rinse thoroughly using a wet cloth and carefully wipe dry. Clean the control panel using a soft damp cloth and a neutral detergent if necessary.

Do not wash the appliance using direct or high-pressure water jets. To reduce the emission of pollutants into the environment, clean the appliance (externally and where necessary internally) with products having a biodegradability of over 90%.

CAUTION: Never stand or sit on the door, not place heavy boxes or crates on the door.

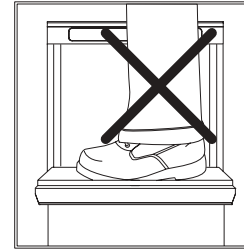

D5. WARNING MESSAGES DISPLAYED ON THE CONTROL PANEL

A1 NO WATER

- Check that the cock is open
- Check that the water inlet filter is clean
- Check the minimum mains pressure (not less than 7.25 psi [50 kPa])
- Check that the overflow pipe is inserted (for appliances without drain pump only)

B1 INEFFICIENT DRAINAGE

- Check if the overflow has been removed.
- Check for obstruction on the waste outlet pipe and the overflow aperture.

B2 TANK WATER LEVEL TOO HIGH

- Check for obstruction on the waste outlet pipe and the overflow aperture.

C1..C8 CALL THE SERVICE CENTRE

E1..E8 CALL THE SERVICE CENTRE

- The appliance continues to operate, but appropriate checks by a technician are recommended.

E TROUBLESHOOTING

DISHWASHER DOES NOT WASH WELL	<ol style="list-style-type: none"> 1) Check if the suction filter is dirty and clean it thoroughly. 2) Check if the wash jets are clogged by solid food remains. 3) Check that the initial amount of detergent or subsequent additions are correct. 4) The selected wash cycle is too short. Repeat the cycle. 5) Check that the tank temperature is between 131°F [55°C] and 150°F [65°C]. 6) Check that the dishes are stacked correctly in the racks.
GLASSES AND DISHES ARE NOT DRIED PROPERLY	<ol style="list-style-type: none"> 1) Only specialised technicians: check the instructions for the amount of rinse-aid. 2) Check that there is rinse-aid in the container and if necessary top up. 3) Only specialised technicians: check the set amount of rinse-aid. 4) Check that the water temperature is between 176°F [80 °C] and 194°F [90 °C].
CONDENSATION ON GLASSES	<ol style="list-style-type: none"> 1) Check that there is rinse-aid in the container and if necessary top up. 2) Only specialised technicians: check the set amount of rinse-aid. 3) Remove the rack of glasses immediately the cycle has ended.
STAINS ON THE GLASSES	<ol style="list-style-type: none"> 1) Only use “non-foaming” products for professional dishwashers.
EXCESSIVE FOAM IN THE TANK	<ol style="list-style-type: none"> 1) Check that the wash water temperature is not less than 122°F [50 °C]. 2) Only specialised technicians: check if the amount of product dispensed by the detergent dispenser is excessive. 3) Ensure that the tank has not been cleaned with unsuitable cleaners. Drain the tank and rinse thoroughly before new wash cycles. 4) If a foaming detergent has been used, drain and refill the tank with water until the foam disappears.
SMEARS OR SPOTS ON THE GLASSES	<ol style="list-style-type: none"> 1) Only specialised technicians: reduce the amount of rinse-aid.
THE WASH OR RINSE ARMS TURN SLOWLY	<ol style="list-style-type: none"> 1) Remove and thoroughly clean the arms. 2) Clean the wash pump suction filter.

