

DIGITAL CONTROLLED SINGLE CHAMBER UP TO 4-6-9- PIZZAS GAS OVEN
FORNO GAS PIZZA MONOCAMERA CONTROLLO DIGITALE, da 4-6-9 PIZZE

PNC	Model	Ref	Page	Note
291 370	ZCMDG4	a	1	
291 350	ZCMDG6	b	1	
291 390	ZCMDG9	c	1	

Index

Pag. 1	Main view
2	Spare parts list

Indice

Vista generale
Lista parti di ricambio

Brand / Marchio :**Factory code:** CUP

OS/DOC

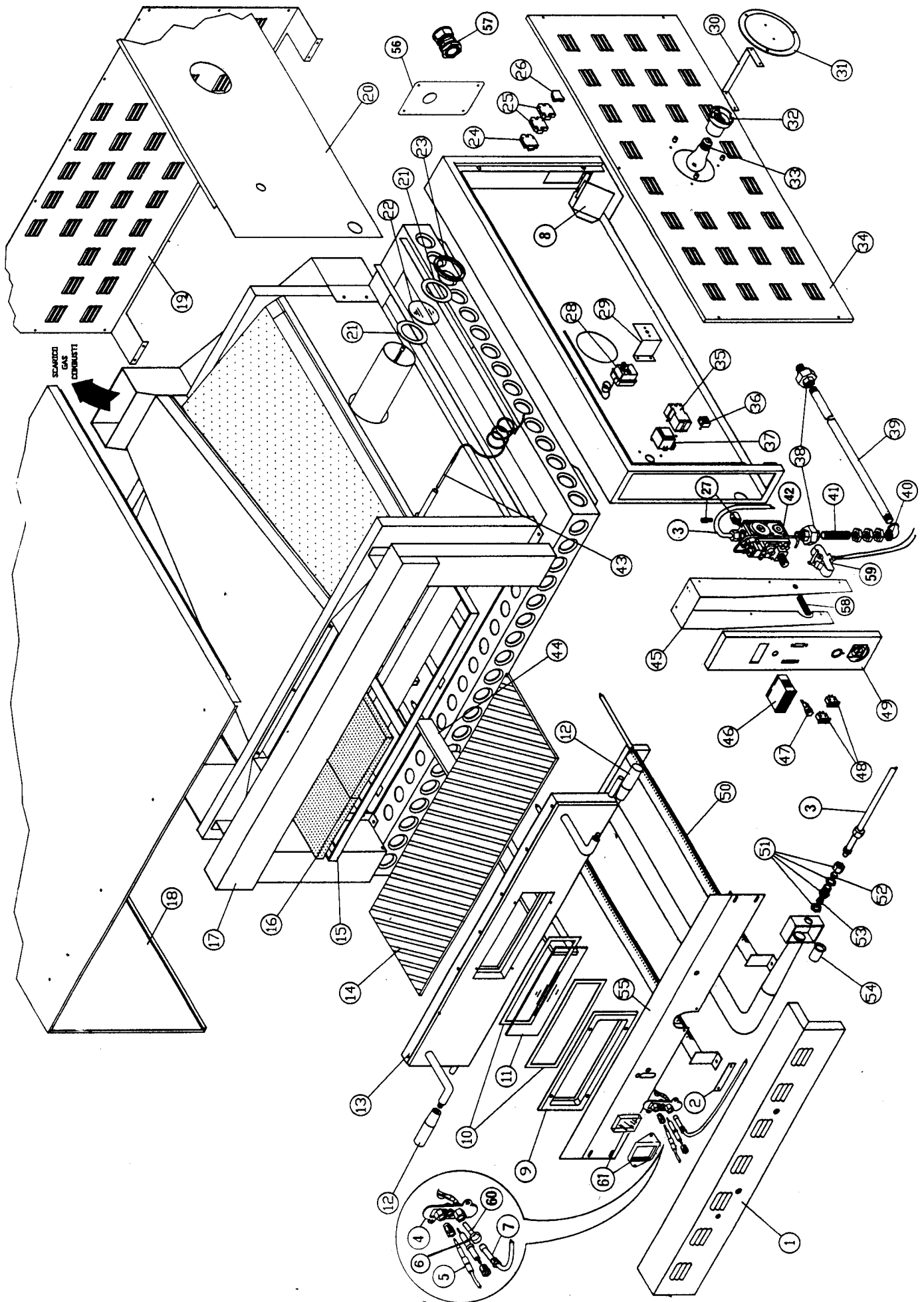

DIGITAL CONTROLLED SINGLE CHAMBER UP TO 4 - 6 - 9 - PIZZAS GAS OVENS
FORNO A GAS MONOCAMERA CONTROLLO DIGITALE, CAPACITA' 4 - 6 - 9 - PIZZE

Cod.Pr. 291 370 291 350 291 390
Mod. ZCMDG4 ZCMDG6 ZCMDG9
Ref. a b c

Pos.	Code	Qty.	Art.	Descrizione	Description	Ref./Note
4	004124	1	00058113	Brucciatoe pilota	Pilot burner	
5	004123	1	00058112	Termocoppia	Thermocouple	9x1 1200
6	004125	1	00058114	Candela accensione	Ignition probe	
11	004135	1	00061000	Vetro sportello	Glass door	320x100
12	004107	2	00055011	Maniglia porta	Handle knob	
15	004142	1	00072150	Telaio supporto refrattario	refractory support structure	a (610 x 610)
15	004143	1	00072151	Telaio supporto refrattario	refractory support structure	b (610 x 910)
15	004144	1	00072152	Telaio supporto refrattario	refractory support structure	c (910 x 910)
16	004138	4/6/9	00061011	Mattonella refrattaria	Refractory brick	(300x300x30)
22	004136	1	00061001	Spioncino in vetro	glass inspection hole	
24	004114	1	00057162	Morsetto di terra	Ground contact clamp	
25	004113	2	00057160	Morsetto di linea	Power contact clamp	
26	004115	1	00057164	Blocca morsetti	Fixing clamp	
28	004108	1	00057103	Termostato di sicurezza	Safety thermostat	set 500°C
32	004111	1	00057150	Portalampada	Light bulb holder	
33	004112	1	00057151	Lampada	Light bulb	230V 25W
35	004119	1	00057300	Accenditore	Igniter	
37	004120	1	00057310	Trasformatore 230/12V	230/12V Trasformator	5,6VA
37	004121	1	00057311	Trasformatore 240/12V	240/12V Trasformator	5,6VA
42	004122	1	00058110	Elettrovalvola gas	Gas solenoid valve	820 Novasit
43	004116	1	00057210	Sonda termostatica	Therm. probe	TCJ6x10
46	004109	1	00057105	Termostato digitale	Digital thermostat	EWPC/902
47	004117	1	00057290	Portafusibile	Fuse holder	
47	004118	1	00057291	Fusibile 100mA	Fuse 100mA	
48	004110	2	00057130	Interruttore unipolare	Unipolar switch	
50	004139	1	00062070	Brucciatoe principale	Main burner	a
50	004140	1	00062071	Brucciatoe principale	Main burner	b
50	004141	1	00062072	Brucciatoe principale	Main burner	c
53	004129	1	00058118	Ugello ,G.P.L.	L.P.G. nozzle	a/ ø1,8
53	004130	1	00058119	Ugello ,metano	Natural gas nozzle	a/ ø2,55
53	004131	1	00058120	Ugello ,G.P.L.	L.P.G. nozzle	b/ ø2,15
53	004132	1	00058121	Ugello ,metano	Natural gas nozzle	b/ ø3,1
53	004133	1	00058122	Ugello ,G.P.L.	L.P.G. nozzle	c/ ø2,4
53	004134	1	00058123	Ugello ,metano	Natural gas nozzle	c/ ø3,5
58	004106	1	00055005	Manopola valvola gas	gas valve knob	
59	004126	1	00058115	Interruttore accend. + cavo	Ignitor switch with cable	
60	004127	1	00058116	Ugello bruciatoe pilota, G.P.L.	L.P.G. Pilot burner nozzle	ref.14
60	004128	1	00058117	Ugello bruciatoe pilota, metano	Natural gas Pilot burner nozzle	ref.27
61	004137	1	00061003	Vetrino+cornice bruciatoe	Burner inspection glass+frame	