

# ***Frymaster***<sup>®</sup>

*Your Growth Is Our Goal*

## **UHCTHD Touch Holding Cabinet**

### **Parts Manual**

This manual is updated as new information and models are released. Visit our website for the latest manual.



8 1 9 7 6 7 0

Part Number: FRY\_P\_8197670 01/2024



### **NOTICE**

IF, DURING THE WARRANTY PERIOD, THE CUSTOMER USES A PART FOR THIS FRYMASTER EQUIPMENT OTHER THAN AN UNMODIFIED NEW OR RECYCLED OEM PART PURCHASED DIRECTLY FROM FRYMASTER, OR ANY OF ITS FACTORY AUTHORIZED SERVICERS, AND/OR THE PART BEING USED IS MODIFIED FROM ITS ORIGINAL CONFIGURATION, THIS WARRANTY WILL BE VOID. FURTHER, FRYMASTER AND ITS AFFILIATES WILL NOT BE LIABLE FOR ANY CLAIMS, DAMAGES OR EXPENSES INCURRED BY THE CUSTOMER WHICH ARISE DIRECTLY OR INDIRECTLY, IN WHOLE OR IN PART, DUE TO THE INSTALLATION OF ANY MODIFIED PART AND/OR PART RECEIVED FROM AN UNAUTHORIZED SERVICER.

# Table of Contents

---

UHCTHD-6-Slot Common Components .....	2
UHCTHD-3-Slot Common Components .....	5

---



# UHCTHD 6-Slot Common Components

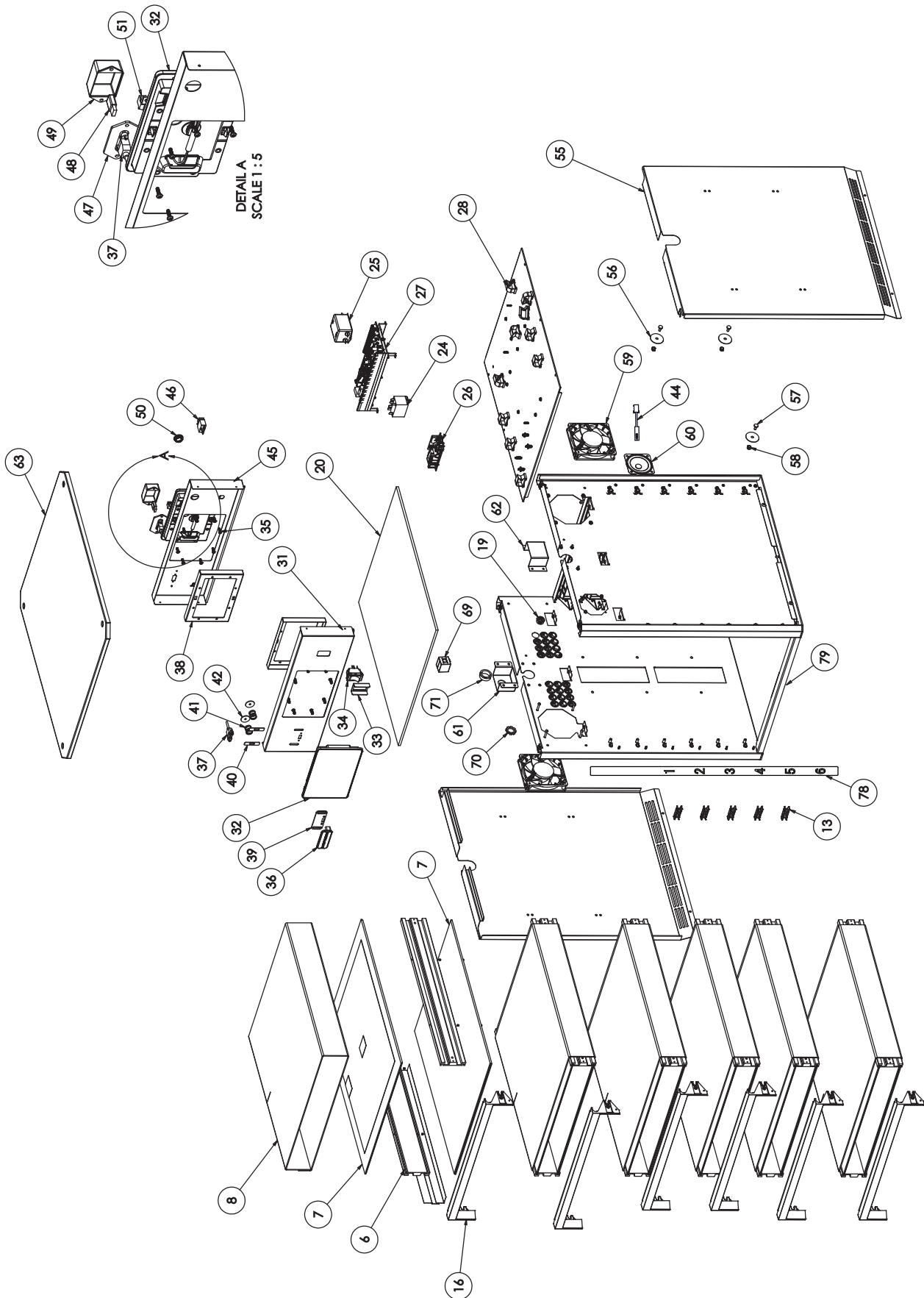

## UHCTHD 6-slot Common Components

ITEM	PART NUMBER	DESCRIPTION	NOTE	
	1	2307785	BASE, CABINET UHCHD	
	2	8090297	STUD, 10-32X1/2 PRESS FLUSH HEAD	
	3	8090495	NUT, 1/4-20 PRESS	
	4	2602493	PANEL, INNER RH UHC-T	
	5	2602492	PANEL, INNER LH UHC-T	
	6	8101286	SPACER, UHC EXTRUDED	
√	7	8076423	PLATE, HEATER UHCTHD	
	8	8160243	INSULATION, UHC SLOT	
	9	8110746	TAPE, ALUMINUM 2 IN X 50 YD	
	10	8110746	TAPE, ALUMINUM 2 IN X 50 YD	
	11	8090612	SCREW, 8-32X3/16 SERRATED CUP PT SET	
	12	8090619	SCREW, 1/4-20 X 1/2 HEX HD	
	13	8160861	SPACER, UHCHD HEATER PLATE	
	14	2307786	CAP, UHCHD LOWER SLOT	
	15	2309061	SUPPORT, UHCHD LOWER CAP	
	16	8075128	BEZEL, SPOD UHCHD	
	17	8091068	SCREW, #6X3/8 PAN HD PHIL HI-LO	
	18	8090609	SCREW, #8-32 X 3/8 SCOKET HEAD CAP	
	19	8070124	BUSHING, HEYCO SB-812-IO	
	20	8161154	INSULATION SIDE PANEL 6X3	
	21	8090361	SCREW, #8 X 1/2 HX HD DRILL	
	22	2602491	PLATE, ELECTRONICS MOUNT UHCTHD	
	23	8090265	STUD. 8-32 X 1/2 PRESS FL HD SS	
√	24	8073490	RELAY, POWER HEAVY DUTY 220V	
	25	8076337	FILTER, POWER LINE MERCOC	
√	26	8076336	POWER SUPPLY, 12VDC MERCOC	
√	27	8080026	BOARD, I/O 12-HEATER	
	28	8091115	CLAMP, CABLE	
	29	8090580	STAND-OFF CIRCUIT BOARD	
	30	8090359	SCREW, #8 X 1/4 HX WASHER SL HD ZP	
	31	8242506	FACIA, FRONT UHCTHD	
√	32	8263619	UI, McD ULTRATRONIK <b>WITH SD CARDS FOR 6 ROW DOUBLE SIDED. (ORDER KIT 8263707 IN ADDITION TO THIS KIT FOR 6 SLOT SINGLE SIDED)</b>	
	*	8263680	KIT, UHCTHD SD CARDS 6 SLOT DOUBLE SIDED <b>(INCLUDES BOTH 8122590 (FRONT) &amp; 8122623 (REAR) SD CARDS)</b>	
	*	8263707	KIT, UHCTHD SD CARD 6 SLOT SINGLE SIDED <b>INCLUDES 8122590 (FRONT) SD CARD</b>	
	33	2304346	GUARD, SWITCH 1721 COMPONENT BOX	
√	34	8074911	SWITCH, 10A 250V 15A 120V SPDT	
	35	8091260	SCREW, 8-32 X 9/16 PHIL HD SS	
	36	8105038	EMBLEM, FRYMASTER DIE CAST	
	37	8076172	CABLE, USB PANEL MOUNT FEMALE	
	38	2602369	BRACKET, ULTRATRONIX UI	
	39	8161155	TEFLON, EMBLEM BACK PLATE USB	
	40	2602055	SLIDE PLATE, MERCOC EMBLEM	
	41	8104885	SPRING, COM .72 X .055 X .750	
	42	8104886	WASHER, S/S 1"OD X W/ .188 HOLE	
	43	8091222	SCREW, 6-32 X 3/8 PHIL TR HD ZP	
	44	8076485	CABLE, JUMPER SPEAKER TO UX UI	
	45	8242507	FACIA, REAR UHCTHD	
	*	8242514	FACIA, REAR UHCTHD W/O UI	
√	46	8074882	BREAKER, 16A	
	47	8161152	GASKET, MERCOC WIFI COVER	
	48	8076226	DONGLE, WIFI	
	49	8161157	COVER, DONGLE	
	50	8100044	.875 PLUG BUTTON, #SS48155 K I I I O	
	51	8070070	TERMINAL, GROUND LUG	
	52	8090105	SCREW, 8-32 X 3/8 HX WSHR SL ZP	
	53	8090256	NUT, KEPS 10-32 HX ZP	
	54	8090117	SCREW, 10-32 X 3/8 TR SL HD SS	

ITEM	PART NUMBER	DESCRIPTION	NOTE
55	2602488	PANEL, SIDE W/ VENTS UHC-T	
56	2309172	WASHER, UHCHD SIDE COVER	
57	8090618	SUPPORT, THREADED KEYHOLE	
58	8090054	NUT, ELASTIC STOP, 10-32 ZN PL	
59	8076537	FAN 120X120X25MM, 115CFM	
60	8075829	SPEAKER, 4 OHM	
61	2602487	BRACKET, STARIN RELIEF UHCTHD	
62	2207551	BRACKET, STRAIN RELIEF UHCHD	
63	2602486	TOPCAP, UHC-T <b>(use QTY #4 of item#76 to secure topcap)</b>	
64	8091064	CLIP, TINNEMAN W/ 1/4-20 BOSS	
65	8052209	DIAGRAM, WIRING UHC-T, LINE TO GROUND	
66	8076425	HARNESS, DC POWER UHCTHD	
67	8076424	HARNESS, AC POWER UHCTHD	
68	8076441	CABLE, UHCTHD UI TO UI <b>(3-WIRE 6-pin CAN CABLE (UI to UI))</b>	
69	8076460	FERRITE, 225 OHMS AT 110MHz	
70	8090454	NUT, 1/2" CONDUIT NUT	
71	8072469	BUSHING, HEYCO 1" ID	
72	8090852	SCREW, 6-32 X 1/2 RD SL HD	
73	8090250	NUT, 6-32 HX ZP KEPS	
74	8091158	SCREW, ROUND HD SLOTTED	
75	8090247	NUT, 8-32 HX ZP KEPS	
76	8091258	SCREW, FLAT HEAD 1/4-20 X 3/4 <b>(LID or TOPCAP SCREWS used to secure item#63)</b>	
77	8090449	SCREW, #10 X 1/2 PHIL TR HD NP TYPE B	
78	8023542	UHCTHD OVERLAY 6 SLOT	
79	8237815	CAP, UHCHD LOWER HEATER PLATE	
*	8076328	CABLE, COMM CROSSOVER NO DC <b>(RJ CABLE (UI to IO)) MODBUS</b>	
		<b>CORDSETS</b>	
	8072803	CE CORDSET	
	8074145	AUSTRALIAN CORDSET	
	8072473	DOMESTIC CORDSET	
	8263096	AUSTRALIAN 90° REAR EXIT KIT WITH CORDSET	
	8263097	AUSTRALIAN 90° REAR EXIT KIT WITH CORD, NO PLUG	
	8263098	CE 90° REAR EXIT KIT WITH CORDSET	
	8263099	CE 90° REAR EXIT KIT WITHOUT CORDSET	

√ Recommended Parts \* Not Shown

# UHCTHD 3-Slot Common Components

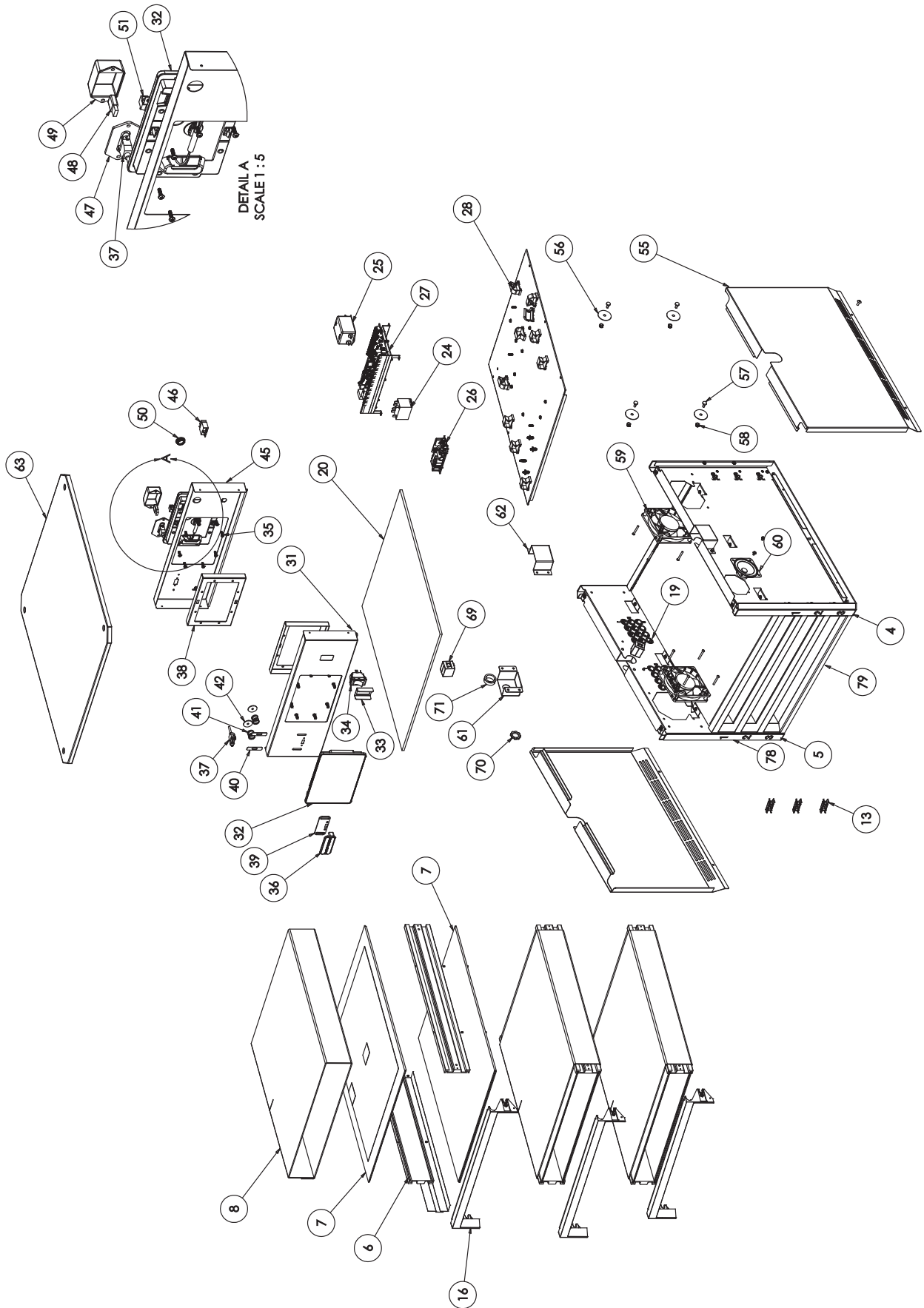

## UHCTHD 3-slot Common Components

ITEM	PART NUMBER	DESCRIPTION	NOTE	
	1	2307785	BASE, CABINET UHCHD	
	2	8090297	STUD, 10-32X1/2 PRESS FLUSH HEAD	
	3	8090495	NUT, 1/4-20 PRESS	
	4	2602569	PANEL, INNER RH UHC-T	
	5	2602568	PANEL, INNER LH UHC-T	
	6	8101286	SPACER, UHC EXTRUDED	
√	7	8076423	PLATE, HEATER UHCTHD	
	8	8160243	INSULATION, UHC SLOT	
	9	8110746	TAPE, ALUMINUM 2 IN X 50 YD	
	10	8110746	TAPE, ALUMINUM 2 IN X 50 YD	
	11	8090612	SCREW, 8-32X3/16 SERRATED CUP PT SET	
	12	8090619	SCREW, 1/4-20 X 1/2 HEX HD	
	13	8160861	SPACER, UHCHD HEATER PLATE	
	14	2307786	CAP, UHCHD LOWER SLOT	
	15	2309061	SUPPORT, UHCHD LOWER CAP	
	16	8075128	BEZEL, SPOD UHCHD	
	17	8091068	SCREW, #6X3/8 PAN HD PHIL HI-LO	
	18	8090609	SCREW, #8-32 X 3/8 SCOKET HEAD CAP	
	19	8070124	BUSHING, HEYCO SB-812-IO	
	20	8161154	INSULATION SIDE PANEL 6X3	
	21	8090361	SCREW, #8 X 1/2 HX HD DRILL	
	22	2602491	PLATE, ELECTRONICS MOUNT UHCTHD	
	23	8090265	STUD. 8-32 X 1/2 PRESS FL HD SS	
√	24	8073490	RELAY, POWER HEAVY DUTY 220V	
	25	8076337	FILTER, POWER LINE MERCOC	
√	26	8076336	POWER SUPPLY, 12VDC MERCOC	
√	27	8080026	BOARD, I/O 12-HEATER	
	28	8091115	CLAMP, CABLE	
	29	8090580	STAND-OFF CIRCUIT BOARD	
	30	8090359	SCREW, #8 X 1/4 HX WASHER SL HD ZP	
	31	8242506	FACIA, FRONT UHCTHD	
√	32	8263619	UI, McD ULTRATRONIK <b>WITH SD CARDS FOR 6-ROW DOUBLE SIDED (ORDER KIT 8263705 IN ADDITION TO THIS KIT FOR 3 SLOT DOUBLE SIDED) (ORDER KIT 8263706 IN ADDITION TO THIS KIT FOR 3 SLOT SINGLE SIDED) (USE 8122634 FOR PRIMARY (FRONT) SD CARD ONLY 3 ROW) (USE 8122635 FOR SECONDARY (REAR) SD CARD ONLY 3 ROW)</b>	
	*	8263705	KIT, UHCTHD SD CARDS 3 SLOT DOUBLE SIDED <b>(INCLUDES BOTH 8122634 (FRONT) &amp; 8122635 (REAR) SD CARDS)</b>	
	*	8263706	KIT, UHCTHD SD CARD 3 SLOT SINGLE SIDED <b>(INCLUDES 8122634 (FRONT) SD CARD)</b>	
	33	2304346	GUARD, SWITCH 1721 COMPONENT BOX	
√	34	8074911	SWITCH, 10A 250V 15A 120V SPDT	
	35	8091260	SCREW, 8-32 X 9/16 PHIL HD SS	
	36	8105038	EMBLEM, FRYMASTER DIE CAST	
	37	8076172	CABLE, USB PANEL MOUNT FEMALE	
	38	2602369	BRACKET, ULTRATONIX UI	
	39	8161155	TEFLON, EMBLEM BACK PLATE USB	
	40	2602055	SLIDE PLATE, MERCOC EMBLEM	
	41	8104885	SPRING, COM .72 X .055 X .750	
	42	8104886	WASHER, S/S 1"OD X W/ .188 HOLE	
	43	8091222	SCREW, 6-32 X 3/8 PHIL TR HD ZP	
	44	8076485	CABLE, JUMPER SPEAKER TO UX UI	
	45	8242507	FACIA, REAR UHCTHD	
	*	8242514	FACIA, REAR UHCTHD W/O UI	
√	46	8074882	BREAKER, 16A	
	47	8161152	GASKET, MERCOC WIFI COVER	
	48	8076226	DONGLE, WIFI	
	49	8161157	COVER, DONGLE	
	50	8100044	.875 PLUG BUTTON, #SS48155 K I I O	
	51	8070070	TERMINAL, GROUND LUG	
	52	8090105	SCREW, 8-32 X 3/8 HX WSHR SL ZP	

ITEM	PART NUMBER	DESCRIPTION	NOTE
53	8090256	NUT, KEPS 10-32 HX ZP	
54	8090117	SCREW, 10-32 X 3/8 TR SL HD SS	
55	2602567	PANEL, SIDE W/ VENTS UHCTHD 3 ROW	
56	2309172	WASHER, UHCHD SIDE COVER	
57	8090618	SUPPORT, THREADED KEYHOLE	
58	8090054	NUT, ELASTIC STOP, 10-32 ZN PL	
59	8076537	FAN 120X120X25MM, 115CFM	
60	8075829	SPEAKER, 4 OHM	
61	2602487	BRACKET, STARIN RELIEF UHCTHD	
62	2207551	BRACKET, STRAIN RELIEF UHCHD	
63	2602486	TOPCAP, UHC-T <b>(use QTY #4 of item#76 to secure topcap)</b>	
64	8091064	CLIP, TINNEMAN W/ 1/4-20 BOSS	
65	8052209	DIAGRAM, WIRING UHC-T, LINE TO GROUND	
66	8076425	HARNESS, DC POWER UHCTHD	
67	8076424	HARNESS, AC POWER UHCTHD	
68	8076441	CABLE, UHCTHD UI TO UI <b>(3-WIRE 6-pin CAN CABLE (UI to UI))</b>	
69	8076460	FERRITE, 225 OHMS AT 110MHz	
70	8090454	NUT, 1/2" CONDUIT NUT	
71	8072469	BUSHING, HEYCO 1" ID	
72	8090852	SCREW, 6-32 X 1/2 RD SL HD	
73	8090250	NUT, 6-32 HX ZP KEPS	
74	8091158	SCREW, ROUND HD SLOTTED	
75	8090247	NUT, 8-32 HX ZP KEPS	
76	8091258	SCREW, FLAT HEAD 1/4-20 X 3/4 <b>(LID or TOPCAP SCREWS used to secure item#63)</b>	
77	8090449	SCREW, #10 X 1/2 PHIL TR HD NP TYPE B	
78	8023555	UHCTHD OVERLAY 3 SLOT	
79	8237815	CAP, UHCHD LOWER HEATER PLATE	
*	8076328	CABLE, COMM CROSSOVER NO DC <b>(RJ CABLE (UI to IO)) MODBUS</b>	
		<b>CORDSETS</b>	
	8072803	CE CORDSET	
	8074145	AUSTRALIAN CORDSET	
	8072473	DOMESTIC CORDSET	
	8263096	AUSTRALIAN 90° REAR EXIT KIT WITH CORDSET	
	8263097	AUSTRALIAN 90° REAR EXIT KIT WITH CORD, NO PLUG	
	8263098	CE 90° REAR EXIT KIT WITH CORDSET	
	8263099	CE 90° REAR EXIT KIT WITHOUT CORDSET	

√ Recommended Parts \* Not Shown

**THIS PAGE INTENTIONALLY LEFT BLANK**

# *Frymaster*®

FRYMASTER  
8700 LINE AVENUE, SHREVEPORT, LA 71106-6800

800-551-8633

318-865-1711

[WWW.FRYMASTER.COM](http://WWW.FRYMASTER.COM)

EMAIL: [FRYSERVICE@WELBILT.COM](mailto:FRYSERVICE@WELBILT.COM)



Welbilt offers fully-integrated kitchen systems. Welbilt's portfolio of award-winning brands includes Cleveland™, Convothem®, Delfield®, Frymaster®, Garland®, Kolpak®, Lincoln®, Merco®, Merrychef® and Multiplex®.

*Bringing innovation to the table* • [welbilt.com](http://welbilt.com)