

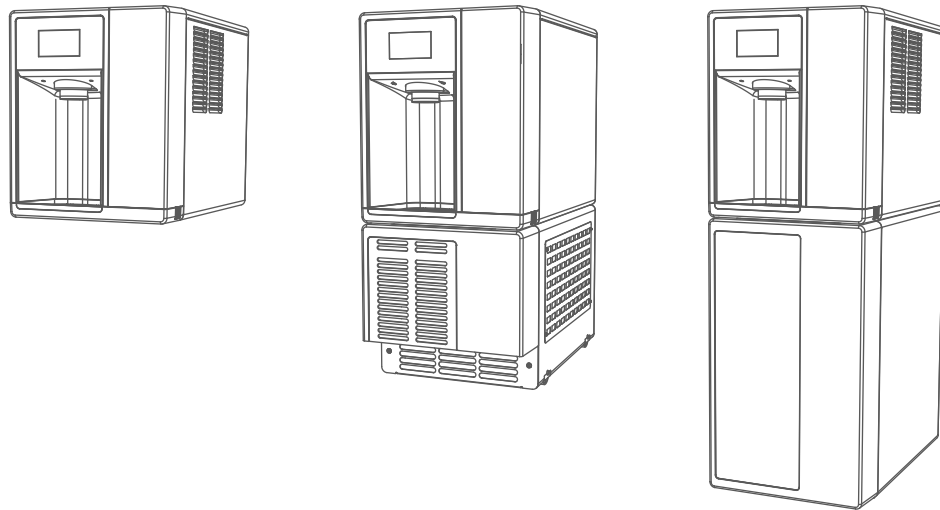

Champion™ 7 and Champion 15 Ice and Water Dispenser with Chewblet® Ice Machine CI114A, UC114A, UD114A

Installation Guide
230 V

Please visit <https://www.follettice.com/technicaldocuments>
for the Operation and Service manual for your unit.



Welcome to Follett

Follett equipment enjoys a well-deserved reputation for excellent performance, long-term reliability and outstanding after-the-sale support. To ensure that this equipment delivers that same degree of service, review this guide carefully before you begin your installation.

Should you have need technical help, please call our Technical Service group at (877) 612-5086 or (610) 252-7301.

Please have your model number, serial number and complete and detailed explanation of the problem when contacting Technical Service.

Getting Started

After uncrating and removing all packing material. Inspect the equipment for concealed shipping damage. All freight is to be inspected upon delivery. If visible signs of damage exist, please refuse delivery or sign your delivery receipt "damaged." Follett Customer Service must be notified within 48 hours. Wherever possible, please include detailed photos of the damage with the original packaging so that we may start the freight claim process.



WARNING! Risk of fire or explosion. Flammable refrigerant used. Follow handling instruction carefully. To be repaired only by trained service Personnel.



WARNING! Do not puncture Refrigerant Tubing. Do not use this product with flammable gases or flammable solvents.



WARNING! Do not store flammable gases, flammable liquids or flammable solids in these units. Do not use FLAME to check for gas leak.



WARNING! Do not under any circumstances try to modify or repair valves, regulator, connectors, controls or any other appliance. Doing so creates the risk of a gas leak.



WARNING! Keep ventilaton openings clear of obstruction.



WARNING! Do not damage the refrigerant circuit.



WARNING! Connect to potable water supply only.

WARNING!

- Read this manual thoroughly before operating, installing or performing maintenance on the equipment. Failure to follow instructions in this manual can cause property damage, injury or death.
- The ice machine contains R290 (propane) refrigerant. R290 (propane) is flammable in concentrations of air between approximately 2.1% and 9.5% by volume. R290 (propane) may burn if exposed to a heat source above 470 °C.
- When servicing this equipment, be sure to lock the circuit breaker, and display an in-service notice.
- This equipment contains high-voltage electricity and refrigerant charge. Installation and repairs are to be performed by properly trained technicians aware of the dangers of dealing with high voltage electricity and refrigerant under pressure. The technician must also be certified in proper refrigerant handling and servicing procedures. All lockout and tag out procedures must be followed when working on this equipment.
- Repair on R290 systems must always be done in a well-ventilated area.
- Because R290 is highly flammable, a combustible gas leak detector is required when servicing R290 systems.
- This appliance intended to be connected to the water mains by a hose-set. New hose-sets supplied with the appliance should be used, old hose-sets should be discarded.
- All Federal, State, and Local regulations must be followed when connecting this appliance to water mains.
- This appliance is only to be installed in locations where it can be overseen by trained personnel.
- Only use parts recommended or provided by the manufacturer.
- Routine adjustments and maintenance procedures outlined in this manual are not covered by the warranty.
- We reserve the right to make product improvements at any time. Specifications and design are subject to change without notice.
- Do not tilt unit further than 30° off vertical during uncrating or installation.
- Dispenser bin area contains mechanical, moving parts. Keep hands and arms clear of this area at all times. If access to this area is required, power to unit must be disconnected first.
- This appliance is not suitable for installation in an area where a water jet could be used.
- This appliance must not be cleaned by a water jet.
- User maintenance should not be done by children.
- Follett recommends a Follett water filter system be installed in the ice machine inlet water line (standard capacity #00130229, high capacity #00978957, carbonless high capacity #01050442).
- Prior to operation clean the dispenser in accordance with instructions found in this manual.
- Do not block air intake or exhaust.
- This appliance should be permanently connected by a qualified person in accordance with application codes.
- A qualified person shall provide a readily accessible disconnect device incorporated into the fixed wiring.
- If the supply cord is damaged, it must be replaced by the manufacturer, its service agent or similarly qualified persons in order to avoid a hazard.
- This appliance can be used by children aged 8 years and above and persons with reduced physical, sensory, or mental capabilities, or lack of experience and knowledge if they have been given supervision or instruction concerning use of the appliance in a safe way and understand the hazards involved. Children should be supervised to ensure that they do not play with the appliance.
- This appliance is designed for commercial use.
- To avoid a hazard due to instability of the appliance, it must be fixed in accordance with the instructions.
- Warranty does not cover exterior or outside installations.
- To reduce risk of shock, disconnect power before servicing.
- Connect to potable water supply only.
- Ice is slippery. Maintain counters and floors around dispenser in a clean and ice-free condition.
- Ice is food. Follow recommended cleaning instructions to maintain cleanliness of delivered ice.

Before You Begin

The serial number of your unit is located on the chassis directly behind the front drip tray. The drip tray can be easily removed by pulling it straight forward. The serial number can also be found on top of the condenser.

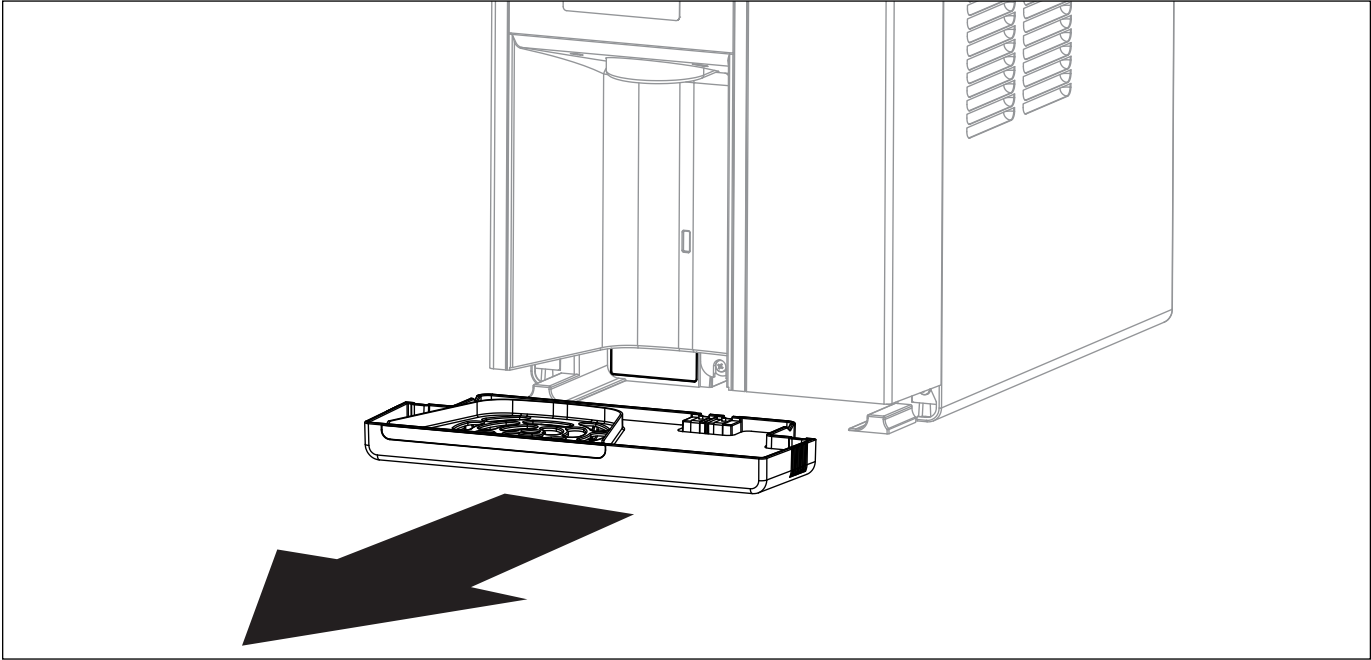

Specifications

Dimensions

| | Width | Depth | Height | Unit Shipping Weight |
|------------------|----------------|------------------|------------------|----------------------|
| E7CI114A | 14.56" (37 cm) | 22.38" (56.8 cm) | 17.59" (44.7 cm) | 92 lbs (41.7 kg) |
| E15CI114A | 14.56" (37 cm) | 22.38" (56.8 cm) | 22.47" (57.1 cm) | 105 lbs (47.6 kg) |
| E7UC114A | 14.56" (37 cm) | 22.38" (56.8 cm) | 33.50" (85.1 cm) | 120 lbs (54.4 kg) |
| E7UD114A | 14.56" (37 cm) | 22.38" (56.8 cm) | 31.50" (80 cm) | 120 lbs (54.4 kg) |

Note: Base stand ships separate.

Ambient Information



CAUTION!

The Champion 7 and Champion 15 are for indoor use only. Designed for commercial use. Follett is not able to provide in-house services for residential installations.

| | Maximum* | Minimum* |
|-------------------|----------------------|-----------------|
| Air Temperature† | 100 F (38 C) | 50 F (10 C) |
| Water Temperature | 90 F (32.2 C) | 40 F (4.5 C) |
| Water Pressure | 70 psi (483 kpa) | 10 psi (69 kpa) |
| Relative Humidity | 55% at 78 F (25.5 C) | |

* Use outside of these limitations is misuse and will void warranty. Maintain proper clearances and ventilations; ensure vents are not blocked or compromised resulting in above specification temperatures and condenser failure.
 † Best performance is achieved between 80 F (27 C) and 50 F (10 C).

Plumbing

- Water Inlet: 1/4" OD tube, John Guest push-in fitting
- Water shut-off recommended within 5 ft (1.5 m) of dispenser

Options

- Water dispense (P/N 01536093)
- Rear drain for ice bin (P/N 01535350)
- Internal Claris filter (P/N 01535327)
- 4" legs countertop model (P/N [00956300](#))
- 6" legs freestanding models (P/N [00956318](#))
- Base stand for countertop models (P/N 01453661)
- External Claris filter (P/N 01536127)
- Drip tray drain E7UD, E7UC (P/N 01535335)
- Drip tray drain with 4" legs E7/E15CI (P/N 01535343)

Water



WARNING!

Connect to potable water supply only.

- Maximum total dissolved solids (TDS) 400 ppm. Ion exchange filtration or RO can reduce hardness.
- Minimum TDS 10 ppm.
- Maximum silica 20 mg/L. Reverse osmosis (RO) must be used to remove silica.
- Maximum water hardness 100 ppm as CaCO₃ (6 grains per gallon). Ion exchange filtration or RO can reduce hardness.
- Not recommended for use with sodium softened water
- Ingress Protection (IP) rating: IPX0 (no protection)
- Use provided water hardness test strips to verify incoming water hardness and adjust bypass setting on Claris filter head (preinstalled behind front cover on most models). Refer to the below table for appropriate settings. Adjust the bypass setting after completing the *Internal Claris Filter Flushing Sequence* section.

| Hardness (ppm) | Setting | Interval (month) | Gallons |
|----------------|---------|------------------|---------|
| 0 | 6 | 12 | 1000 |
| 50 | 5 | 9 | 800 |
| 120 | 3 | 6 | 500 |
| 250 | 2 | 4 | 200 |
| 425 | 0 | 2 | 100 |

Note: Claris filter manifold is factory set at 3 prior to shipment.

Clearances

- CI Models: 3" (7.62 cm) on each side of dispenser, 2" (5.08 cm) behind for electrical/water connection/ventilation
- UD/UC Models: 2" (5.08 cm) behind dispenser for electrical and optional drain connection. 6" (15.3 cm) in front of dispenser for ventilation.

Electrical

230 V

- 230 V, 50 Hz, 1 phase, 2A, maximum fuse or breaker 10A.
- Connect to dedicated 10A circuit, fuse or breaker.
- Equipment ground required.
- 8' (2.4 m) cord supplied with machine.
- Replacement cord instructions, type IEC 60320-C13 attachment. If the supply cord is damaged, it must be replaced by a special cord or assembly available from the manufacturer or its service agent.

Refrigeration



Caution!

Risk of fire. All service on refrigeration system must be performed in accordance with all federal, state and local laws that pertain to the use of refrigerants. It is the responsibility of the technician to ensure that these requirements are met.

- Refrigerant
 - 230 V: R290 - 3.3 ounces (93 grams)

Heat Rejection

- 1700 BTU/hr (498 W)

Champion 7 Detailed Drawing - CI Models (with freestanding base)

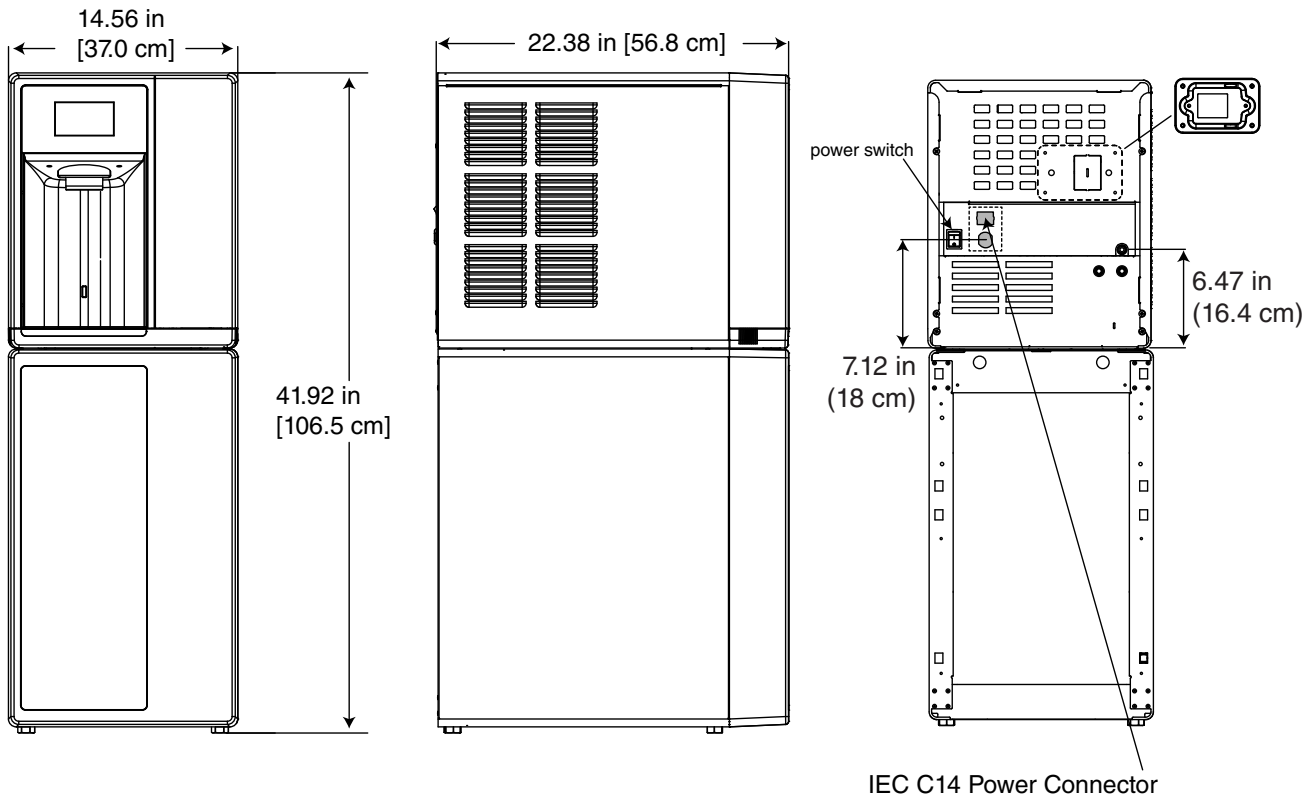

Champion 15 Detailed Drawing - CI Models (with freestanding base)

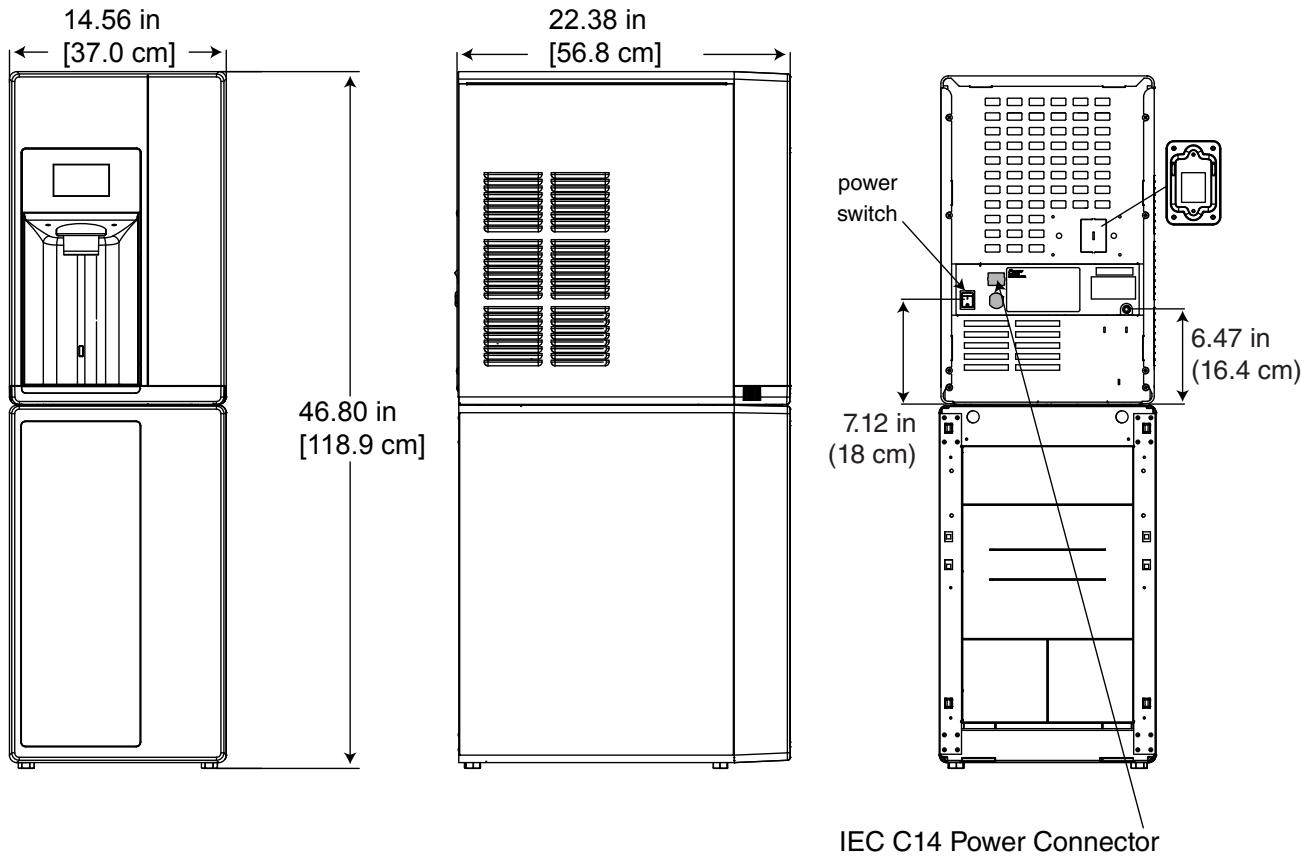

Champion 7 Detailed Drawing - UC and UD Models

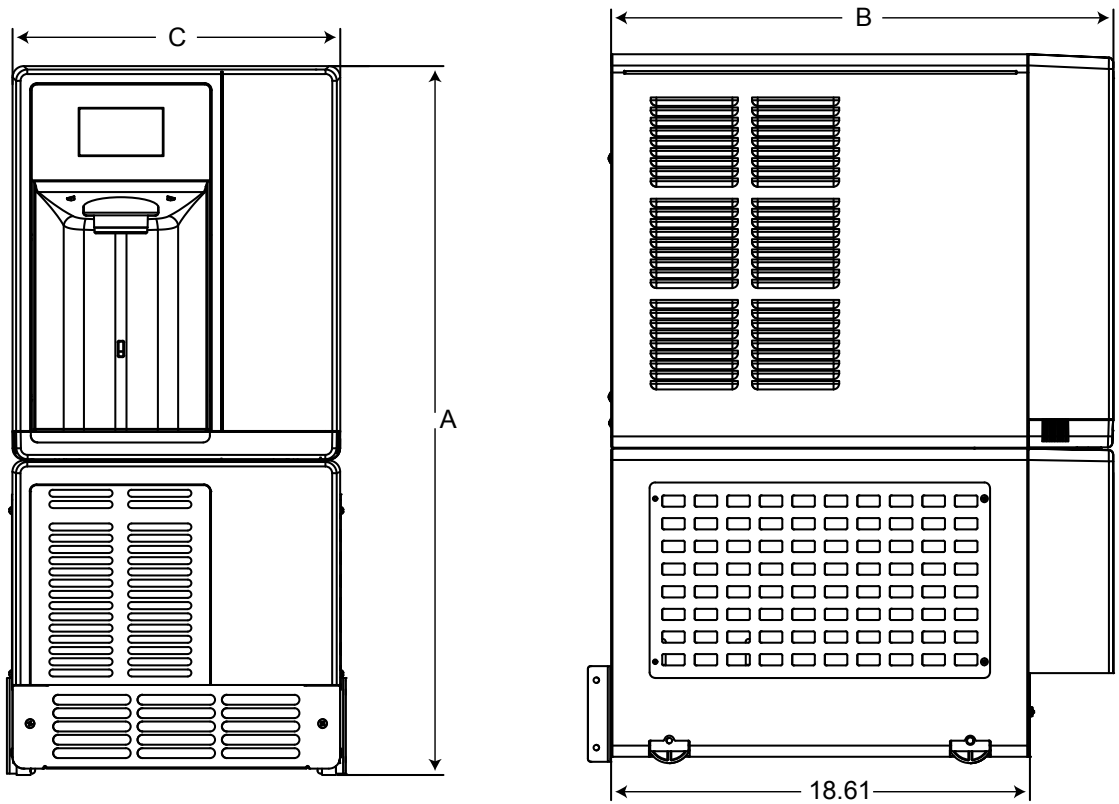

| Dimension | E7UC114A | E7UD114A (ADA) |
|-----------|--------------------|--------------------|
| A | 33.50 in (85.1 cm) | 31.50 in (80 cm) |
| B | 22.38 in (56.7 cm) | 22.38 in (56.7 cm) |
| C | 14.56 in (37 cm) | 14.56 in (37 cm) |

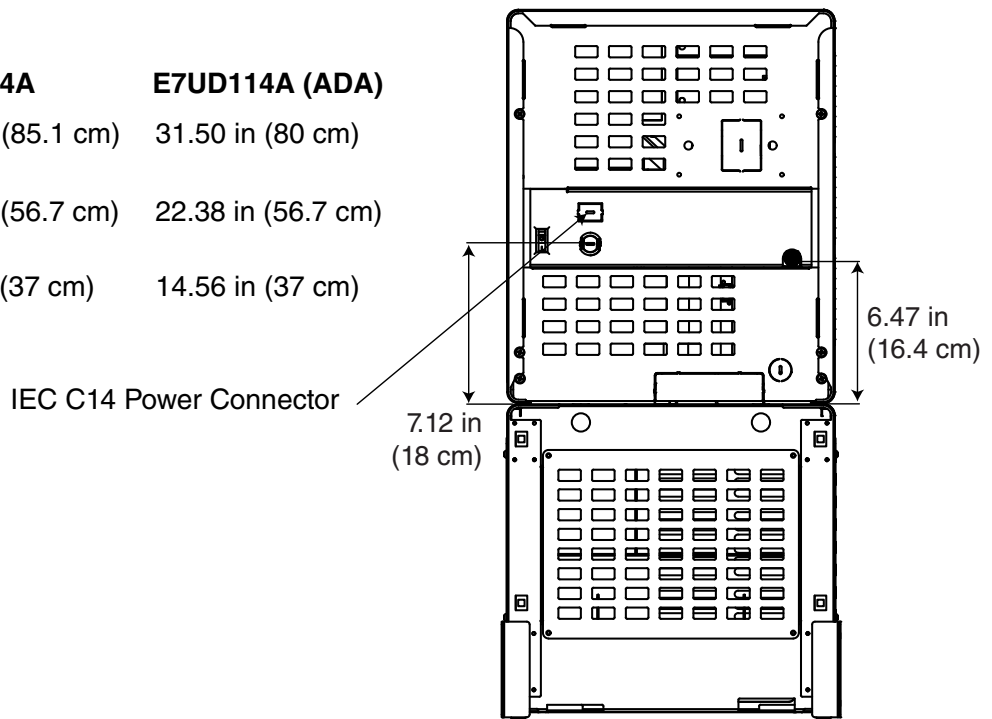

Installation

CAUTION!

No service or maintenance should be performed until the technician has thoroughly read this service manual. Except for routine cleaning and sanitizing, only qualified technicians should attempt to service or maintain this equipment.

Countertop Installation

The Champion 7 countertop model is designed to fit on counters underneath standard mounted cabinets, this does not apply to Champion 15 models.

1. 3" (7.62 cm) on each side of dispenser, 2" (5.08 cm) behind for electrical/water connection/ventilation (**Fig. 1**).
2. Rough-in the electrical service and water line.
 - Electrical: 230 V, single phase, 10A dedicated receptacle required. The dispenser has a detachable 8 ft (2.4 m) cord and plug.
 - Water: supply line (with shut-off valve) connects to the dispenser's 1/4" OD tube quick connect.

NOTICE!

If installing optional Drip Tray Drain Kit or Leg Accessory, complete those steps before proceeding.

CAUTION!

Use caution when tipping the dispenser during leg installation. Do not lay unit on back or side. DO NOT EXCEED 30° angle. Tipping more than 30° can result in compressor malfunction.

3. If installing optional 4" Leg Accessory (item# [00956300](#)), place a 5" (12.7 cm) spacer underneath the dispenser to ease installation.
4. Remove four plastic, thread-protecting plugs from bottom of dispenser.
5. Screw each leg into chassis (**Fig. 2**).
6. Complete *Potable Water Connection* before proceeding.

Fig. 1

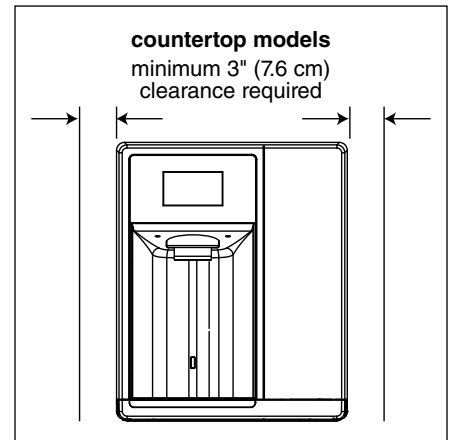
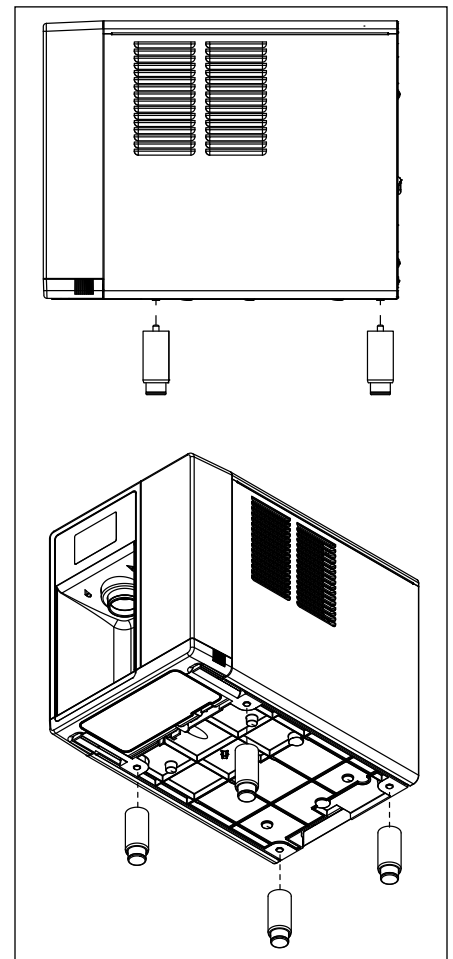

Fig. 2



Freestanding Installation

1. 3" (7.62 cm) on each side of dispenser, 2" (5.08 cm) behind for electrical/water connection/ventilation (**Fig. 3**).
2. Rough-in the electrical service and water line.
 - Electrical: 230 V, single phase, 10A dedicated receptacle required. The dispenser has a detachable 8 ft (2.4 m) cord and plug.
 - Water: supply line (with shut-off valve) connects to the dispenser's 1/4" OD tube quick connect.

Fig. 3

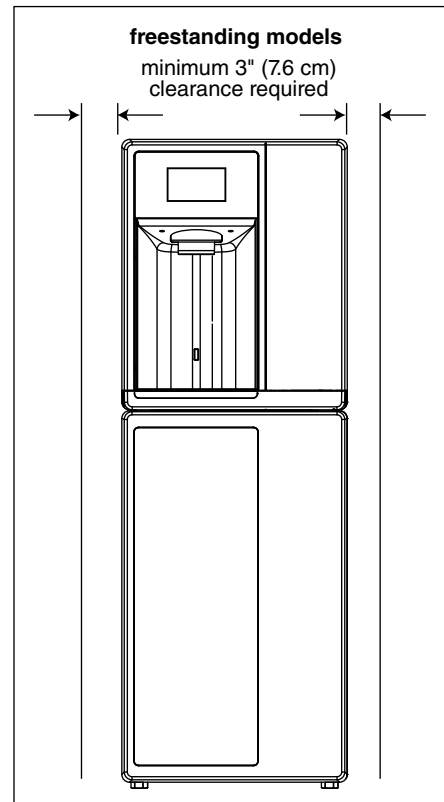

3. If installing optional 6" Leg Accessory (item# [00956318](#)), tilt or lay base stand on side and screw each leg into stand (**Fig. 4**).

Fig. 4

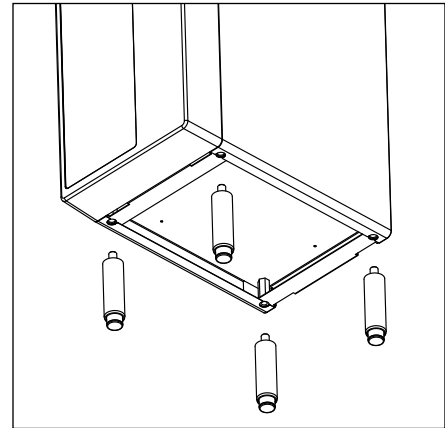

4. Remove four plastic, thread-protecting plugs from bottom of dispenser.
5. Attach dispenser to base stand with supplied hardware (**Fig. 5**).

NOTICE!

If installing optional Drip Tray Drain Kit, refer to instructions included with the Drip Tray Drain Kit.

Fig. 5

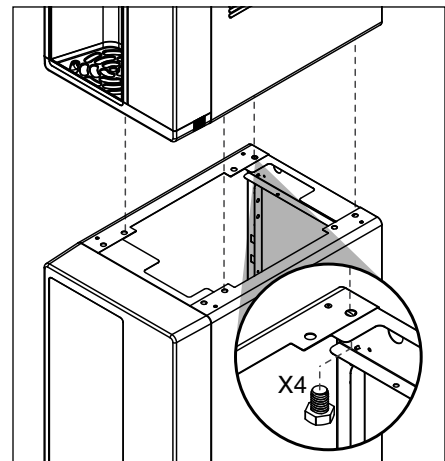

6. Complete *Potable Water Connection* before proceeding.
7. Secure unit to wall or cove molding with supplied bracket (**Fig. 6**) to prevent tipping.

Note: Fasteners must be supplied by installer.



WARNING!

Freestanding unit must be secured to wall to prevent tipping. Failure to do could result in personal injury or damage to the unit.

Undercounter Installation

1. Measure to verify that the dispenser will fit in the desired location. A clearance of at least 2" (5.08 cm) is required behind the dispenser for the electrical and optional drain connection.
2. Ensure that the finished floor inside the cabinet is flush (level) with the floor outside the cabinet (**Fig. 7**). If the cabinet floor is lower than the finished floor, the cabinet floor must be built up (using appropriate materials) until it is flush with the finished floor. A flush floor is required for proper operation and maintenance/service of the dispenser.
3. Rough-in the electrical service, water line, and optional Drip Tray Drain Kit*.
 - Electrical: 230 V, single phase, 10A dedicated receptacle required. The dispenser has a detachable 8 ft (2.4 m) cord and plug.

Note: The dispenser must be installed such that it can be moved forward at least 4" (10.16 cm) to allow access to the Bin Lid Cleaning Spout (**Fig. 9.6**) for dispenser cleaning and sanitizing. Take this requirement into consideration during rough-in.

 - Water: supply line (with shut-off valve) connects to the dispenser's 1/4" OD tube quick connect.

* The optional Drip Tray Drain Kit (item# [00956375](#)) requires a floor drain within 15 ft (4.5 m) of the dispenser. For detailed installation instructions, please refer to the instructions shipped with the Drip Tray Drain Kit.

Fig. 6

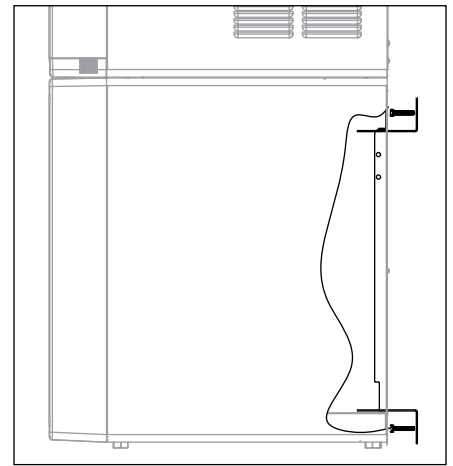
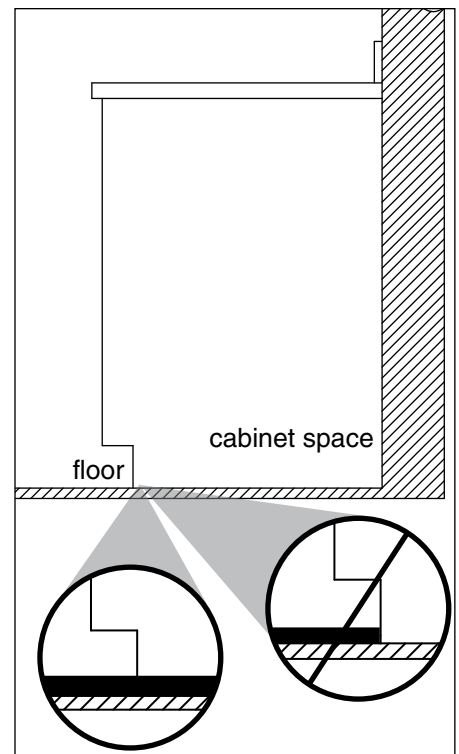
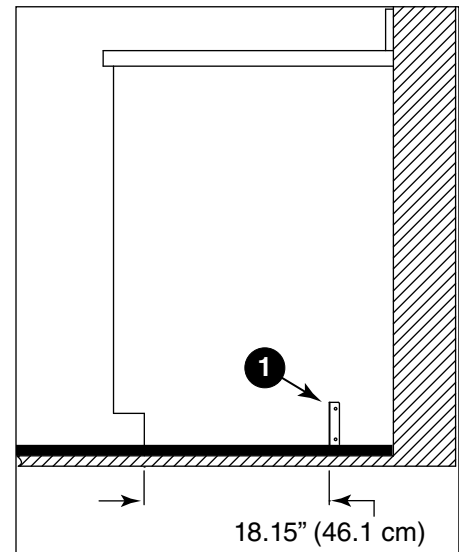

Fig. 7



4. Install the angle bracket inside the cabinet, 18.15" (46.1 cm) from the toe kick (**Fig. 8.1**). The bracket prevents the dispenser from being located/pushed beyond the recommended cabinet space depth. **Do not attach the bracket to the dispenser.**

Fig. 8



Potable Water Connection

1. **Do not supply power to the unit until after the Initial Sanitizing Procedure has been completed.** This ensures that the evaporator is warm and does not contain ice.
2. Connect water line. Recommended routing (**Fig. 9**) allows easy access to water for cleaning and sanitizing procedure.
3. Sanitize the dispenser prior to use (locate the Initial Sanitizing Kit shipped with this unit and complete the **Initial Sanitizing Procedure** section).
4. If the dispenser has the optional internal water filter*, ensure that you also complete the **Internal Claris Filter Flushing Sequence** section before putting the unit into service.

* If your dispenser has the internal water filter option, the water filter *must* be installed for the dispenser to operate.

Fig. 9

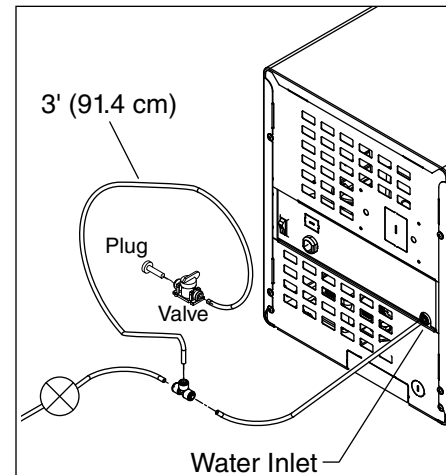

Access Internal Components



CAUTION!

Except for routine cleaning and sanitizing, only qualified technicians should attempt to service or maintain this equipment.

1. Remove the drip tray by pulling straight forward (**Fig. 10.1**).
2. Unscrew the chute (**Fig. 10.2**).
3. Remove the one screw securing the front cover (**Fig. 10.3**).
4. Remove the front cover and set aside. Follett recommends setting the cover on the drip tray, which provides a stable base. Be careful not to stretch or damage any cables connecting the front cover to the unit (**Fig. 10.4**).
5. Remove top sheet metal cover (**Fig. 10.5**).

Fig. 10

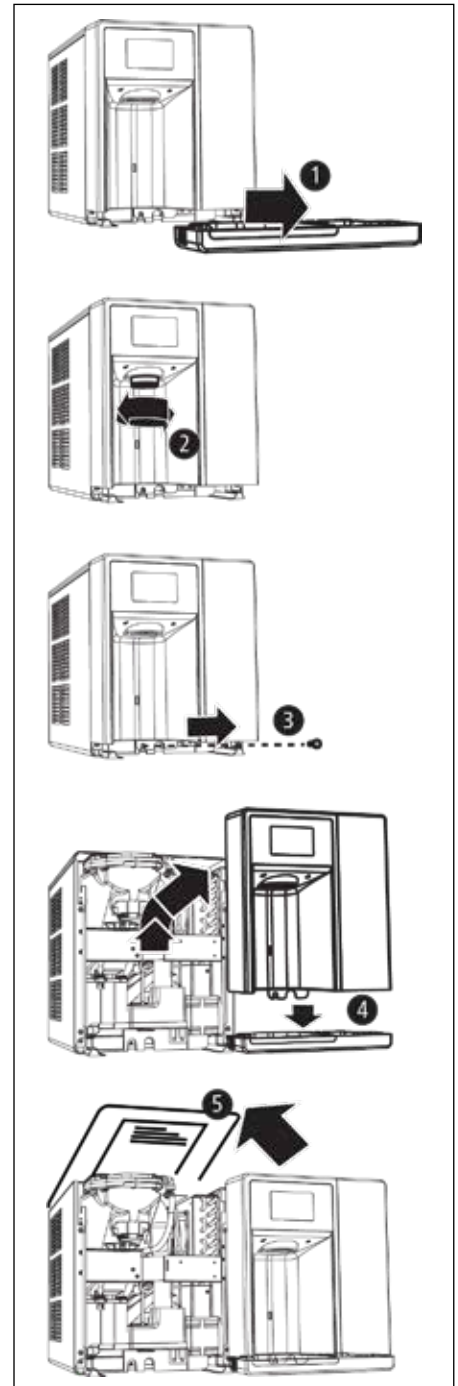

Initial Sanitizing Procedure (unit is not powered)

1. Complete the steps in the *Access Internal Components* section.
2. Remove cap from bin lid cover.
3. Screw bin lid cover cap onto ice discharge chute.
Note: On rear drain units, ensure that the pinch clamp is closed on the ice storage bin rear drain tube. On hot tank units, ensure that the pinch clamp is closed.
4. Champion 7: mix 2.5 gal. (9.5 L) of water and 1 packet Kay-5 sanitizer.
Champion 15: mix 5 gal. (18.9 L) of water and 2 packets Kay-5 sanitizer.
5. Pour sanitizing solution into bin lid access spout until solution reaches the spout neck.
6. Allow the solution to remain in unit for 5 minutes.
7. Drain system by opening pinch clamp and/or lowering drain tube.
8. Secure drain tube into holder.
9. Fill and drain twice with potable water. Secure drain tube.
10. Place a bucket under the dispense chute and remove cap. **Note:** Some sanitizing solution will remain and drain out when cap is removed. Reposition cap on bin lid spout.
Note: On rear drain units, open the pinch clamp on the ice storage bin rear drain tube. On hot tank units, open the pinch clamp.

Set Bypass Level on Internal Claris Filter Head

1. Use the provided water hardness test strips to determine and record the incoming water hardness.

Refer to the below table for appropriate bypass settings. The default bypass setting is 3

| Hardness (ppm) | Bypass Setting | Filter Replacement Schedule (month) | Gallons |
|----------------|----------------|-------------------------------------|---------|
| 0 | 6 | 12 | 1000 |
| 50 | 5 | 9 | 800 |
| 120 | 3 | 6 | 500 |
| 250 | 2 | 4 | 200 |
| 425 | 0 | 2 | 100 |

2. If the bypass setting needs to be adjusted, use the following procedure. If the bypass setting does NOT need to be adjusted, proceed to flush the Claris filter.
3. Remove power from the unit.
4. Place a towel or pitcher under the Claris filter.
5. Ensure power is removed and/or unit is off.
6. Remove filter by turning counterclockwise and set aside filter.
Note: Place a towel or pitcher under filter to catch a small amount of water.
7. Remove the two bracket screws so that the underside of the filter head can be accessed.
8. To adjust the bypass level, insert the bypass setting key into the underside of the filter head, press key into filter head, and turn the bypass blending disc to the appropriate setting.
9. After positioning the bypass blending disc, remove and keep the bypass setting key.
10. Reinstall the bracket using the bracket screws.
11. Reinstall the Claris filter.
12. Reinstall front panel, ice dispense chute, and drip tray.

Internal Claris Filter Flushing Sequence

If your dispenser has the internal Claris filter option, the water filter *must* be flushed prior to use.

To flush the Claris filter, please complete the steps below.

1. Connect power supply and turn on power switch located on back of unit.
2. Place Flushing Hose in 1 gallon (or larger) bucket/container.
3. Rotate flushing valve $\frac{1}{4}$ turn clockwise so "OPEN" is pointing to the Flush Hose (**Fig. 11**).
4. Dispense approximately 1.5 gallons of water into a bucket. (If needed, rotate the flushing valve back to the "CLOSED" position to stop flushing, empty the bucket, then continue flushing until 1.5 gallons has been collected and discarded).

Fig. 11

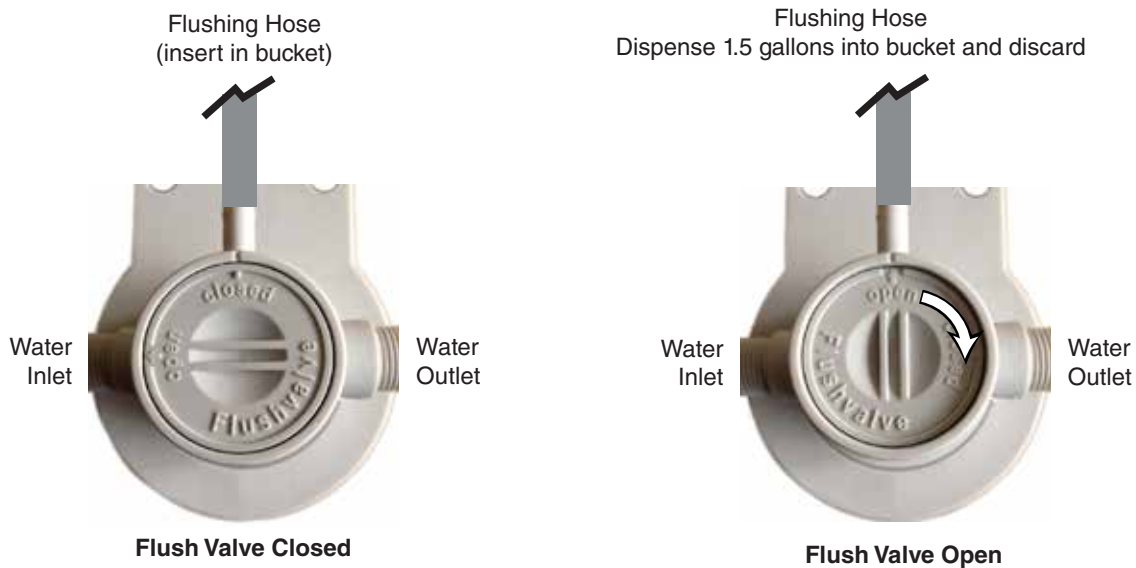

5. Rotate the flushing valve to "CLOSED" (with "OPEN" pointed to exit port of manifold).
6. Remove plug cap from the end of water reservoir drain tube and lower tube to drain water into bucket. After the system has been drained of water, replace plug cap in water reservoir drain tube.
7. Secure tube in holder.
8. Discard water collected in bucket.
9. Reassemble the unit.

User Interface Menu Access

The user interface has several menus that can be accessed for setting up and servicing the Champion unit.

1. To access the user interface menus, touch the Follett logo (Fig. 12.1), then touch  (Fig. 12.2), then touch the Follett logo again (Fig. 18.3).

Fig. 12



Select Language

The user interface can be set to display English, Spanish, or French.

1. To select a language (default is English), Choose *Operation Settings*, then *Language*.
2. Select your language from the dropdown menu.

Fig. 13

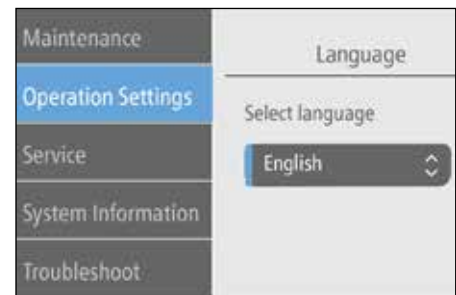

Hot Water Temperature and Display Setting (not available on 230 V units)

The default hot water temperature value is 120 and displayed in °F. To change the temperature or to display in °C, follow the steps below.

1. Access the UI menus, then choose *Operation Settings*, then *Hot Water*.
2. Select F or C from the dropdown menu.
3. Adjust the temperature setting using the arrows.

Fig. 14

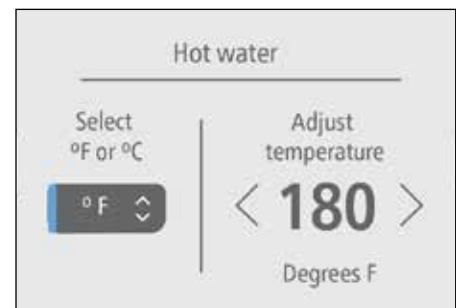

Filter Replacement Reminder

The filter replacement reminder can be set from 0 (off) to 12 months (default). Follett recommends setting the interval based on the results from the *Set Bypass Level on Internal Claris Filter Head* section.

1. Access the UI menus, then choose *Service*, then *Filter Interval*.
2. Adjust the interval setting using the arrows.

Fig. 15

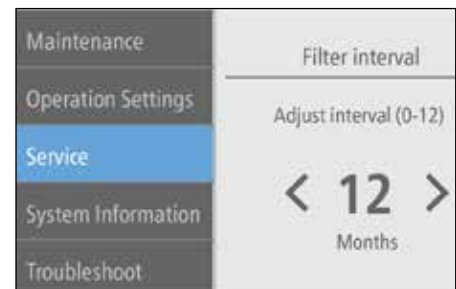

PM (Preventive Maintenance) Reminder – Clean and Sanitize

The PM reminder can be set from 0 (off) to 12 months. The PM reminder default is 6 months.

1. Access the UI menus, then choose *Service*, then *PM Interval*.
2. Adjust the interval setting using the arrows.

Fig. 16

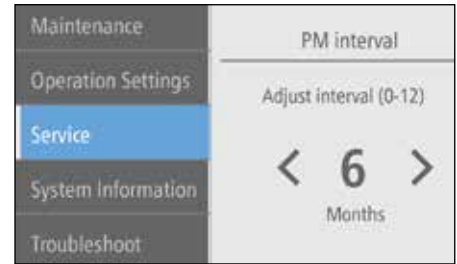

Clean and Sanitize the Unit

Clean and Sanitize Mode (All Operations Disabled) - Use when cleaning ice machine

Entering Clean and Sanitize Mode disables all operations and allows you to safely clean and/or sanitize the ice machine and dispenser.

1. To enter Clean and Sanitize Mode, touch the Follett logo (Fig. 17.1), then touch  (Fig. 17.2), then touch the Follett logo again (Fig. 23.3).

Fig. 17



2. Choose *Maintenance*, then *Clean and Sanitize* (Fig. 18).

Fig. 18

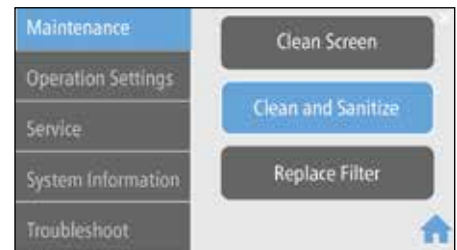

3. Dispense all ice out of the unit (Fig. 19).

Fig. 19

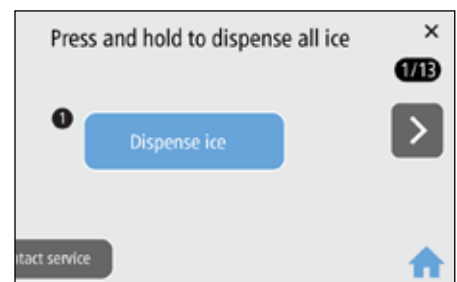

4. Remove the drip tray by pulling straight forward (Fig. 20).

Fig. 20



5. Unscrew the chute (**Fig. 21**).

Fig. 21

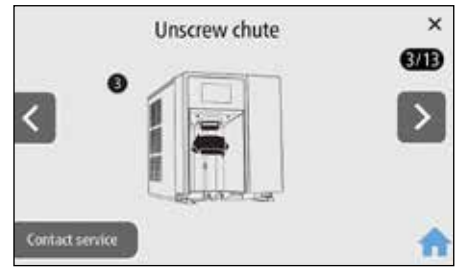

6. Remove the one screw securing the front cover (**Fig. 22**).

Fig. 22



7. Remove the front cover and set aside. Follett recommends setting the cover on the drip tray, which provides a stable base (**Fig. 23**). Be careful not to stretch or damage any cables connecting the front cover to the unit.

Fig. 23



8. Remove plug cap from end of drain tube and lower tube to drain water into bucket (**Fig. 24**). After the system has been drained of water, replace plug cap in drain tube and secure tube in holder.

Fig. 24

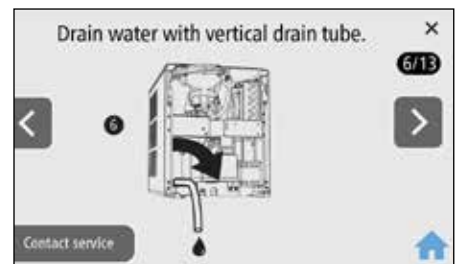

9. Rear drain units: Locate the storage bin drain tube pinch clamp and engage (close) (**Fig. 25**).

Fig. 25

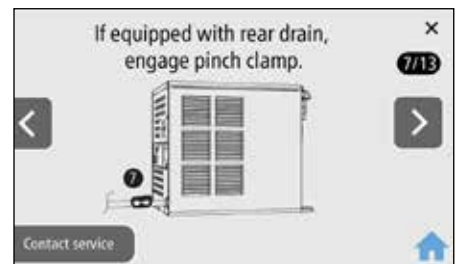

- Hot water tank units: Locate the pinch clamp and engage (close) (Fig. 26).

Fig. 26

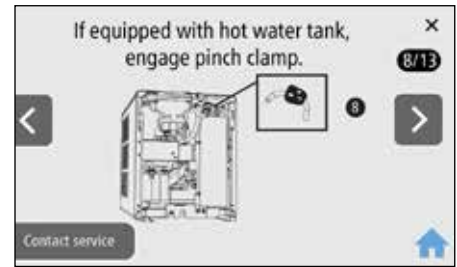

- Remove top sheet metal cover and remove cap from bin lid cover. Screw cap onto dispense chute (Fig. 27).

Fig. 27



- Fill ice bin with hot water (100F - 120F) to melt ice in evaporator. Wait 5 minutes and drain water.
- If equipped with rear drain, disengage pinch clamp, drain water and re-engage clamp.
- The cleaning and sanitizing instructions can be found on the label attached to the underside of the lid (Fig. 29).
- Follow the Cleaning and Sanitizing Procedure on the next page.

Fig. 28

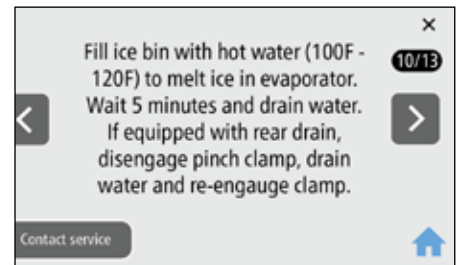

Fig. 29



16. Press and hold to fill with water. Alternately, fill manually through ice bin lid. Drain and repeat a second time (**Fig. 30**).

17. When the Cleaning and Sanitizing procedure is finished, replace cap, lid, right side panel, cover, chute and drip tray.

18. Press Complete (**Fig. 31**).

Fig. 30

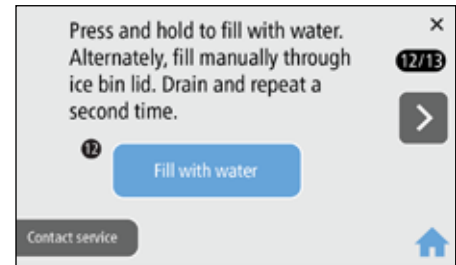
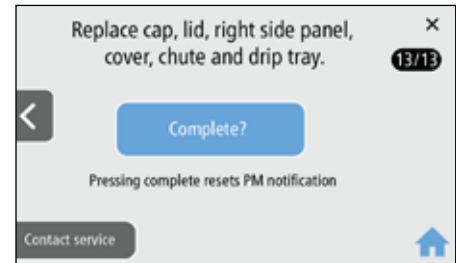

Fig. 31



Cleaning and Sanitizing Procedure

Cleaning and sanitizing should be performed during initial installation and at least every 6 months (more often if local water conditions dictate).

WARNING!

- Place the dispenser in Clean and Sanitize Mode prior to servicing or cleaning the ice machine.
- For protection, rubber gloves and safety goggles (and/or face shield) should be worn when handling SafeCLEAN Plus™.
- Do not use bleach, it will damage the dispenser.

Required Supplies

- Champion 7: 24 oz. (0.71 L) SafeCLEAN Plus™ liquid
- Champion 15: 48 oz. (1.42 L) SafeCLEAN Plus™ liquid
- Funnel
- Bucket
- Multi-head screwdriver
- Towels

Ice Machine and Dispenser

If no power to the unit, please follow the user interface (UI) steps below or refer to the Champion 7/15 service manual at follettice.com.

1. Touch  located on the upper right corner of the user interface. Scroll down and select Cleaning and Sanitizing from the menu.
2. Begin the cleaning and sanitizing procedure using the user interface:
 - (UI 1) Dispense all ice out of the unit.
 - (UI 2) Remove the drip tray by pulling straight forward.
 - (UI 3) Unscrew the chute.
 - (UI 4) Remove the one screw securing the front cover.
 - (UI 5) Remove the front cover and set aside. Follett recommends setting the cover on the drip tray, which provides a stable base. Be careful not to stretch or damage any cables connecting the front cover to the unit.
 - (UI 6) Remove plug cap from end of drain tube and lower tube to drain water into bucket. After the system has been drained of water, replace plug cap in drain tube and secure tube in holder.
 - (UI 7) Rear drain units: Locate the storage bin drain tube pinch clamp and engage (close).
 - (UI 8) Hot water tank units: Locate the pinch clamp and engage (close).
 - (UI 9) Remove top sheet metal cover and remove cap from bin lid cover. Screw cap onto dispense chute.
 - (UI 10) Fill ice bin with hot water (100 F – 120 F) to melt ice in evaporator. Wait 5 minutes and drain water. If equipped with rear drain, disengage pinch clamp, drain water and re-engage clamp.
 - (UI 11) Locate lid. Follow instructions below.
3. Champion 7: Mix 24 oz. (0.71 L) SafeCLEAN Plus liquid with three gallons (11.4 L) of hot (100 F – 120 F) water.
Champion 15: Mix 48 oz. (1.42 L) SafeCLEAN Plus liquid with six gallons (22.7 L) of hot (100 F – 120 F) water.
4. Pour SafeCLEAN Plus solution into bin lid access spout until solution reaches the spout neck. Verify solution maintains level at the spout neck. Allow solution to remain in unit for 15 minutes.
5. Remove right side panel to access and clean the condenser.
6. Submerge dispense chute, drip tray and drip tray grill in the remainder of solution for 2 minutes. Rinse with clean, potable water.
7. Drain system by lowering drain tube into bucket. Return drain tube back into position.

8. Rear drain units: Disengage the storage bin drain tube pinch clamp until cleaning solution is drained, then engage the storage bin drain tube pinch clamp.
9. (UI 12) Fill and drain twice with potable water. Unit can be filled by pressing the Dispense Water button on the user interface or fill manually through ice bin lid. Return drain tube back into position when complete
Rear drain units: Disengage the storage bin drain tube pinch clamp when complete.
Hot tank units: Disengage the hot tank vent tube pinch clamp when complete.
10. Place a bucket under the dispense chute and remove cap. Caution: Some solution will remain and drain out when cap is removed.
11. (UI 13) When the Cleaning and Sanitizing procedure is finished, replace cap, lid, right side panel, cover, chute and drip tray. Press Complete on the user interface.
12. Dispense water for 5 seconds to rinse the dispense tube. (Hot water units: Dispense hot water for 5 seconds.)

Exterior Cabinet

1. To enter Cleaning Screen Mode, press ?.
2. Choose Clean Screen, then Lock.
3. Clean the user interface screen using a damp - not wet - nonabrasive cloth and mild detergent, if necessary.
4. Press and hold the unlock button to unlock the user interface.

Clean the User Interface Screen

Clean Screen Mode (Dispensing Disabled) - Use when cleaning surface

Entering Clean Screen Mode disables the User Interface and allows you to clean the outside of the dispenser without accidentally dispensing ice and/or water.



1. To enter Cleaning Screen Mode, touch the Follett logo (**Fig. 32.1**), then touch  (**Fig. 32.2**), then touch the Follett logo again (**Fig. 32.3**).
2. Choose *Maintenance*, then *Clean Screen*, then *Lock*
3. Clean the user interface screen using a damp - not wet - nonabrasive cloth and mild detergent if necessary.
4. When done, choose *Unlock* for approximately 5 seconds and then press .

Fig. 32



Fig. 33



Operation

Note: If "Touchless" is activated, simply placing a finger near the button will cause dispensing.

To dispense ice

1. Place cup under ice/water dispense chute.
2. Touch "ICE" button in center of circle. Once depressed, ice will start dispensing into glass on user interface and into cup placed under ice chute.
3. Maximum continuous dispense is 60 seconds. If more ice is needed, release and touch ice dispense once again.
4. Once cup is filled to desired level, release button and remove cup.

Fig. 34

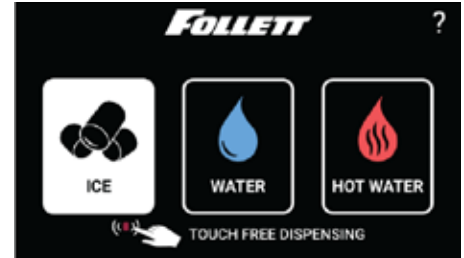

To dispense hot water (Not available on 230 V models)



WARNING!

Boiling water can cause severe burns. Use caution when dispensing.

1. Place cup under ice/water dispense chute.
2. Touch "HOT WATER" button. Once touched, a secondary safety menu will be displayed.
3. Press and hold "HOT WATER" button. Once cup is filled to desired level, release button and remove cup.
4. After button is released, screen will return to home screen in approximately 5 seconds.

Fig. 35



To dispense water

1. Place cup under ice/water dispense chute.
2. Touch "WATER" button in center of circle. Once depressed, water will start dispensing into glass on user interface and into cup placed under ice chute.
3. Maximum continuous dispense is 60 seconds. If more water is needed, release and water ice dispense once again.
4. Once cup is filled to desired level, release button and remove cup.

User Interface

From the Home screen, touch the Follett logo, then touch , then touch the Follett logo again.

| Maintenance | |
|--------------------|---|
| Clean Screen | <ul style="list-style-type: none"> ▪ Lock screen, clean User Interface with a damp (not wet) non abrasive cloth and unlock screen when finished. |
| Clean and Sanitize | <ul style="list-style-type: none"> ▪ Follow cleaning procedure outlined in service manual and on bottom side of top cover ▪ Reset cleaning PM Timer |
| Replace Filter | <ul style="list-style-type: none"> ▪ Remove old filter turning counterclockwise and install new filter turning clockwise ▪ Reset filter PM Timer |

| | |
|---|---|
| Preventive Maintenance Interval (see Preventive Maintenance Setting table that follows) | ▪ Adjust from 1 to 6 month interval based on water chemistry in 1 month increments (Default 6 months) |
| Filter Interval | ▪ Adjust from 1 to 6 month interval based on water chemistry in 1 month increments (Default 6 months) |
| Operation Settings | |
| Sleep Mode | ▪ Adjust from 0 to 240 minutes in 20 minute increments (default is 240 minutes) |
| Language | ▪ Select English, Espanol, Francais (default is English) |
| Brightness | ▪ Adjust brightness from 10 to 100 in increments of 5 (Default 80) |
| Hot Water Temp | ▪ Temperature adjusts from 100 F to 185 F degrees in 1 degree increments (Default 180 F) |
| Service | |
| TDS Flush Cycle (future) | ▪ Low range = 10 to 200 TDS, Hi range is 201 to 400 TDS (Default 10-200) |
| Time Delay | ▪ Short range = 15 minutes, Long range = 30 minutes (Default is 15 minutes) |
| Wake On Dispense | ▪ Adjust from 0 to 120 seconds in 1 second increments (Default is 35 s) |
| Flush Enabled (future) | ▪ Time Delay ▪ Self ▪ Shuttle |
| Screen Timeout | ▪ Adjust from 30 to 300 seconds in increments of 30 seconds (Default 120 s) |
| System Information | |
| Model Number | ▪ EXAMPLE: 7CI112A |
| Serial Number | ▪ EXAMPLE: L54179 |
| Water Filter | ▪ INSTALLED/NOT INSTALLED |
| Drain (drip tray/ice bin) | ▪ INSTALLED/NOT INSTALLED ▪ Drip tray drain ▪ Ice bin drain |
| Hot Water | ▪ INSTALLED/NOT INSTALLED |
| Ambient Water | ▪ INSTALLED/NOT INSTALLED |
| IMC Software Version | ▪ Version # |
| UI Software Version | ▪ Version # |
| Troubleshoot | |
| Drip Tray Full | ▪ Remove drip tray, empty water, clean and dry tray and terminals before re-installing |
| Low Water | ▪ Contact Service |
| Water Leak | ▪ Contact Service |
| Event Log | ▪ Tracks events as they occur |
| Manual QR Code | ▪ Scan QR code with smart phone to access service manuals |

Preventive Maintenance Setting

To determine the correct preventive maintenance interval for your application, use either the TDS or Hardness tables below. If you use both the TDS and Hardness and your values are not the same, Follett recommends that you use the lowest value (shortest interval). Without evidence of regular preventive maintenance, warranty will be void. Unit needs to be installed with proper filtration system that provides TDS/hardness within Follett specifications.

| TDS - ppm | |
|------------------|------------------------|
| TDS Range (ppm) | PM Schedule (Months) |
| 10 to 150 | 6 |
| 151 to 250 | 4 |
| 251 to 350 | 3 |
| 351 to 400 | 2 |
| 401 and above | RO/Filtration Required |

| Hardness - ppm | |
|-----------------------|------------------------|
| Hardness Range (ppm) | PM Schedule (Months) |
| 0 to 60 | 6 |
| 61 to 120 | 4 |
| 121 to 180 | 3 |
| 181 to 200 | 2 |
| 201 and above | RO/Filtration Required |

User Interface Alerts

Fig. 36 Interface Alert Examples

Alert type 1

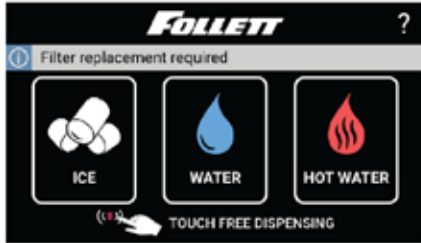



Alert type 2

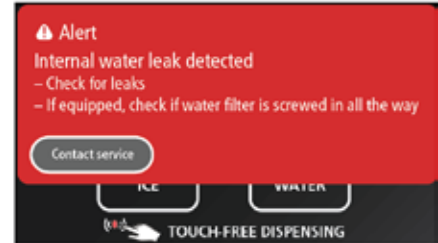

Alert type 3



| Interface Display | Condition | Remedy |
|------------------------------|--|--|
| Alert Type 1 | | |
| Clean and Sanitize | Maximum 6 month maintenance required (Adjustable 1 to 6 months) | Follow PM cleaning procedure in service manual and reset timer |
| Filter Replacement Required | Maximum 6 month filter replacement required (Adjustable 1 to 6 months) | |
| Low Water | Reservoir sensors are not detecting water | Verify water is turned "ON" and internal filter has been installed. If this does not correct problem, unit will need to be serviced |
| Alert Type 2 | | |
| Empty Drip Tray | Drip tray full of water contacting tray sensors | Empty drip tray, dry tray/terminals and reinstall |
| Alert Type 3 | | |
| Internal Water Leak Detected | Unit has internal water leak contacting chassis sensors | <ul style="list-style-type: none"> ▪ Dry chassis, locate leak and repair ▪ Reset from user interface menu (Follett, , Follett), Service → Advanced → enter access code → Control Board Reset → yes →  ▪ Or, reset control board manually by pressing reset button |

Machine Status

Procedure for viewing status indicators: From the Home screen, touch  to enter help screen. Status will be displayed on right side of screen.

Fig. 37 Help Screen Example



| Interface Display | Condition | Remedy |
|-------------------|--|---|
| Time Delay | Ice bin is full and unit is placed into 15 minute time delay (15 or 30 minutes) | After 15 minutes unit will exit time delay |
| Sleep Mode | If unit has not be used during time delay, unit will enter sleep mode (adjustable 0 to 240 minutes). | To exit sleep mode you must dispenser ice for 35 seconds of accumulated time |
| Making Ice | Normal ice operation | Normal ice operation |
| Flush Enabled | Future | Future |
| Low Bin | Ice bin shuttle micro switch activated | This indicates full bin of ice. Inspect bin and take corrective action if bin is not full |
| Low Water | Reservoir sensors are not detecting water | Verify water is turned "ON" and internal filter has been installed. If this does not correct problem, unit will need to be serviced |

Electrical Wiring Diagram

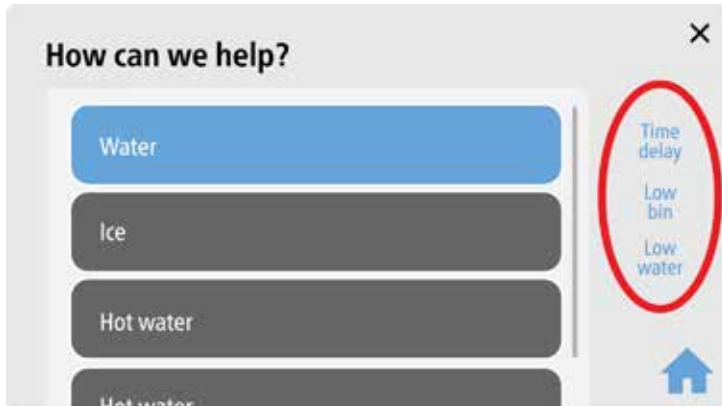
01545888R01

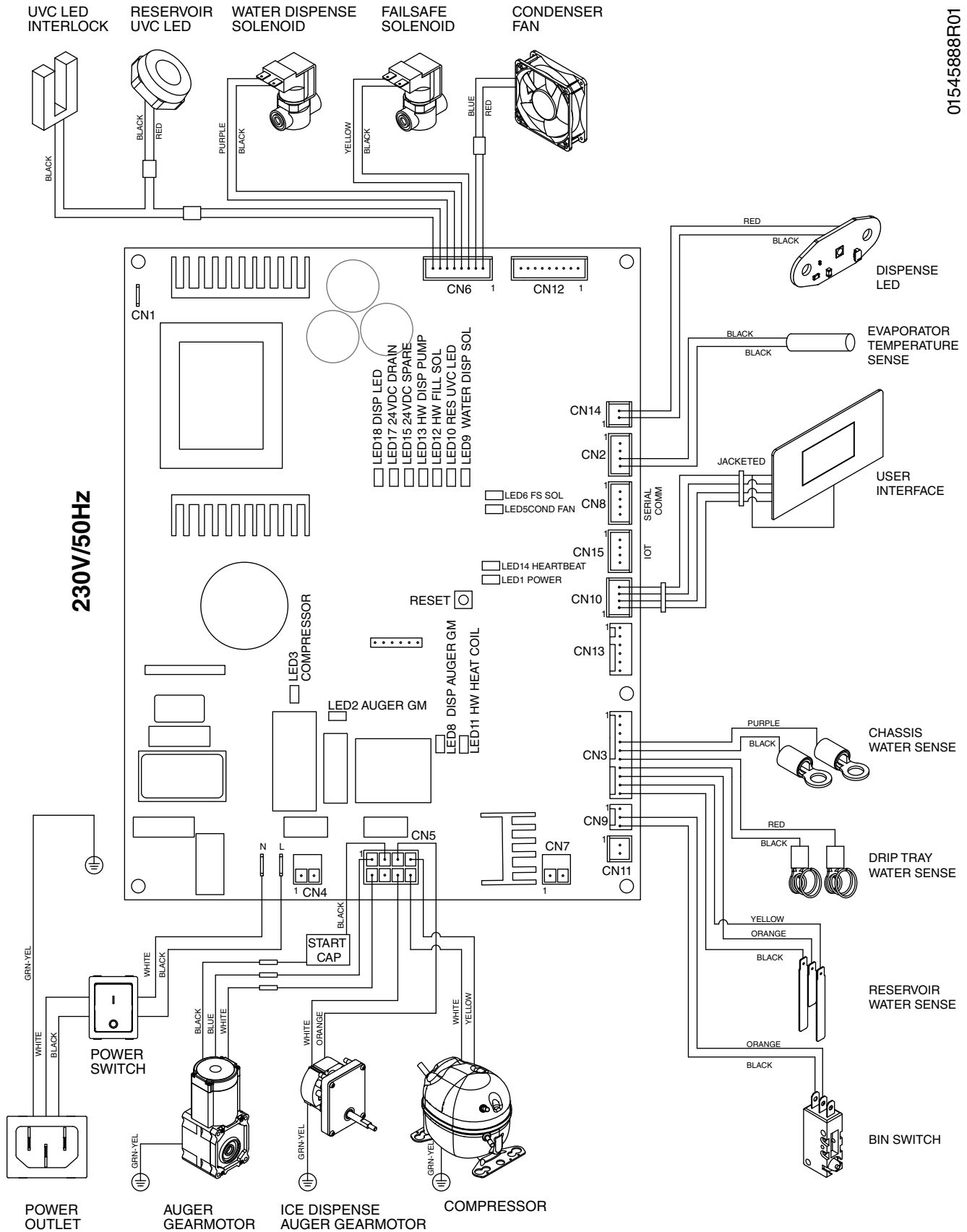

Control Board Output LEDs and Connections

| Status LED | Function | Power | Connector | Pins | Input/Output |
|------------|--------------------------------|-------------|-----------|-------------|--------------|
| 1 | Power "ON" | 5 VDC | Internal | — | Internal |
| 2 | Auger Gear Motor | 230/220 VAC | CN5 | 1, 2 Cap, 8 | Output |
| 3 | Compressor | 230/220 VAC | CN5 | 4, 5 | Output |
| 5 | Condenser Fan | 24 VDC | CN6 | 1, 2 | Output |
| 6 | Failsafe Solenoid | 24 VDC | CN6 | 3, 4 | Output |
| 8 | Ice Dispense Auger Motor | 230/220 VAC | CN5 | 3, 6 | Output |
| 9 | Water Dispense Solenoid | 24 VDC | CN6 | 5, 6 | Output |
| 10 | Reservoir UV LED/Interlock | 24 VDC | CN6 | 7, 8 | Output |
| 11* | Hot Tank Output Heating Coil | 120/220 VAC | CN7 | 1, 2 | Output |
| 12* | Hot Tank Fill Solenoid | 24 VDC | CN12 | 1, 2 | Output |
| 13* | Hot Water Dispense Pump | 24 VDC | CN12 | 3, 4 | Output |
| 14 | Heart Beat (Model Code) | 5 VDC | Internal | — | Internal |
| 15 | Spare Output # 1 (VDC) | 24 VDC | — | — | Future |
| 17 | Spare Output # 2 (Drain) | 24 VDC | — | — | Future |
| 18 | Dispenser LED VYV Light - Blue | 24 VDC | CN14 | 1, 2 | Output |

* Not available on 230 V models.

Miscellaneous

| Description | Part # |
|----------------------------|--------------------------|
| Claris Filter | 01548635 |
| SafeCLEAN Plus, case of 6 | 01149954 |
| SafeCLEAN Plus, case of 24 | 01149962 |

Warranty Registration and Equipment Evaluation

Thank you for purchasing Follett® equipment. Our goal is to deliver high value products and services that earn your complete satisfaction by delivering high-value products and services backed by outstanding customer and technical support.

Please review the installation instructions thoroughly. It is important that the installation be performed to factory specifications so your equipment operates at its maximum efficiency.

Follett LLC will not be liable for any consequential damages, expenses, connecting or disconnecting charges, or any losses resulting from a defect of the machine. For full warranty details, visit our website www.follettice.com/productwarranties.

Registering your equipment helps Follett track your equipment's service history should you need to contact us for technical support, and your feedback helps us improve our products and services. Please visit www.follettice.com/support to complete the Warranty Registration form.

Should you have any questions, please contact Follett's technical support group at (877) 612-5086 or (610) 252-7301 and we will be happy to assist you.

Champion and SafeCLEAN Plus are trademarks of Follett Products, LLC.
Chewblet and Follett are registered trademarks of Follett Products, LLC, registered in US.



801 Church Lane • Easton, PA 18040, USA
Toll free (877) 612-5086 • +1 (610) 252-7301
www.follettice.com

01545870R00
© Follett Products, LLC 12/23