

Commercial Urn Technical Information – Installation Instructions

PROPRIETARY RIGHTS NOTICE This document and all information contained within it is the property of Hamilton Beach Brands, Inc. (HBB). It is confidential and proprietary and has been provided to you for a limited purpose. It must be returned or destroyed upon request. Disclosure, reproduction or use of this document and any information contained within it, in full or in part, for any purpose is forbidden without the prior written consent of HBB. No photographs may be taken of any article fabricated or assembled from this document without the prior written consent of HBB.

For Install:

1. Attach O-Ring (B) and Screw Fastener (A) to Water Gauge (I) where indicated by dashed lines.
2. Insert Hex Bolt (C) and Steel Washer (D) into Urn
3. Place Plastic Washer (E) on Hex Bolt (C) outside of Urn
4. Insert Water Gauge Gasket (H) into Faucet Head [do not tighten Screw Fastener (A) to Faucet Head (F) yet]
5. If separate, attach Spout Handle (G) to Faucet Head (F)
6. Insert Water Gauge (I) through plastic retainer on Urn
7. Lift Water Gauge (I) and tighten Faucet Assembly onto Hex Bolt (C).
8. Align Water Gauge (I) and tighten to Screw Fastener (A) to Faucet Assembly

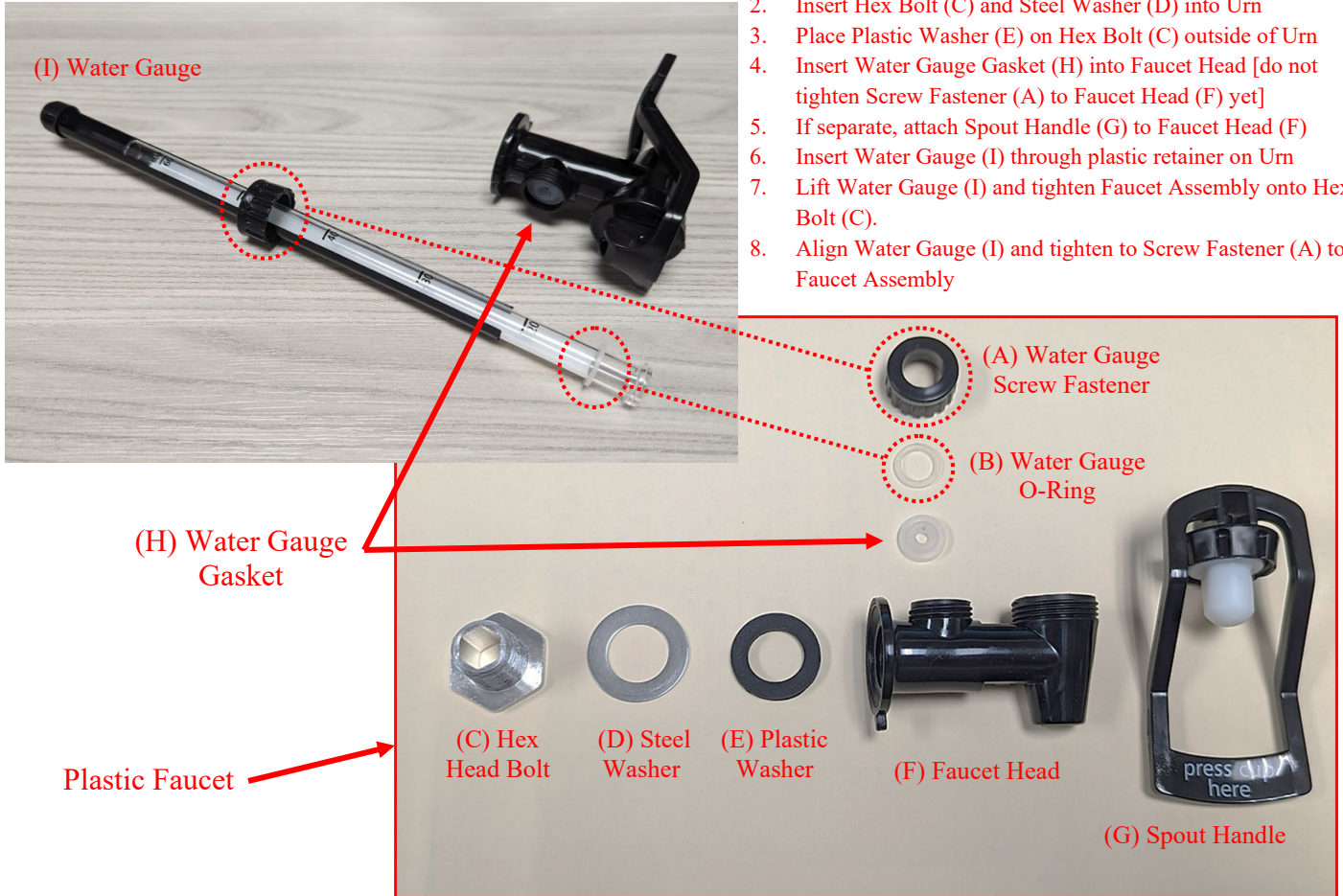

Outside Urn



Inside Urn

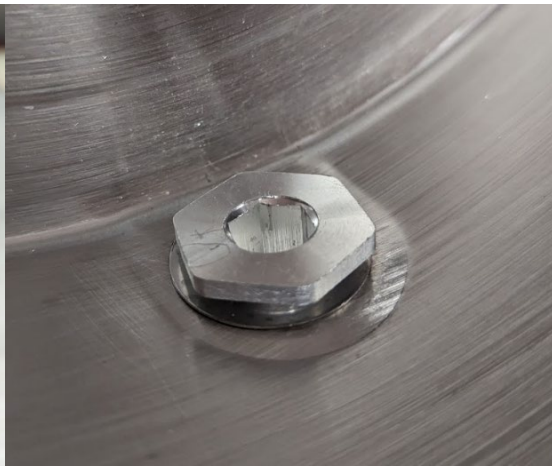

 Hamilton Beach 4421 Waterfront Drive Glen Allen, VA 23060	Revision Description:	Production Release.					
	Request Number:	DOC13132	Revision Date:	23-May-2023	Approved by:	DOC13132	
	Issue Code(s):		Page:	1 of 1	Document #:	520011500	Rev: