

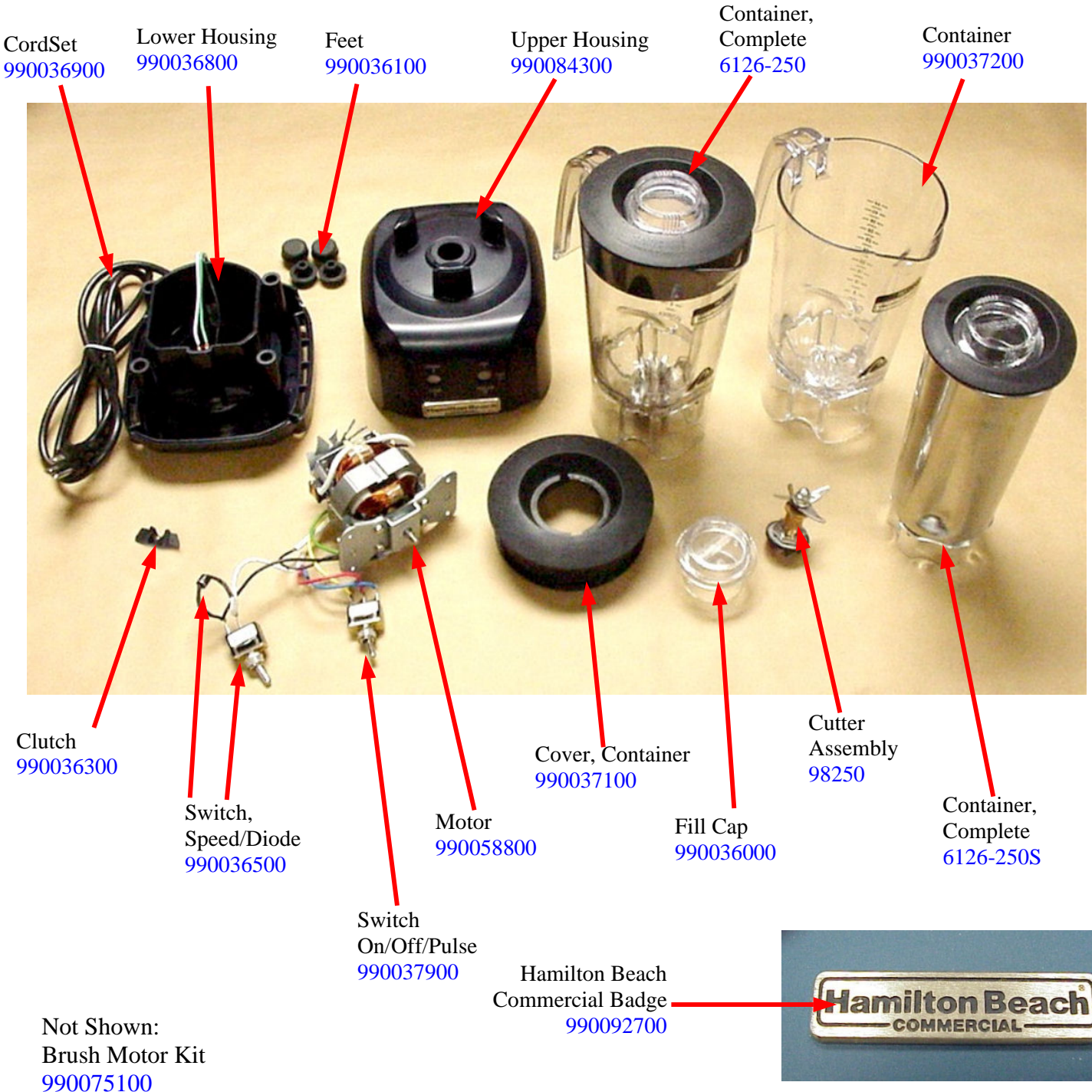

Replacement Parts Diagram

Model HBB250 (Series A-C & HBB250R (Series A-D))

PROPRIETARY RIGHTS NOTICE This document and all information contained within it is the property of Hamilton Beach Brands, Inc. (HBB). It is confidential and proprietary and has been provided to you for a limited purpose. It must be returned or destroyed upon request. Disclosure, reproduction or use of this document and any information contained within it, in full or in part, for any purpose is forbidden without the prior written consent of HBB. No photographs may be taken of any article fabricated or assembled from this document without the prior written consent of HBB.



	Revision Description:		Changed upper housing part number			
	Request Number:	CME-2736	Revision Date:	11/23/09	Approved by:	CME-2736
	Issue Code(s):	SP, CS	Page:	1 of 3	Document #:	510000300
					Rev:	L

Replacement Parts Diagram

Model HBB250 (Series A-C & HBB250R (Series A-D))

PROPRIETARY RIGHTS NOTICE This document and all information contained within it is the property of Hamilton Beach Brands, Inc. (HBB). It is confidential and proprietary and has been provided to you for a limited purpose. It must be returned or destroyed upon request. Disclosure, reproduction or use of this document and any information contained within it, in full or in part, for any purpose is forbidden without the prior written consent of HBB. No photographs may be taken of any article fabricated or assembled from this document without the prior written consent of HBB.

Cutter Assembly Replacement Instructions

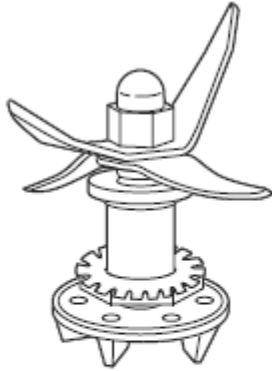

**Cutter Repair Kit
for Rio Blenders**



⚠ WARNING



Cut Hazard
Handle cutter
assembly with
care.
Failure to follow
these instructions
can result in cuts
or other injuries.

Removing the old cutter assembly



Hold the blades with a
cloth. Unscrew the clutch
counterclockwise.



Remove the clutch and
felt washer.



Remove the shaft and
blade assembly

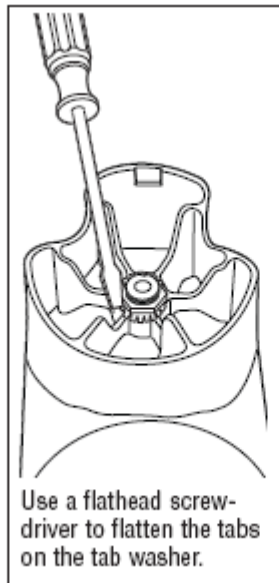

Use a flathead screw-
driver to flatten the tabs
on the tab washer.

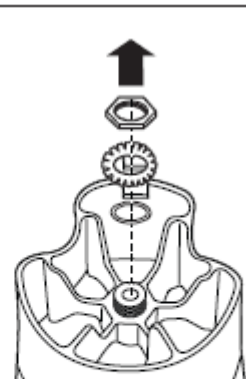

Remove the nut by
turning counterclockwise
by hand. Then remove
the tab washer and
pressure washer.

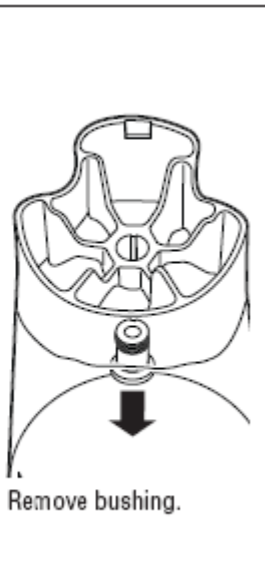

Remove bushing.

<p>4421 Waterfront Drive Glen Allen, VA 23060</p>	Revision Description: Changed upper housing part number		Revision Date: 11/23/09		Approved by: CME-2736	
	Request Number: CME-2736	Page: 2 of 3		Document #: 510000300		Rev: L
	Issue Code(s): SP, CS					

Replacement Parts Diagram

Model HBB250 (Series A-C & HBB250R (Series A-D))

PROPRIETARY RIGHTS NOTICE This document and all information contained within it is the property of Hamilton Beach Brands, Inc. (HBB). It is confidential and proprietary and has been provided to you for a limited purpose. It must be returned or destroyed upon request. Disclosure, reproduction or use of this document and any information contained within it, in full or in part, for any purpose is forbidden without the prior written consent of HBB. No photographs may be taken of any article fabricated or assembled from this document without the prior written consent of HBB.

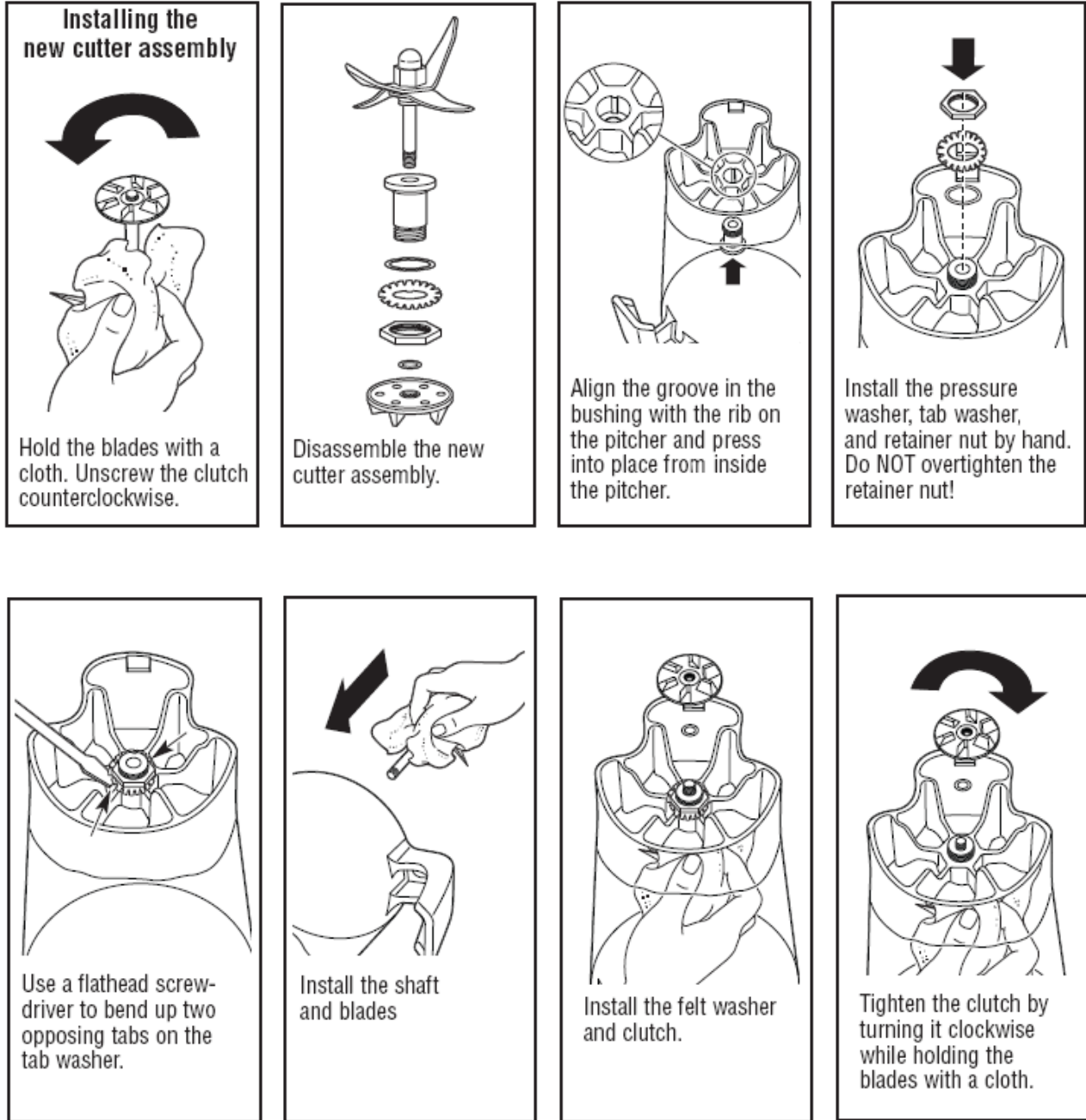

Installing the new cutter assembly



Hold the blades with a cloth. Unscrew the clutch counterclockwise.

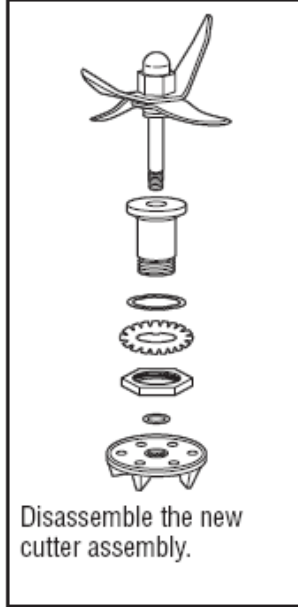

Disassemble the new cutter assembly.

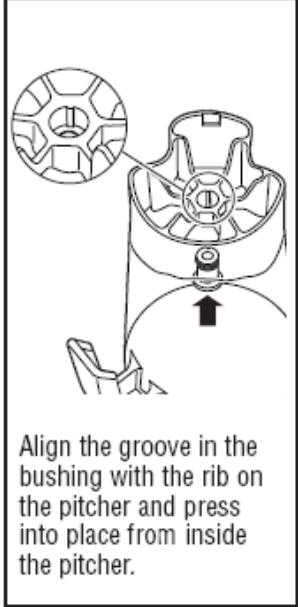

Align the groove in the bushing with the rib on the pitcher and press into place from inside the pitcher.

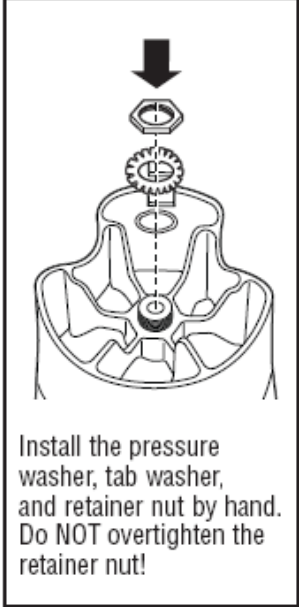

Install the pressure washer, tab washer, and retainer nut by hand. Do NOT overtighten the retainer nut!

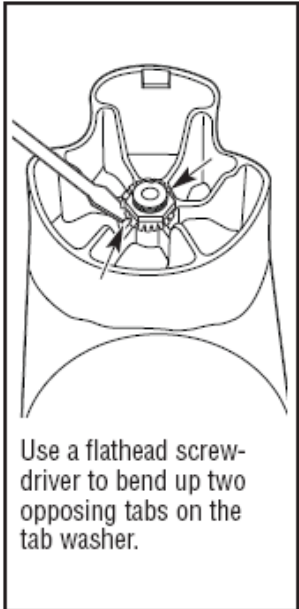

Use a flathead screwdriver to bend up two opposing tabs on the tab washer.

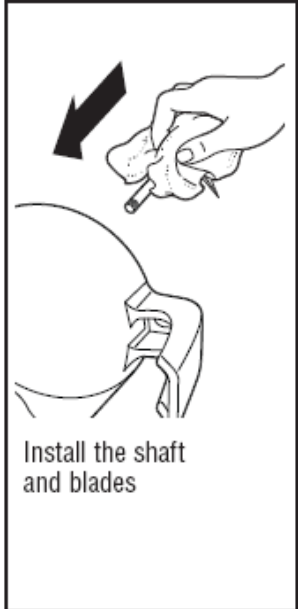

Install the shaft and blades

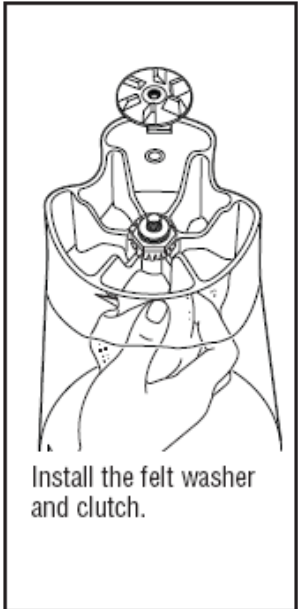

Install the felt washer and clutch.

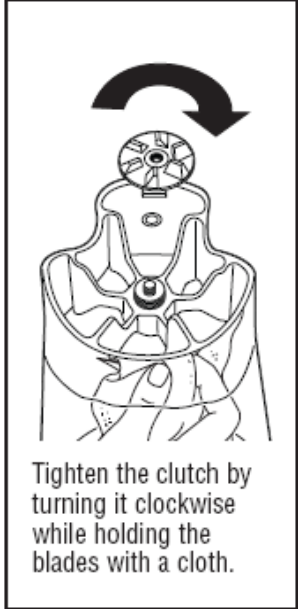

Tighten the clutch by turning it clockwise while holding the blades with a cloth.

<p>4421 Waterfront Drive Glen Allen, VA 23060</p>	Revision Description: Changed upper housing part number		Revision Date: 11/23/09		Approved by: CME-2736	
	Request Number: CME-2736	Page: 3 of 3		Document #: 510000300		Rev: L
	Issue Code(s): SP, CS					