

## Parts and Accessories Diagram

### HMD200

**PROPRIETARY RIGHTS NOTICE** This document and all information contained within it is the property of Hamilton Beach Brands, Inc. (HBB). It is confidential and proprietary and has been provided to you for a limited purpose. It must be returned or destroyed upon request. Disclosure, reproduction or use of this document and any information contained within it, in full or in part, for any purpose is forbidden without the prior written consent of HBB. No photographs may be taken of any article fabricated or assembled from this document without the prior written consent of HBB.

**\*To replace Toggle Switch, Switch Upgrade Kit must be used with new Top Cover and Switch Adaptor.**

Boot (Not Shown)  
990081300

Switch Upgrade Kit (series A-D) – 990092800  
Includes: Top Cover, Toggle Switch, Boot, Grounding Wire, and Switch Adaptor.

**\*\*Original Top Cover can be replaced if original Toggle Switches are in place and do not need to be replaced. If already upgraded, use Top Cover 990083700.**

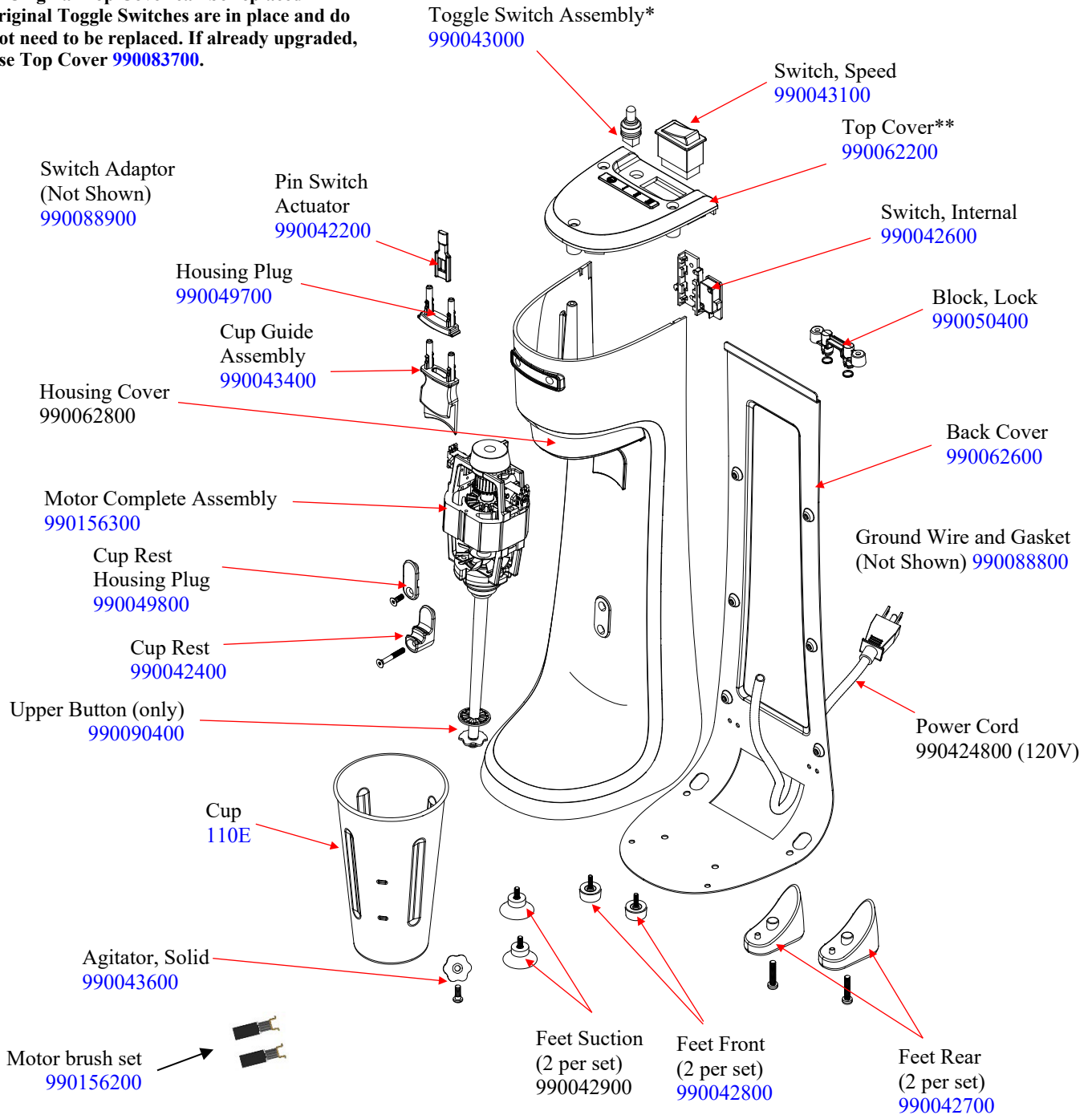

 Hamilton Beach 4421 Waterfront Drive Glen Allen, VA 23060	Revision	Update Power Cord Part number				Rev. Date:
	Description:	DOC14038	Page:	1 of 2	Document #:	7/2/2024
Request #:	DOC14038	Page:	1 of 2	Document #:	540009901	Rev: C

# Parts and Accessories Diagram

## HMD200

**PROPRIETARY RIGHTS NOTICE** This document and all information contained within it is the property of Hamilton Beach Brands, Inc. (HBB). It is confidential and proprietary and has been provided to you for a limited purpose. It must be returned or destroyed upon request. Disclosure, reproduction or use of this document and any information contained within it, in full or in part, for any purpose is forbidden without the prior written consent of HBB. No photographs may be taken of any article fabricated or assembled from this document without the prior written consent of HBB.

### Accessories

Agitator,  
Alternative  
929

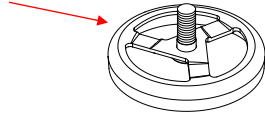

Agitator,  
Alternate  
928



 4421 Waterfront Drive Glen Allen, VA 23060	Revision	Update Power Cord Part number					Rev. Date:	
	Description:						7/2/2024	
	Request #:	DOC14038	Page:	2 of 2	Document #:	540009901	Rev:	C