

Parts and Accessories Diagram Model HMD400

PROPRIETARY RIGHTS NOTICE This document and all information contained within it is the property of Hamilton Beach Brands, Inc. (HBB). It is confidential and proprietary and has been provided to you for a limited purpose. It must be returned or destroyed upon request. Disclosure, reproduction or use of this document and any information contained within it, in full or in part, for any purpose is forbidden without the prior written consent of HBB. No photographs may be taken of any article fabricated or assembled from this document without the prior written consent of HBB.

Replacement Parts

***To replace Toggle Switch, Switch Upgrade Kit must be used with new Top Cover and Switch Adaptor.**

****Original Top Cover can be replaced if original Toggle Switches are in place and do not need to be replaced. If already upgraded, use Top Cover 990083800.**

Switch Upgrade Kit (series A-D) – 990092900
Includes: (1)Top Cover, (3)Toggle Switch, (3)Boot, (3)Grounding Wire, and (3)Switch Adaptor.

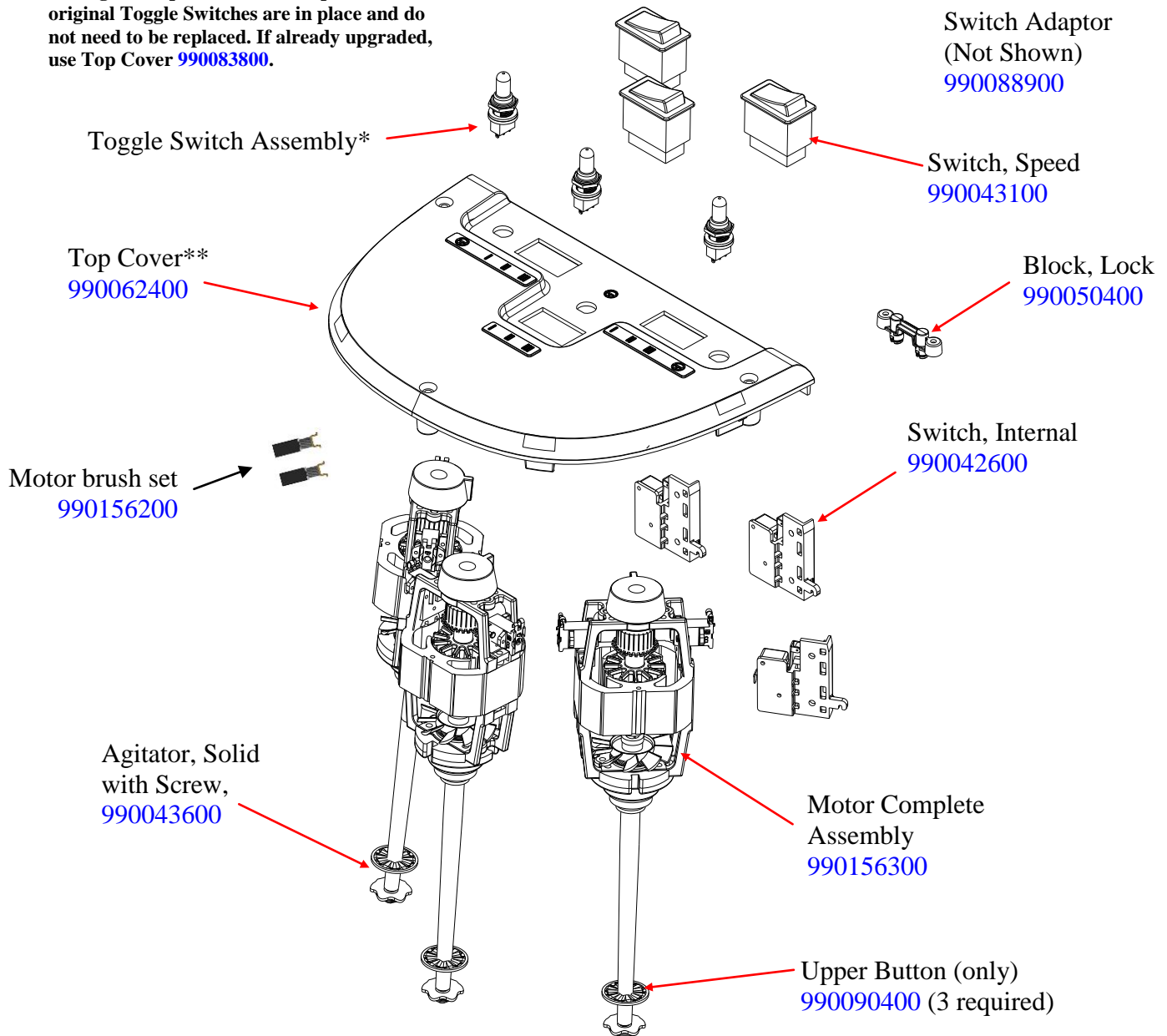

<p>Hamilton Beach 4421 Waterfront Drive Glen Allen, VA 23060</p>	Revision Description:	Added cord strain relief					
	Request Number:		Revision Date:	5/14/14	Approved by:	DOC4776	
	Issue Code(s):	CS, SP	Page:	1 of 3	Document #:	540009904	Rev:

Parts and Accessories Diagram Model HMD400

PROPRIETARY RIGHTS NOTICE This document and all information contained within it is the property of Hamilton Beach Brands, Inc. (HBB). It is confidential and proprietary and has been provided to you for a limited purpose. It must be returned or destroyed upon request. Disclosure, reproduction or use of this document and any information contained within it, in full or in part, for any purpose is forbidden without the prior written consent of HBB. No photographs may be taken of any article fabricated or assembled from this document without the prior written consent of HBB.

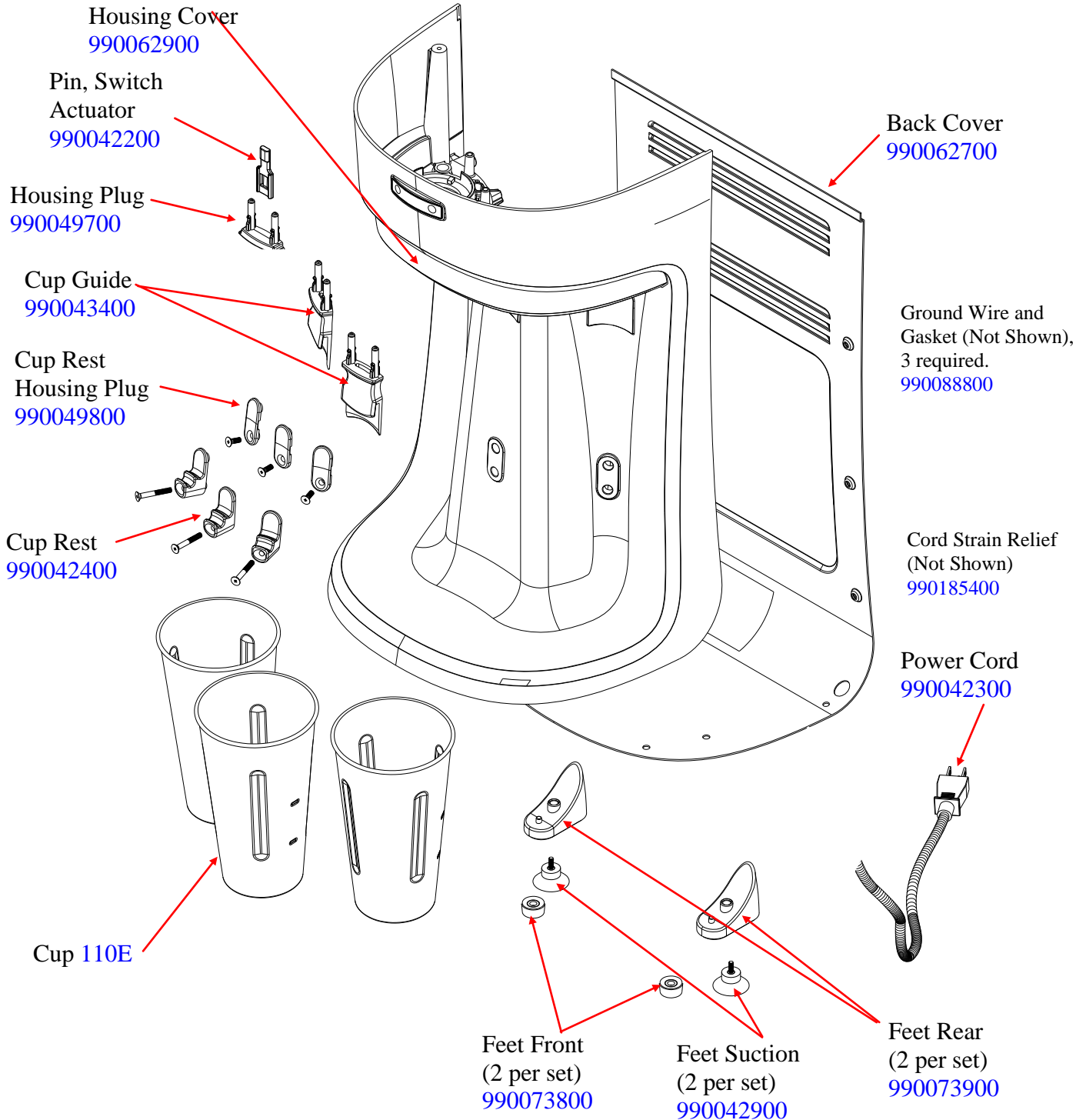

 Hamilton Beach 4421 Waterfront Drive Glen Allen, VA 23060	Revision Description:	Added cord strain relief					
	Request Number:		Revision Date:	5/14/14	Approved by:	DOC4776	
	Issue Code(s):	CS, SP	Page:	2 of 3	Document #:	540009904	Rev:

Parts and Accessories Diagram Model HMD400

PROPRIETARY RIGHTS NOTICE This document and all information contained within it is the property of Hamilton Beach Brands, Inc. (HBB). It is confidential and proprietary and has been provided to you for a limited purpose. It must be returned or destroyed upon request. Disclosure, reproduction or use of this document and any information contained within it, in full or in part, for any purpose is forbidden without the prior written consent of HBB. No photographs may be taken of any article fabricated or assembled from this document without the prior written consent of HBB.

Accessories

Agitator,
Alternative
929

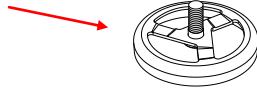

Agitator,
Alternate
928



Impellor,
Agitator
930



 4421 Waterfront Drive Glen Allen, VA 23060	Revision Description:		Added cord strain relief							
	Request Number:		Revision Date:		5/14/14		Approved by:		DOC4776	
	Issue Code(s):		CS, SP		Page: 3 of 3		Document #:		540009904	