

Assembly

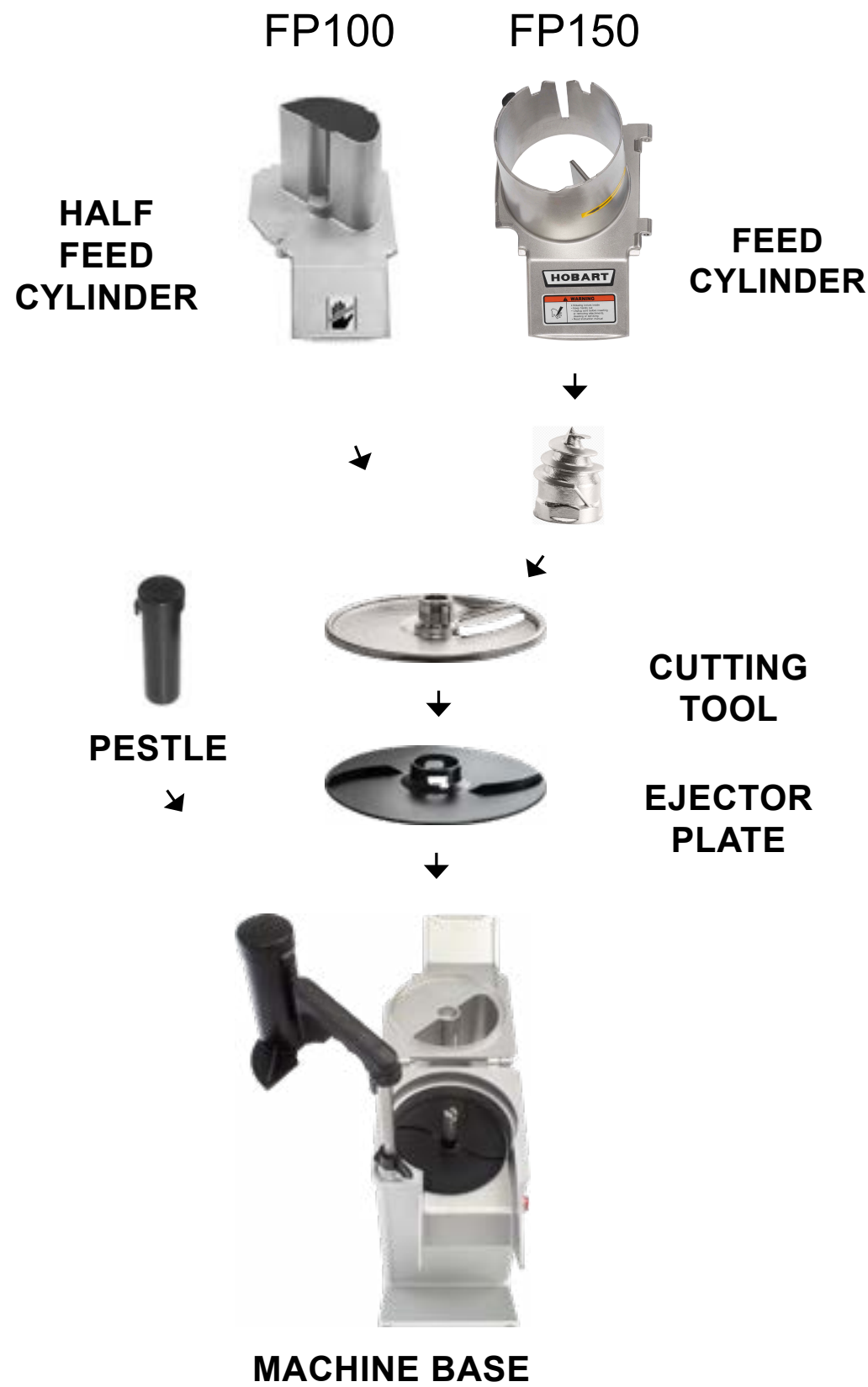

FP250/FP350

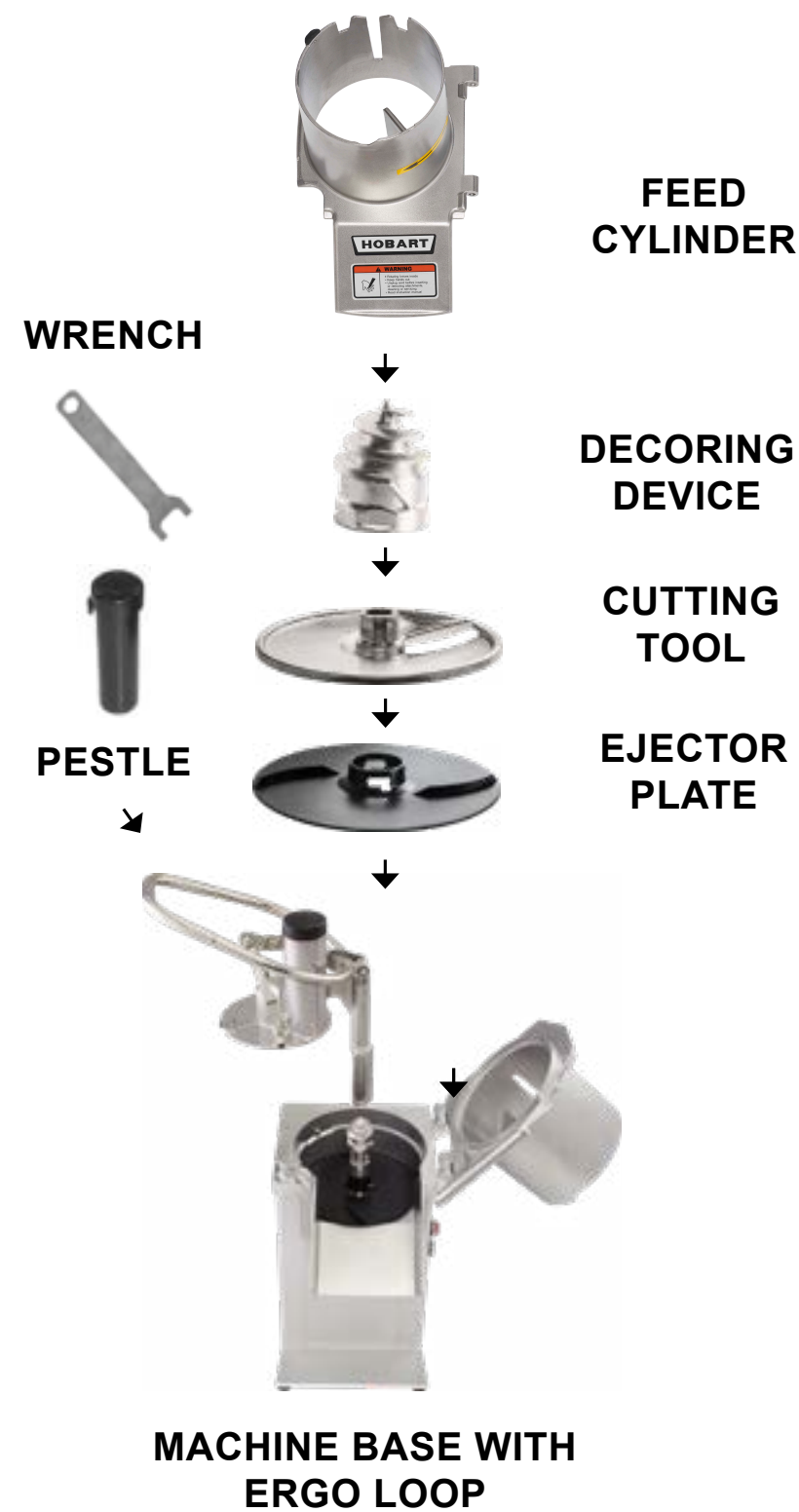

Loading Machine

Loading the machine properly is important to ensure a quality cut. While loading the food processor, remember the following:

- Place small, round items like tomatoes, potatoes, beet and onions against an inner support wall inside the hopper
- Avoid overfilling the hopper
- Avoid processing meats or frozen items (see Use and Care guide)
- When processing long vegetables such as cucumbers and zucchini, use the feed tube
- Best product quality is achieved when only light pressure is used to keep the product in contact with the cutting plate.

Half Hopper Example:



Full Hopper Example:



Cleaning & Disassembly Instructions

FP100/FP150

1. Remove feed tube pusher. Wash in warm water & detergent. Rinse in warm water. Raise pusher plate, turn to the left.
2. Remove feed hopper. Wash in warm water & detergent, then rinse.
3. Lift out cutting plate. If used dicing grid, push remaining leftovers through grid with nylon brush before removing.
4. Remove dicing plate & flinger plate; wash in warm water & detergent then rinse.
5. Turn pusher plate back clockwise over the feed hopper & lower it.
6. Place pan under exit chute. Pour warm water from top through knife chamber. Run wet cloth through feed tube. Wipe with a clean, dry cloth.
7. Return cutting tools to wall rack. Lower flinger plate onto knife shaft until flinger plate seats on the shaft pin.
8. Place feed hopper on the hinge pins, lower to normal position. Turn and lower pusher plate. Replace feed tube pusher.

FP250/FP350

1. Remove the feed tube pusher.
2. Lift the pusher plate and move it to the left, lift and remove.
3. Turn the locking knob counterclockwise to unlock the feed hopper.
4. Raise the feed hopper and slide it off its hinge pins.
5. Unthread the decorating screw clockwise with the wrench and remove it.
6. Remove the cutting plate and, if used, the dicing grid. Use the brush to push remaining food through the dicing grid.
7. Remove the ejector plate.
8. Remove food waste from discharge chute and cutting plate chamber.
9. Use a clean cloth with warm soapy water to wipe the cutting plate chamber, discharge chute and motor housing.

Cutting Tools

Fitting the Cutting Tools

- Lift the pusher plate and swing it out to the left.
- Turn the locking knob anti-clock wise and raise the feed cylinder.
- Place the ejector plate on the shaft and turn/press down the ejector plate into its coupling
- Place the chosen cutting tool on the shaft and rotate the cutting tool so that it drops into its coupling.
- During dicing: place the dicing grid with the sharp edge of the knives upward, so that the recess in the side of the dicing grid fits into the guide groove on the machine base.
- Then place the slicer so that it drops down into its coupling.
- Lower the feed cylinder and turn the locking knob clockwise to the locked position.

Removing the Cutting Tools

- Raise the pusher plate and swing it out
- Turn the locking knob and raise the feed cylinder.
- Remove the cutting tool/tools and the ejector plate.

