



COMMERCIAL

Spare Parts List

Model: KCHMT60.24.4D

PNC: 738288

REV: 2/18/2025

NO	DESCRIPTION	Serial #	QTY	COMPONENT PNC	Model Number	Model PNC
2	TEMPERATURE CONTROLLER	<01021236	1PC	0USF42	KCHMT60.24.4D	738288
		≥01021236	1PC	0USDET	KCHMT60.24.4D	738288
2a	Inner Chest Temperature Sensor Probe	ALL	1PC	0USC4C	KCHMT60.24.4D	738288
2b	Controller Mounting Plate	ALL	1PC	0USDIF	KCHMT60.24.4D	738288
8	CABLE COVER	ALL	1PC	0USK07	KCHMT60.24.4D	738288
9	BRAKE WHEEL	ALL	2PCS	0USF03	KCHMT60.24.4D	738288
10	FRONT SUPPORT OF UNIT BOARD	ALL	1PC	0USJ61	KCHMT60.24.4D	738288
11	NORMAL WHEEL	ALL	2PCS	0USH63	KCHMT60.24.4D	738288
11a	Castor Mounting Bolt (4-PACK)	ALL	4PC	0USC2U	KCHMT60.24.4D	738288
11b	Castor Mounting Locking Washer (4-PACK)	ALL	4PC	0USC4A	KCHMT60.24.4D	738288
11c	Castor Mounting Flat Washer (4-PACK)	ALL	4PC	0USC2X	KCHMT60.24.4D	738288
12	BACK SUPPORT OF UNIT BOARD	ALL	1PC	0USJ62	KCHMT60.24.4D	738288
14	BODY	ALL	1PC	N/A	KCHMT60.24.4D	738288
15	TOP CLIP	ALL	4PCS	0USL80	KCHMT60.24.4D	738288
16	UNIT ROOM COVER	ALL	1PC	0USI10	KCHMT60.24.4D	738288
17	PLUG	ALL	1PC	0USH67	KCHMT60.24.4D	738288
18	LOCATION KNOB	ALL	2PCS	0USH46	KCHMT60.24.4D	738288
19	FIXED CLIP OF CUTTING BOARD	ALL	2PCS	0USG68	KCHMT60.24.4D	738288
20	TOP	ALL	1PC	0USH97	KCHMT60.24.4D	738288
21	CUTTING BOARD	ALL	1PC	0USF49	KCHMT60.24.4D	738288
22	PAN SUPPORT /FRONT	ALL	1PC	0USJ35	KCHMT60.24.4D	738288
22a	PAN SUPPORT /BACK	ALL	1PC	0USDEM	KCHMT60.24.4D	738288
22b	Shelf Support Screw	ALL		0USM14	KCHMT60.24.4D	738288
23	STANDARD PAN	ALL	24PCS	N/A	KCHMT60.24.4D	738288
24	PAN SUPPORT /LEFT/RIGHT	ALL	2PCS	0USM80	KCHMT60.24.4D	738288
25	PAN SUPPORT	ALL	7PCS	0USJ31	KCHMT60.24.4D	738288
26	HANDLE OF COVER	ALL	1PC	0USH09	KCHMT60.24.4D	738288
27	MOVING COVER	ALL	1PC	0USH61	KCHMT60.24.4D	738288
27a	MOVING COVER LINER	ALL	1PC	0USL39	KCHMT60.24.4D	738288
28	FIXED COVER	ALL	1PC	0USG72	KCHMT60.24.4D	738288
28a	FIXED COVER LINER	ALL	1PC	0USL70	KCHMT60.24.4D	738288
29	CONDENSER	<03221905	1PC	0USF34	KCHMT60.24.4D	738288
		≥03221905	1PC	0USO57	KCHMT60.24.4D	738288
30	FILTER DRIER	ALL	1PC	0USG66	KCHMT60.24.4D	738288
31	DRIER SUPPORT	ALL	1PC	0USI78	KCHMT60.24.4D	738288
32	CAPILLARY	ALL	1PC	0USM13	KCHMT60.24.4D	738288
33	CONDENSER FAN	ALL	1PC	0USF40	KCHMT60.24.4D	738288
33a	CONDENSER FAN BLADE	ALL	1PC	0USC4J	KCHMT60.24.4D	738288
34	BASKET GUARD GRILLS	ALL	1PC	0USDIJ	KCHMT60.24.4D	738288
35	EVAPORATE PIPE	ALL	1PC	0USG14	KCHMT60.24.4D	738288
36	WATER BOX	ALL	1PC	0USI29	KCHMT60.24.4D	738288
37	COMPRESSOR	ALL	1PC	0USF28	KCHMT60.24.4D	738288
37a	COMPRESSOR ELECTRICAL COMPONENT SET	ALL	1PC	0USDF5	KCHMT60.24.4D	738288
38	SUCTION PIPE	ALL	1PC	0USH80	KCHMT60.24.4D	738288
39	CONNECTOR SUPPORT	ALL	1PC	0USDEE	KCHMT60.24.4D	738288
40	CABLE CONNECTOR	ALL	1PC	0USF09	KCHMT60.24.4D	738288
41	CONNECTOR COVER	ALL	1PC	0USJ98	KCHMT60.24.4D	738288
42	GUIDE OF UNIT BOARD/LEFT	ALL	1PC	0USK50	KCHMT60.24.4D	738288
42a	GUIDE OF UNIT BOARD/RIGHT	ALL	1PC	0USK49	KCHMT60.24.4D	738288

43	UNIT BOARD	ALL	1PC	0USK32	KCHMT60.24.4D	738288
44	AIR FLOW CONDUCT BOARD	ALL	2PCS	0USL13	KCHMT60.24.4D	738288
45	CIRCLE FAN	ALL	3PCS	0USF14	KCHMT60.24.4D	738288
46	CIRCLE FAN SUPPORT	ALL	1PC	0USK03	KCHMT60.24.4D	738288
47	EVAPORATOR	ALL	1PC	0USG30	KCHMT60.24.4D	738288
47a	Evaporator Temperature Sensor Probe	ALL	1PC	0USC6R	KCHMT60.24.4D	738288
48	EVAPORATOR WATER PAN	ALL	1PC	0USG55	KCHMT60.24.4D	738288
49	FIXED SUPPORT OF EVAPORATOR COVER	ALL	2PCS	0USK05	KCHMT60.24.4D	738288
50	EVAPORATOR COVER	ALL	1PC	0USK02	KCHMT60.24.4D	738288
52	SENSOR FIXED CLIP	ALL	1PC	0USM10	KCHMT60.24.4D	738288
63	CONDUCT BOARD	ALL	1PC	0USK04	KCHMT60.24.4D	738288
63a	CONDUCT BOARD SIDE PLATE	ALL	2PCS	0USL14	KCHMT60.24.4D	738288
66	MIDDLE GIRDER	ALL	1PC	0USC6D	KCHMT60.24.4D	738288
67	MIDDLE GIRDER FIXER	ALL	2PCS	0USH59	KCHMT60.24.4D	738288
68	FIXED BOLT	ALL	2PCS	0USG67	KCHMT60.24.4D	738288
69	FIXED NUT	ALL	2PCS	0USG73	KCHMT60.24.4D	738288
70	BACK FRAME	ALL	2PCS	0USM81	KCHMT60.24.4D	738288
71	FRONT FRAME	ALL	2PCS	0USM82	KCHMT60.24.4D	738288
71a	FRONT FRAME COVER (TOP)	ALL	2PCS	0USM07	KCHMT60.24.4D	738288
71b	FRONT FRAME COVER (BOTTOM)	ALL	2PCS	0USM07	KCHMT60.24.4D	738288
71c	FRONT FRAME COVER (LEFT)	ALL	2PCS	0USM05	KCHMT60.24.4D	738288
71d	FRONT FRAME COVER (RIGHT)	ALL	2PCS	0USDEG	KCHMT60.24.4D	738288
72	BRIDGE	ALL	2PCS	0USM83	KCHMT60.24.4D	738288
73	GASKET	ALL	4PCS	0USM84	KCHMT60.24.4D	738288
74	GUIDE (RIGHT)	<31820284	4PCS	0USM46	KCHMT60.24.4D	738288
		≥31820284	4PCS	0USE8B	KCHMT60.24.4D	738288
75	GUIDE (LEFT)	<31820284	4PCS	0USM47	KCHMT60.24.4D	738288
		≥31820284	4PCS	0USE8A	KCHMT60.24.4D	738288
76	DRAWER PANNEL	ALL	4PCS	0USM85	KCHMT60.24.4D	738288
76a	DRAWER BODY	ALL	4PCS	0USM86	KCHMT60.24.4D	738288
77	BACK FRAME CLIP	ALL	4PCS	0USM87	KCHMT60.24.4D	738288
78	DRAWER SUPPORT	ALL	4PCS	0USM51	KCHMT60.24.4D	738288
79	FRONT SUPPORT	ALL	4PCS	0USM52	KCHMT60.24.4D	738288

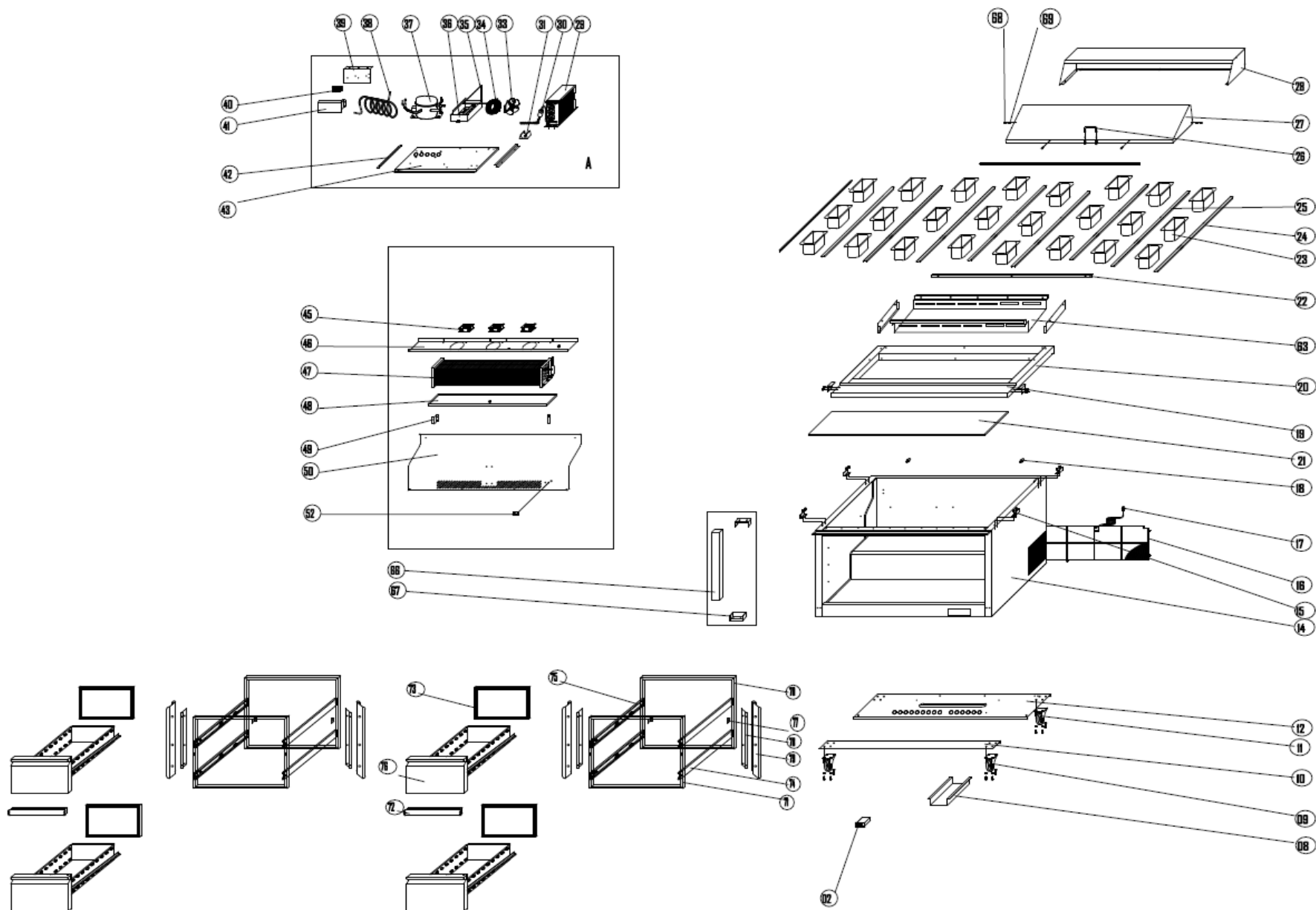

EXPLODE OF KCHMT60.24.4D