



Kelvinator 

Factory Parts Catalog

Product No.	KCPT72-9
Series	Pizza Table
Color	stainless steel
Volts	115
Market	North America

This Catalog replaces 5995621389

Publication No.
5995650099
14/08/20
(EN/SERVICE/KC)
099

PIZZA PREP TABLE

Model No.
KCPT72

RECOMMENDED SPARE PARTS

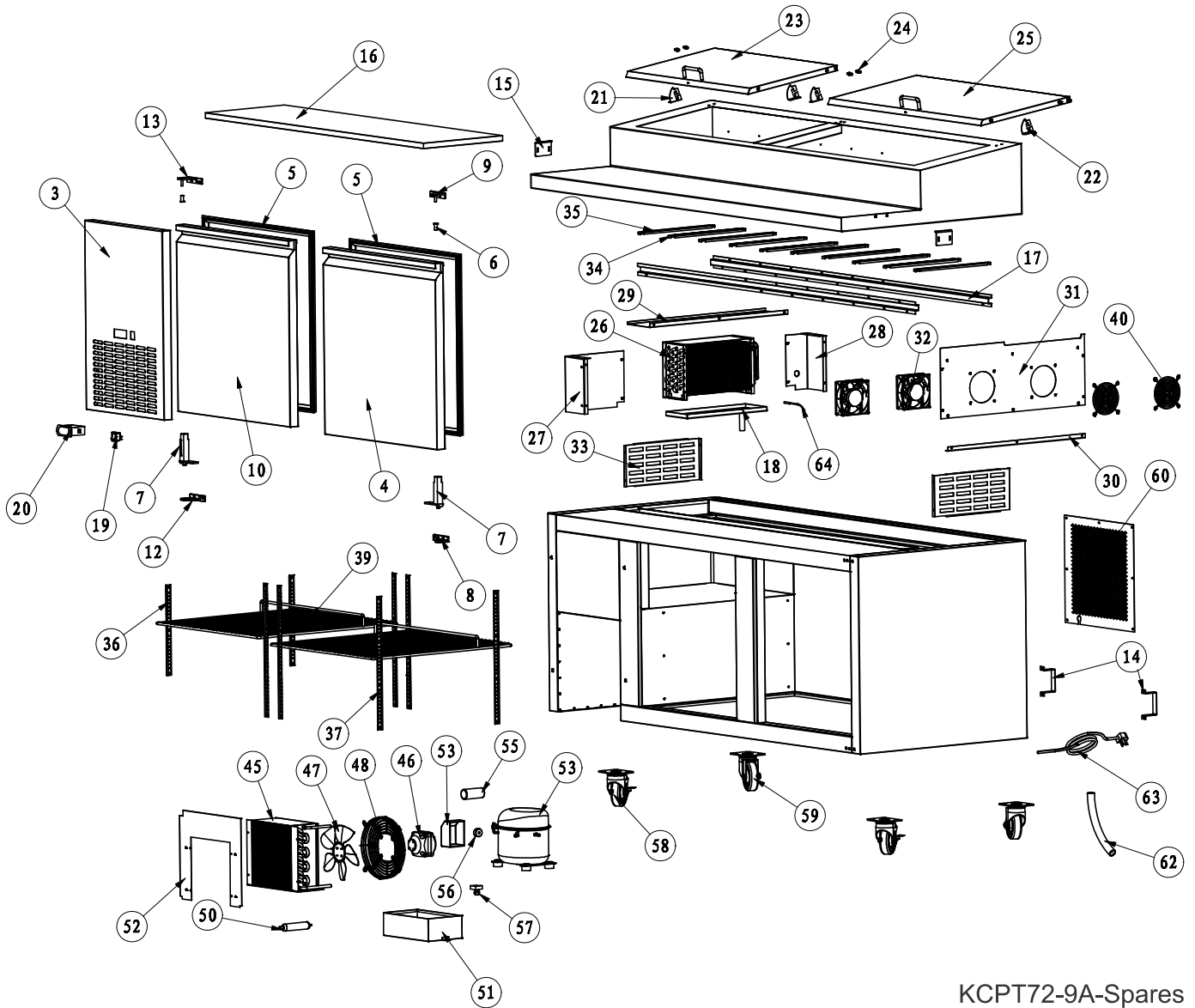

KCPT72-9A-Spares

RECOMMENDED SPARE PARTS

POS. NO	PART NO.	DESCRIPTION
3	5304493462	Cover, condenser, control panel
4	5304493463	Door, right side
5 #	5304493464	Gasket, door seal
6	5304493360	Hinge Pin, door, upper
7	5304492217	Door Closer, hinge spring
8	5304493361	Hinge, door, bottom right
9	5304493362	Hinge, door, upper right
10	5304493465	Door, left side
12	5304493409	Hinge, door, bottom left
13	5304493410	Hinge, door, top left
14	5304493382	Bracket, stand off
15	5304493363	Bracket, cutting board
16	5304493466	Board, cutting
17	5304493467	Rail, pan
18	5304493468	Pan, defrost drain, evaporator
19 #	5304492248	Switch, power
20 #	5304496527	Controller, temp, (Juchuang)
20 #	5304492240	Controller, temp, (Carel)
21	5304493469	Hinge, top lid, left
22	5304493470	Hinge, top lid, right
23	5304493471	Lid, small, left
24	5304493473	Hinge Pin, lid
25	5304493472	Lid, large, right
26 #	5304493474	Evaporator
27	5304493475	Support, evap cover, left side
28	5304493476	Support, evap cover, right side
29	5304493477	Support, evap cover, upper
30	5304493478	Support, evap cover, bottom
31	5304493479	Panel, fan mount
32 #	5304492231	Fan Assy, evaporator, with motor
33	5304493480	Grille, inner
34	5304493481	Bracket, end pan, 25 mm wide
35	5304493482	Bracket, end pan, 15 mm wide
36	5304493397	Pilaster, shelf mount, 3 screw
37	5304493483	Pilaster, shelf mount, 4 screw
39	5304493484	Shelf
40	5304493485	Grille, fan cover, evaporator
45 #	5304492269	Condenser
46 #	5304492359	Motor, condenser fan
47 #	5304492273	Fan Blade, condenser fan
48	5304492272	Cover, condenser fan
50 #	5304492275	Filter-drier
51	5304493296	Pan, drain, condensate
52	5304493501	Frame, air baffle, condenser
53 #	5304493171	Compressor
55 #	5304493032	Capacitor, start
56 #	5304493174	Overload
57 #	5304493173	Relay/Starter
58	5304492261	Caster, 4 inch diameter, locking
59	5304492262	Caster, 4 inch diameter
60	5304493502	Panel, svce access, rear grille
62 #	5304493401	Tube, drain, 16 mm dia
63 #	5304493100	Power Cord, electric, 115 V
64 #	5304492340	Probe, temp controller

WIRING DIAGRAM

KCPT72.9 Wiring

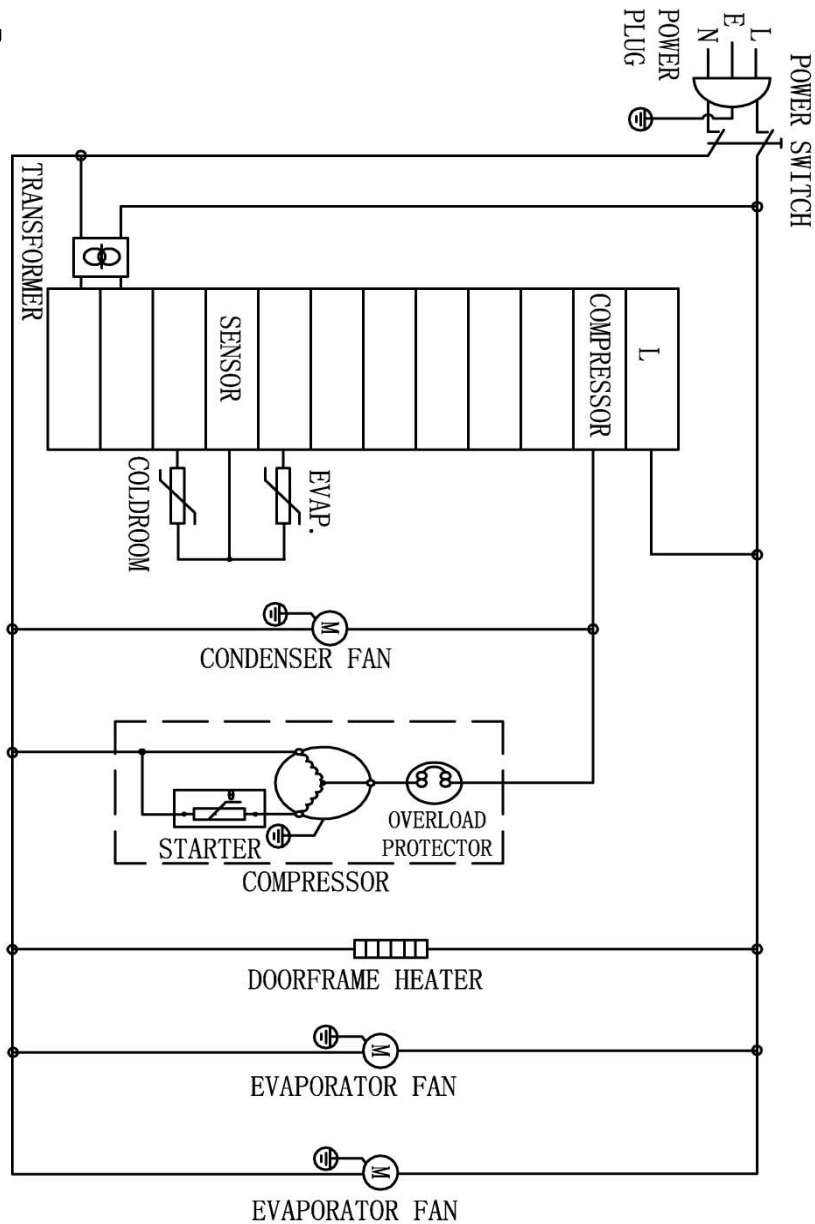

CIRCUIT DIAGRAM

**MODEL: PICL2
TECHNIC PARAMETER**

DESIGNED PRESSURE	
HIGH SIDE	358PSI
LOW SIDE	190PSI
REFRIGERANT	R134a
AMOUNT	430g
FOAM AGENT	141b
RATED VOLTAGE	AC115V
FREQUENCY	60Hz
RATED CURRENT	9.8A
NET WEIGHT	155Kg
MANUFACTURED	