



## SPARE PARTS CATALOG

603R/63R

---



REV: 01/2013-A

Merrychef USA  
1111 North Hadley Road  
Fort Wayne, Indiana 46804  
Telephone: 260.459.8200  
Fax: 888.790.8193  
Technical Support: 800.678.9511  
Merrychef.com

# Table of Contents

603R/63R SPARE PARTS EXPLODED VIEW ..... 3  
603R/63R SPARE PARTS LIST ..... 4  
RECOMMENDED PLANNED MAINTENANCE SCHEDULE ..... 6

# 603R/63R SPARE PARTS EXPLODED VIEW

**Note:** Unique part numbers specified in Spare Parts List on page 2

Example:

|   |        |                        |   |
|---|--------|------------------------|---|
| 6 | 333013 | Resistan Gasket (63R)  | 2 |
|   | 333101 | Resistan Gasket (603R) | 2 |

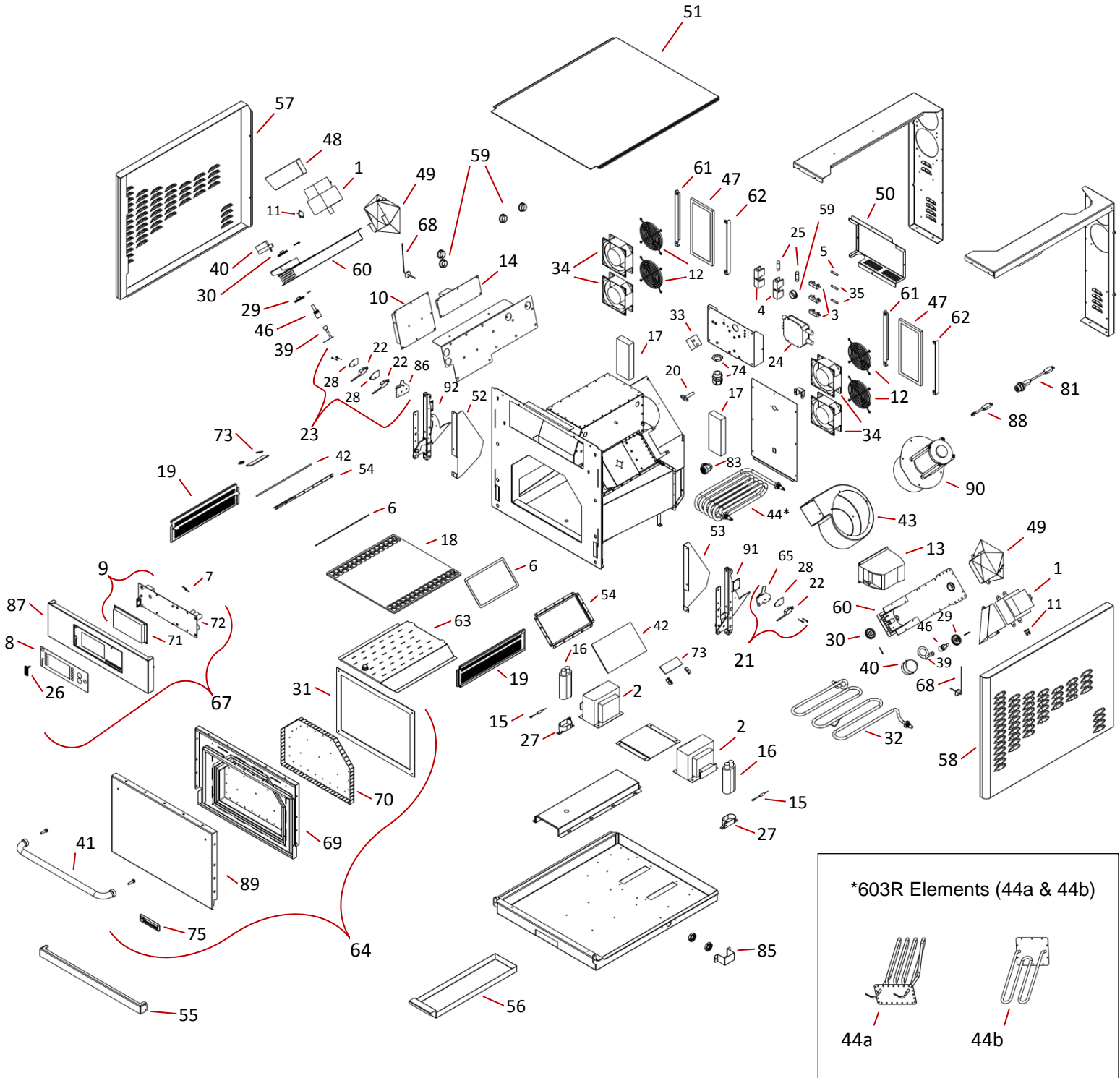

# 603R/63R Spare Parts List

(S/N 1107XXXXXXXXXX and below 603R  
S/N 1108XXXXXXXXXX and above 63R)

| Item # | Spare Part # | Description                                  | Qty Per Oven |
|--------|--------------|--|--------------|
| 1      | 333000       | Magnetron                                    | 2            |
| 2      | 333002       | Transformer, High Voltage                    | 2            |
| 3      | 333006       | Fuse Holder Small                            | 3            |
| 4      | 333008       | Fuse Holder Large                            | 2            |
| 5      | 333009       | Fuse .5A Fastblow                            | 1            |
| 6      | 333013       | Resistan Gasket (63R)                        | 2            |
|        | 333101       | Resistan Gasket (603R)                       | 2            |
| 7      | 333014       | Thermocouple, Cabinet                        | 1            |
| 8      | 333025       | Control Overlay                              | 1            |
| 9      | 333026       | VFD / Control Board Assembly                 | 1            |
| 10     | 333027       | Relay Board, Main                            | 1            |
| 11     | 333034       | High Limit Magnetron                         | 2            |
| 12     | 333036       | Fan Guard                                    | 4            |
| 13     | 333044       | Speed Control                                | 1            |
| 14     | 333045       | Relay Board, Aux                             | 1            |
| 15     | 333046       | Diode, High Voltage                          | 2            |
| 16     | 333047       | Capacitor, High Voltage                      | 2            |
| 17     | 333055       | Catalyst                                     | 2            |
| 18     | 333056       | Cook Plate                                   | 1            |
| 19     | 333058       | Grease Filter Weldment (63R)                 | 2            |
| 20     | 333060       | Tube Weldment                                | 1            |
| 21     | 333071       | Secondary Switch Assembly                    | 1            |
| 22     | 333072       | Microswitch                                  | 3            |
| 23     | 333073       | Primary Switch Assembly                      | 1            |
| 24     | 333075       | RFI Filter                                   | 1            |
| 25     | 333076       | Fuse 30 amp Main                             | 2            |
| 26     | 333092       | Menu Card Cover                              | 1            |
| 27     | 333096       | Capacitor Clamp                              | 2            |
| 28     | 333097       | Door Switch Spacer                           | 3            |
| 29     | 333098       | Gear, Stirrer                                | 2            |
| 30     | 333099       | Gear, Stirrer Motor                          | 2            |
| 31     | 333100       | Door Gasket                                  | 1            |
| 32     | 333107       | Heating Element, Radiant                     | 1            |
| 33     | 333109       | Cavity High Limit                            | 1            |
| 34     | 333110       | Cabinet Fan                                  | 4            |
| 35     | 333111       | Fuse 20 amp Slowblow                         | 2            |
| 36     | 333116       | Gasket, Base (NOT SHOWN)                     | 1            |
| 37     | 333121       | Cut Off Bulb Mount                           | 1            |
| 38     | 333138       | Sealant RTV 106 Tube (NOT SHOWN)             | x            |
| 39     | 333166       | Stirrer Antenna                              | 2            |
| 40     | 333167       | Stirrer Motor Assembly                       | 2            |
| 41     | 333185       | Door Handle                                  | 1            |
| 42     | 333206       | Partition Plate (63R)                        | 2            |
|        | 333095       | Partition Plate Assy (603R) – (includes #54) | 2            |
| 43     | 333215       | Scroll Housing - CW                          | 1            |
| 44     | 333216       | Top Heater, (63R)                            | 1            |
| 44a    | 333108       | Heating Element, Top (603R) (Picture inset)  | 1            |
| 44b    | 333106       | Heating Element, Back (603R) (Picture inset) | 1            |

| Item # | Spare Part # | Description                                 | Qty Per Oven |
|--------|--------------|---|--------------|
| 45     | 333217       | Locktite 2620 High Temp (NOT SHOWN)         | x            |
| 46     | 333219       | Stirrer Extension (63R)                     | 2            |
|        | 333067       | Stirrer Extension (603R)                    | 2            |
| 47     | 333220       | Air Filter                                  | 2            |
| 48     | 333221       | Mag Exhaust Shroud                          | 2            |
| 49     | 333222       | Mag Inlet Shroud                            | 2            |
| 50     | 333223       | Fuse Box Cover (63R)                        | 1            |
|        | 333296       | Fuse Box Cover (603R)                       | 1            |
| 51     | 333224       | Top Panel (63R)                             | 1            |
|        | 333297       | Top Panel (603R)                            | 1            |
| 52     | 333225       | Left Hinge Shim (63R)                       | 1            |
|        | 333126       | Left Hinge Shim (603R)                      | 1            |
| 53     | 333226       | Right Hinge Shim (63R)                      | 1            |
|        | 333136       | Right Hinge Shim (603R)                     | 1            |
| 54     | 333227       | Partition Plate Bracket (63R)               | 2            |
|        | 333095       | Partition Plate Assy (603R) –(includes #42) | 2            |
| 55     | 333228       | Under Door Cover (63R)                      | 1            |
|        | 333298       | Under Door Cover (603R)                     | 1            |
| 56     | 333229       | Grease Drawer Weldment (63R)                | 1            |
|        | 333120       | Grease Drawer Weldment (603R)               | 1            |
| 57     | 333230       | Side Panel Assy, LH (63R)                   | 1            |
|        | 333299       | Side Panel Assy, LH (603R)                  | 1            |
| 58     | 333231       | Side Panel Assy, RH (63R)                   | 1            |
|        | 333300       | Side Panel Assy, RH (603R)                  | 1            |
| 59     | 333232       | Bushing, Snap (63R)                         | 5            |
|        | 369083       | Bushing, Snap (603R)                        | 5            |
| 60     | 333233       | Wave Guide Assembly (63R)                   | 2            |
|        | 333171       | Wave Guide Assembly (603R)                  | 2            |
| 61     | 333237       | Right Air Filter Mount                      | 2            |
| 62     | 333238       | Left Air Filter Mount                       | 2            |
| 63     | 333240       | Jet Plate Weldment (63R)                    | 1            |
|        | 333123       | Jet Plate Weldment (603R)                   | 1            |
| 64     | 333241       | Door Assembly (63R)                         | 1            |
|        | 333069       | Door Assembly (603R)                        | 1            |
| 65     | 333250       | Secondary Switch Bracket                    | 1            |
| 66     | N/A          | N/A   | x            |
| 67     | 333257       | Control Panel Assembly (63R)                | 1            |
|        | 333118       | Control Panel Assembly (603R)               | 1            |
| 68     | 333262       | Thermocouple, Cavity Double (63R)           | 1            |
|        | 333012       | Cavity Thermocouple (603R)                  | x            |
| 69     | 333263       | Door Inner Weldment (63R)                   | 1            |
|        | 333301       | Door Inner Assy (603R)                      | 1            |
| 70     | 333264       | Door Choke Assembly (63R)                   | 1            |
|        | 333265       | Choke Shim (NOT SHOWN) (63R)                | x            |
|        | 333302       | Door Choke Assembly(603R)                   | 1            |
|        | 333303       | Choke Shim (NOT SHOWN) (603R)               | 1            |
| 71     | 333275       | Display, VFD                                | 1            |
| 72     | 333276       | Control Board                               | 1            |
| 73     | 333277       | Horn Quartz                                 | 4            |
| 74     | 370749       | Strain Relief                               | 1            |
| 75     | 333280       | Merrychef Logo Badge                        | 1            |
| 76     | 333285       | Foil Tape Alum 3326 Roll (NOT SHOWN)        | 1            |

| Item # | Spare Part # | Description   | Qty Per Oven |
|--------|--------------|---|--------------|
| 77     | 333281       | Wire Harness, 63R (NOT SHOWN)                           | 1            |
|        | 333172       | Wire Harness, 603R (NOT SHOWN)                          | 1            |
| 78     | 333286       | Insulation, Radiant Heater (NOT SHOWN)                  | 4            |
| 79     | N/A          | N/A   | x            |
| 80     | N/A          | N/A   | x            |
| 81     | 333278       | Connector, USB Circular                                 | 1            |
| 82     | 333279       | Cordset, 30A L6-30P Twist Lock 63R &603R-CF (NOT SHOWN) | 1            |
|        | 333094       | Cordset, 30A L6-30P Plug (603R-WD) (NOT SHOWN)          | 1            |
|        | 333004       | Cordset, 20A (603) (NOT SHOWN)                          | 1            |
| 83     | 333289       | Steam Tube ½" NPT Flexible                              | 1            |
| 84     | N/A          | N/A   | x            |
| 85     | 333284       | Steam Shield (63R)                                      | 1            |
|        | 333304       | Steam Shield (603R)                                     | 1            |
| 86     | 333282       | Primary Switch Bracket                                  | 1            |
| 87     | 333291       | Control Panel Weldment (63R)                            | 1            |
|        | 333305       | Control Panel Weldment (603R)                           | 1            |
| 88     | 333295       | USB Dongle Assembly                                     | 1            |
| 89     | 333292       | Door Skin Weldment (63R)                                | 1            |
|        | 333306       | Door Skin Weldment (603R)                               | 1            |
| 90     | 333290       | Blower Assembly   | 1            |
| 91     | 333293       | Hinge Assembly, Right (63R)                             | 1            |
|        | 333112       | Hinge Assembly, Right (603R)                            | 1            |
| 92     | 333294       | Hinge Assembly, Left (63R)                              | 1            |
|        | 333113       | Hinge Assembly, Left (603R)                             | 1            |

## Recommended Planned Maintenance Schedule

| Daily                           |
|---------------------------------|
| Clean Oven As Per User Manual   |
| Clean Air Filter                |
| Clean Grease Filter             |
| Weekly                          |
| Check Door Operation            |
| Check Door Interlock Operation  |
| Check Door Seal                 |
| Check Door Springs              |
| Check Oven Accessories          |
| Check Cooling Fan Operation     |
| Monthly                         |
| Check Oven For Damage           |
| Check Control Panel Operation   |
| Check Power Supply and Cord     |
| Check and Clean Steam Vent Pipe |
| Check Oven Operation            |



