

VULCAN

*SERVICE MANUAL & CATALOG OF
REPLACEMENT PARTS*

WARMER

MODEL

MEW14

ML-103832



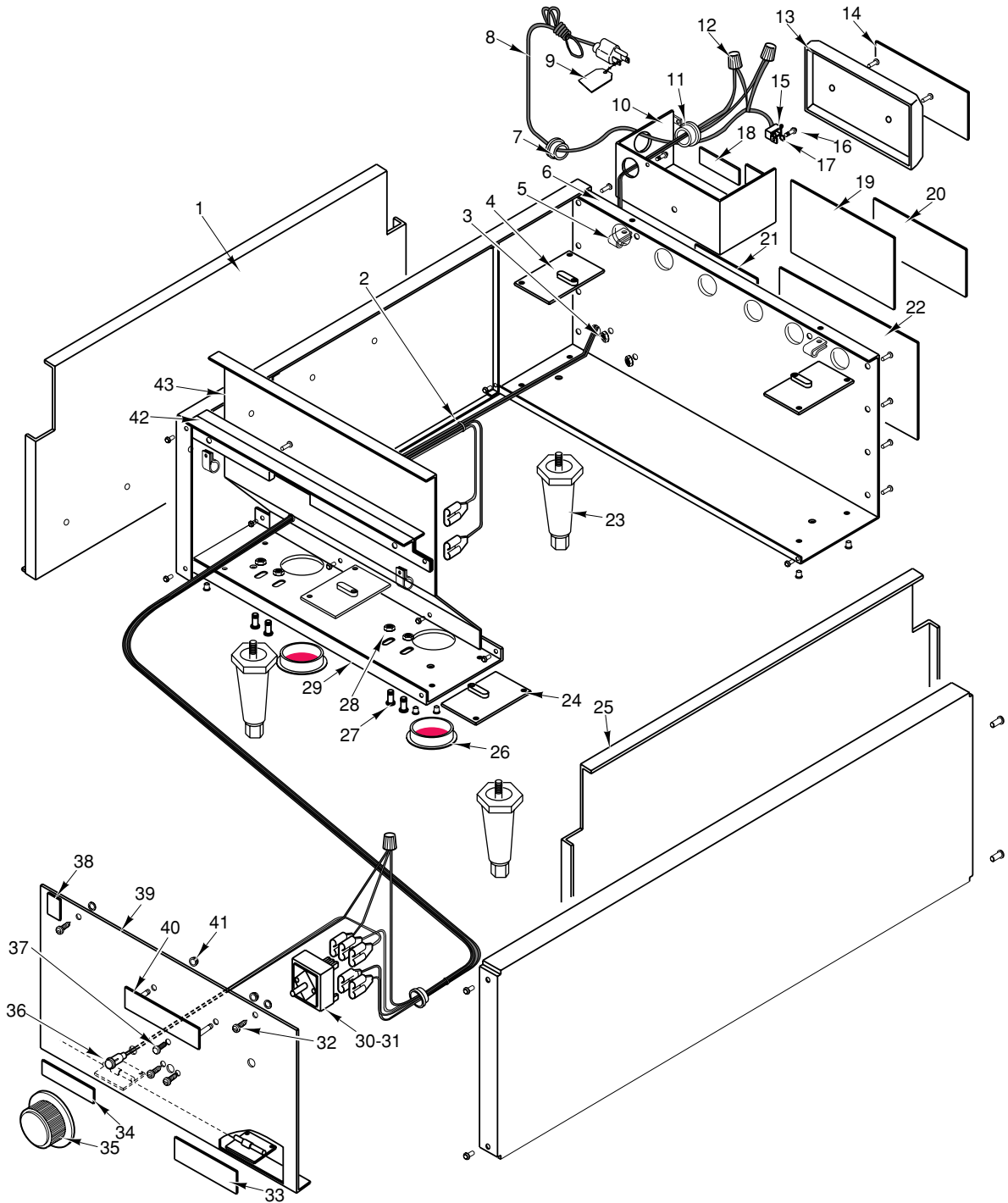

PL-52131

MEW14 WARMER FRAME

MEW14 WARMER FRAME

ILLUS. PL-52131	PART NO.	NAME OF PART	AMT.
1	00-920159	Insulation - Panel Side	1
2	00-540917	Tie - Wire	2
3	NS-044-09	Nut Assy. 10-24 Hex Keys	2
4	00-920140-00001	Leg Pad Weldment	2
5	00-911037-00001	"U" Nut	2
6	00-920132	Member - Rear Cross	1
7	FE-014-47	Strain Relief	1
8	00-802422-00011	Lead In Wire Assy.	1
9	00-806584	Label-Warning	1
10	00-920570	Shield - Heat Front	1
11	FE-016-02	Bushing - Snap	2
12	00-911501-00005	Connector-Wire	3
13	00-423047-00019	Plate - Cover	1
14	00-805782	Label-Disconnect Power	1
15	FE-023-68	Lug-Solderless	1
16	SC-119-23	Mach. Screw 10-24 x 1/2 Hex Washer Hd.	2
17	WL-007-11	Lockwasher 10	1
18	00-805727	Label-Ground Marker	1
19	00-908805	Label-Ground Warning	1
20	00-805780	Marker-Supply	1
21	00-825368	Plate-Serial Number	1
22	00-920156-00010	Label - Wiring Diagram	1
23	00-804405	Leg - With Adjustable Foot	4
24	00-920140-00001	Leg Pad Weldment	2
25	00-423047-00020	Side Panel Weldment	2
26	00-423047-00021	Ventilator - Drain	2
27	SC-119-23	Mach. Screw 10-24 x 1/2 Hex Washer Hd.	4
28	NS-044-09	Nut Assy. 10-24 Hex Keys	4
29	00-920131	Member - Front Cross Channel	1
30	00-920152	Switch - Infinite Heat	1
31	00-920221	Switch (240V.)(Infinite Heat)	1
32	00-820365	Screw - Quick Opening	2
33	00-805782	Label-Disconnect Power	1
34	00-344646-00001	Label	1
35	00-920396	Knob-Control	1
36	00-906440-00013	Light-Red Signal	1
37	PB-004-69	Plug-Hole	2
38	00-086556-00001	Label	1
39	00-920551-00001	Front Panel Assy.	1
40	00-417700-00003	Nameplate	1
41	NS-047-68	Lock Nut 1/8	2
42	00-920670	Upper Front Cross Angle Assy.	1

MEW14 WARMER BODY

ILLUS. PL-52130	PART NO.	NAME OF PART	AMT.
1	00-423047-00030	Pan - Well W/Studs	1
2	00-423047-00031	Difuser W/Studs	1
3	00-920151	Insulation	1
4	SC-119-23	Mach. Screw 10-24 x 1/2 Hex Washer Hd.	2
5	00-920138	Splash - Rear	1
6	SD-036-61	Self-Tapping Screw 10-16 x 1/2 Slotted Truss Hd., Type B	2
7	00-920130-00001	Top Frame Weldment	1
8	NS-044-09	Nut Assy. 10-24 Hex Keps	2
9	00-920143	Panel - Bottom	1
10	SD-036-64	Self-Tapping Screw 8-18 x 3/8 Slotted Pan Hd., Type AB	4
11	NS-038-08	Lock Nut 1/4-20	4
12	00-920158	Stud	1
13	NS-038-08	Lock Nut 1/4-20	1
14	00-920157	Standoff	1
15	00-920149	Cover - Element	1
16	00-920150-00010	Heater (120 V.)	1
17	00-920150-00011	Heater (240 V.)	1
18	00-920148	Clamp - Heater	3
	00-920145-00001	Well Assy. Complete (120 V.)	1
	00-920145-00002	Well Assy. Complete (240 V.)	1

MEW14 MEDIUM DUTY ELECTRIC COUNTER FOOD WARMER

SERVICE

WARNING: THE FOOD WARMER AND ITS PARTS ARE HOT. USE CARE WHEN OPERATING, CLEANING OR SERVICING THE FOOD WARMER.

WARNING: DISCONNECT ELECTRICAL POWER SUPPLY AND PLACE A TAG AT THE DISCONNECT SWITCH TO INDICATE THAT YOU ARE WORKING ON THE CIRCUIT BEFORE PERFORMING ANY SERVICE.

REPLACING PILOT "ON" LIGHT OR INFINITE (CONTROL) SWITCH

1. Remove control knob by grasping outer edge and pulling straight out, without twisting or turning.
2. Remove two screws at top of front panel. Pull edge to open.
3. Disconnect leads to pilot or infinite switch and remove the damaged component. Mark disconnected leads to identify them.
4. Mount the new infinite switch with fasteners provided. The new pilot light is snapped into place from the front of the panel.
5. Connect leads to corresponding terminals on new component. Check completed circuit against circuit diagram inside the front control panel.
7. Reverse steps 1 and 2 to close front panel.

REPLACING HEATING ELEMENT

1. Remove pan well hold-down nut located at center of bottom panel and accessible from underneath the food warmer.
2. Carefully lift out pan well, and disconnect terminal leads to heating element.
3. Remove the heating element cover (secured by five nuts) and insulation covering the heating element.
4. Remove heating element hold-down clamp, and remove damaged element.
5. Reverse Steps 1-4 to reassemble.

