

**CMF95 Series**  
 Single Stage Condensing Downflow Gas Furnace  
 95.1% AFUE

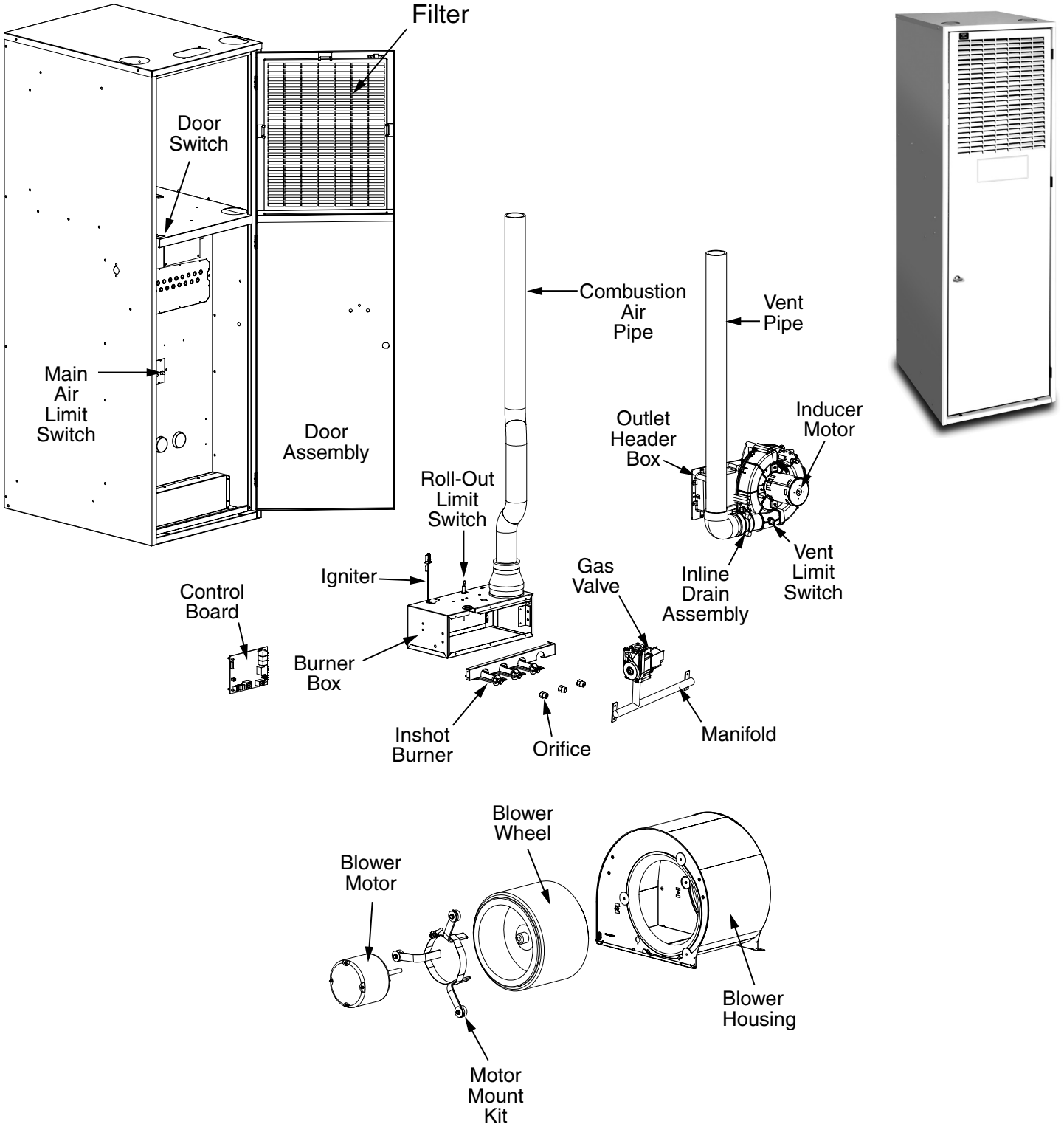

**95.1% AFUE****CMF95 DOWNFLOW GAS FURNACE**

DESCRIPTION	045T PG	072T PG
Blower Deck Limit Switch (Not Shown)	626602R	626602R
Blower Housing	297217R	297217R
Blower Motor	1032131R	1032133R
Blower Wheel	667258R	667258R
Burner Assembly	921495	921496
Burner View Port (Not Shown)	632216R	632216R
Combustion Air Pipe	664645R	664645R
Control Board (Nordyne/UTEC)	1021573R	1021573R
Control Board (Emerson) <i>NOTE: For units manufactured after 09/07/2022</i>	1041648R	1041648R
Door Assembly	1041165R	1041165R
Door Latch Assembly	1036349R	1036349R
Door Switch	632337R	632337R
Drain Tube (Soft, 42") (Not Shown)	664278R	664278R
Drain Tube (Hard "J") (Not Shown)	663706R	663706R
Drain Tee (Not Shown)	618060R	618060R
Filter	669925R	669925R
Flame Sensor (Not Shown)	903600	903600
Fuse (Not Shown)	632261R	632261R
Gas Valve	903596	903596
Heat Exchanger (Not Shown)	921492	921493
Igniter	1016290S	1016290S
Inducer Motor (with Gasket)	921494	921494
Inducer Orifice (Not Shown)	669927R	669926R
Inline Drain Assembly	664435R	664435R
Inshot Burner	661135R	661135R
Main Air Limit Switch	1018776R	626434R
Manifold	664639R	664640R
Motor Mount Kit	904951	904951
Orifice (LP)	661057R	661056R
Orifice (Natural Gas)	661049R	661047R
Outlet Header Box	904802	904802
Pressure Switch (Not Shown)	632622R	632622R
Rollout Limit Switch	626609R	626609R
Set of Wires (Not Shown, Norydne/UTEC)	1028602R	1028602R
Set of Wires (Not Shown, Emerson) <i>NOTE: For units manufactured after 09/07/2022</i>	1040685R	1040685R
Transformer (Not Shown)	622341R	622341R
Vent Limit Switch	626599R	626599R
Vent Pipe	664644R	664644R

Please specify Model No., Serial No, and the correct part number(s) when ordering parts from the nearest authorized dealer or service center.

