

# Operation Manual

Product Holding Bin  
Universal JIB Series

## Product Identification

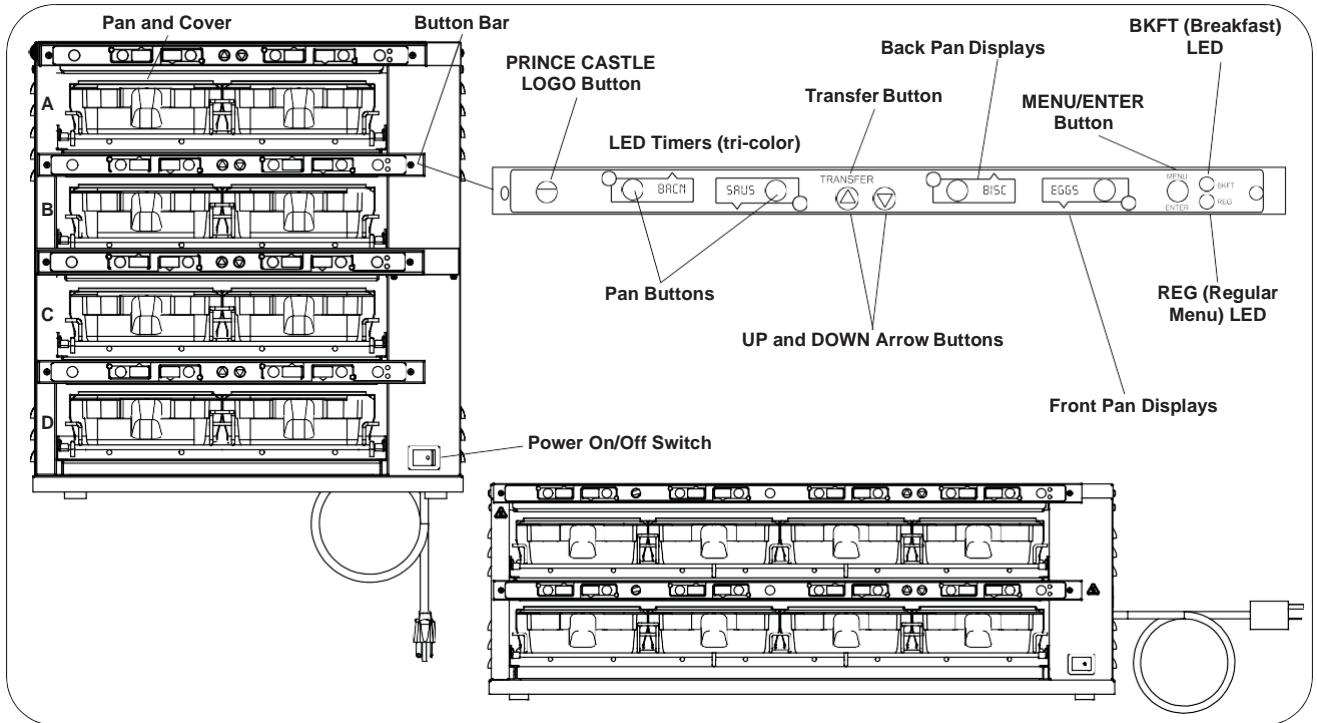

### LIMITED WARRANTY

This product is warranted to be free from defects in material and/or workmanship for a period of one (2) year from date of original installation (with the exception of racks, pans, and covers). Any component which proves to be faulty in material and/or workmanship will be replaced or repaired (at the option of Prince Castle, Inc.) without cost to the customer for parts or labor. This warranty covers on location service (i.e. trip charges and/or mileage). Travel mileage is limited to 100 miles (200 kilometers -International) round trip (one trip warranty) from an authorized service agency or its sub-service agency.

This warranty is subject to the following exceptions/conditions:

- Use of any non-genuine Prince Castle parts voids this warranty.
- All labor shall be performed during regular work hours. Overtime premium will be charged to the buyer.
- Damage caused by carelessness, neglect, and/or abuse (e.g., dropping, tampering or altering parts, equipment damaged in shipment, by fire, flood or an act of God) is not covered under this warranty.

### TABLE OF CONTENTS

Product Identification .....	1
Specifications .....	2
Safety Information .....	2
Installation .....	2
Operation .....	3
Cleaning .....	4
Programming .....	5 - 14
Troubleshooting .....	15 - 16
Service List and Parts List .....	17 - 18
Wiring Diagrams .....	19 - 21



**PRINCE CASTLE LLC**  
WORLDWIDE

205 Lies Rd. • Carol Stream, IL 60188 USA  
Telephone: 630-462-8800 • Toll Free: 1-800-PCASTLE  
Fax: 630-462-1460 • www.princecastle.com

## Specifications

Model	Voltage	Watts	Hertz
DHB4SS-20UJB	120	1700	60
DHB2PT-33UJB	208 – 240	2500	50/60
DHB2SS-33UJB	208 – 240	2500	50/60
DHB4PT-20UJB	120	1700	60
DHB2SS-20UJB	120	1700	60
DHB2SS-27UJB	120	1700	60

## Safety Information



### WARNING

Indicates information important to the proper operation of the unit. Failure to observe may result in damage to the equipment and/or severe bodily injury or death.



### CAUTION

Indicates information important to the operation of the unit. Failure to observe may result in damage to the equipment.

## Installation

- A. Remove the unit from the carton and inspect for signs of damage. If there is damage to the unit:
- notify the carrier within 24 hours of delivery
  - save carton and packaging materials for inspection purposes
  - contact your local dealer, or if purchased directly, the Prince Castle Sales Department at 800-722-7853 or 1-630-462-8800 to arrange for a replacement unit.

*NOTE: When installing this unit, the ambient temperature at the mounting site should not exceed 100°F.*

- B. Place the bin on a counter and seal the base to the counter with food-approved sealant.
- C. Plug the power cord into the bin and connect the plug into the proper electrical outlet (15 amp, 120 Volt). All connections must be in accordance with local electrical codes and any other applicable codes.

*NOTE: The electrical receptacle should be a dedicated outlet. No other equipment should be operating on the line (refrigerators, fryers, etc.).*

- D. Install the racks, pans and pan covers into the cavities.
- E. Turn the power switch to ON. Allow 30 minutes for warm-up.

Prince Castle reserves the right to change specifications and product design without notice. Such revisions do not entitle the buyer to corresponding changes, improvements, additions or replacements for previously purchased equipment.

**Operation**

**1** Turn power On/Off switch to ON position.

Load pan covers (if used) onto pan racks and insert racks into the unit.

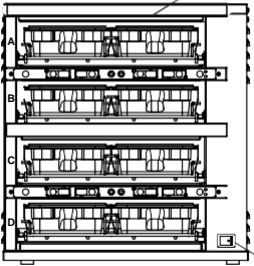

Allow 30 minutes for heaters to reach operating temperature. The Temperature Display will show temperature as unit warms up to the operating temperature.

Power On/Off Switch

**2** Press all PAN buttons (if applicable).



The PAN DISPLAYS will show the assigned product name.

BKFT (Breakfast) or REG (Regular Menu) will be lit depending on pre-programmed menu.

If no product is assigned, the display will be dim and show "-- --". Pressing the PAN button will not activate the timer if "-- --" is displayed. Pressing PAN button when product name is displayed will start timing cycle.

**3** LED Timing Status



LED Timers

- RED (flashing) = Discard product
- GREEN (steady) = Oldest product, use first
- GREEN (flashing) = Cook more product
- YELLOW (steady) = Newer product, use green first
- YELLOW (flashing) = Cook more product

**4** To begin timing cycle, load product and press the PAN button.

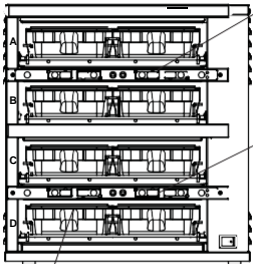

If no other pan is active for a product, the LED for the first pan loaded will turn GREEN.

The LED for the 2nd pan (3rd pan, etc.) loaded will turn YELLOW.

An LED timer can be stopped (cancelled) at any time by pressing and releasing the corresponding PAN button.

If only one pan is active for a product, the LED will turn GREEN.

**Operation (continued)**

**5** When any of the timer LEDs flash, cook more product or remove and discard product as indicated.

**GREEN** Flashing = Cook more product

**YELLOW** Flashing = Cook more product

**RED** Flashing = Discard product

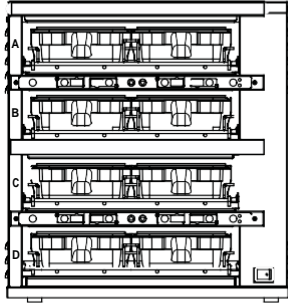

**WARNING**  
Hot surfaces.

**6** Product, along with any remaining time, can be transferred from one cavity to another as follows:

A. Press and release the **TRANSFER** button on the timer bar of the product to be moved. Displays for all pans available for transfer will be brightly lit. All others will be dimly lit.

C. Press and release the **TRANSFER** button on the bar where the product will be moved. All available pan locations on the bar will be brightly lit.



B. Press and release the **PAN** button of the product to be moved.

D. Press and release the **PAN** button for the new location. The new location will finish timing the product. When the transferred pan time expires, the location will revert back to the original menu settings.

*NOTE: If product transfer is not completed within a pre-programmed transfer time, the transfer will be cancelled. See your Manager.*

**7** To shut down the unit, turn the power On/Off switch to OFF.

*NOTE: To load preset times/menus:*

- A. Turn power switch to OFF.
- B. Press and hold both the UP and DOWN Arrow buttons.
- C. Turn power switch ON.
- D. When the four right-most displays show PRESET LOADED, release the buttons.

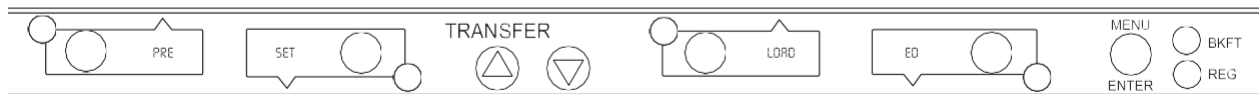

**Cleaning**



**WARNING**

Before performing any maintenance, turn the power switch to the **OFF** position and unplug the power cord from the electrical receptacle.



**CAUTION**

This unit is not watertight. Do not clean with a water jet/jet spray. Do not immerse the unit in water.

- 1. Turn the unit off and unplug the power cord from the electrical receptacle.
- 2. Remove the pan covers and pan racks. Wipe all parts and unit with a damp cloth. **DO NOT** use a green Scotch Bright pad cleaner, ice or water.

**Heater Temperatures**

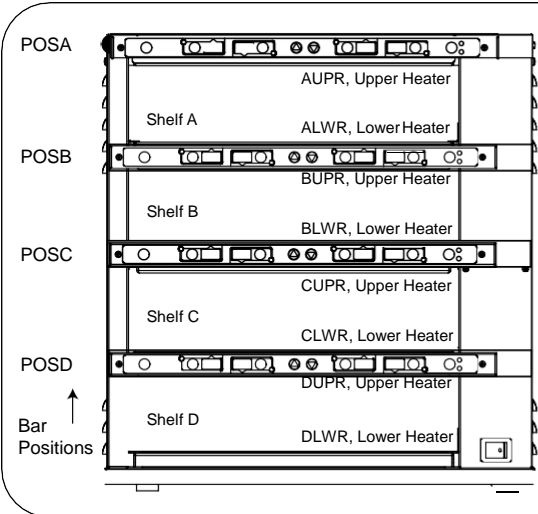

The bin heater temperature display and control have been incorporated into the POSA Main time bar of the Universal JIB Series bin. This bin has four Main timer bars on the front. Figure 1 shows the default bar positions POSA, POSB, and POSC. Refer to the Timer Bar Positions below. The timer bar set for position POSA control the bin heaters. The timer bars for positions POSB, POSC and POSD do not have heater control.

**Figure 1**

*Note: These instructions are only for the bar set to position POSA.*  
On the Main timer bar, press the Prince Castle Logo and the Down Arrow buttons together and release. The displays will show temperature information for the uppermost heater as show in Table 1 below. The temperatures show are examples only.

**Table 1**

Set Temperature	Actual Temperature	Heater Location	Heater Indicator
275S	276A	AUPR	↑↓ H

Set Temperature: The current temperature goal for the displayed heater  
Actual Temperature: The current actual temperature for the displayed heater.  
Heater Location: This is the heater location within the bin shelf being displayed. Each heater extends to the entire width and depth of the shelf.  
Heat Indicator: H will be shown when the bin controller has turned on the heater. H will flash when a fault condition exists for the displayed heater.

To display information for the other heaters in the bin, press the Up or Down Arrow buttons to scroll through each heater display. Table 2 show the heater information that will be displayed. The temperatures and Heat Indicator displays show are examples only.

**Table 2**

Set Temperature	Actual Temperature	Heater Location	Heater Indicator
275°F	276 °F	AUPR	↑↓
225°F	226°F	ALWR	↑↓
275°F	277°F	BUPR	↑↓
225°F	225°F	BLWR	↑↓
325°F	326°F	CUPR	↑↓
225°F	226°F	CLWR	↑↓
325°F	324°F	DUPR	↑↓ H
225°F	224°F	DLWR	↑↓ H

Heater fault indications will be displayed instead of an actual temperature in a heater error condition exists. These indications are:  
Open Relay: Actual Temperature display alternates between OPEN and RELY  
Shorted Relay: Actual Temperature display alternates between SHRT and RELY  
High Temperature: Actual Temperature display shows HHHH  
These fault indicators will be accompanied by the Heat Indicator display flashing H.  
The Actual Temperature display will show LLL (low temperature) if the heater temperature is below 75°F, such as during warm-up.

## Setting the Temperature (continued)

### Cancel Heater Display:

To cancel the heater display and go back to normal timer displays, press the Prince Castle Logo and the Up Arrow buttons together and release. The displays will return to showing product names or remaining time if a timer is running. Also, the heater display will cancel itself after 20 seconds of no button presses

### Changing Set Point Temperatures for Heaters:

*Note: The upper and lower heaters in each shelf extend to the entire width and depth of the shelf.*

*The Heater temperatures are linked to the product time. There are two product types (Grilled and Fried). If you change the temperature for one product within the product types, all the temperatures for the product type will change together.*

1. Make sure that there are no timers active by cancelling the time or resetting the machine by turning the unit off then on.
2. Press and hold the Prince Castle Logo button and then press and hold the Menu/Enter button. Hold both for 6 seconds. The display will change.
3. Press the Up and Down Arrow buttons to scroll to "PROD TEMP".
4. Press Menu/Enter to select this option. A product name will be displayed.
5. Press the Up and Down Arrow buttons to scroll to the desired Product that you would like to change the set point temperature for.
6. Press the Menu/Enter button to select this option.
7. Use the Up and Down Arrow buttons to scroll to the desired heater set point temperature.
8. Press the Menu/Enter button to save this selection.
9. Repeat steps 4 to 8 for changes to the temperature of another Product.
10. Press the Logo button when finished with heater set point temperature changes.

### Setting the Temperature (continued)

#### Calibrating Heater Offset:

This program menu item is only available in the bar set for POSA.

*Note: Allow a sufficient amount of time for temperatures to stabilize before starting calibration.*

#### Measuring temperature:

1. View the actual heater temperatures as described above.
2. Using stand-alone temperature meter (not supplied), take a temperature reading within the shelf near the center of the heater surface.
3. If the actual temperature displayed by the timer bar does not closely match the meter, the displayed temperature can be adjusted as follows.

#### Adjusting the temperature display:

1. On the Main timer bar, press and hold the Prince Castle Logo and Menu/Enter buttons together for 6 seconds. The display will change to program mode.
2. Use the Up and Down Arrow buttons to scroll to the CAL HTRS display.
3. Press the Menu/Enter button. The display will show SEL AUPR for shelf A, upper heater.
4. Use the Up and Down Arrow buttons to scroll to the heater to adjust. The display will cycle through heaters AUPR, ALWR, BUPR, CUPR and CLWR> See Figure 1 above for shelf and heater locations.
5. Press the Menu/Enter button. The display will show CAL AUPR (if AUPR was chosen) and the actual temperature number. This number may fluctuate by a degree since it is the actual temperature reading.
6. Press and release the Up or Down Arrow buttons to increase or decrease the displayed temperature number. The number can be increased by up to 20 degrees, or decreased by up to 20 degrees. The display may not change instantly. For example, if the display shows 200 and the handheld meter shows 205, press the Up Arrow button 5 times. The display will increment for the number of button pushes until it shows 205. This number may fluctuate by a degree since it is the actual temperature reading.
7. Press the Menu/Enter button. The display will go back to CAL HTRS again.
8. Repeat this process for the other heaters.
9. Press the Prince Castle Logo button when done. The bar will return to normal operating mode.

#### Changing the Temperature Degree Scale:

This program menu item is only available in the bar set for POSA.

Temperatures can be displayed in either degrees Fahrenheit (default) or Celsius

1. On the Main timer bar, press and hold the Prince Castle Logo and Menu/Enter buttons together for 6 seconds. The display will change to program mode.
2. Use the Up and Down Arrow buttons to scroll to the DEGR F/C display.
3. Press the Menu/Enter button. Either the F or C will begin flashing to indicate the currently selected scale, F (Fahrenheit) or C (Celsius).
4. Use the Up and Down Arrow buttons to change the selected scale.
5. Press the Menu/Enter button to accept any changes. The flashing will stop.
6. Press the Prince Castle Logo button when done. The bar will return to normal operating mode.

**Selecting Breakfast and Regular Menus**

1 There are three menus available:  
Breakfast = Menu 1  
Fried = Menu 2  
Grilled = Menu 3  
Press and hold the MENU/ENTER button, then use the UP or DOWN Arrow button to scroll through the 3 menus.

When scrolling, menu numbers appear in this display.

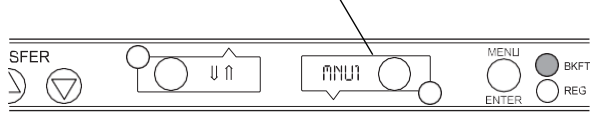

2 When the desired menu is displayed, release the MENU/ENTER button. The food products for the menu will be displayed in the upper and lower PAN displays.

When timers for a different menu are still active, those BKFT or REG LEDs will flash until they are all cancelled.

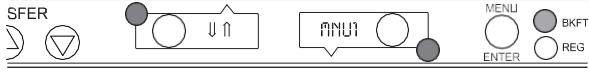

## Programming the Menus

- 1** Press and hold the PRINCE CASTLE LOGO button (on the button bar) until all the displays show PROG.

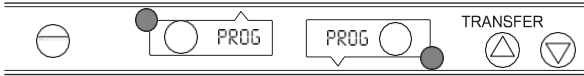

- 2** Press and hold the MENU/ENTER button. The display next to the MENU/ENTER button will show the menu choices. Use the UP or DOWN Arrow button to scroll through the 3 menus. Release the MENU/ENTER button when the desired menu is displayed.

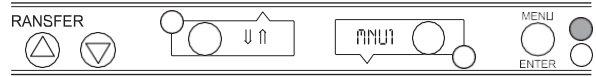

When the MENU/ENTER button is released, all displays will again show PROG.



- 3** A. Press the PAN button next to the display to be changed. The LED will turn YELLOW and the display will change from PROG to the assigned product choice.

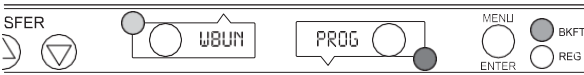

- B. Press the UP or DOWN Arrow button to scroll to the desired product choice.  
C. Press the MENU/ENTER button to save the selection. All displays will show PROG.



- 4** A. Repeat Steps 2 and 3 as required.  
B. Press the PRINCE CASTLE LOGO button to exit the Program Mode and return to the Run Mode.

*NOTE: Up to six items (one for each menu) may be programmed for each PAN button. A pan may be set as "not used" by assigning "----" as its product.*



## Changing the Hold and Cook-More Times

- 1** A. The SET PRODUCT TIME menu is used to change the Hold and Cook-More times.  
B. Press and hold the PRINCE CASTLE LOGO button, then immediately press and hold the MENU/ENTER button until the display shows one of the programming menus.  
C. Use the UP or DOWN Arrow button to scroll to the PROD TIME ↑ ↓ ENTR menu. (*NOTE: Units with 6 or 8 Pan displays will show SET PRODUCT TIME ↑ ↓ ENTR.*)

PRINCE CASTLE LOGO Button

MENU/ENTER Button



## Changing the Hold and Cook-More Times (continued)

- 2** A. Press and release the MENU/ENTER button to enter the Set Product Time menu. The display will show, for example, EGGS TIME ↓ ↑ ENTR.
- B. Use the UP or DOWN Arrow button to scroll through the list of products. When the desired product is displayed, press the MENU/ENTER button to select it.

Refer to the Product Menu Details on page 11 for a list of products and their corresponding display names.



*NOTE: Holding the UP or DOWN Arrow button for longer than 2 seconds will cause the product list to automatically scroll up or down.*

- 3** A. The display now shows the current Hold time.



- B. Use the UP or DOWN Arrow button to scroll to the desired Hold time. When the desired Hold time is displayed, press the MENU/ENTER button to save the desired Hold time.



*NOTE: Hold time cannot be reduced to less than the Cook-More time plus one minute.*

- 4** A. The display will now show current Cook-More time. Use the UP or DOWN Arrow button to scroll to the desired Cook-More time.



- B. When the desired Cook-More time is displayed, press the MENU/ENTER button to save it.



*NOTE: Cook-More time cannot be increased to more than the Hold time minus one minute.*

- 5** A. The display will show PROD TIME ↑ ↓ ENTR. Repeat Steps 2 – 4 for any other product.

- B. Press and release the PRINCE CASTLE LOGO button at any time to exit the Program Mode and return to the Run Mode.

*NOTE: If the MENU/ENTER button has not been pressed to save any changes, the program will revert to the original values.*



## Setting the Alternating Display Interval

- A. The Alternating Display Interval allows the timer bar displays to alternate between the product name and remaining Hold time. The default setting is 5 seconds.
- B. Press and hold the PRINCE CASTLE LOGO button, then immediately press and hold the MENU/ENTER button until the display shows one of the programming menus.
- C. Use the UP or DOWN Arrow button to scroll to the DISP ALT TIME menu. Press MENU/ENTER button.
- D. Use the UP and DOWN Arrow buttons to adjust the interval setting from 0 to 15 seconds. Press MENU/ENTER to save the change.
- E. Press and hold the PRINCE CASTLE LOGO button at any time to exit the Program Mode.

PRINCE CASTLE LOGO Button

MENU/ENTER Button



## Changing Product Names

- 1** A. The EDIT PRODUCT NAME menu is used to change a default product name to one of your own choosing.
  - B. Press and hold the PRINCE CASTLE LOGO button, then immediately press and hold the MENU/ENTER button until the display shows one of four programming menus.
  - C. Use the UP or DOWN Arrow button to scroll to the PROD NAME ↑ ↓ ENTR menu.
- NOTE: The default names available for editing are listed on page 11.*

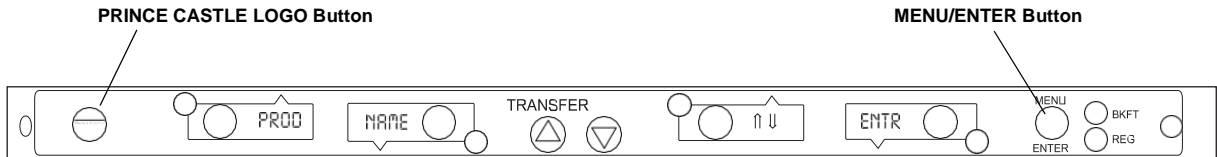

- 2** A. Press and release the MENU/ENTER button to enter the Edit Product Name menu.  
The display will read PROD XXXX ↑ ↓ ENTR.
- B. Use the UP or DOWN Arrow button to scroll through the list of products.
- C. When the desired product is displayed, press the MENU/ENTER button to select it. The first letter (in this case, the E) will start blinking.



- 3** A. To change the blinking E, use the UP or DOWN Arrow button to scroll to the desired letter/number/symbol.
- B. When the desired selection is displayed, press the PAN button (to the left or right of the selected display) to move to the next digit.
- C. Repeat for all digits.



*NOTE: Holding the UP or DOWN Arrow button for longer than 2 seconds will cause the selected digit to automatically scroll up or down.*

- 4** When all four digits have been changed, press the MENU/ENTER button to save the new name.



- 5** A. The display will show PROD NAME ↑ ↓ ENTR. Repeat Steps 2 – 4 for any other product.
  - B. Press and release the PRINCE CASTLE LOGO button at any time to exit the Program Mode and return to the Run Mode.
- NOTE: If the MENU/ENTER button has not been pressed to save any changes, the program will revert to the original names.*



## Set Volume Level

- 1** A. The default setting for the volume level is OFF.
- B. Press and hold the PRINCE CASTLE LOGO button, then immediately press and hold the MENU/ENTER button until the display shows one of the programming menus.
- C. Use the UP or DOWN Arrow button to scroll to the Set Vol 0 ↑ ↓ ENTR menu.

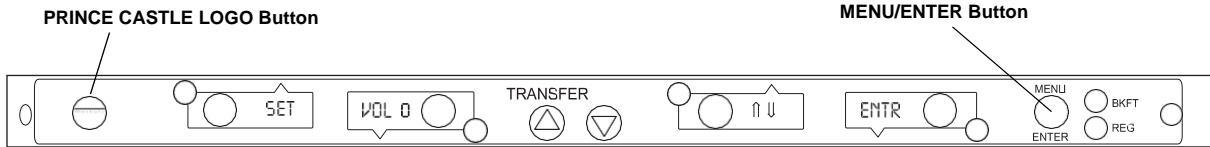

- 2** A. Press and release the MENU/ENTER button to enter the Set Volume menu.
  - B. The display shows SET VOL 0 ↑ ↓ ENTR. This shows that the volume is currently turned off.
- The volume may be set for Vol 0 (off) or for volume levels Vol 1 through Vol 3.

- 3** A. To change the volume level, use the UP or DOWN Arrow button to scroll to the desired level. When the desired selection is displayed, press the MENU/ENTER button.
  - B. Press and release the PRINCE CASTLE LOGO button at any time to exit the Program Mode and return to the Run Mode.
- NOTE: If the MENU/ENTER button has not been pressed to save any changes, the program will revert to the original time.*

## Set Bar Position

- 1** To check the timer position on the main bar, press and hold the PRINCE CASTLE LOGO button and the DOWN Arrow button. The current timer bar position will be displayed in the far right timer display as POS X.
- NOTE: X = the setting.*
- To change the timer bar position, proceed to Step 2.
- To check the timer position on the aux bar press and hold the logo only.

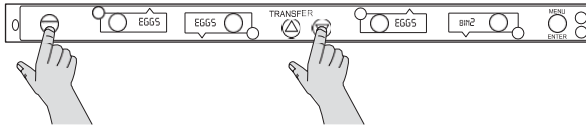

- 2** To change the main timer bar position, press and hold the PRINCE CASTLE LOGO button and the DOWN Arrow button for approximately 6 seconds or until the display shows POSN # \$ ENTR POS X.
- The address number will blink on/off.
- NOTE: X = current bar position setting. SET will not show on the 4 channel bar.*

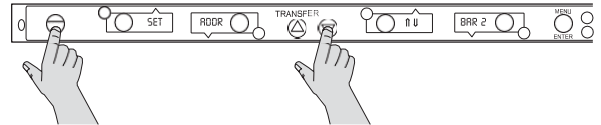

- 3** Use the UP or DOWN Arrow button to scroll to the desired position. The right most display shows the position letter to be selected. Press the MENU/ENTER button to store the new position and return to normal Operating Mode.
- NOTE: The position choices for 2 cavity bins are A and B. The position choices for 4 cavity bins are A through F.*
- If the bin has a corresponding aux timer bar on the back, the aux bar will automatically update itself to match the position selection of its main bar.*
- NOTE: To cancel at any time with saving changes, press the LOGO button.*

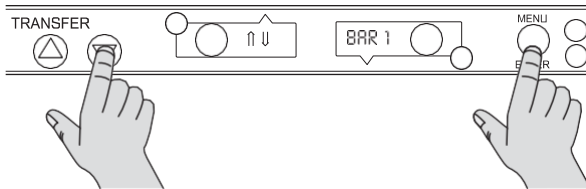

- 4** To check the current position setting on the main timer bar without making a change, press and hold the LOGO and the DOWN buttons simultaneously. On the aux timer bar, press and hold the LOGO button only.
- One of the displays will show POS X to indicate the current position setting, where X is the setting.

## Product Menu Details

Product	Display Name (2)	Product Type (4)	Hold — Minutes (1)	Cook More — Minutes (1)	Product	Display Name (2)	Product Type (4)	Hold — Minutes (1)	Cook More — Minutes (1)
Breakfast Ham	HAM	Grill	8	0	Cheese Sticks	MOZZ	Fryer	15	0
Chicken Fajita Mix	FAJI	Grill	30	0	Chicken Nuggets	NUGS	Fryer	20	0
Fried Eggs	EGGS	Grill	12	0	Chicken Patty	CHIX	Fryer	45	0
Grilled Chicken Fillet	CHXN	Grill	30	0	Chicken Strips	CSPY	Fryer	30	0
Grilled Chicken Strips	STRP	Grill	30	0	Churros	CHUR	Fryer	15	0
Grilled Onions	ONIO	Grill	45	0	Egg Rolls	EROL	Fryer	30	0
Jumbo Patty	JMBO	Grill	20	0	Fish	FISH	Fryer	15	0
Regular Patty	REGU	Grill	15	0	Hash Brown Sticks	HASH	Fryer	15	0
Sausage Patty	SAUS	Grill	45	0	Homestyle Chicken	HOME	Fryer	30	0
Scrambled Eggs	SCRM	Grill	30	0	Jalapenos	JPOP	Fryer	20	0
Sirloin Patty	SIRL	Grill	20	0	Onion Rings	ORNG	Fryer	5	0
Portuguese Sausage	PORT	Grill	45	0	Potato Wedges	WEDG	Fryer	30	0
SPAM	SPAM	Grill	30	0	Spicy Chicken	SPCY	Fryer	30	0

- 1) Hold and Cook-More times may be reprogrammed — see instructions.
- 2) Product abbreviations may be reprogrammed — see instructions.
- 3) Sound enabled.
- 4) Fryer product temperatures are 275°/225°F  
Grill product temperatures are 325°/225°F

**Menus**

**DHB2PT-20UJB & DHB4SS-20UJB**

Main	Timer	4	3	2	1
MNU1	Bkft	<b>SCRM</b>	<b>SCRM</b>	<b>EGGS</b>	<b>EGGS</b>
MNU2	Fried	<b>CSPY</b>	<b>CSPY</b>	<b>SPCY</b>	<b>SPCY</b>
MNU3	Grilled	<b>REGU</b>	<b>REGU</b>	<b>JMBO</b>	<b>JMBO</b>

**DHB2PT-33UJB & DHB2SS-33UJB**

Main	Timer	1	2	3	4	5	6	7	8
MNU1	Bkft	<b>SCRM</b>	<b>SCRM</b>	<b>EGGS</b>	<b>EGGS</b>	<b>E GGS</b>	<b>EGGS</b>	<b>EGGS</b>	<b>EGGS</b>
MNU2	Fried	<b>CSPY</b>	<b>CSPY</b>	<b>CSPY</b>	<b>CSPY</b>	<b>SPCY</b>	<b>SPCY</b>	<b>SPCY</b>	<b>SPCY</b>
MNU3	Grilled	<b>ONIO</b>	<b>ONIO</b>	<b>JMBO</b>	<b>JMBO</b>	<b>JMBO</b>	<b>JMBO</b>	<b>JMBO</b>	<b>JMBO</b>

**Timer Bar Positions on Bins**

**DHB4PT-20UJB & DHB4SS-20UJB**  
Four cavity bin with four 4-channel timer bars:

Timer Bar Position A, Address 1

Timer Bar Position B, Address 2

Timer Bar Position C, Address 3

Timer Bar Position D, Address 4

**DHB2PT-33UJB & DHB2SS-20UJB**  
Two cavity bin with two 8-channel timer bars:

Timer Bar Position A, Address 1

Timer Bar Position B, Address 2

**Bar Address**

To check the bar address on the main timer bar, press and hold the LOGO button and the DOWN Arrow simultaneously. On the aux bar press and hold the LOGO only button. The bar address is shown as BARY as on other bars where y is the address.

The Timer Bar address is automatically set when the Bar Position is selected as follows:

Position	Address Default
A	1
B	2
C	3
D	4
E	5
F	6

The address can be changed at power on as on other bars, but loading presets will change the address back to the default in the list above. Loading presets will not change the selected position.

**Special Programming Mode**

- 1** A. Press and hold the PRINCE CASTLE LOGO button then immediately press and hold the MENU/ENTER button. Hold both buttons for six seconds. The displays will change to show the first menu — depending on model.
- B. Press and release the UP and DOWN buttons to scroll through the list of Special Modes.

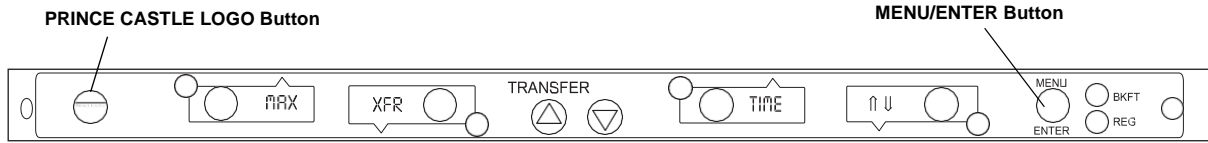

**2 Set Link Group**  
*NOTE: Preset link group is set to GRP1 from factory.*

- A. When the displays show SET LINK GRP<sub>x</sub> ↑ ↓ ENTR, the X indicates the currently assigned Link Group. Press and release the MENU/ENTER button to set the Link Group Mode.
- B. The link group number (X) will flash. Press and release the UP or DOWN Arrow button to change the group number. The maximum number allowed is 3, and the minimum is 0. When a Timer Bar is assigned to Link Group 0, it is isolated and not associated with any other Timer Bar (linking is disabled).
- C. When the desired link group is displayed, press and release the MENU/ENTER button to save it. The program will revert to Set Link Group Mode.



**Troubleshooting**

PROBLEM	PROBABLE CAUSE	SOLUTION
Display flashes Opn and rEL.	Open relay. Circuit inoperable.	Consult an authorized Service Technician.
Display flashes SHr and rEL.	Shorted relay. Circuit inoperable. Open heater. Unplugged ribbon cable between power and main circuit boards.	Consult an authorized Service Technician.
Display flashes Opn and rEL.	Temperature is below 75°F. Heater inoperable. Probe inoperable. Relay inoperable.	Consult an authorized Service Technician.
Display shows HHH for an extended period of time and heater surface temperature is hot.	Temperature is above 300°F (abnormal operation).	Consult an authorized Service Technician.
Display shows HHH for an extended period of time and heater surface temperature is cool.	Probe is inoperable.	

Service Parts List

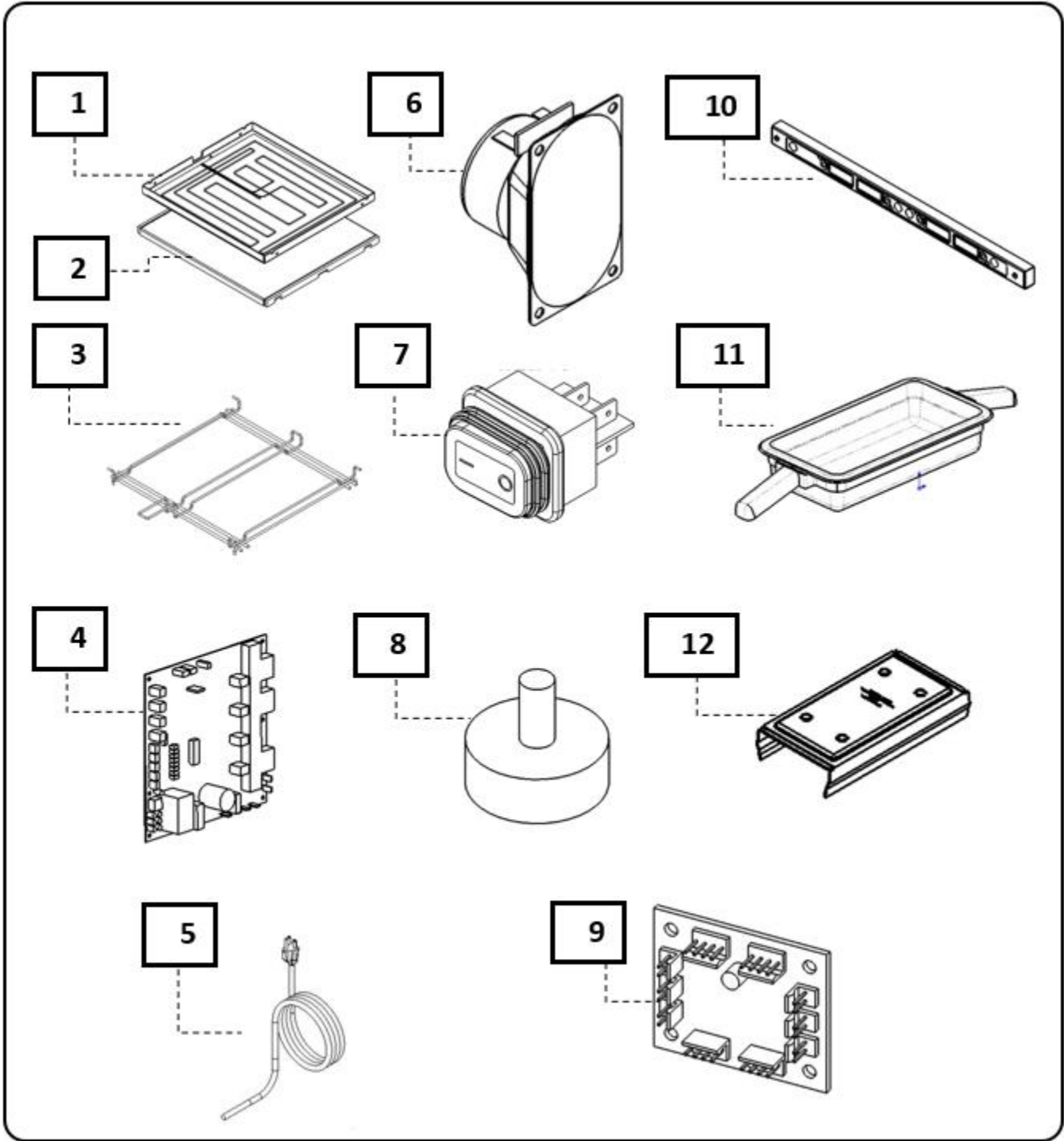

**Parts List**

<b>Ref</b>	<b>Part No</b>	<b>Description</b>
1	542-435S	Kit, Upper Heater Assy <b>(33UJBs)</b>
	542-425S	Kit, Upper Heater Assy <b>(27UJBs)</b>
	542-420S	Kit, Upper Heater Assy <b>(20UJBs)</b>
2	542-430S	Kit, Lower Heater Assy <b>(33UJBs)</b>
	542-415S	Kit, Lower Heater Assy <b>(27UJBs)</b>
	542-410S	Kit, Lower Heater Assy <b>(20UJBs)</b>
3	542-293S	Kit, Rack Guide <b>(33UJBs)</b>
	542-467S	Kit, Rack Guide <b>(27UJBs)</b>
	542-184S	Kit, Rack Guide <b>(20UJBs)</b>
4	541-1348S	Kit, Main PCB <b>(2PT/2SS-33UJB/2SS-27UJB)</b>
	541-1346S	Kit, Main PCB <b>(4SS/4PT-20UJB)</b>
	541-1367S	Kit, Main PCB <b>(2SS-20UJB)</b>
5	72-528S	Kit, Power Cord <b>(33UJBs)</b>
	72-521S	Kit, Power Cord <b>( All other models)</b>
6	88-709-2-11S	Kit, Speaker
7	78-219S	Kit, Power Switch
8	197-232S	Kit, Foot Mounting
9	541-959S	Kit, PCB Audio Interface
10	510-118S	Kit, Main Timer Bar <b>(2PT/2SS-33UJBs)</b>
	510-116S	Kit, Main Timer Bar <b>(4PT/4SS-20UJBs)</b>
	510-231S	Kit, Main Timer Bar <b>(2SS-20UJB)</b>
	510-233S	Kit, Main Timer Bar <b>(2SS-27UJB)</b>
	510-119S	Kit, Aux Timer Bar <b>(2PT-33UJB)</b>
	510-117S	Kit, Aux Timer Bar <b>(4PT-20UJB)</b>
11	541-442S	Kit, Pan <b>(2PT-33UJB)</b>
	541-1095S	Kit, Pan <b>(All other models)</b>
12	542-286S	Kit, Cover

Wiring Diagrams

DHB2PT-33JB

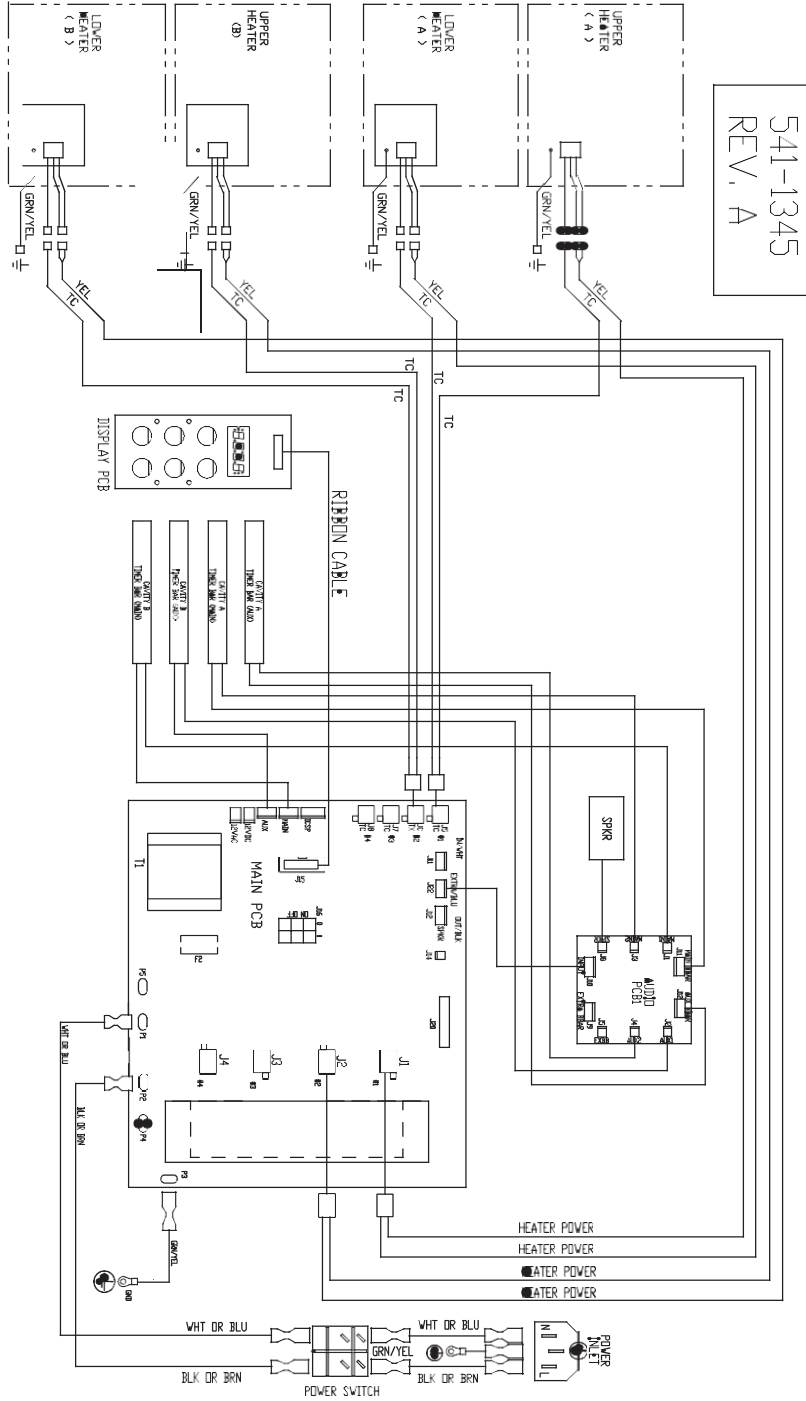

541-1345  
REV. A

Wiring Diagrams (continued)

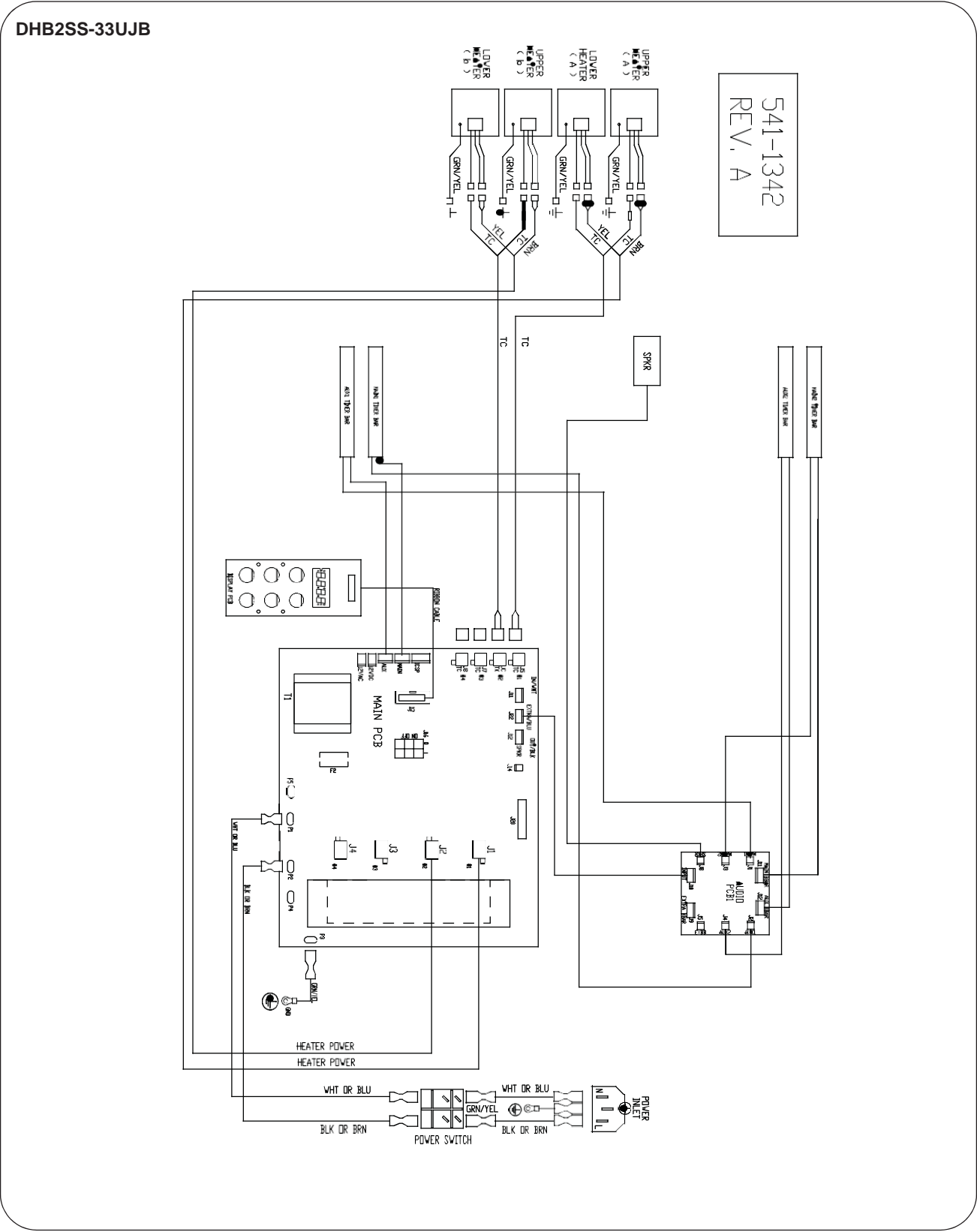

**Wiring Diagrams (continued)**

**DHB4PT-20UJB & DHB4SS-20UJB**

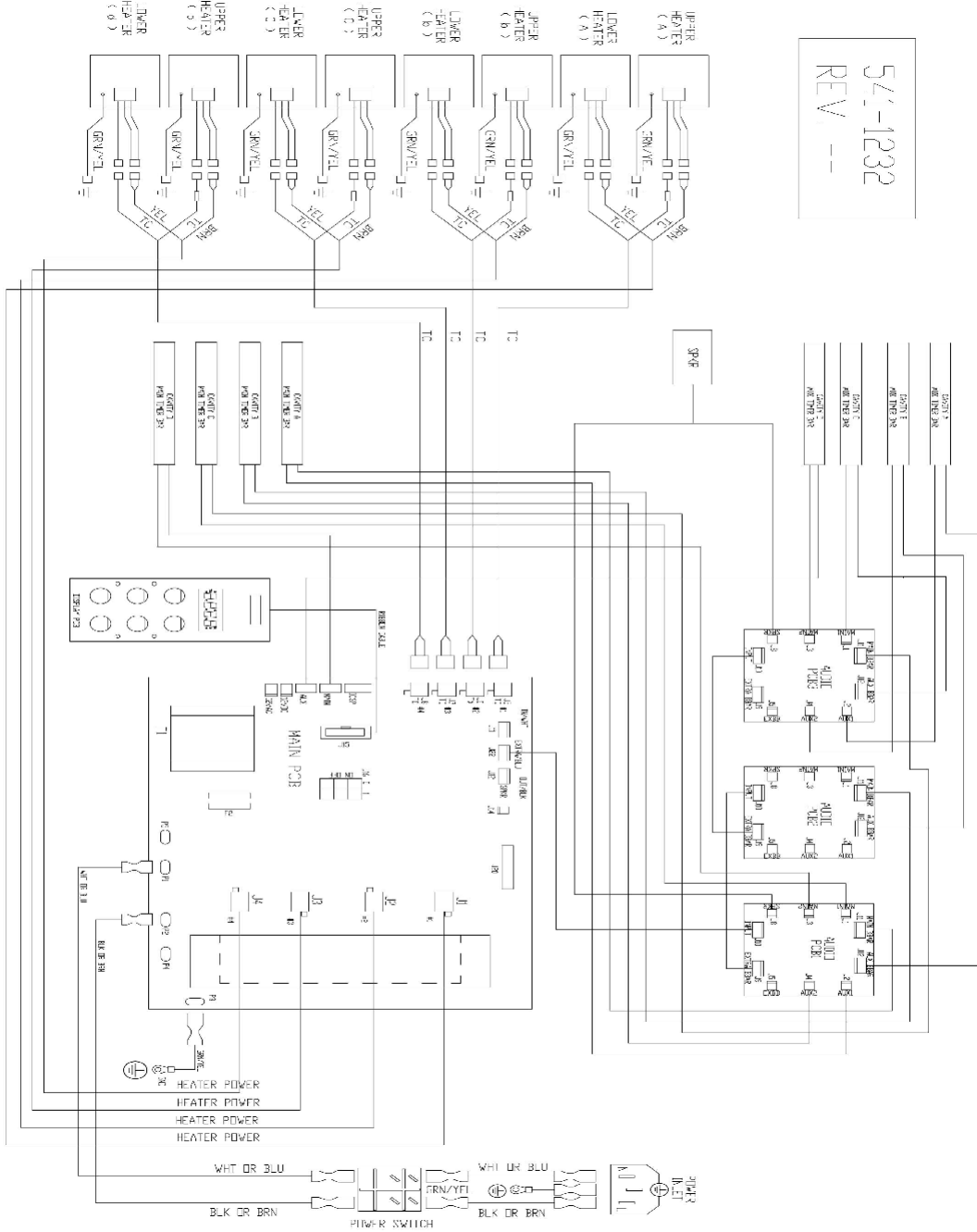

57-1232  
 REV. --