

# Operation Manual

Product Holding Bin  
DHB2PT Series

## Product Identification

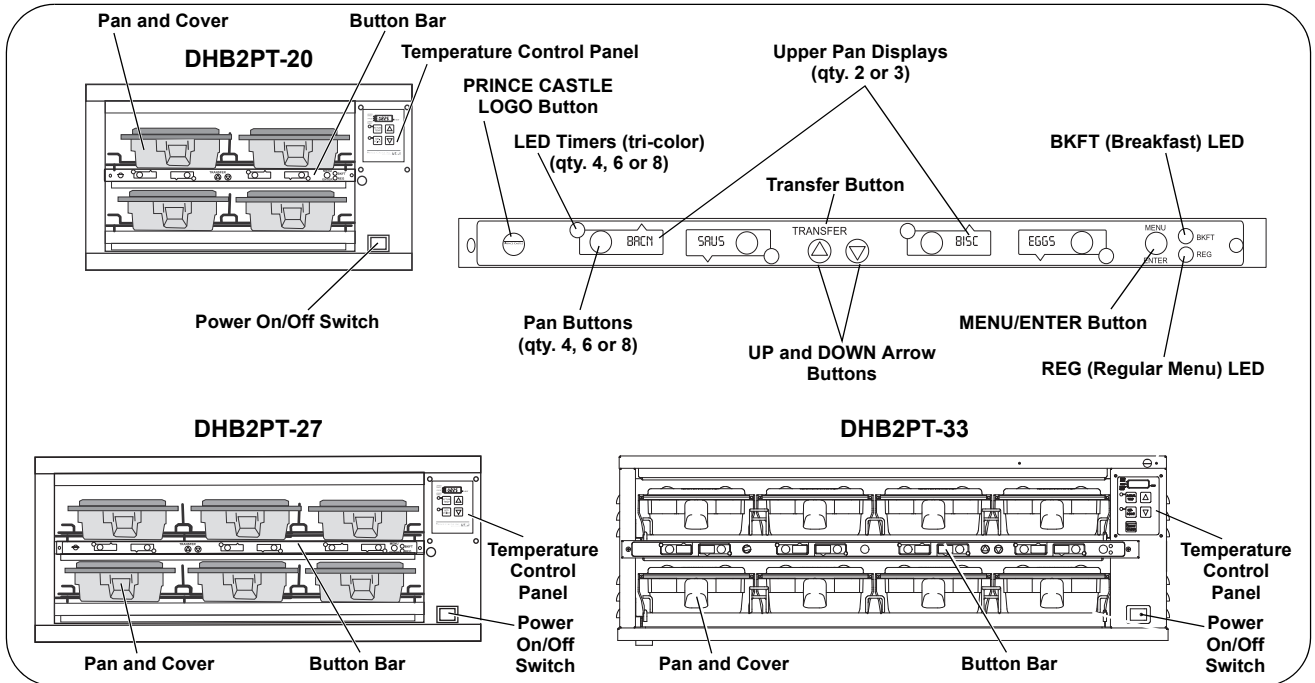

### LIMITED WARRANTY

This product is warranted to be free from defects in material and/or workmanship for a period of 1 year from date of original installation, not to exceed 18 months from the date of manufacture.

Any component which proves to be faulty in material and/or workmanship will be replaced or repaired (at the option of Prince Castle, Inc.) without cost to the customer for parts and labor. This warranty covers on-location service (i.e. trip charges and/or mileage). Travel mileage is limited to 100 miles (200 Kilometers) round trip (one trip warranty) from an authorized service agency or its sub-service agency.

This warranty is subject to the following exceptions/conditions:

- Use of any non-genuine Prince Castle parts voids this warranty.
- All labor to be performed during regular work hours. Overtime premium (the incremental amount) will be charged to the customer.
- Damage caused by carelessness, neglect and/or abuse (e.g., dropping, tampering or altering parts, equipment damaged in shipment, by fire, flood or an act of God) is not covered under this warranty.
- All problems due to operation at voltages other than that specified on equipment nameplates are not covered by this warranty. Conversion to correct voltage is the customer's responsibility.
- This equipment must be serviced by Prince Castle Authorized Service Agency or a Prince Castle Service Technician during the warranty period.

### TABLE OF CONTENTS

|  |        |
|--|--------|
| Product Identification .....                           | 1      |
| Safety Information .....                               | 2      |
| Installation .....                                     | 2      |
| Operation .....  | 3      |
| Cleaning .....   | 4      |
| Programming .....                                      | 7 – 10 |
| CastleNet® Communications Network .....                | 11     |
| Factory Presets .....                                  | 12     |
| Troubleshooting .....                                  | 13     |
| Exploded View and Parts List (DHB2PT-20B) .....        | 14     |
| Exploded View and Parts List (DHB2PT-27B/-27BCE) ..... | 15     |
| Exploded View and Parts List (DHB2PT-33) .....         | 16     |
| Wiring Diagram .....                                   | 17     |



**PRINCE CASTLE LLC**  
WORLDWIDE

355 East Kehoe Blvd. • Carol Stream, IL 60188 USA  
Telephone: 630-462-8800 • Toll Free: 1-800-PCASTLE  
Fax: 630-462-1460 • www.princecastle.com

**Specifications**

| Model        | Volts     | Watts | Hertz | Model        | Volts     | Watts | Hertz |
|--------------|-----------|-------|-------|--------------|-----------|-------|-------|
| DHB2PT-20B   | 120       | 1700  | 60    | DHB2PT-20BCE | 220 – 240 | 1500  | 50    |
| DHB2PT-27B   | 120       | 1650  | 60    | DHB2PT-33BCE | 240       | 2600  | 50    |
| DHB2PT-27BCE | 230       | 2500  | 50    | DHB2PT-33BGB | 220 – 240 | 2500  | 50    |
| DHB2PT-33B   | 208 – 240 | 2500  | 50/60 |              |           |       |       |

**Safety Information**



**WARNING**

Indicates information important to the proper operation of the unit. Failure to observe may result in damage to the equipment and/or severe bodily injury or death.



**CAUTION**

Indicates information important to the operation of the unit. Failure to observe may result in damage to the equipment.

**Installation**

- A. Remove the unit from the carton and inspect for signs of damage. If there is damage to the unit:
  - notify the carrier within 24 hours of delivery
  - save carton and packaging materials for inspection purposes
  - contact your local dealer, or if purchased directly, the Prince Castle Sales Department at 800-722-7853 or 1-630-462-8800 to arrange for a replacement unit.

*NOTE: When installing this unit, the ambient temperature at the mounting site should not exceed 100°F.*

- B. Place the bin on a counter and seal the base to the counter with food-approved sealant.
- C. Plug the power cord into the bin and connect the plug into the proper electrical outlet. All connections must be in accordance with local electrical codes and any other applicable codes.

*NOTE: The electrical receptacle should be a dedicated outlet. No other equipment should be operating on the line (refrigerators, fryers, etc.).*

- D. If used, plug a Prince Castle external timer bar (consult factory for model) data cable into the blue plug jack (external) located on the rear of the Prince Castle holding bin. If cable from timer is too short, use Prince Castle Extender Cable Kit, P/N PC-COMEXT.
- E. Install the racks, pans and pan covers into the cavities.

- F. Turn the power switch to ON. Allow 30 minutes for warm-up.

*NOTE: If the unit is to be networked with other Prince Castle units, an external timer may be connected to any one bin in the chain. Refer to CASTLENET COMMUNICATIONS NETWORK in this manual.*

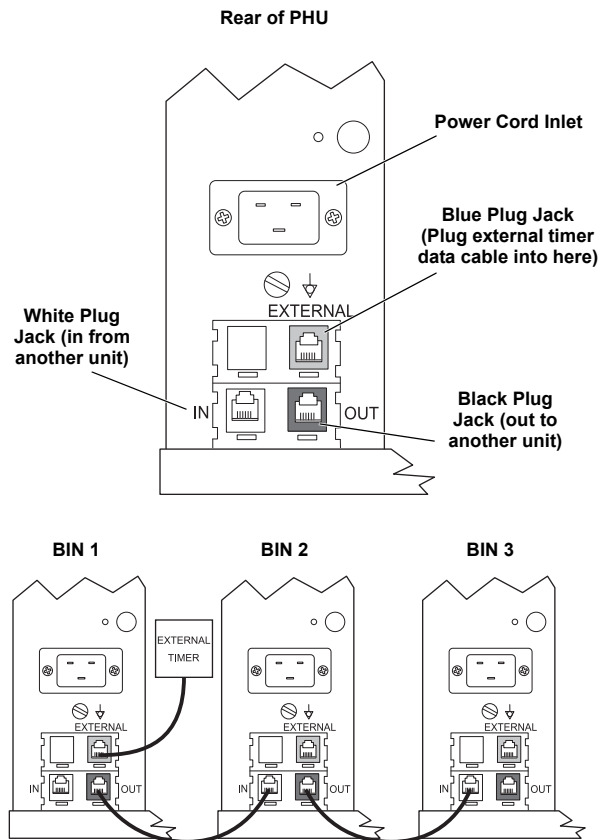

**Prince Castle reserves the right to change specifications and product design without notice. Such revisions do not entitle the buyer to corresponding changes, improvements, additions or replacements for previously purchased equipment.**

**Operation**

**1** Turn power On/Off switch to ON position.

Load pan covers (if used) onto pan racks and insert racks into the unit.

Allow **30 minutes** for heaters to reach operating temperature. The Temperature Display will show temperature as unit warms up to the operating temperature.

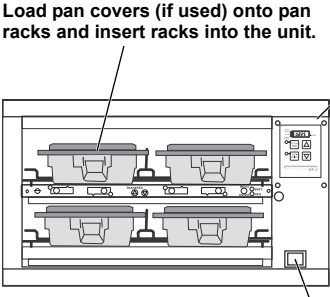

Power On/Off Switch

**2** Press all PAN buttons.



The PAN DISPLAYS will show the assigned product name. If no product is assigned, the display will be dim and show "- - -". Pressing the PAN button will not activate the timer if "- - -" is displayed. Pressing PAN button when product name is displayed will start timing cycle.

BKFT (Breakfast) or REG (Regular Menu) will be lit depending on pre-programmed menu.

**3** LED Timing Status



LED Timers

RED (steady) = Ready for product  
 RED (flashing) = Discard product  
 GREEN (steady) = Oldest product, use first  
 GREEN (flashing) = Cook more product  
 YELLOW (steady) = Newer product, use green first  
 YELLOW (flashing) = Cook more product

**4** When LED is steady RED, load product and press the PAN button.

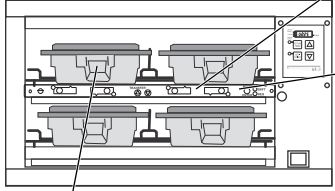

If no other pan is active for a product, the LED for the first pan loaded will turn from RED to GREEN.

The LED for the 2nd pan (3rd pan, etc.) loaded will turn from RED to YELLOW.

An LED timer can be stopped (cancelled) at any time by pressing and releasing the corresponding PAN button.

If only one pan is active for a product, the LED will turn from RED to GREEN.

**5** When any of the timer LEDs flash, cook more product or remove and discard product as indicated.

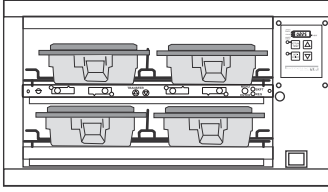

GREEN (flashing) = Cook more product  
 YELLOW (flashing) = Cook more product  
 RED (flashing) = Discard product

**WARNING**  
Hot surfaces.

**6** Product, along with any remaining time, can be transferred from one cavity to another as follows:

A. Press and release the TRANSFER button. Displays for available bins are brightly lit. Displays for bins currently timing, are dimly lit.

B. Press and release the PAN button of the product to be moved.

C. Press and release the TRANSFER button again.

D. Move the product. Press and release the PAN button for the new location. The new location will finish timing the product. When the transferred pan timing expires, location will revert to original menu setting.

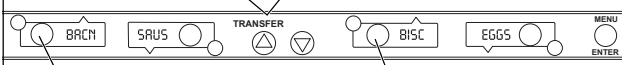

*NOTE: If product transfer is not completed within a pre-programmed transfer time, the transfer will be cancelled. See your Manager.*

**Operation (continued)**

**7**

To change a menu selection for a specific pan cavity, use the following steps:

- A. Press and hold the PRINCE CASTLE LOGO button for 6 seconds. All Pan displays will show PROG. All LED Timers will be RED.      D. Press the UP or DOWN Arrow button to scroll to the desired product choice.      E. Press the MENU/ENTER button to select the product choice.



- B. Press and hold the MENU/ENTER button. The display next to the MENU/ENTER button will display the product choices. While holding the MENU/ENTER button, press the UP or DOWN Arrow button to scroll through the product choices. While scrolling, the BKFT LED will be lit for the breakfast menus and the REG LED will be lit for the regular menus.
- C. Press a PAN button to change the product. the LED timer will change to yellow and the display will change from PROG to the assigned product choice and two other displays will change to up and down arrows and ENTR.
- F. Repeat Steps A – E as required for other Pan displays. Press the PRINCE CASTLE LOGO button to exit the Program Mode.
- NOTE: Up to six products may be programmed for each Pan button (1 for each menu). In addition, a pan may be set as "not used" by assigning "----" as its product.*

**8**

To shut down the unit, turn the power On/Off switch to OFF.

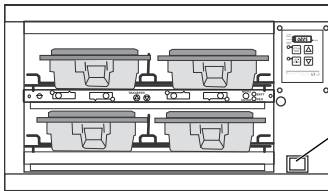

**Cleaning**

**WARNING**

Before performing any maintenance, turn the power switch to the OFF position and unplug the power cord from the electrical receptacle.

**CAUTION**

This unit is not watertight. Do not clean with a water jet/jet spray. Do not immerse the unit in water.

1. Turn the unit off and unplug the power cord from the electrical receptacle.
2. Remove the pan covers and pan racks. Wipe all parts and unit with a damp cloth. DO NOT use a green Scotch Bright pad cleaner, ice or water.

## Setting the Temperature

- The unit has two shelves, each with an upper and lower heater (four heaters total).  
 The factory pre-set for the upper heaters is 225°F.  
 The factory pre-set for the lower heaters is 195°F.  
 Each upper heater has a programmable range of 150° – 275°F.  
 Each lower heater has a programmable range of 150° – 225°F.  
 Use the control below and the following steps to set the setpoint temperature for each heater.

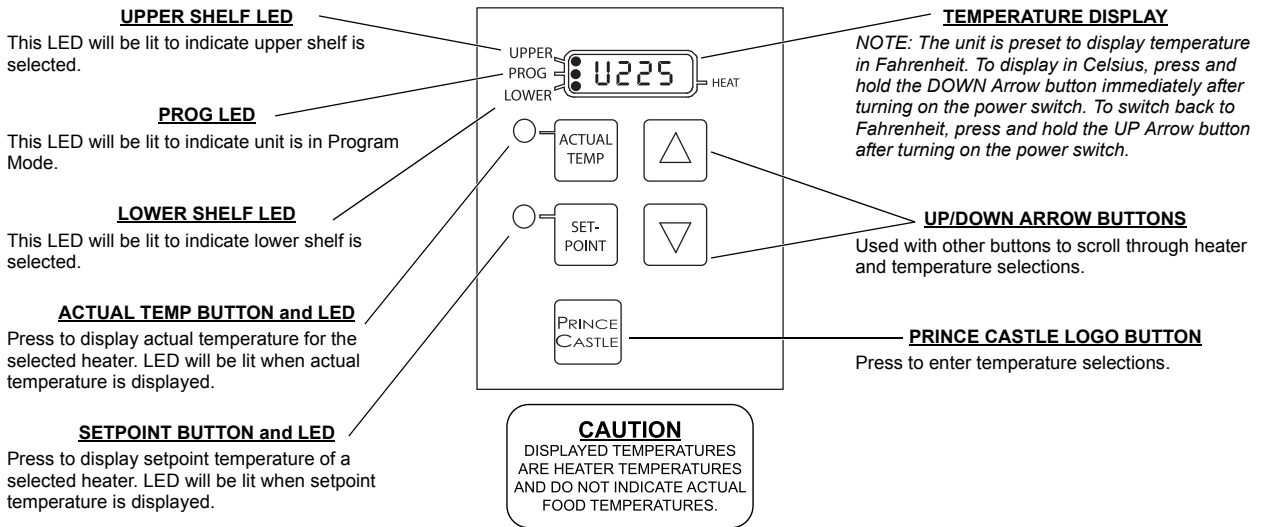

*NOTE: To reset all times and temperatures to the factory settings, turn the unit off, then press and hold the UP and DOWN Arrow buttons simultaneously while turning the unit back on. A "P" will appear in the display and all times and temperatures will be reset to original factory settings.*

- Press the UP or DOWN Arrow button until the desired shelf LED and upper (U) or lower (L) shelf is selected.

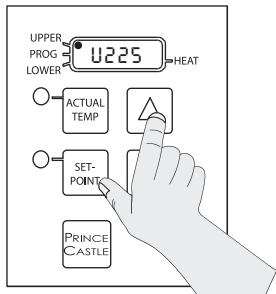

- Press and hold the SETPOINT button and the PRINCE CASTLE LOGO button for 5 seconds. The Program LED will light.

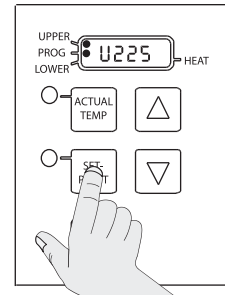

- Press the UP or DOWN Arrow button until the desired setpoint temperature is displayed.

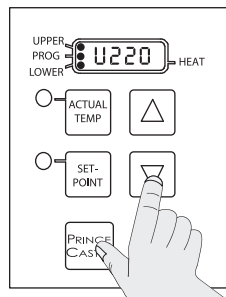

- Press the PRINCE CASTLE LOGO button to save the new setpoint value. Repeat steps 2 – 5 to change the setpoint for any other heater.

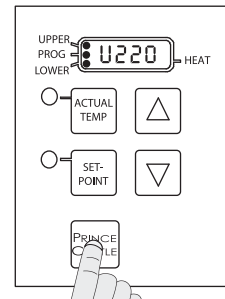

**Calibrating Heaters**

**1** Use the following steps to calibrate the individual heaters.

*NOTE: Allow sufficient amount of time for temperatures to stabilize before starting calibration.*

Press the UP or DOWN Arrow button until the desired shelf LED and upper (U) or lower (L) heater is selected.

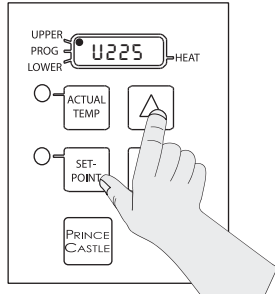

**2** Take a temperature reading within the shelf near the center of the heater surface.

Use a stand-alone temperature meter (not supplied).

**WARNING**  
Hot surfaces. Use caution when taking temperature readings within the shelf.

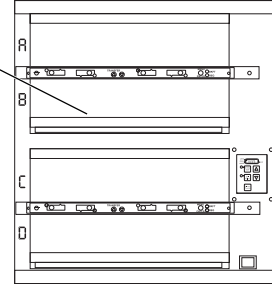

**3** A. Press and hold the PRINCE CASTLE LOGO and ACTUAL TEMP buttons for 5 seconds. The colon (:) LED indicator will light. The temperature displayed is the actual heater temperature sensed by the controller.  
B. To clear any offset readings, press the SETPOINT button.

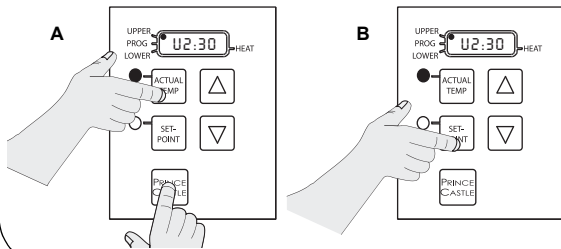

**4** A. Press the UP or DOWN Arrow button until the temperature displayed matches the reading obtained in Step 2.  
B. Press the PRINCE CASTLE LOGO button to save the temperature value and exit the Calibration Mode.

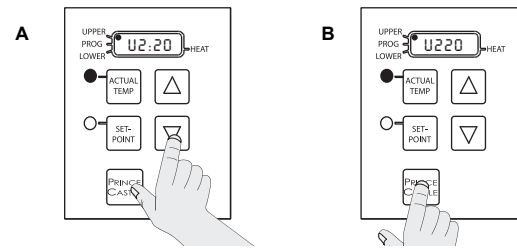

**Selecting Breakfast and Regular Menus**

**1** There are six menus available:  
BKFT LED ON = Menu1 or Menu6  
REG LED ON = Regular2, Regular3, Regular4, or Regular5  
Press and hold the MENU/ENTER button, then use the UP or DOWN Arrow button to scroll through the 6 menus.

When scrolling, menu numbers appear in this display.



**2** When the desired menu is displayed, release the MENU/ENTER button. The food products for the menu will be displayed in the upper and lower PAN displays.

When timers for a different menu are still active, those BKFT or REG LEDs will flash until they are all cancelled.

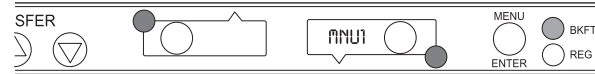

## Programming the Menus

- 1** Press and hold the PRINCE CASTLE LOGO button (on the button bar) until all the displays show PROG and the PAN buttons LEDs all glow RED.



- 2** Press and hold the MENU/ENTER button. The display next to the MENU/ENTER button will show the menu choices. Use the UP or DOWN Arrow button to scroll through the 6 menus. Release the MENU/ENTER button when the desired menu is displayed.

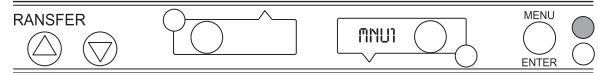

When the MENU/ENTER button is released, all displays will again show PROG.



- 3** A. Press the PAN button next to the display to be changed. The LED will change from RED to YELLOW and the display will change from PROG to the assigned product choice.



- B. Press the UP or DOWN Arrow button to scroll to the desired product choice.  
C. Press the MENU/ENTER button to save the selection. All displays will show PROG.



- 4** A. Repeat Steps 2 and 3 as required.  
B. Press the PRINCE CASTLE LOGO button to exit the Program Mode and return to the Run Mode.

*NOTE: Up to six items (one for each menu) may be programmed for each PAN button. A pan may be set as "not used" by assigning "---" as its product.*



## Changing the Hold and Cook-More Times

- 1** A. The SET PRODUCT TIME menu is used to change the Hold and Cook-More times.  
B. Press and hold the PRINCE CASTLE LOGO button, then immediately press and hold the MENU/ENTER button until the display shows one of the programming menus.  
C. Use the UP or DOWN Arrow button to scroll to the PROD TIME ↑ ↓ ENTR menu. (*NOTE: Units with 6 or 8 pan displays will show SET PRODUCT TIME ↑ ↓ ENTR.*)

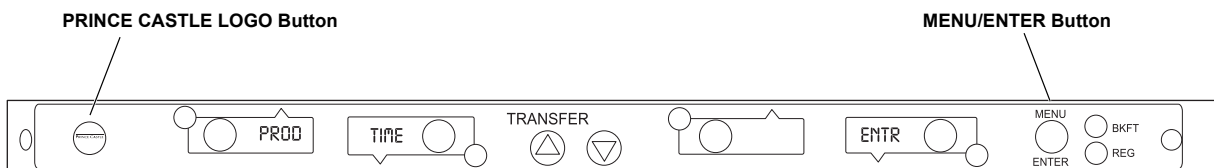

## Changing the Hold and Cook-More Times (continued)

- 2** A. Press and release the MENU/ENTER button to enter the Set Product Time menu. The display will show, for example, EGGS TIME ↑ ↓ ENTR.
- B. Use the UP or DOWN Arrow button to scroll through the list of products. When the desired product is displayed, press the MENU/ENTER button to select it.

Refer to the Product Menu Details on page 12 for a list of products and their corresponding display names.



*NOTE: Holding the UP or DOWN Arrow button for longer than 2 seconds will cause the product list to automatically scroll up or down.*

- 3** A. The display now shows the current Hold time.



- B. Use the UP or DOWN Arrow button to scroll to the desired Hold time. When the desired Hold time is displayed, press the MENU/ENTER button to save the desired Hold time.



*NOTE: Hold time cannot be reduced to less than the Cook-More time plus one minute.*

- 4** A. The display will now show current Cook-More time. Use the UP or DOWN Arrow button to scroll to the desired Cook-More time.



- B. When the desired Cook-More time is displayed, press the MENU/ENTER button to save it.



*NOTE: Cook-More time cannot be increased to more than the Hold time minus one minute.*

- 5** A. The display will show PROD TIME ENTR. Repeat Steps 2 – 4 for any other product.
- B. Press and release the PRINCE CASTLE LOGO button at any time to exit the Program Mode and return to the Run Mode.

*NOTE: If the MENU/ENTER button has not been pressed to save any changes, the program will revert to the original values.*



## Setting the Alternating Display Interval

- A. The Alternating Display Interval allows the timer bar displays to alternate between the product name and remaining Hold time. The default setting is 5 seconds.
- B. Press and hold the PRINCE CASTLE LOGO button, then immediately press and hold the MENU/ENTER button until the display shows one of the programming menus.
- C. Use the UP or DOWN Arrow button to scroll to the DISP ALT TIME menu. Press MENU/ENTER button.
- D. Use the UP and DOWN Arrow buttons to adjust the interval setting from 0 to 15 seconds. Press MENU/ENTER to save the change.
- E. Press and hold the PRINCE CASTLE LOGO button at any time to exit the Program Mode.

**PRINCE CASTLE LOGO Button**

**MENU/ENTER Button**



## Changing Product Names

- 1** A. The EDIT PRODUCT NAME menu is used to change a default product name to one of your own choosing.  
 B. Press and hold the PRINCE CASTLE LOGO button, then immediately press and hold the MENU/ENTER button until the display shows one of four programming menus.  
 C. Use the UP or DOWN Arrow button to scroll to the PROD NAME ↑ ↓ ENTR menu.  
*NOTE: The default names available for editing are listed on page 12.*

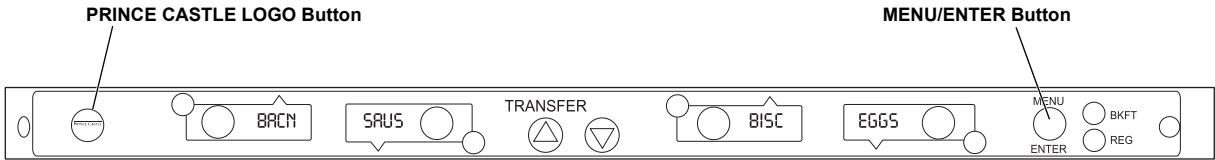

- 2** A. Press and release the MENU/ENTER button to enter the Edit Product Name menu. The display will read PROD XXXX ↑ ↓ ENTR.  
 B. Use the UP or DOWN Arrow button to scroll through the list of products.  
 C. When the desired product is displayed, press the MENU/ENTER button to select it. The first letter (in this case, the E) will start blinking.

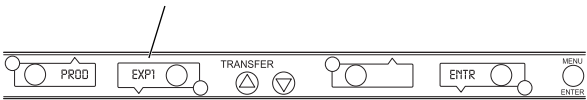

- 3** A. To change the blinking E, use the UP or DOWN Arrow button to scroll to the desired letter/number/symbol.  
 B. When the desired selection is displayed, press the PAN button (to the left or right of the selected display) to move to the next digit.  
 C. Repeat for all digits.



*NOTE: Holding the UP or DOWN Arrow button for longer than 2 seconds will cause the selected digit to automatically scroll up or down.*

- 4** When all four digits have been changed, press the MENU/ENTER button to save the new name.



- 5** A. The display will show PROD NAME ↑ ↓ ENTR. Repeat Steps 2 – 4 for any other product.  
 B. Press and release the PRINCE CASTLE LOGO button at any time to exit the Program Mode and return to the Run Mode.  
*NOTE: If the MENU/ENTER button has not been pressed to save any changes, the program will revert to the original names.*



## Set Maximum Transfer Time

- 1** A. The SET MAXIMUM TRANSFER TIME menu is used to set the amount of time allowed to make a product transfer from one pan to another.  
B. Press and hold the PRINCE CASTLE LOGO button, then immediately press and hold the MENU/ENTER button until the display shows one of the programming menus.  
C. Use the UP or DOWN Arrow button to scroll to the XFR TIME ↑ ↓ ENTR menu. (*NOTE: Units with 6 or 8 pan displays will show MAX XFR TIME ↑ ↓ ENTR.*)

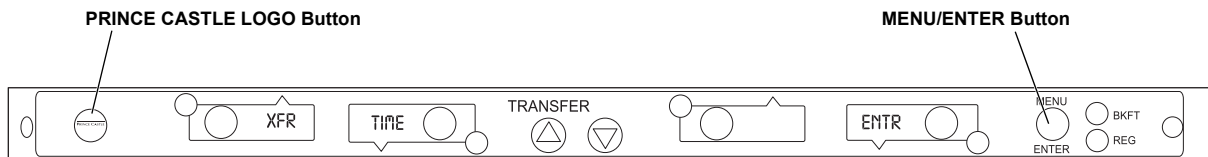

- 2** A. Press and release the MENU/ENTER button to enter the Set Maximum Transfer Time menu.  
B. The display shows XFR :20 ↑ ↓ ENTR. This shows a value of 20 seconds.



- 3** A. To change the time, use the UP or DOWN Arrow button to scroll to the desired time. When the desired selection is displayed, press the MENU/ENTER button to enter the selection.  
B. Press and release the PRINCE CASTLE LOGO button at any time to exit the Program Mode and return to the Run Mode.  
*NOTE: If the MENU/ENTER button has not been pressed to save any changes, the program will revert to the original time.*

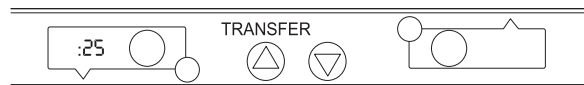

## Set Volume Level

- 1** A. The default setting for the volume level is OFF.  
B. Press and hold the PRINCE CASTLE LOGO button, then immediately press and hold the MENU/ENTER button until the display shows one of the programming menus.  
C. Use the UP or DOWN Arrow button to scroll to the Set Vol 0 ↑ ↓ ENTR menu.

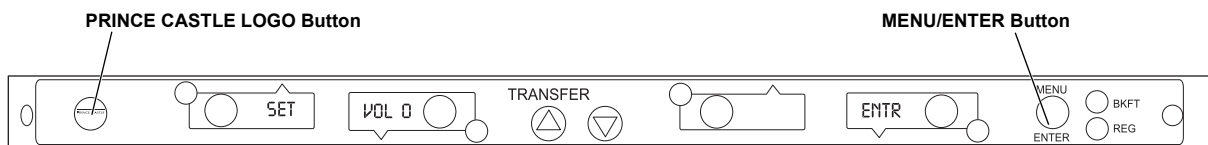

- 2** A. Press and release the MENU/ENTER button to enter the Set Volume menu.  
B. The display shows SET VOL 0 ↑ ↓ ENTR. This shows that the volume is currently turned off.  
The volume may be set for Vol 0 (off) or for volume levels Vol 1 through Vol 3.

- 3** A. To change the volume level, use the UP or DOWN Arrow button to scroll to the desired level. When the desired selection is displayed, press the MENU/ENTER button.  
B. Press and release the PRINCE CASTLE LOGO button at any time to exit the Program Mode and return to the Run Mode.  
*NOTE: If the MENU/ENTER button has not been pressed to save any changes, the program will revert to the original volume level.*

**CastleNet® Communications Network**

The Prince Castle DHB Bins, external timers, and New Bun Cabinet Timers can be inter-connected to form the CastleNet® Communication Network. The network can be used for data transfer between bins and timers for menu updates or to transfer product hold time from bin-to-bin. A PDA (or similar device) or a notebook with Prince Castle MenuView® software is used to connect to the network and enter the desired changes.

Each bin is supplied with a standard 25' cable and allows units to be "daisy-chained" together to form the network. If cable is too short, use Prince Castle Extender Cable Kit, P/N PC-COMEXT.

The factory default address for Main bins and timers is address 1. The factory default address for Specialty bins and timers is address 2. If a third bin is used, the address must be set at 3.

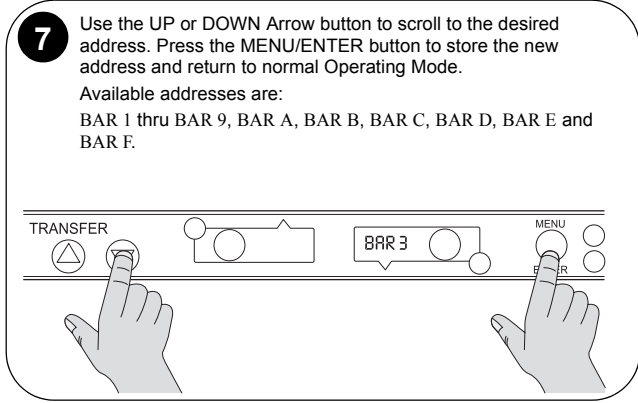
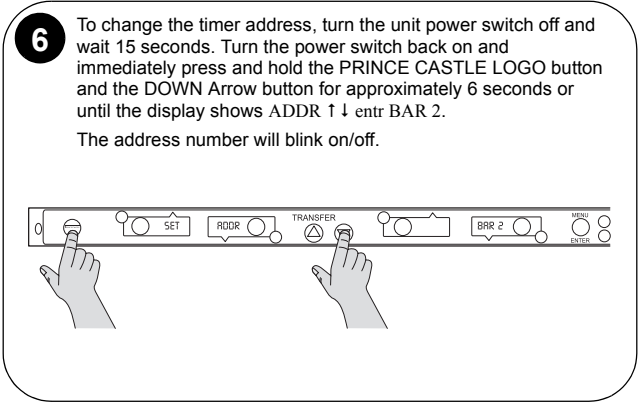
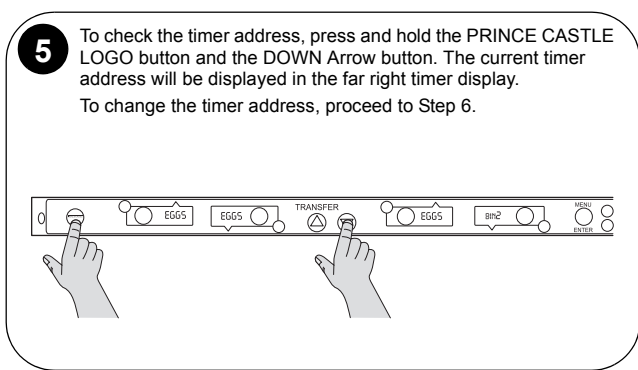
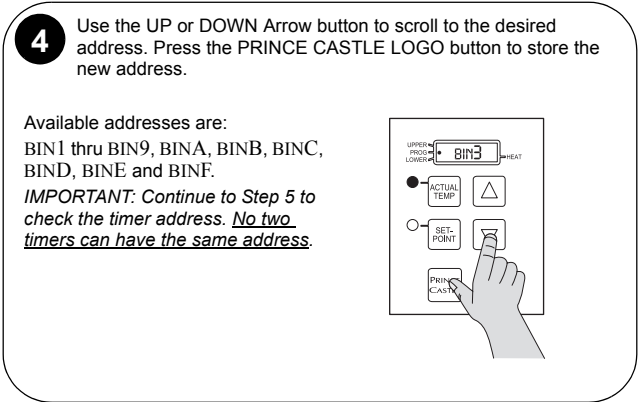
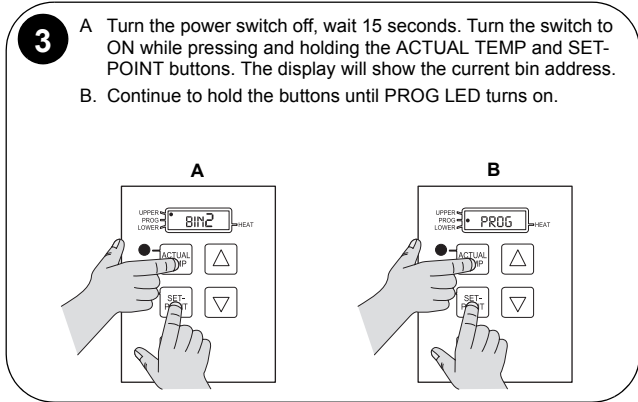
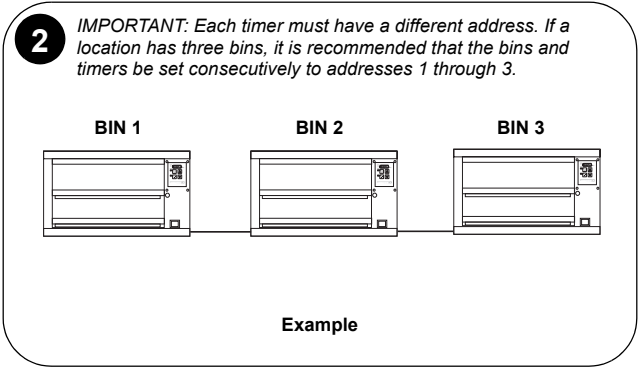
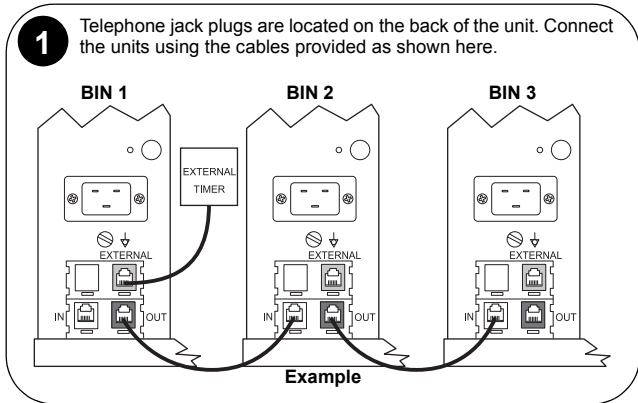

**Factory Presets**

**Product Menu Details**

| Product          | Display Name | Hold Minutes <sup>1</sup> | Cook-More Minutes <sup>1</sup> |
|------------------|--------------|---------------------------|--------------------------------|
| Burger           | BUR1         | 30                        | 3                              |
| Burger           | BUR2         | 30                        | 3                              |
| Chicken Patty    | CHX1         | 30                        | 3                              |
| Chicken Patty    | CHX2         | 30                        | 3                              |
| Chicken Patty    | CHX3         | 30                        | 3                              |
| Chicken Wing     | WING         | 30                        | 3                              |
| Fish             | FISH         | 30                        | 3                              |
| Eggs             | EGGS         | 30                        | 3                              |
| Sausage          | SAUS         | 30                        | 3                              |
| Bacon            | BACN         | 30                        | 3                              |
| Ham              | HAM          | 30                        | 3                              |
| Popper           | POP          | 30                        | 3                              |
| Mozzarella Stick | MOZ          | 30                        | 3                              |
| Onion            | ONIN         | 30                        | 3                              |
| Mushroom         | MUSH         | 30                        | 3                              |
| Chicken Nuggets  | NUGG         | 30                        | 3                              |
| Spicy Chicken    | SPCY         | 30                        | 26                             |
| French Toast     | TOST         | 10                        | 8                              |
| Chicken Stars    | STAR         | 30                        | 27                             |
| Large            | LRG          | 20                        | 17                             |
| \$6 Burger       | SIX          | 20                        | 17                             |
| BBQ Chicken      | BBQ          | 20                        | 17                             |
| Crispy Chicken   | CRSP         | 30                        | 26                             |
| Special #1       | SPC1         | 30                        | 3                              |
| Special #2       | SPC2         | 30                        | 3                              |

1. Hold and Cook-More times may be re-programmed. See page 7.

2. Product abbreviations SPC1 thru SPC9 may be reprogrammed. See page 9.

| Menu | Bkft | Down | Up   | Down | Up   | Down | Up   | Down | Menu | LED  |
|------|------|------|------|------|------|------|------|------|------|------|
|      | CRSP | ONIN | BBQ  | SPCY | SIX  | SIX  | LRG  | LRG  | MNU1 | Bkft |
|      | BUR1 | BUR1 | BUR1 | BUR1 | BUR2 | BUR2 | BUR2 | BUR2 | MNU2 | REG  |
|      | CHX1 | CHX1 | CHX2 | CHX2 | CHX3 | CHX3 | WING | FISH | MNU3 | REG  |
|      | CHX1 | CHX2 | WING | WING | MOZ  | MOZ  | POP  | POP  | MNU4 | REG  |
|      | CHX1 | CHX2 | CHX3 | WING | WING | POP  | ONIN | MUSH | MNU5 | REG  |
|      | EGGS | EGGS | EGGS | EGGS | HAM  | BACN | SAUS | SAUS | MNU6 | Bkft |

**6 Channel Menus**

| Timer | 6    | 5    | 4    | 3    | 2    | 1    |      |      |
|-------|------|------|------|------|------|------|------|------|
|       | STAR | FISH | TOST | ONIN | CRSP | SPCY | MNU1 | Bkft |
|       | BUR1 | BUR1 | BUR1 | BUR2 | BUR2 | BUR2 | MNU2 | Reg  |
|       | CHX1 | MUSH | MOZ  | POP  | WING | WING | MNU3 | Reg  |
|       | CHX1 | CHX2 | WING | MOZ  | POP  | POP  | MNU4 | Reg  |
|       | CHX1 | CHX2 | CHX3 | POP  | ONIN | MUSH | MNU5 | Reg  |
|       | EGGS | EGGS | EGGS | HAM  | BACN | SAUS | MNU6 | Bkft |

## Troubleshooting

| PROBLEM  | PROBABLE CAUSE  | SOLUTION  |
|--|---|---|
| Display flashes Opn and rEL.   | Open relay. Circuit inoperable.   | Replace power circuit board.  |
| Display flashes SHr and rEL.   | Shorted relay. Circuit inoperable.<br>Open heater.<br><br>Unplugged ribbon cable between power and main circuit boards. | Replace power circuit board.<br>Test heater resistance (150.2 Ohms).<br>Replace heater if necessary.<br>Verify ribbon cable connection.   |
| Display flashes Opn and rEL.   | Temperature is below 75°F.<br>Heater inoperable.<br>Probe inoperable.<br><br>Relay inoperable.                          | Normal display during warmup.<br>Test heater resistance (150.2 Ohms).<br>Check for open thermocouple wires from probe. Replace heater/probe assembly.<br>Replace power circuit board. |
| Display shows HHH for an extended period of time and heater surface temperature is hot.  | Temperature is above 300°F (abnormal operation).  | Diagnostic circuit inoperable. Replace power circuit board.   |
| Display shows HHH for an extended period of time and heater surface temperature is cool. | Probe is inoperable.  | Check for pinched thermocouple wires from probe. Replace heater/probe assembly.   |

**Exploded View and Parts List (DHB2PT-20B)**

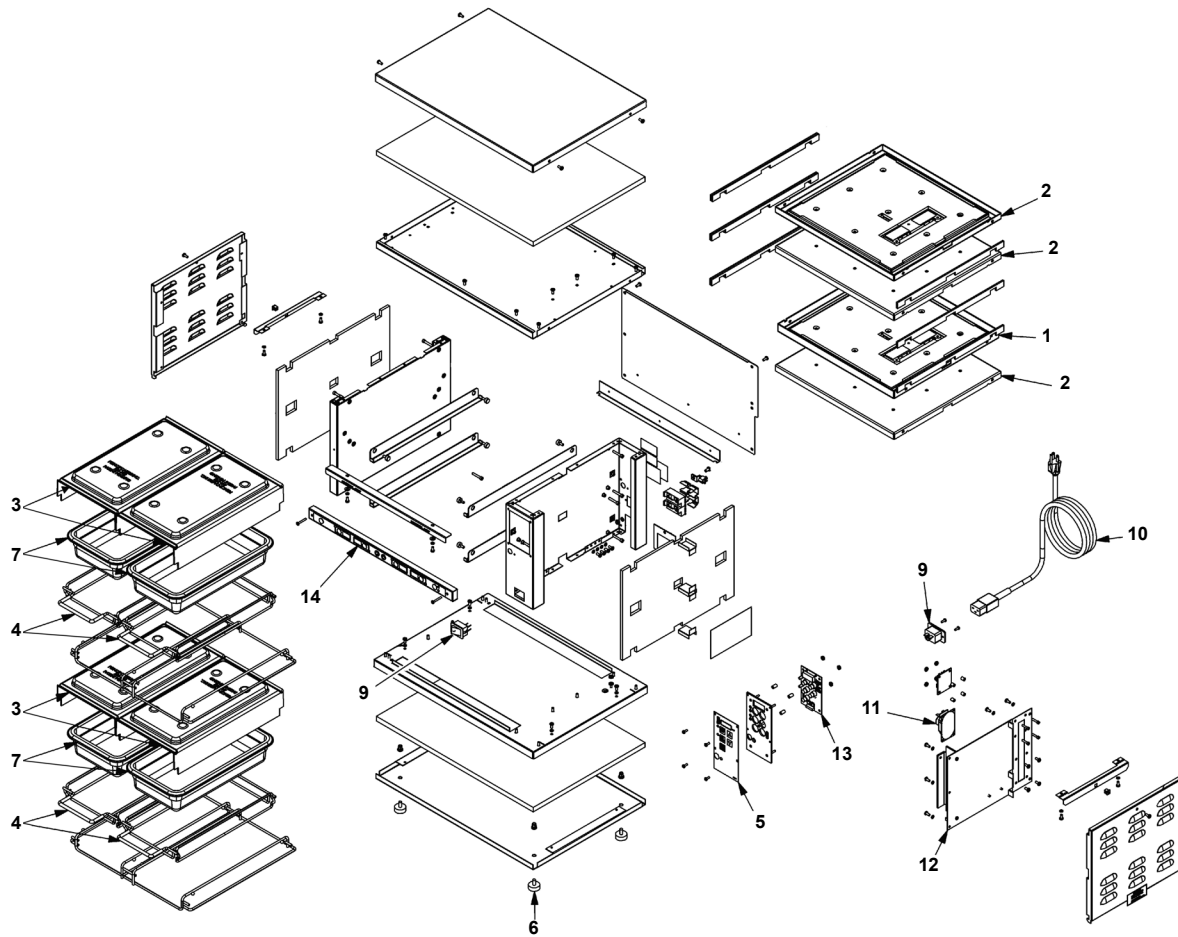

| Ref. | Part No.   | Description              |
|------|------------|--------------------------|
| 1    | 542-121S   | Upper Heater Assy        |
| 2    | 542-059S   | Lower Heater Assy        |
| 3    | 541-723E4S | Cover (Pkg of 4)         |
| 4    | 541-725S   | Rack Kit                 |
| 5    | 536-802S   | Overlay Kit              |
| 6    | 197-232S   | Mounting Foot (Pkg of 4) |
| 7    | 155695N-4  | Pan (Pkg of 4)           |
| 8    | 78-184S    | Power Switch             |
| 9    | 88-609S    | Power Connector          |

| Ref.       | Part No.     | Description             |
|------------|--------------|-------------------------|
| 10         | 72-200-15S   | Power Cord              |
| 11         | 541-959S     | PCB Audio Interface Kit |
| 12         | 541-734S     | Main PCB Kit            |
| 13         | 541-719S     | Display PCB Kit         |
| 14         | 541-999S     | Timer Bar Kit           |
| Not Shown* |              |                         |
| *          | 541-1000S    | Auxiliary Timer Bar     |
| *          | 88-709-2-11S | Speaker                 |

**Exploded View and Parts List (DHB2PT-27B/-27BCE)**

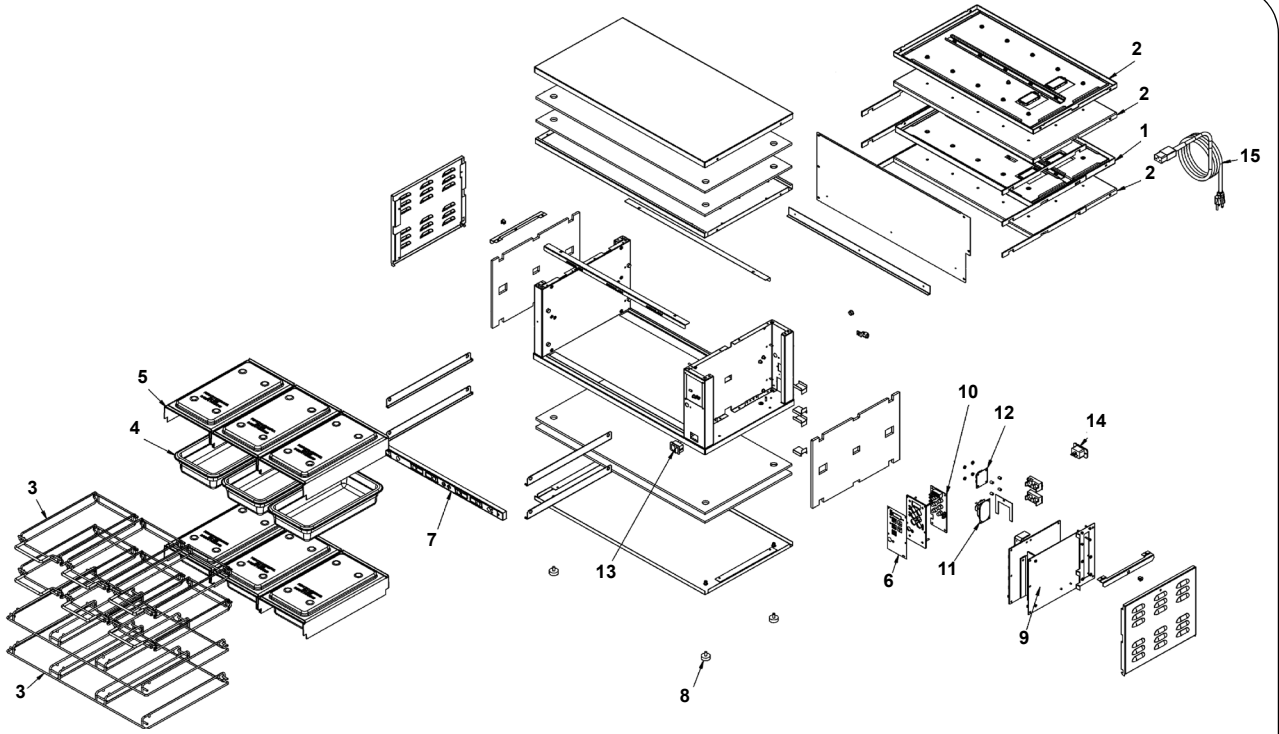

| Ref. | Part No.   | Description                          |
|------|------------|--------------------------------------|
| 1    | 541-833S   | Upper Heater Kit (DHB2PT-27B)        |
|      | 541-669S   | Upper Heat Assembly (DHB2PT-27BCE)   |
| 2    | 541-832S   | Lower Heater Kit (DHB2PT-27B)        |
|      | 541-695S   | Lower Heater Assembly (DHB2PT-27BCE) |
| 3    | 541-724S   | Rack Kit                             |
| 4    | 155695N-4  | Pan (Pkg of 4)                       |
| 5    | 541-723E4S | Cover (Pkg of 4)                     |
| 6    | 536-802S   | Display Overlay Kit                  |
| 7    | 541-997S   | Timer Bar Kit                        |
| 8    | 197-232S   | Mounting Foot (Pkg of 4)             |
| 9    | 541-734S   | Main PCB Kit                         |

| Ref.       | Part No.     | Description                          |
|------------|--------------|--------------------------------------|
| 10         | 541-719S     | Display PCB Kit                      |
| 11         | 88-709-2-11S | Speaker Kit                          |
| 12         | 541-959S     | PCB Audio Interface Kit              |
| 13         | 78-184S      | Power Switch                         |
| 14         | 88-609S      | Power Inlet Connector (DHB2PT-27B)   |
|            | 88-720-01S   | Power Inlet Connector (DHB2PT-27BCE) |
| 15         | 72-200-15S   | Power Cord (DHB2PT-27B)              |
|            | 72-230S      | Power Cord (DHB2PT-27BCE)            |
| Not Shown* |              |                                      |
| *          | 541-734S     | Control PCB (DHB2PT-27B)             |
| *          | 541-735S     | Control PCB (DHB2PT-27BCE)           |

**Exploded View and Parts List (DHB2PT-33B)**

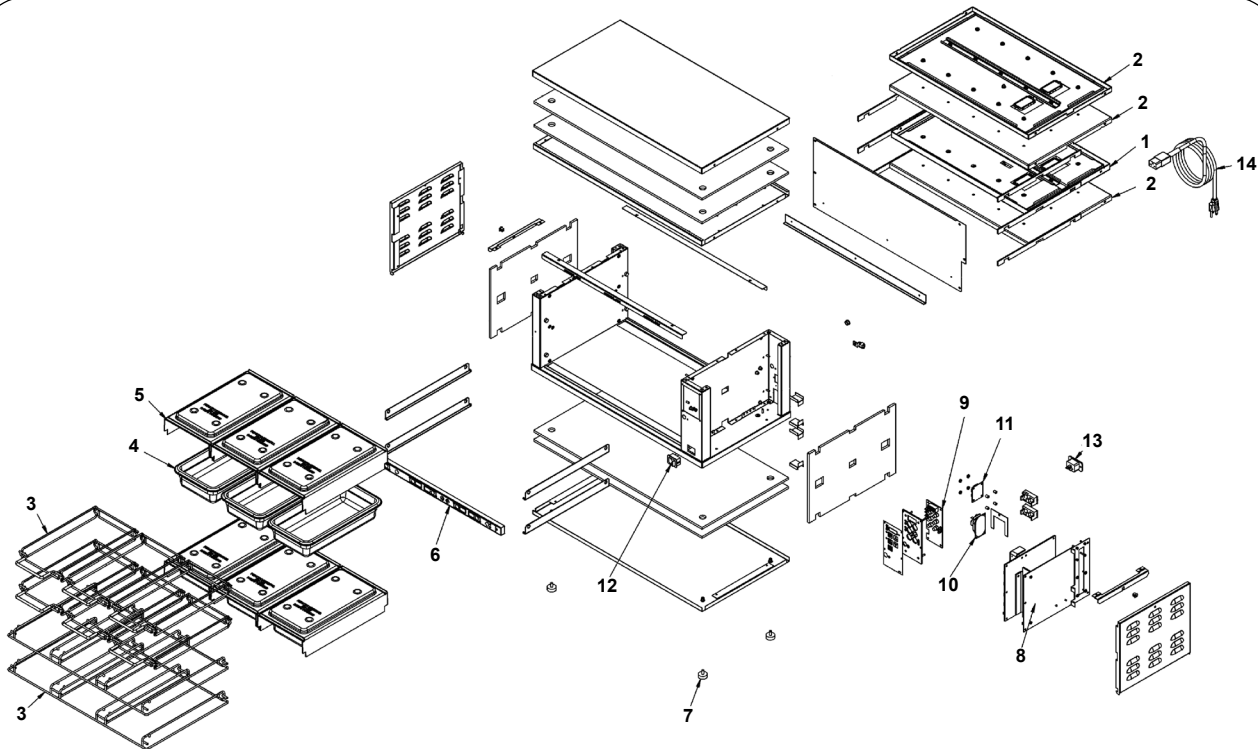

| Ref. | Part No.   | Description              | Ref. | Part No.     | Description             |
|------|------------|--------------------------|------|--------------|-------------------------|
| 1    | 541-376S   | Upper Heater Kit         | 8    | 541-735S     | Main PCB Kit            |
| 2    | 541-375S   | Lower Heater Kit         | 9    | 541-719S     | Display PCB Kit         |
| 3    | 541-636S   | Rack Kit                 | 10   | 88-709-2-11S | Speaker Kit             |
| 4    | 155695N-4  | Pan (Pkg of 4)           | 11   | 541-959S     | PCB Audio Interface Kit |
| 5    | 541-723E4S | Cover (Pkg of 4)         | 12   | 78-184S      | Power Switch            |
| 6    | 541-995S   | Timer Bar Kit            | 13   | 88-609S      | Power Inlet Connector   |
| 7    | 197-232S   | Mounting Foot (Pkg of 4) | 14   | 72-200-15S   | Power Cord              |

Note: DHB2PT-33B has 4 pans.

