

MANUFACTURING
NUMBERS:

9200800



Antunes Foodservice Equipment
DIVISION OF A.J. ANTUNES & CO.

A BRAND OF A.J. ANTUNES & CO.
roundup
ANTUNES FOODSERVICE EQUIPMENT®

DELI SANDWICH TOASTER

Model DST-200



P/N 1011001 Rev. B 03/09



Owner's Manual

TABLE OF CONTENTS

Owner Information	2	Adjusting Toasting Quality	7
General	2	Programming the DST-200.....	8
Warranty Information	2	DST-200 Default Settings.....	8
Service/Technical Assistance	2	DST-200 Unit Status Mode.....	9
Specifications	3	Purging Products from the Toaster.....	9
Electrical Ratings & Plug Configurations.....	3	Shutting Down the DST-200.....	10
Dimensions.....	3	Maintenance	11
Important Safety Information	4	DAILY: Cleaning the Accessories and Horizontal	
Operation	5	Conveyor Belts	11
Operating Instructions	5	Troubleshooting	12
Changing Modes	6	Notes	14
Toasting Product.....	6	Limited Warranty	Back Cover

OWNER INFORMATION

General

The DST-200 Deli Sandwich Toaster uses infrared heat to evenly and quickly toast a variety of bread products.

This manual provides the safety, installation, and operating procedures for the Deli Sandwich Toaster. We recommend that all information contained in this manual be read prior to installing and operating the unit.

Your Deli Sandwich Toaster is manufactured from the finest materials available and assembled to Roundup's strict quality standards. This unit has been tested at the factory to ensure dependable trouble-free operation.

Warranty Information

Please read the full text of the Limited Warranty in this manual.

If the unit arrives damaged, contact the carrier immediately and file a damage claim with them. Save all packing materials when filing a claim. Freight damage claims are the responsibility of the purchaser and are NOT covered under warranty.

Service/Technical Assistance

If you experience any problems with the installation or operation of your unit, contact your local Roundup Authorized Service Agency. They can be found in the service agency directory packaged with the equipment.

You may also contact the factory at **1-877-392-7854 (toll free in the U.S. and Canada)** or **1-630-784-1000** if you have trouble locating your nearest Authorized Service Agency.

Fill in the information below and have it handy when calling your Authorized Service Agency for assistance. The serial number is on the specification plate located on the rear of the unit.

Purchased From: _____

Date of Purchase: _____

Model No.: _____

Serial No.: _____

Mfg. No.: _____

Refer to the service agency directory and fill in the information below:

Authorized Service Agency

Name: _____

Phone No.: _____

Address: _____

Use only genuine Roundup replacement parts in this unit. Use of replacement parts other than those supplied by the manufacturer will void the warranty. Your Authorized Service Agency has been factory trained and has a complete supply of parts for this unit.

IMPORTANT! Keep these instructions for future reference. If the unit changes ownership, be sure this manual accompanies the equipment.

SPECIFICATIONS

Electrical Ratings & Plug Configurations

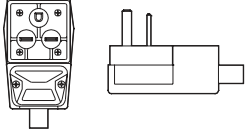
Model & Mfg. No.	Voltage	Watts	Amps	Hertz	Plug Description	Plug Configuration	Shipping & Operating Weight
DST-200 9200800	208 1 phase	5000	24.0	60	NEMA 6-30P Straight Blade (P/N 0700748)		95 lbs. (43 kg) Operating 105 lbs. (48 kg) Shipping

⚠ CAUTION ⚠

All electrical connections must be in accordance with local electrical codes and any other applicable codes.

Dimensions

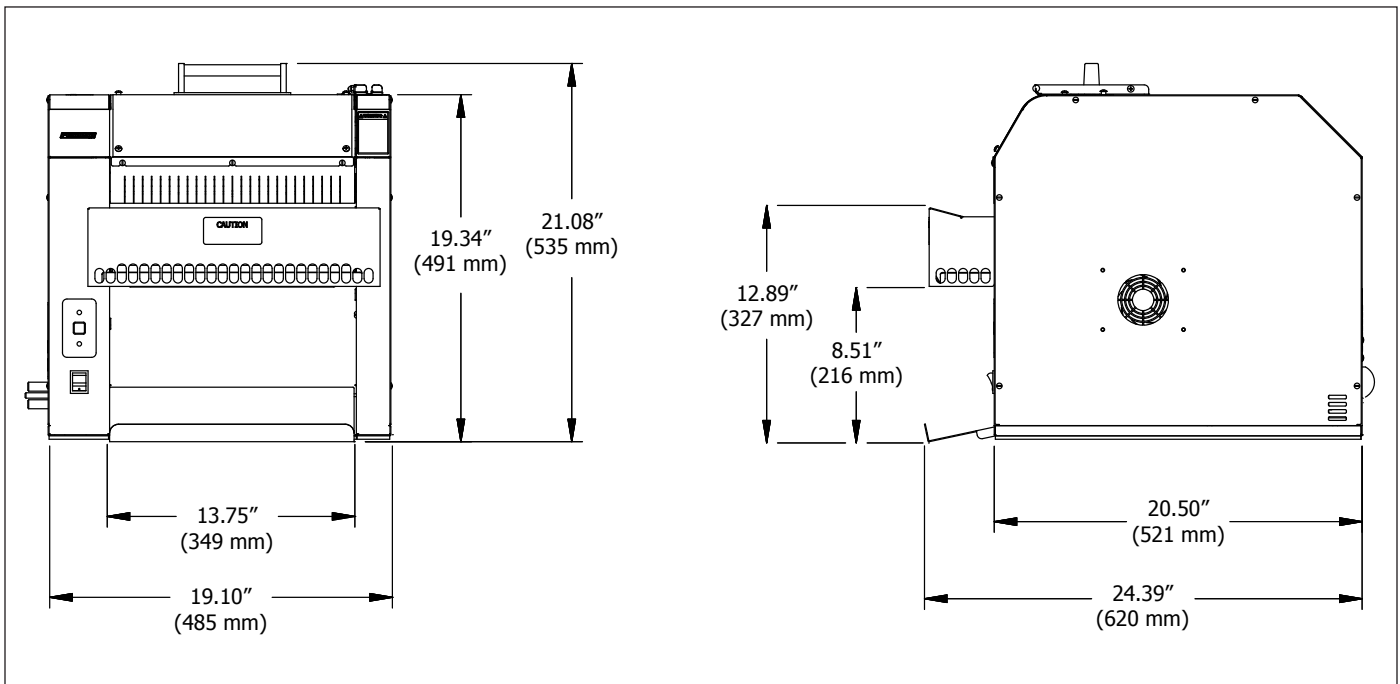

IMPORTANT SAFETY INFORMATION

Throughout this manual, you will find the following safety words and symbols that signify important safety issues with regards to operating or maintaining the equipment.

WARNING

GENERAL WARNING. Indicates information important to the proper operation of the equipment. Failure to observe may result in damage to the equipment, severe bodily injury or even death.

WARNING

ELECTRICAL WARNING. Indicates information relating to possible shock hazard. Failure to observe may result in damage to the equipment and/or severe bodily injury or death.

CAUTION

GENERAL CAUTION. Indicates information important to the proper operation of the equipment. Failure to observe may result in damage to the equipment.

WARNING

HOT SURFACE WARNING. Indicates information important to the handling of equipment and parts. Failure to observe caution could result in personal injury.

In addition to the warnings and cautions in this manual, use the following guidelines for safe operation of the unit.

- Read all instructions before using equipment.
- For your safety, the equipment is furnished with a properly grounded cord connector. Do NOT attempt to defeat the grounded connector.
- Install or locate the equipment only for its intended use as described in this manual. Do NOT use corrosive chemicals in this equipment.
- Do NOT operate this equipment if it has a damaged cord or plug, if it is not working properly, or if it has been damaged or dropped.
- This equipment should be serviced by qualified personnel only. Contact the nearest Authorized Service Agency for adjustment or repair.
- Do NOT block or cover any openings on the unit.
- Do NOT immerse cord or plug in water.
- Keep cord away from heated surfaces.
- Do NOT allow cord to hang over edge of table or counter.
- Do NOT operate unit on a combustible counter top.
- Do NOT clean this appliance with a water jet.

The following warnings and cautions appear throughout this manual and should be carefully observed.

- Turn the power off, wait for the cool-down procedure to complete its cycle (45 minutes), and unplug the power cord before performing any service or maintenance on the unit.

NOTE: Turning off the Power Switch does NOT turn off all power to the unit. When the unit is plugged in and turned off, a LED light will flash to indicate that the power cord is plugged in.

- The procedures in this chapter may include the use of chemical products. These chemical products will be highlighted with bold face letters followed by the abbreviated **HCS** (Hazard Communication Standard). See Hazard Communication Standard manual for the appropriate Material Safety Data Sheets (MSDS).
- The equipment should be grounded according to local electrical codes to prevent the possibility of electrical shock. It requires a grounded receptacle with separate electrical lines, protected by fuses or circuit breaker of the proper rating.
- Bread may burn. Therefore toasters must not be used near or below curtains or other combustible walls and materials. Failure to maintain safe operating distances may cause discoloration or combustion.



This equipotentiality symbol shows external functional grounding connection.

WARNING

To avoid possible personal injury and/or damage to the unit, all inspections, tests, and repair of electrical equipment should be performed by QUALIFIED SERVICE PERSONNEL. The unit MUST be shut down and UNPLUGGED before any internal servicing, except when electrical tests are required. Use extreme care during electrical circuit tests. Live circuits will be exposed.

OPERATION

Operating Instructions

NOTE: To ensure proper operation, toast some test product at the start of each day or whenever the unit mode is changed.

NOTE: The DST-200 has two operational modes: Deli 1 and Deli 2. The unit always starts up in Deli 1 Mode.

1

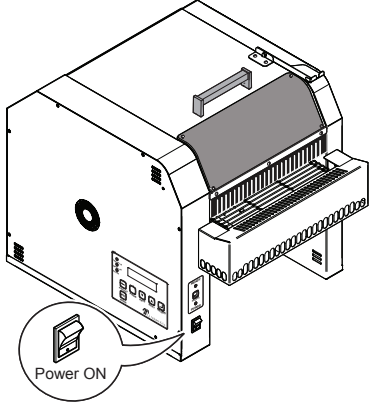

Turn the Power Switch on.
The unit clicks three times. This is normal.

2

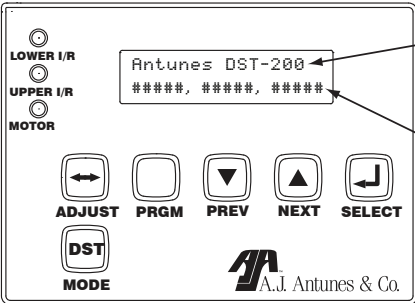

The unit displays this message for approximately 2 seconds.
The bottom line refers to the current software version.

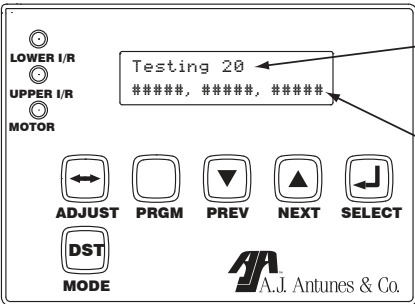

The unit performs a 20-second system check.
The bottom line refers to the current software version.

The unit's start-up mode includes a 20-second system check.

3

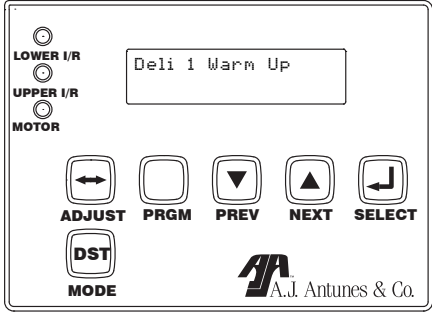

After the system check, the unit displays "Deli 1 Warm Up". This stage lasts approximately 20 minutes.

4

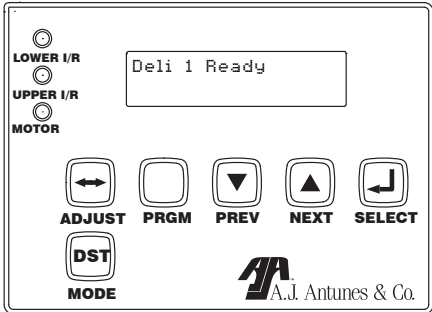

The unit displays "Deli 1 Ready" when it reaches proper operating temperature for toasting.

NOTE: If any parts are missing or damaged, contact Technical Service IMMEDIATELY at 1-877-392-7854 (North America only), or 630-784-1000.

CAUTION

1. Provide at least 1 inch (25.4 mm) clearance on both sides of this unit from any combustible wall or surface.
2. Do NOT operate unit on a combustible surface or counter top.

WARNING

Use caution while the unit is operating. The unit and accessories will be hot to the touch. Use Heat Resistant Gloves when removing any accessories while the unit is operating. Personal injury may result.

OPERATION (continued)

Changing Modes

Follow these steps to change between **Deli 1** mode and **Deli 2** mode.

NOTE: Do NOT toast any products until the unit displays “Deli 1 Ready” or “Deli 2 Ready”.

1

Press the **DST MODE** button on the Control Panel once to switch between the **Deli 1** and **Deli 2** modes.

2

The unit switches modes. The unit displays “Deli 1 Ready” or “Deli 2 Ready”.

Toasting Product

The DST-200 can toast a variety of bread products. However, when toasting ciabatta breads, french breads, or other long thin breads, refer to items 1 and 2 below.

NOTE: Do NOT insert long, thin breads directly into the toaster. Insert these types of breads sideways.

NOTE: Always toast some test product at the start of each day or whenever the unit mode is changed to ensure proper toasting operation.

1

INCORRECT

Do **NOT** insert long, thin bread products into the toaster as shown above.

⚠ IMPORTANT ⚠

Do **NOT** overload the toaster. Bread can burn and too much product may cause the toaster to become jammed.

OPERATION (continued)

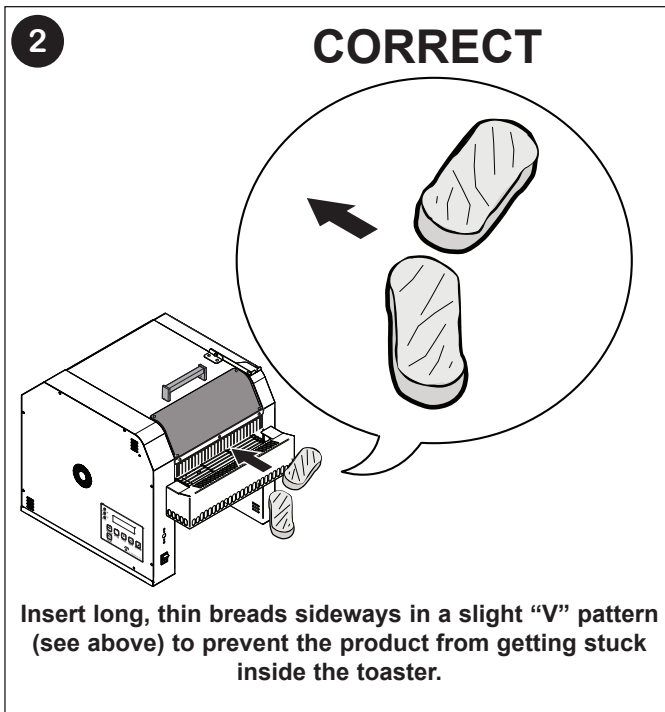

Adjusting Toasting Quality

The toasting quality of the DST-200 can be adjusted to provide a lighter or more darkly toasted product. Follow these steps to adjust toasting quality:

1. Press and release the **ADJUST** button on the Control Panel (Figure 1).

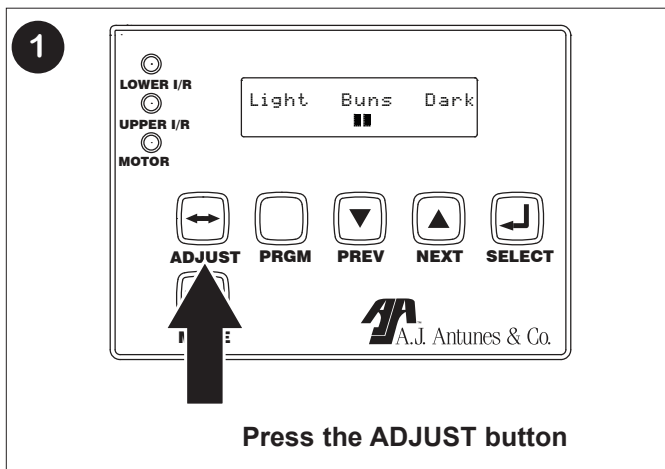

2. Use the **PREV** and **NEXT** buttons to adjust the toasting quality to lighter or darker respectively (Figure 2).

NOTE: Pressing the **PREV** button decreases toasting darkness. Pressing the **NEXT** button increases toasting darkness. There are ten adjustment increments in each direction. When two bars are lit, the adjustment is in the center. When one bar is lit, the adjustment is either set to dark or light.

3. Toast some test product to verify that the unit produces the desired toast quality.
4. If the toasting quality needs further adjustment, repeat Steps 2 and 3 as necessary.
5. Press the **PRGM** button when the adjustment is complete to return to the Ready Screen.

NOTE: This setting is maintained when the unit is powered off.

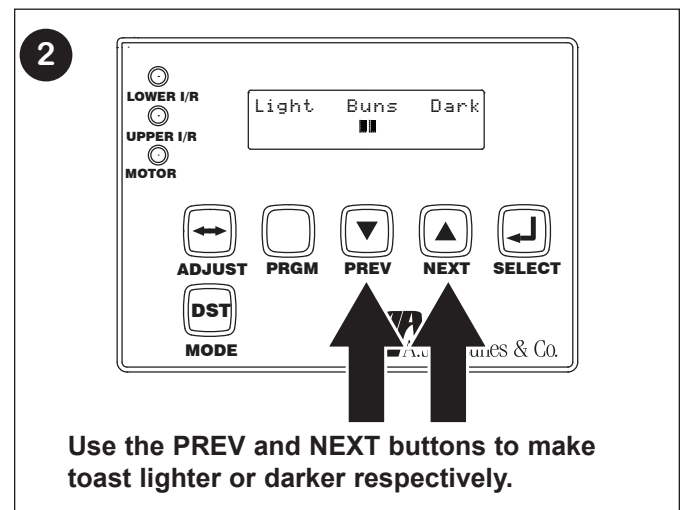

OPERATION (continued)

Programming the DST-200

NOTE: Reprogramming the DST-200 is NOT recommended. The factory default settings should produce acceptable toast quality.

The DST-200 uses three variables for toasting:

- Speed
- Lower IR%
- Upper IR%

Speed refers to how fast the Conveyor Belts move during operation.

Lower IR% represents how much power the lower infrared heating elements receive.

Upper IR% represents how much power the upper infrared heating elements receive.

Follow these steps to view and change the DST-200 program settings.

1. From the desired operation mode (Deli 1 or Deli 2), press and hold the **PRGM** button for 3 seconds.

NOTE: To program a specific mode, the unit must first be in that mode.

2. The following appears on the display:

```
Program Deli 1 (Or Deli 2)
Press Select
```

3. Press the **SELECT** button and use the **NEXT** or **PREV** button to scroll through the following categories:
 - Speed
 - Upper IR%
 - Lower IR%
 - Units (F/C)
4. When you reach the desired category, press the **SELECT** button once. This causes the value to blink, indicating the value is in Edit mode.
5. Use the **PREV** and **NEXT** buttons to change the value while it is blinking to change the setting.
6. When you are finished viewing settings, press the **PRGM** button to save the changes (Deli 1 or Deli 2).

NOTE: The unit will exit the Program mode after 10 seconds of inactivity and all changes will be lost.

DST-200 Default Settings

The table below shows the default settings for the DST-200 Toaster. Note that Deli 1 and Deli 2 are shipped with the same pre-programmed values.

Setting	Deli 1	Deli 2
Lower IR %	94	94
Upper IR %	94	94
Speed	3200	3200

OPERATION (continued)

DST-200 Unit Status Mode

This mode provides feedback on how the unit's systems are performing. No adjustments can be made in this mode. Also, the display will remain on the selected screen in this mode until you switch screens or exit Unit Status mode.

Follow these steps to view the Unit Status mode.

1. From the Deli 1 or Deli 2 mode, press and hold the **ADJUST** button for 3 seconds.
2. The following appears on the display in sequence (use the **NEXT** and **PREV** buttons to scroll through these items):
 - Upper IR
(The set point current value appears on the top line. The actual current value appears on the lower line.)
 - Lower IR
(The set point current value appears on the top line. The actual current value appears on the lower line.)
 - Speed Motor SetPt
 - Fan Speed % of Normal
L: (Left Fan), R: (Right Fan)
 - Controls Temp ###F
 - Run Time ##:## (in hours and minutes)
3. Press the **PRGM** button once. This exits the Unit Status mode and returns to the current operation mode screen.

Purging Products from the Toaster

NOTE: The unit must be in a Ready or Wait mode in order to purge products.

There are two ways to purge products from the unit:

1. FACING THE CONTROL PANEL

With the unit in Deli 1 or Deli 2 mode, press and hold the **NEXT** button until the product is purged from the unit (Figure 1).

The unit displays "Purging" and temporarily speeds up the conveyor, forcing the product out of the toaster.

Once the product is purged, release the **NEXT** button and the unit returns to normal operating speed.

2. FACING THE FRONT OF UNIT

With the unit in Deli 1 or Deli 2 mode, press and hold the **PURGE** button to purge product from the unit (Figure 1)

Once the product is purged, release the **PURGE** button. The unit will return to normal operating speed.

These procedures temporarily speed up the unit to purge products out to the front of the toaster.

NOTE: Product is always purged out of the front of the toaster using the **NEXT** button or the **PURGE** button. It is **NOT** possible to purge product backwards through the unit.

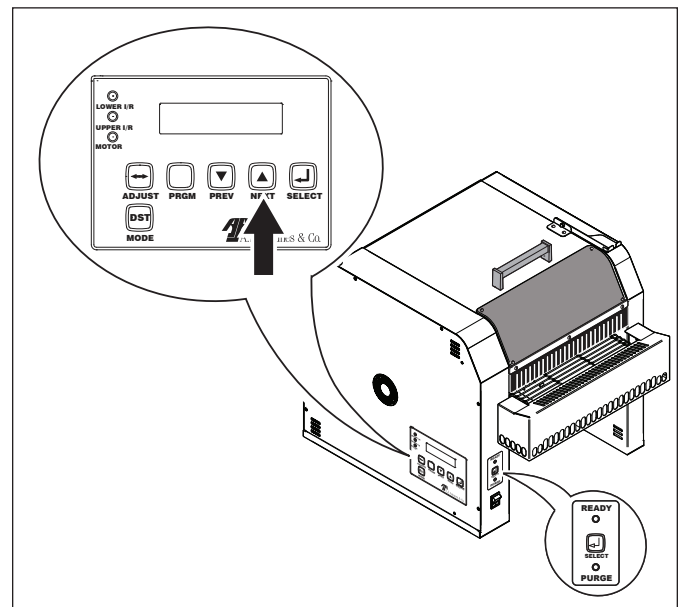

Figure 1. Purging Product from the Toaster

OPERATION (continued)

Shutting Down the DST-200

Follow these steps to shut down the toaster:

1. Turn the Power Switch off (Figure 2). The LED on the switch turns off.
2. The unit enters Cool Down mode and displays "Cool Down Mode". The fans continue to run. This Cool Down mode continues for 45 minutes and shuts the unit down automatically when complete.

⚠ WARNING ⚠

To avoid possible personal injury and/or damage to the unit, all inspections, tests, and repair of electrical equipment should be performed by **QUALIFIED SERVICE PERSONNEL**. The unit **MUST** be **shut down and UNPLUGGED** before performing any internal service, except when electrical tests are required. Use extreme care during electrical circuit tests. Live circuits will be exposed.

⚠ IMPORTANT ⚠

Do NOT unplug the power cord when the unit is in Cool Down mode. Wait for 45 minutes to allow the Cool Down mode to complete before unplugging the power cord.

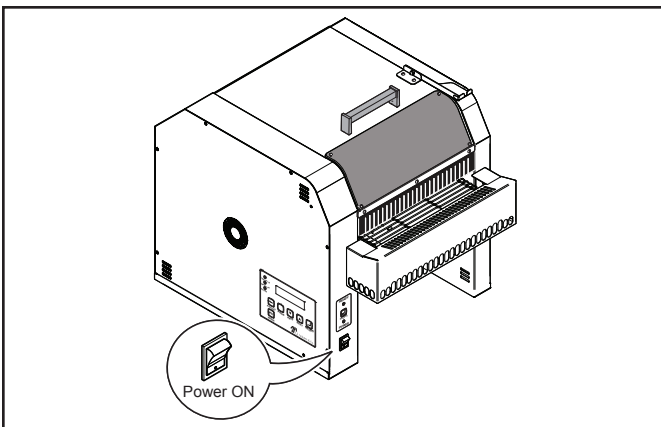

Figure 2. Power Switch Location

MAINTENANCE

⚠ WARNING ⚠

The unit will remain hot to the touch while it is cooling down. Personal injury and burns may result from touching the unit before it is finished cooling down. Wear Heat Resistant Gloves!

DAILY: Cleaning the Accessories and Horizontal Conveyor Belts

NOTE: Do NOT wash accessories in the Power Soak machine.

CLEANING THE ACCESSORIES AND TOASTER

1. Turn the Power Switch off. The LED on the switch turns off.
2. The unit enters Cool Down mode and displays "Cool Down Mode". The fans continue to run. This Cool Down mode continues for 45 minutes and shuts the unit down automatically when complete.

NOTE: You do NOT need to wait for the count down to complete. Continue with the cleaning steps as soon as you see "Cool Down Mode".

3. Wearing Heat Resistant Gloves, remove the following items from the unit (Figure 3):
 - Front Nose Piece
 - Crumb Tray
 - Bun Chute

⚠ WARNING ⚠

Do NOT wash any of the accessories in a Power Soak machine or any other mechanical washer. Damage to the accessories may result. Wash all accessories by hand in the sink.

4. Wash the Nose Piece, Crumb Tray, and Bun Chute in a three-compartment sink.
5. Open the Top Cover and use the Prop Shelf (Figure 3) to secure the Top Cover in the open position.

NOTE: Be sure the Prop Shelf is placed properly in the holding screw.

6. Press the **PURGE** button to start the conveyors.
7. While the conveyors are moving, remove all baked on pieces of food by wiping each conveyor with a non-abrasive pad in a side-to-side motion.

8. Press the **PURGE** button to stop the conveyors.
9. Use a damp cloth and general purpose cleaner to clean the exposed section of the top and bottom conveyor. Be sure to use a side-to-side motion.
10. Press the **PURGE** button to start the conveyors. When a new section is exposed, press the **PURGE** button again to stop the conveyors.

NOTE: To keep track of which sections have been cleaned, place the damp cloth on the conveyor before pressing the **PURGE** button to start the conveyors.

11. Repeat Steps 9 and 10 as needed until both conveyors have been cleaned.
12. Wipe down the outside of the toaster with a damp towel.
13. Reattach the accessories, close the Top Cover, and place the toaster back into operation.

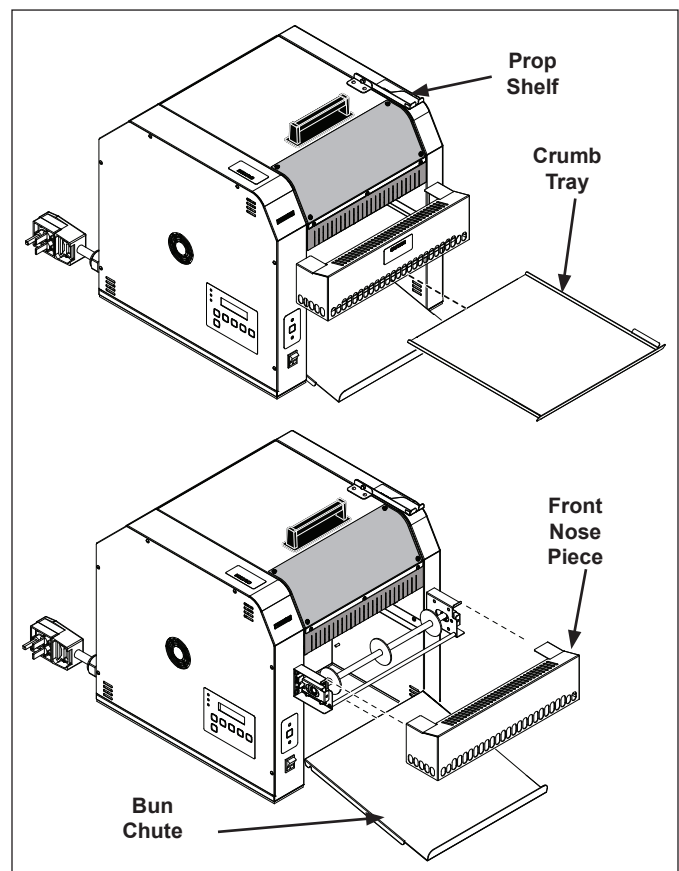

Figure 3. Toaster Components

TROUBLESHOOTING

⚠ CAUTION ⚠

To avoid possible personal injury and/or damage to the unit, all inspections, tests, and repair of electrical equipment should be performed by **QUALIFIED SERVICE PERSONNEL**. The unit **MUST** be shut down and UNPLUGGED before servicing, except when electrical tests are required. Use extreme care during electrical circuit tests. Live circuits will be exposed.

Problem	Possible Cause	Corrective Action
No Display and/or no light on the Power Switch.	Unit not plugged in.	Plug the power cord into the appropriate outlet.
	Hi-Limit thermostat is tripped.	Reset Hi-Limit on rear of the unit.
	Circuit Breaker tripped	Reset Circuit Breaker.
	Power Cord and/or plug are damaged.	Contact your maintenance person or Authorized Service Agency.
	Inoperable Power Switch.	
Unit displays one of the following messages: Upper IR Heater Fault or Lower IR Heater Fault	Failed heater.	Allow about 10 minutes for the toaster to self adjust.
	Wire disconnected in IR circuit.	
	Control wires to the Solid State Relay are disconnected.	Adjust the toast quality setting. Refer to the Operation section of this manual.
	The Solid State Relay has failed.	
Unit displays the following message: Conveyor Motor Fault	Retainer Ring not locked on plug.	Plug power cord in tightly and lock the Retainer Ring.
	Product is getting stuck in the conveyor system or the conveyor system is jammed.	Check and clear the vertical and horizontal conveyors for any stuck product. Refer to the Operation and Maintenance sections of this manual for proper compression settings and cleaning procedures.
Unit displays the following message: SSR Failure - System Stopped	The motor controller circuit has failed or is inoperable.	Call your Authorized Service Agency for service.
	A relay has failed preventing proper heater control.	The toaster cannot be operated with this kind of failure. Contact your Authorized Service Agency for service.

TROUBLESHOOTING

Problem	Possible Cause	Corrective Action
Cooling fan speed error. Unit displays one or more of the following messages: Left Fan Fault Right Fan Fault Control Temp Fault	Cooling fan failure.	The toaster will operate normally until the compartment ambient temperature exceeds 150°F (66°C). At this point the toaster will shut down. Contact your Authorized Service Agency for service.
Product sticking in horizontal conveyor or product not toasted properly	Product inserted incorrectly into horizontal conveyor.	Refer to the Operation section in this manual for proper operation procedures. Also refer to the product labels on the unit.
Unit displays the following message: WARNING! Power Fault Unplug now!!!	Contactors and control relay failures. Unit has detected IR current or rising Platen temperature with the power off.	Immediately unplug the power cord and call your Authorized Service Agency for service. The unit must not be operated with this kind of failure.

LIMITED WARRANTY

Equipment manufactured by Roundup Food Equipment Division of A.J. Antunes & Co. has been constructed of the finest materials available and manufactured to high quality standards. These units are warranted to be free from mechanical and electrical defects for a period of one year from date of purchase or 18 months from shipment from factory, whichever occurs first, under normal use and service, and when installed in accordance with manufacturer's recommendations.

To insure continued proper operation of the units, follow the maintenance procedure outlined in the Owner's Manual.

1. This warranty does not cover cost of installation, defects caused by improper storage or handling prior to placing of the Equipment. This warranty does not include overtime charges or work done by unauthorized service agencies or personnel. This warranty does not cover normal maintenance, calibration, or regular adjustments as specified in operating and maintenance instructions of this manual, and/or labor involved in moving adjacent objects to gain access to the Equipment. This warranty does not cover consumable items such as platen release sheet and conveyor belt wraps. This warranty does not pay travel, mileage, or any other charges for an authorized service agency to reach the equipment location.
2. Roundup reserves the right to make changes in design or add any improvements on any product. The right is always reserved to modify equipment because of factors beyond our control and government regulations. Changes to update equipment do not constitute a warranty charge.
3. If shipment is damaged in transit, the purchaser should make a claim directly upon the carrier. Careful inspection should be made of the shipment as soon as it arrives and visible damage should be noted upon the carrier's receipt. Damage should be reported to the carrier. This damage is not covered under this warranty.
4. Warranty charges do not include freight or foreign, excise, municipal or other sales or use taxes. All such freight and taxes are the responsibility of the purchaser.
5. THIS WARRANTY IS EXCLUSIVE AND IS IN LIEU OF ALL OTHER WARRANTIES, EXPRESSED OR IMPLIED, INCLUDING ANY IMPLIED WARRANTY OR MERCHANTABILITY OR FITNESS FOR A PARTICULAR PURPOSE, EACH OF WHICH IS HEREBY EXPRESSLY DISCLAIMED. THE REMEDIES DESCRIBED ABOVE ARE EXCLUSIVE AND IN NO EVENT SHALL ROUNDUP BE LIABLE FOR SPECIAL CONSEQUENTIAL OR INCIDENTAL DAMAGES FOR THE BREACH OR DELAY IN PERFORMANCE OF THIS WARRANTY.



A.J. Antunes & Co.

A.J. Antunes & Co.
Headquarters/Manufacturing
180 Kehoe Boulevard
Carol Stream, Illinois 60188 USA
Phone (630) 784-1000
Toll Free (800) 253-2991
Fax: (630) 784-1650

Antunes Equipment
Manufacturing (Suzhou) Ltd.,
9 Hou Ju Road, Building #24,
S&T Park, SND
Suzhou, Jiangsu, China 215011
Phone: 86-512-6841-3637
Fax: 86-512-6841-3907

www.ajantunes.com