

THIS OWNER'S MANUAL
IS FOR THE FOLLOWING
MANUFACTURING
NUMBERS:

9200200
9200202
9200206
9200208
9200212
9200214
9200216
9200218
9200220
9200222
9200224
9200226
9200228
9200230
9200232
9200234
9200236
9200246
9200248
9080300
9080302
9080303
9080305
9080306
9080307
9080310
9080311
9080312
9080315
9080316
9080317
9080400
9080402
9080408
9080410
9080416
9080420
9080422
9080424
9080426
9080428

P/N 1010588 Rev. G 10/96

Roundup

FOOD EQUIPMENT DIVISION

OWNER'S MANUAL



VERTICAL CONTACT TOASTER

Models VCT-10 & VCT-30
Series 92002XX, 90803XX & 90804XX



A.J. Antunes & Co.

ISO 9001 CERTIFIED

180 Kehoe Blvd. • Carol Stream, Illinois 60188
Telephone (630) 784-1000 • FAX (630) 784-1650
Toll Free 1-877-392-7854 (in the U.S.A. and Canada)
www.ajantunes.com

PLEASE READ THIS MANUAL CAREFULLY
AND KEEP IT FOR FUTURE REFERENCE!

IMPORTANT INFORMATION

Congratulations on your purchase of this Roundup product. This unit is manufactured from the finest materials available, and is assembled to Roundup's strict quality standards.

This unit has been tested at the factory to ensure dependable trouble-free operation.

This manual is provided to help you become familiar with the unit and contains all the information necessary to properly install, operate and maintain this unit. Following the instructions in this manual will result in many years of reliable service.

Problems? Questions?
Please Call the Factory at
1-800-253-2991

WARRANTY INFORMATION

NOTE: The statements below are only representative of the Limited Warranty.

Please read the full text of the Limited Warranty on the back page.

This unit is warranted to be free of mechanical and electrical defects for a period of one year. This unit is designed to operate on single-phase circuits.

This warranty does not include overtime charges of work done by unauthorized service agencies or personnel. Because of the unit's compact size and portability, travel time and mileage charges are not included in warranty repair payment.

The warranty on the unit does NOT extend to:

1. Damages caused in shipment or damage as a result of improper use.

NOTE: IF UNIT ARRIVES DAMAGED, contact the carrier immediately and file a damage claim with them. Save all packing materials when filing a claim.

2. Installation of electrical service.
3. Installation of Plumbing or Water Supply, or water pressure regulator (if applicable).
4. Normal maintenance as outlined in this manu-

5. Malfunction resulting from improper maintenance.
6. Damage caused by abuse or careless handling.
7. Damage from tampering with, removal of, or changing any preset control or safety device.
8. Damage from moisture into electrical components (if applicable).

WARRANTY REGISTRATION

Fill in the information in the blanks below now to ensure speedy response should your unit ever require service.

Date of Purchase _____

Purchased from _____

Phone No. _____

P.O. No. _____

Invoice No. _____

Serial No.** _____

Authorized Service Agency***

Address _____

Phone No. _____

** Serial Number can be found on the specification plate on the rear of the unit.

*** Locate the nearest Authorized Service Agency in the directory enclosed with the unit.

SERVICE PARTS

Use only genuine Roundup replacement parts in this unit. Use of replacement parts other than those supplied by the manufacturer will void the warranty.

Your Authorized Service Agency has a parts price list and will be glad to inform you of the cost of your parts order.

PARTS IDENTIFICATION

To find items you want to order from the parts list, proceed as follows:

- Look at the exploded view parts drawing to locate the part that is needed.
- Use the item number from the parts drawing to locate the correct parts in the parts list. This section will have the Roundup part number and a description of the part.



CAUTION

Follow instructions below before operating this unit.



CAUTION
Failure to use grill cover may result in loss of warranty coverage.

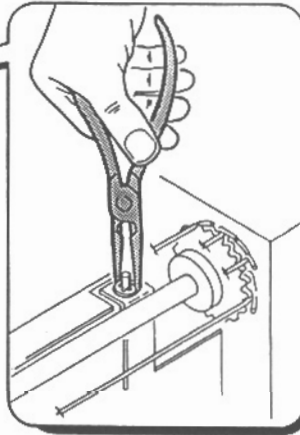
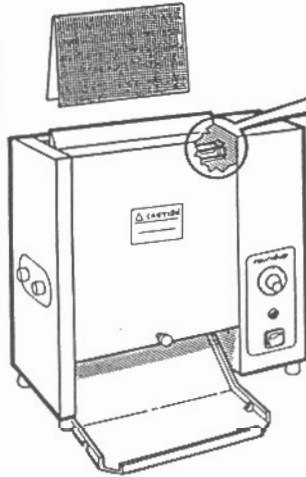

CAUTION
You must remove the push-on fasteners before operating this unit.
(Push-on fasteners are used for shipping purposes only) -

INSTALL GRILL COVER

See Page 14 for Instructions

NOTE: Additional grill covers can be ordered through your authorized service agency.
P/N 040K104 (3 per pack)
P/N 040P104 (10 per pack)

REMOVE PUSH-ON FASTENERS FROM THE TENSIONERS ON MODEL VCT-10/30

- This procedure removes the Push-On Fasteners from the Tensioners on your VCT-10/30. The Push-On Fasteners are needed for shipping only and are not required for operation.
- This Toaster has four (4) Tensioner Assemblies, two (2) on each side. Each Tensioner Assembly has two (2) Push-On Fasteners, one at the top and one at the bottom. This is a total of eight (8) Push-On Fasteners. We recommend removing **ALL** the Push-On Fasteners during this procedure.



CAUTION

Toaster must be allowed to cool before performing this procedure.



WARNING

Disconnect the unit from main power before any servicing is done.

1. Remove both Face Panels.
2. Locate Push-On Fastener at the top of Tensioner Assembly (See illustration).
3. Squeeze sides of Push-On Fastener as shown in illustration. Pull Push-On Fastener off the Tensioner Arm, and discard push-On Fastener.

NOTE: Push-On Fasteners are used to secure Tensioner Arms during shipping and should not be used for operation of this unit.

4. Locate and remove the remaining Push-On Fasteners.
5. Reattach the Face Panels.
6. Test operation of Toaster before returning to service.

INSTALLATION

The toaster is shipped completely wired and ready to connect to a grounded power supply.

To set up the toaster for operation:

1. Install Grill Cover (Item 36, instructions on page 15).
2. Install optional equipment (Bun Chute and/or Bun Feeder), if used.

NOTE: Bun Chute is not used on VCT-10BK.

NOTE: Place Bun Chute under grill so that the notches on the Bun Chute fit over the acorn nuts (Item K) on each side. (Bun Chute can be installed on front or back of unit).

3. Measure the buns being used and move the bun adjustment knob (on left side, Item 30) to match the bun thickness.



WARNING ELECTRICAL SHOCK HAZARD

- Electrical ground is required on this appliance.
- Do Not modify the power supply cord plug. If it does not fit the outlet, have a proper outlet installed by a qualified electrician.
- Do Not have a fuse in the neutral or grounding circuit. A fuse in the neutral or grounding circuit could result in an electrical shock.
- Do Not use an extension cord with this appliance.
- Check with a qualified electrician if you are in doubt as to whether the appliance is properly grounded.

Failure to follow these instructions could result in serious injury or death.

4. Connect Toaster to power supply (See Specification Plate for proper voltage).
5. Unit is now ready for operation.

OPERATION

1. Connect Unit to power supply, then turn Thermostat Dial (Item 22) to desired setting. Suggested starting position is:
VCT-10 – #8 VCT-30 – #10
Turn to a **lower** number for **less** toasting.
2. Move Rocker Switch (Item 20) to “ON” position.

NOTE: Allow 20 minute warm-up time before proceeding.

3. Drop buns into Toaster. Cut sides of heel and crown must face each other.
4. Toasted heel and crown will drop down the Bun Chute (Item 24) together.

NOTE: Test at least three buns before putting Toaster into service.

MAINTENANCE

DAILY

When the toaster is cool, remove the Bun Chute and Grill Cover, clean with soap and water and allow to air dry.

NOTE: Do not use abrasives on Grill Cover.

Re-install all parts after drying.

WEEKLY

1. Move Rocker Switch (Item 20) to “OFF” position and unplug power cord.
2. Perform daily maintenance.
3. Remove conveyor belts (See “Conveyor Belt” on page 13).
4. Remove both tensioner assemblies (Item 4) by pressing down lightly on the rods until they are free from the rod brackets (Item 27). Lift both tensioners up and out of the unit.
5. Clean belts and tensioners with soap and water, and allow to air dry.
6. Clean the grill surface with a clean, damp cloth and allow to air dry.

CAUTION



Do not use abrasive pads or cleaners. Do not use chemical cleaners on the grill surface.

7. Reverse above procedures to assemble the toaster.

CAUTION



Refer to “Removal/Replacement of Conveyor Belt” on page 13. Incorrectly installed conveyor belts may cause “jamming” or other problems.

8. Toaster is ready for operation.

PARTS IDENTIFICATION

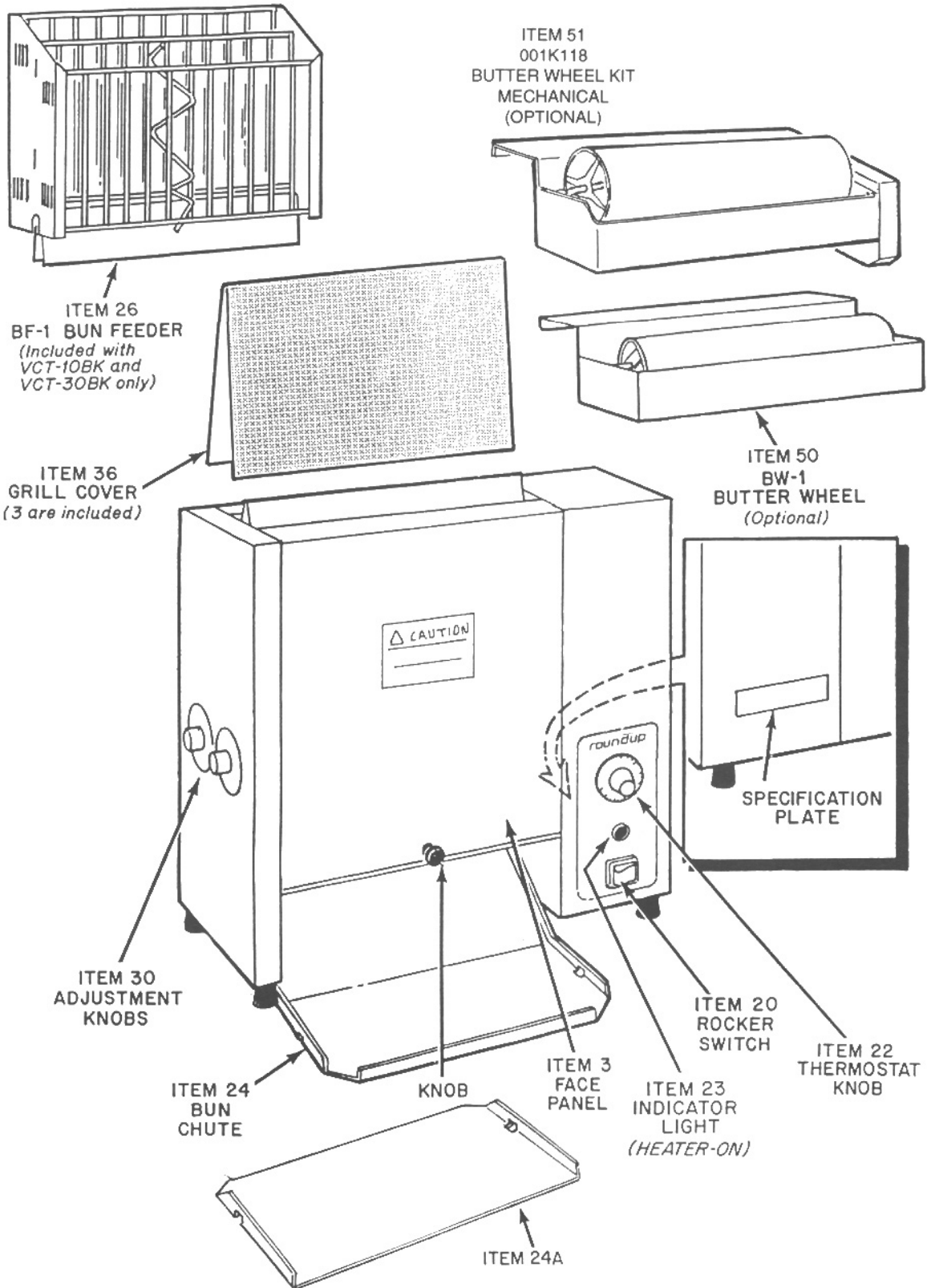

PARTS IDENTIFICATION

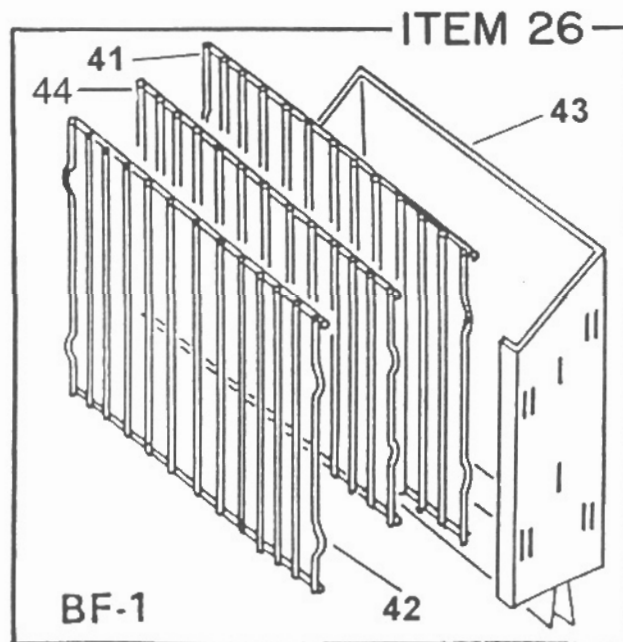
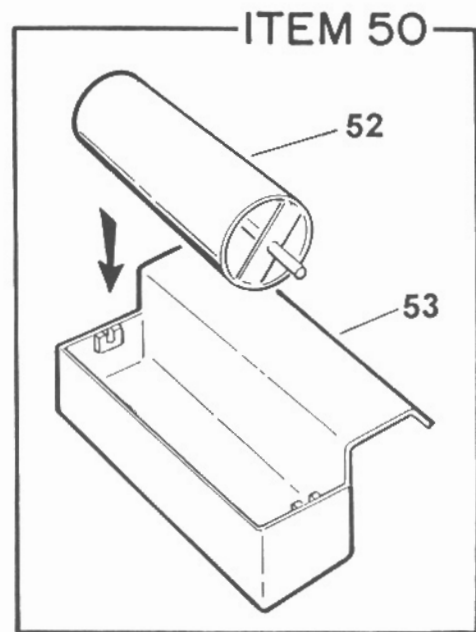
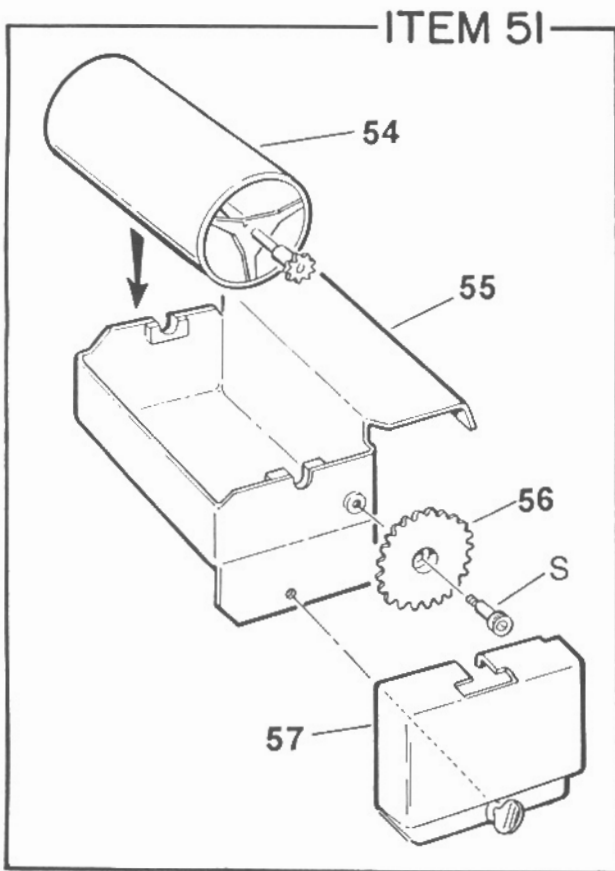

EXPLODED VIEW

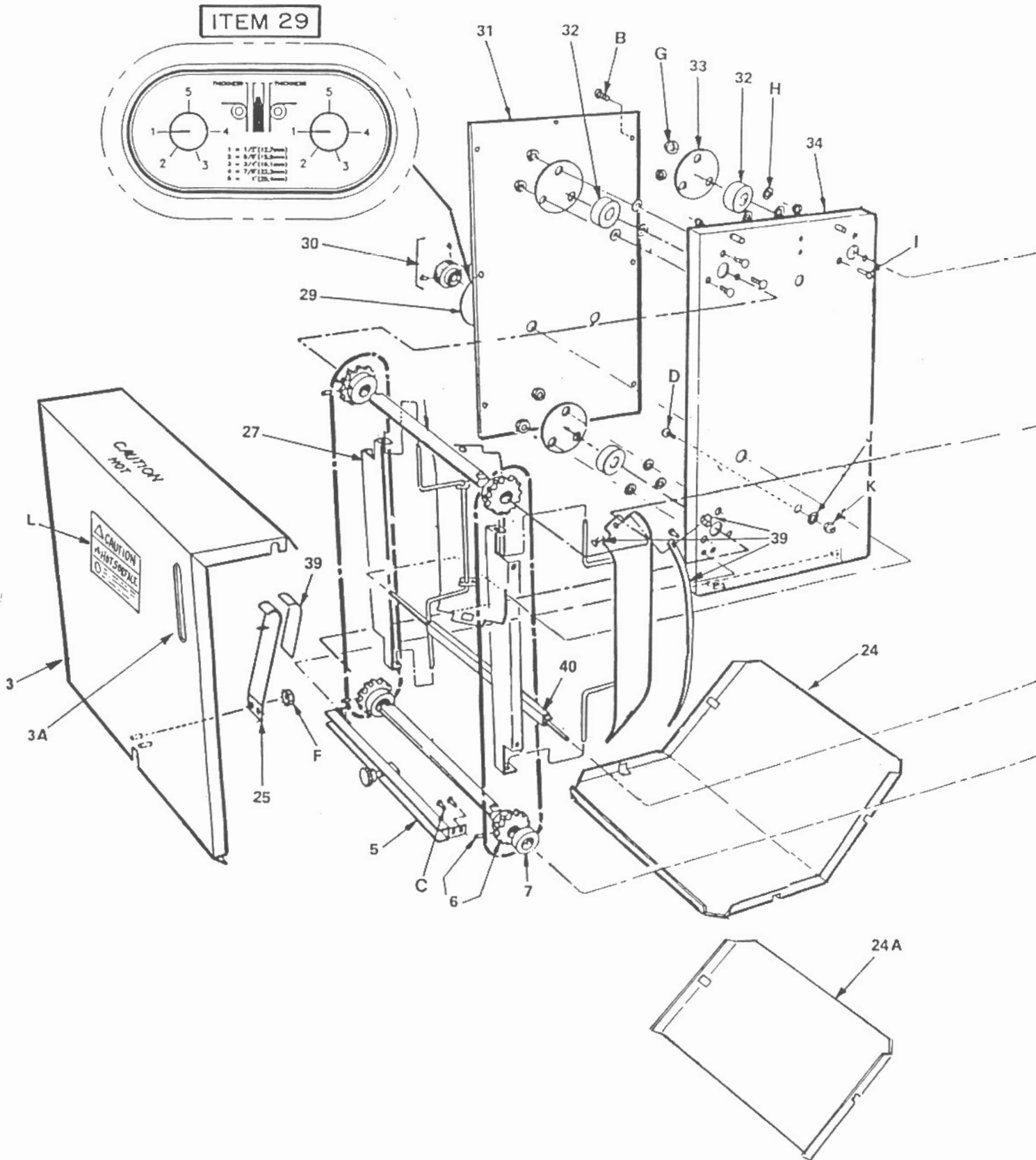

EXPLODED VIEW

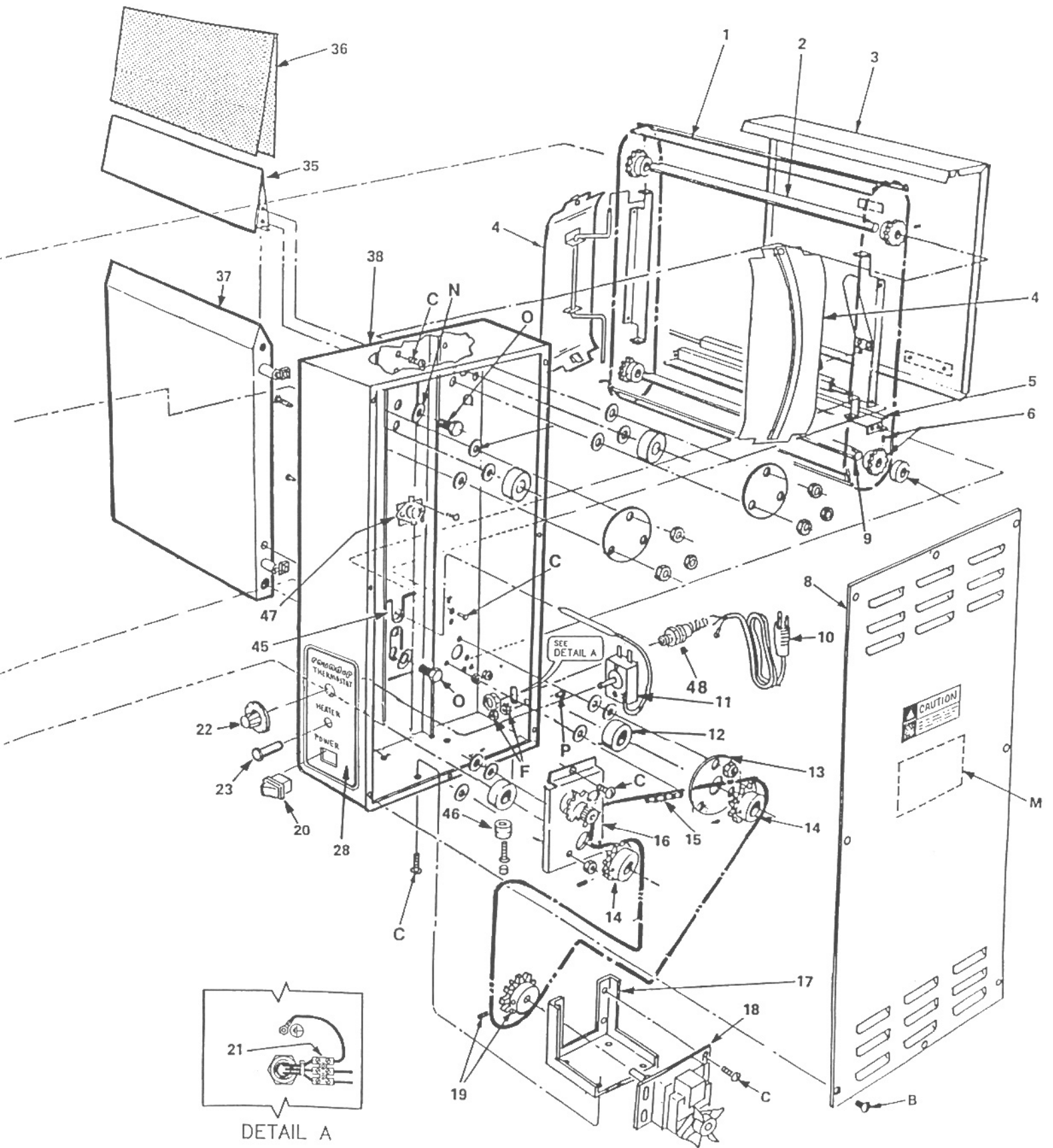

PARTS LIST

ITEM	PART NO.	DESCRIPTION	QTY
49	215K101	HEX KEY KIT (NOT SHOWN)	1
50	9080429	BUTTER WHEEL (OPTIONAL) (NOT SHOWN)	1
51	001K118	BUTTER WHEEL KIT (FOR NEW INSTALLATION ITEM 3A MUST BE ORDERED PART #: 0010960)	1
52	0020205	BUTTER ROLLER WELDMENT	1
53	0020204	BUTTER TRAY WELDMENT	1
54	0020991	ROLLER WELDMENT	1
55	0020993	PAN WELDMENT	1
56	2150170	SPROCKET 25B40	1
57	0502857	HOUSING, GEAR	1

* NOT SHOWN

THE FOLLOWING ITEMS ARE AVAILABLE ONLY IN PACKAGES OF 10			
ITEM	PART NO.	DESCRIPTION	QTY
A	100P898	WIRING DIAGRAM LABEL	1
B	308P157	SCREW, #8-32 x 3/8" (10 mm)	2
C	310P154	SCREW, #10-32 x 3/8"	4
D	306P104	SCREW, #6-32 x 1/4" (6 mm)	1
E	406P107	CABLE TIE	1
F	308P143	NUT, #8-32, "KEPS"	1
G	308P106	NUT, #8-32	3
H	310P140	WASHER, #10	3
I	308P107	SCREW, #8-32 x 3/4" (20 mm)	3
J	306P102	WASHER, #6, INT. TOOTH	1
K	306P107	ACORN NUT, #6-32	1
L	1000901	"HOT SURFACE" LABEL	1
M	1000900	"SERVICE" LABEL	1
N	325P104	WASHER, 1/4"	1
O	325P109	SCREW, 1/4-20 x 1/2"	1
P	308P124	SCREW, #8-32 x 1/2", 1-WAY	1
R	406P108	WIRE NUT CONNECTOR	1
S	325P152	SCREW, THUMB, 1/4-20	1

ITEM	PART NO.	DESCRIPTION	QTY
24	0500540	BUN CHUTE	1
24A	0502505	BUN CHUTE	1
25	0500539	CONVEYOR SPRING	2
26	9080438	OPTIONAL BUN FEEDER (BF-1)	--
27	050K114	ROD BRACKET KIT	2
28	1000906	CONTROL PANEL LABEL	1
29	100P902	DIAL LABEL (PKG. OF 10)	1
30	2100127	KNOB (W / SETSCREWS)	2
31	0502176	COVER PANEL	1
32	2150150	BRONZE BEARING	6
33	215K106	BEARING RETAINER KIT (INCL. ONE OF ITEM 32)	6
34	0020791	END HOUSING WELDMENT	1
35	0500543	SEPARATOR CONE	1
36	040K104	GRILL COVER (PKG. OF 3)	--
	040P104	GRILL COVER (PKG. OF 10)	--
37	0100127	GRILL (120 VOLT)	1
	0100130	GRILL (230 VOLT)	1
38	0020787	CONTROL HOUSING WELDMENT	1
39	210K130	TEFLON STRIP KIT (INCL. 2 SLIDE RAILS FOR TENSIONERS AND 2 STRIPS FOR CONVEYOR SPRINGS)	2
40	0020174	CONVEYOR CAM	2
41	0800136	BUN TRIVET - 9 1/2" LONG	1
42	0800135	BUN TRIVET - 7" LONG	1
43	0020338	BUN FEEDER FRAME	1
44	0020777	BUN TRIVET	1
45	0500578	RETAINER	1
46	210K230	BUMPER, 1" LEG KIT (SET OF FOUR, INCLUDES SCREWS AND BUMPER COVERS)	1
	210K104	LEG KIT FOR VCT-10BK ONLY	1
	*210K115	LEG KIT 2" LEG	1
47	4030162	HIGH LIMIT THERMOSTAT	1
48	0400258	STRAIN RELIEF	1
	040P243	STRAIN RELIEF (RIGHT ANGLE) (PKG OF 10)	1

ITEM	PART NO.	DESCRIPTION	QTY
1	0010190	CONVEYOR BELT	2
	0800204	1/2" PITCH LINK (SMALL)	--
	0800121	3/4" PITCH LINK (LARGE)	--
2	2150117	IDLER SHAFT	2
3	0010568	FACE PANEL	2
3A	0010960	FACE PANEL	1
4	0010475	TENSIONER ASSY	4
5	0010569	SUPPORT ASSY	2
6	2150108	SPROCKET	8
7	212K103	SPACER (PKG. OF 2)	2
8	0502167	COVER PANEL	1
9	2150118	DRIVE SHAFT	2
10	*****	POWER CORD - SEE CHART ON PAGE 10	--
11	403K116	THERMOSTAT (INCLUDES ITEM 22)	1
12	2150158	BALL BEARING (USE ON LOWER SHAFTS OF MOTOR SIDE ONLY)	2
13	050K115	BEARING RETAINER KIT	1
14	2150109	DRIVE SPROCKET	2
15	2150162	DRIVE CHAIN (VCT-10)	1
	2150119	DRIVE CHAIN (VCT-30)	1
16	0020464	IDLER SPROCKET ASSY	1
17	0500538	MOTOR MOUNTING BRKT.	1
18	*****	DRIVE MOTOR - SEE CHART ON PAGE 10	1
19	2150120	MOTOR SPROCKET (VCT-10)	1
	2150110	MOTOR SPROCKET (VCT-30)	1
20	4010151	SWITCH, ROCKER (120 VAC)	1
	4010137	SWITCH, ROCKER (230 VAC)	1
	*401K115	TOGGLE SWITCH 20A MFG. SERIES 90803XX & 90804XX ONLY	1
21	4060304	TERMINAL BLOCK	1
22	2100133	THERMOSTAT KNOB	1
23	4060323	INDICATOR LIGHT (115 VAC)	1
	4060229	INDICATOR LIGHT (230 VAC)	1
	*4060186	LIGHT, IND-RED; RND; (125V) MFG. SERIES 90803XX & 90804XX ONLY	1
	*4060198	LIGHT, IND. RED; RND; (250V)	1

PARTS IDENTIFICATION

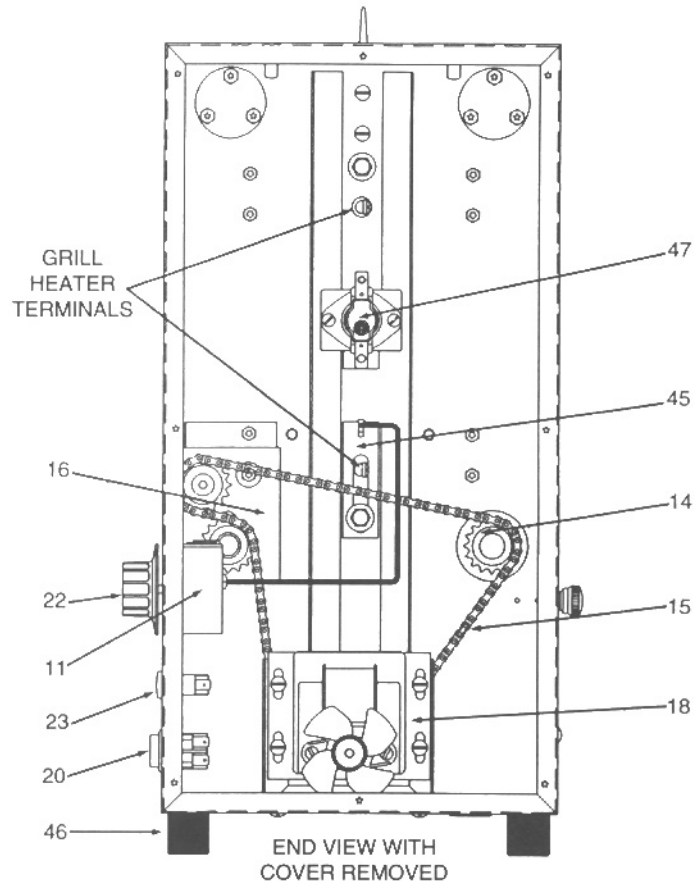

DRIVE MOTOR AND POWER CORD/PLUG PART NUMBERS

MODEL	VOLTAGE/ COUNTRY	DRIVE MOTOR P/N	POWER/PLUG CORD P/N	POWER CORD PLUG
VCT-10	115 VOLT / US	400K150	0700463	NEMA 5-15P
	115 VOLT / CANADA	400K150	0700451	NEMA 5-20P
	230 VOLT / US	400K151	0700452	NEMA 6-20P
	230 VOLT / EURO	400K151	0700453	CEE 7/7
VCT-30	115 VOLT / US	400K152	0700463	NEMA 5-15P
	115 VOLT / CANADA	400K152	0700451	NEMA 5-20P
	230 VOLT / US	400K153	0700452	NEMA 6-20P
	230 VOLT / ERO	400K153	0700453	CEE 7/7
VCT-10BK	230 VOLT / US	400K151	0700452	NEMA 6-20P
	230 VOLT / EXPORT	400K151	0700453	CEE 7/7
VCT-30BK	120 VOLT / US	400K152	0700463	NEMA 5-15P
	230 VOLT / US	400K153	0700452	NEMA 6-20P
	230 VOLT / EXPORT	400K153	0700453	CEE 7/7

POWER CORD PLUGS:



NEMA
5-15P



NEMA
5-20P



NEMA
6-20P



CEE
7/7

TROUBLESHOOTING GUIDE

NOTE: Service is to be performed by qualified service personnel.



WARNING

Inspection, testing and repair of electrical equipment should be performed by qualified service personnel. The unit should be unplugged when servicing, except when electrical tests are required.



DANGER

Use extreme care during electrical circuit tests. Live circuits will be exposed.



DANGER

Where testing indicates "with power OFF" be sure that power switches are off and unit is unplugged.

TO USE THIS GUIDE

1. Locate the problem in the left column.
2. Read across to the right columns and follow instructions.

NOTE: Letters shown in column 2 refer to Possible Causes – numbers in column 3 refer to Test Procedures.

PROBLEM	POSSIBLE CAUSE	FOLLOW TEST PROCEDURES
No heat - and - conveyor belts do not move	A. B. C. D. E.	1 2 3 4 5
No heat - and - conveyor belts move	A. B. C. D. L.	1 2 3 4 12
Grill is hot - and - conveyor belts do not move	A. B. C. E. F. G. H. J.	1 2 3 5 6 7 8 10
Product is over-toasted - or - grill heat is too high - or - drop time is too slow	A. C. D. E. F. G. H. I. J. K.	1 3 4 5 6 7 8 9 10 11
Product is under-toasted - or - grill heat is too low - or - drop time is too fast	A. B. C. D. E. G. I. J. K.	1 2 3 4 5 7 9 10 11
Product is getting "Stuck" - or - conveyor belts "Stop" when product is toasting	A. B. C. E. F. G. H. I. J. K.	1 2 3 5 6 7 8 9 10 11
Conveyor belts are "Jumping" or "Snapping"	A. B. E. F. G. H. I. J. K.	1 2 5 6 7 8 9 10 11

POSSIBLE CAUSES

- | | |
|--|--|
| <ul style="list-style-type: none"> A. Toaster is installed incorrectly. B. Not enough voltage, defective power cord, defective power switch. C. Defective wiring. D. Defective thermostat or defective grill. E. Defective drive motor or wrong drive motor. F. Defective drive chain or loose sprocket. | <ul style="list-style-type: none"> G. Face panel(s) loose or not attached. H. Conveyor belts installed incorrectly. I. Conveyor belt is loose or missing links (41 links required). J. Conveyor spring or pressure rod spring bent or missing. K. Bun adjustment knobs set incorrectly. L. High limit thermostat tripped or defective. |
|--|--|

TEST PROCEDURES

1. Perform Installation and Operating Procedures on Page 6 of this manual.
2. Check receptacle for correct voltage (see Specifications, Page 10). With unit plugged in and Rocker Switch ON, check for voltage at bottom of Rocker Switch. If low or zero voltage, replace Power Cord. If correct voltage, check at top of power switch for correct voltage. If low or no voltage, replace Rocker Switch.
3. Check all electrical connections for burns, discoloration or arcing. Replace all connections or components with damaged terminals. Replace all damaged wiring with the same or a higher rated wire.
4. To check thermostat - Allow unit to warm up for 20 minutes with thermostat dial at "10".
 - A. Check grill temperature at center of grill (with conveyor belt, tensioners, and grill cover removed),.
 - B. After grill temperature reaches a maximum of **530-555°F (277°-290°C)** and the temperature begins to drop, the indicator light (Item 23) should turn off. If test readings do not agree with these figures, replace thermostat.To check grill -
 - A. Use an Ohm meter to test resistance of the grill heater (Disconnect one wire to isolate heater). Correct cold resistance is: **120 volt model - 8.2 Ohms;**
208, 220-240 volt model - 24.8 Ohms.
5. To check drive motor -
 - A. Measure resistance of motor coil. Replace motor if coil measures either open circuit or zero resistance.
 - B. Mark the drive motor sprocket and count the turns per minute. Correct drive motor speed is **one (1) turn per minute for VCT-10, three (3) turns per minute for VCT-30.**
6. Check drive chain for kinks, broken or bent links or other damage. Check motor sprocket and drive sprockets (on drive shaft), tighten setscrew on flat of shaft if needed. Also check for broken/damaged/worn sprockets. Replace as needed.
7. Tighten black knob on face panel. Install face panel if it is not attached.
8. Install conveyor belt to match diagram on Page 14. Be sure that the "hook" faces out and the point of the hook is down.
9. Remove conveyor belt by squeezing any two links together to "unhook" the links. Lay conveyor belt flat and count links. Correct amount is forty one (41) links, 38 large and 3 small links. To shorten conveyor belt, remove one or more small links. Replace entire conveyor belt if links are damaged.
10. Replace Conveyor Spring (Item 25) (on inside of face panel) or Tensioner (Item 4) if damaged or missing.
11. Measure bun thickness and set bun adjustment knobs correctly.
12. With power off and unit cool to the touch, remove one wire and check across terminals for continuity. If continuity, part is good. If no continuity, press reset and retest. If still no continuity, replace.

PARTS REPLACEMENT

NOTE: Service is to be performed by qualified service personnel.



WARNING
Inspection, testing and repair of electrical equipment should be performed by qualified service personnel. The unit should be unplugged when servicing, except when electrical tests are required.



DANGER
Use extreme care during electrical circuit tests. Live circuits will be exposed.



DANGER
Where testing indicates "with power OFF" be sure that power switches are off and unit is unplugged.

THERMOSTAT

With Power OFF -

1. Remove Cover Panel (Item 8).
2. Remove Knob (Item 22).
3. Remove two screws holding Thermostat from front panel.
4. Remove wires from old Thermostat and attach to new Thermostat.
5. Loosen bolt (Item 0) holding retainer (45). Slide retainer down, remove old Thermostat and pull the "bulb" out of hole in side panel.
6. Push the "bulb" of the new Thermostat into the hole in the side panel.
7. Reverse steps 1-5 to complete procedure.



CAUTION
Do not kink the thermostat tubing. Carefully form the tubing away from the electrical and moving parts.

DRIVE MOTOR

With Power OFF -

1. Remove Cover Panel (Item 8).
2. Remove Drive Motor (Item 18).
3. Remove Motor Sprocket (Item 19) with a 5/32" hex wrench.
4. Attach Sprocket to new Motor.

NOTE: Make sure sprocket setscrew is on the flat of the shaft and tight.

5. Connect the motor wires to the new motor one at a time.
6. Attach the Motor/Bracket Assembly to the Motor Mounting Bracket (Item 17).

NOTE: Do not tighten screws at this time.

7. Place Drive Chain (Item 15) on Sprocket and push down on Motor - allow 1/4" (0.6 mm) play at middle of drive chain - then tighten mounting screws while holding Motor.

NOTE: Be sure that the Drive Chain (Item 15) is straight across the sprockets (Item 14). Move the sprockets in or out (if needed) to make the drive chain straight.

8. Install Cover Panel to complete procedure.

CONVEYOR BELT

With Power OFF -

Removal -

1. Remove Face Panel (Item 3).
2. Move Bun Adjustment Knob to "1" to loosen Conveyor Belt.
3. Disconnect Conveyor Belt by unhooking both ends of one link, then remove Conveyor Belt.

Replacement -

1. Move Bun Adjustment Knobs to "1" to loosen conveyor belt.

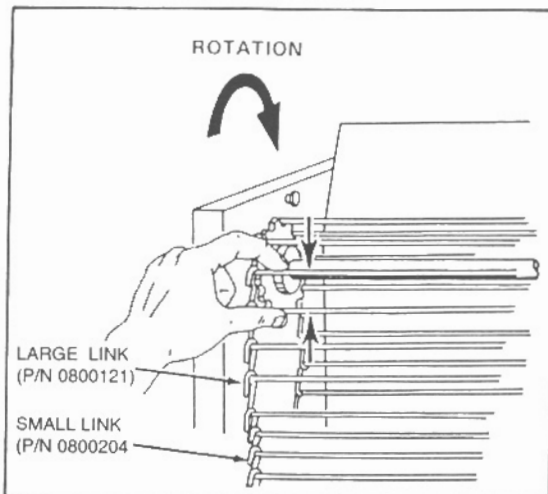

2. Place the Conveyor Belt on the top Sprockets and check for correct positioning (See diagram).

NOTE: Conveyor Belt must be installed correctly (open end of link pointing away from direction of rotation, and end of link on outside of Conveyor Belt after installation).

3. Wrap conveyor around lower sprockets and connect by hooking both ends of the Conveyor Belt together.
4. Install Face Panel and tighten knob.
5. Move Bun Adjustment Knob to correct position.

CONVEYOR SPRING

With Power OFF -

1. Remove Face Panel (Item 3).
2. Remove two 8x32 nuts (Item F) from Conveyor Spring.
3. Remove old Conveyor Spring.
4. Reverse steps 1-3 to complete procedure.

NOTE: Conveyor Spring must have Teflon Strip (Item 39) attached.

HIGH LIMIT

With Power OFF -

1. Remove Cover Panel (Item 8).
2. Locate High Limit Thermostat (Item 47).
3. Remove screws holding wires to High Limit Thermostat.
4. Remove screws holding High Limit Thermostat.
5. Reverse steps 2-4 to install new High Limit Thermostat.

INSTALLATION OF GRILL COVER

1. Turn OFF the power and allow the unit to cool completely.
2. Remove the Bun Feeder (if used) and set aside. Remove Grill Cover, if one is in place.
3. Lay a Grill Cover on a clean, flat surface. Note that the Grill Cover is longer than it is wide. Fold exactly in half the LONG way – correct finished size is 13 inches by 12 inches.
4. Crease the Grill Cover at the fold by

pressing the fold with a finger. DO NOT USE METAL TOOLS TO CREASE THE GRILL COVER!

5. Install the Grill Cover by draping it over both sides of the grill surface. Note that the crease should be centered directly on the grill top (black separator cone).
6. Install Bun Feeder. Check Grill Cover to be sure it is not caught in conveyor. Unit is now ready for use.

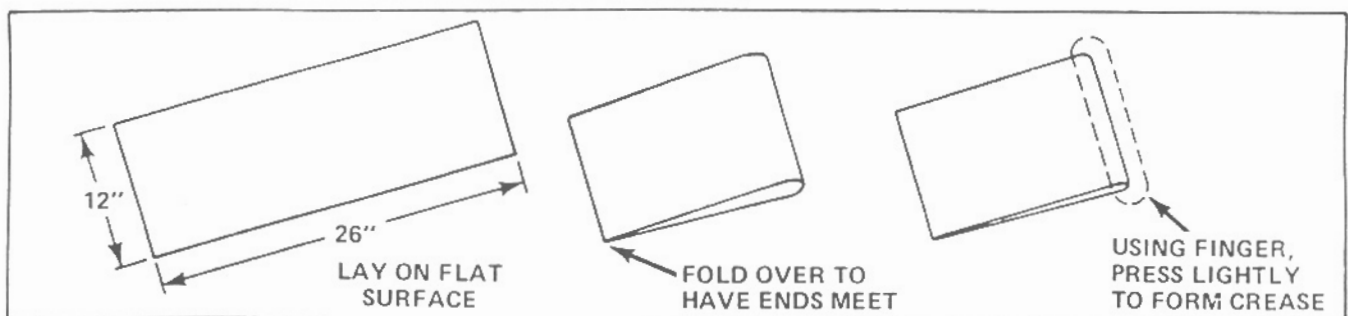

WIRING DIAGRAM

MFG. SERIES 92002XX ONLY

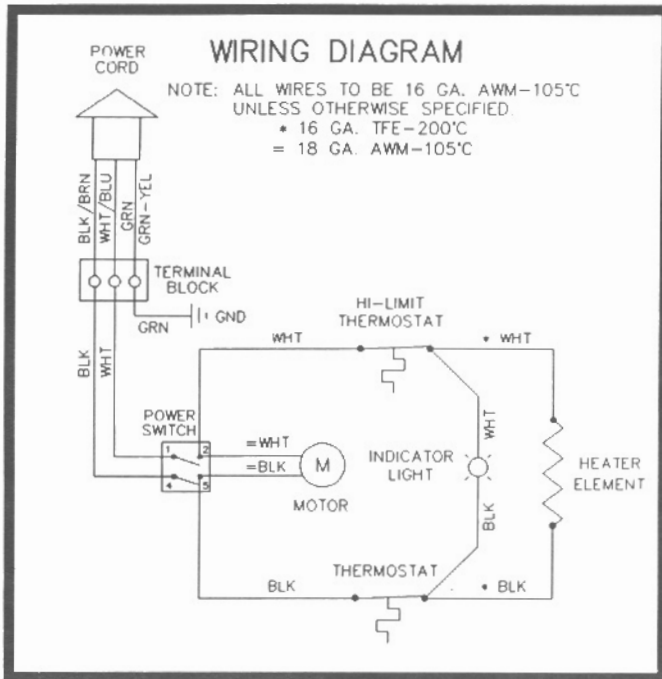

MFG. SERIES 90803XX AND 90804XX ONLY

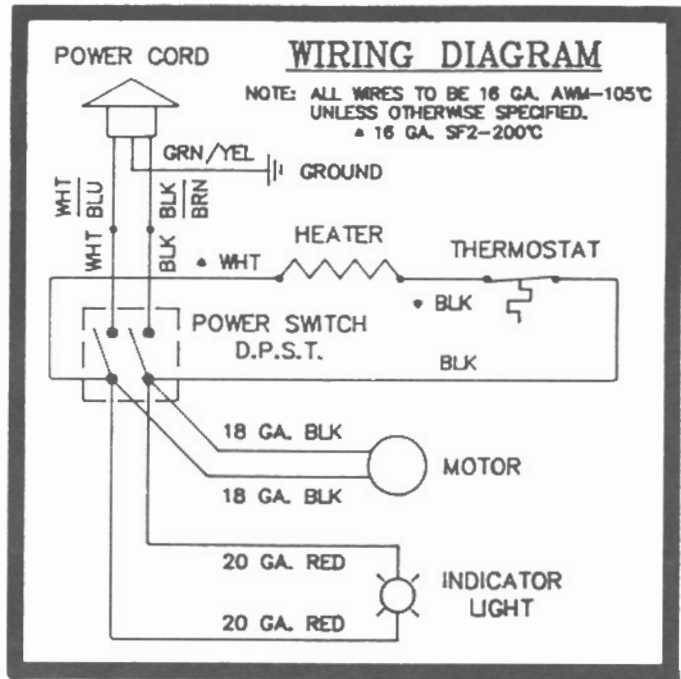

WARRANTY

Equipment manufactured by Roundup Food Equipment Division of A. J. Antunes & Co. has been constructed of the finest materials available and manufactured to high quality standards. These units are warranted to be free from mechanical and electrical defects for a period of one year from date of purchase under normal use and service, and when installed in accordance with manufacturer's recommendations. To insure continued proper operation of the units, follow the maintenance procedure outlined in the Owner's Manual.

1. This warranty does not cover cost of installation, defects caused by improper storage or handling prior to placing of the Equipment. This warranty does not include overtime charges or work done by unauthorized service agencies or personnel. This warranty does not cover normal maintenance, calibration, or regular adjustments as specified in operating instructions, or manuals (see Owner's Manual of specific product); and/or labor involved in moving adjacent objects to gain access to the Equipment. This warranty does not cover consumable items such as grill covers, gaskets, O-rings and bulbs. This warranty does not pay travel, mileage, or any other charges for a service to reach the equipment's location (unless stated in the Owner's Manual).
2. Roundup reserves the right to make changes in design or add any improvements on any product. The right is always reserved to modify equipment because of factors beyond our control and government regulations. Charges to update equipment do not constitute a warranty charge.
3. If shipment is damaged in transit the purchaser should make his claim directly upon the carrier. Careful inspection should be made of the shipment as soon as it arrives and visible damage should be noted upon the carrier's receipt. Damage should be reported to the carrier. This damage is not covered under this warranty.
4. Warranty charges do not include freight or foreign, excise, municipal or other sales or use taxes. All such freight and taxes are the responsibility of the purchaser.
5. THIS WARRANTY IS EXCLUSIVE AND IS IN LIEU OF ALL OTHER WARRANTIES, EXPRESSED OR IMPLIED, INCLUDING ANY IMPLIED WARRANTY OR MERCHANTABILITY OR FITNESS FOR A PARTICULAR PURPOSE, EACH OF WHICH IS HEREBY EXPRESSLY DISCLAIMED. THE REMEDIES DESCRIBED ABOVE ARE EXCLUSIVE AND IN NO EVENT SHALL ROUNDUP BE LIABLE FOR SPECIAL CONSEQUENTIAL OR INCIDENTAL DAMAGES FOR THE BREACH OR DELAY IN PERFORMANCE OF THIS WARRANTY.