

EZ-Fit® Lid L2400C



Lid Dispenser Instruction Guide

Thank you for purchasing the EZ-Fit® Lid Dispenser from San Jamar. EZ-Fit® Lid is designed to provide simple, sanitary lid dispensing that is easy and convenient for both you and your guests. If you have any questions or comments, please do not hesitate to contact us at www.sanjamar.com or (800) 248-9826.

Note: EZ-Fit® Lid Dispensers are intended for use with flat, cold beverage lids only. This product is not designed for use with domed lids or most contoured hot beverage lids. For best performance, test lid compatibility prior to installation.

The L2400C EZ-Fit® Lid Dispenser is designed for use with lids more than 3.75" in diameter. For smaller lids, please use the L2200C EZ-Fit® Lid Dispenser.

IN-COUNTER MOUNTING INSTRUCTIONS

1. Cut hole in counter surface.

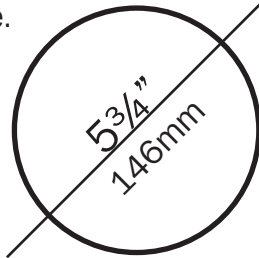

2. Remove trim ring with lid dispenser door assembly attached by turning counterclockwise.

3. Insert dispenser tube into counter and secure mount ring to counter with screws provided (#8 screws).

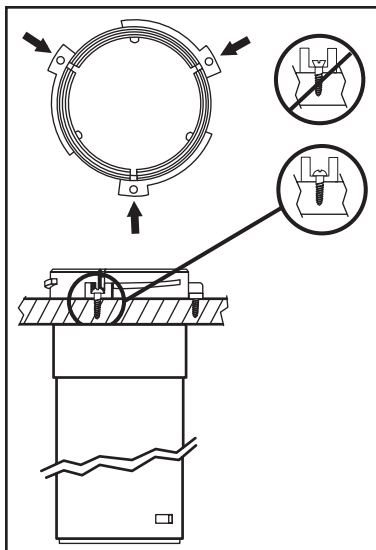

4. Replace trim ring with lid dispenser door assembly by turning clockwise.

5. Rotate lid dispenser door assembly (a) to desired orientation (b).

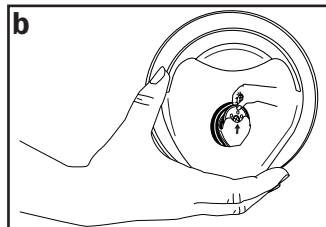
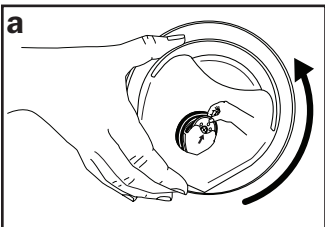

LOADING INSTRUCTIONS

1. Open lid dispenser door by pressing down on top of door assembly (a) and pulling outward (b), releasing door latch.

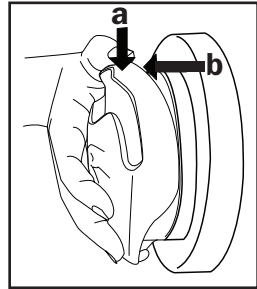

2. Load full sleeve of lids, assuring that inside of lids are facing outward, as shown.

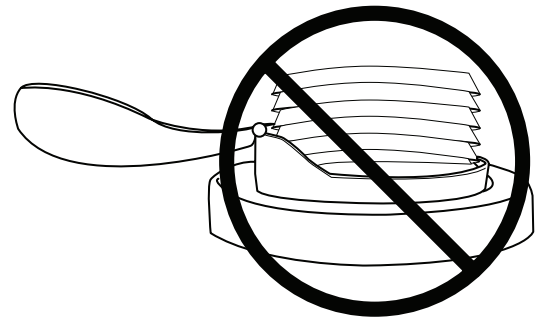
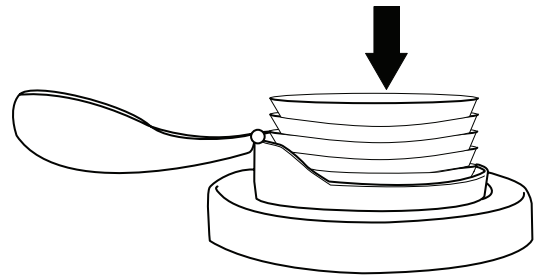

3. While holding lids in place, close lid dispenser door, snapping latch securely in place.

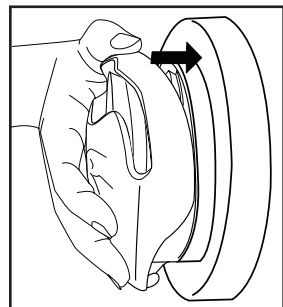

EZ-FIT® LID DISPENSER PRODUCT LINE

Item No.	Description	Lid Rim Dia.	Approx. Size
L2200C	Small Lid Dispenser	2.75" to 3.75"	8oz. to 24oz.
L2400C	Large Lid Dispenser	3.75" to 4.75"	24oz. to 64oz.

Tips for Best Dispensing Performance

1. Be sure lids are always loaded with the top side of lid loaded first, with inside of lids and lid flanges facing outward, as shown in loading instructions.
2. EZ-Fit® Lid is designed for use with flat, cold beverage lids only. Dispenser may not dispense properly if using contoured hot beverage lids or domed lids.
3. Some brands and styles of beverage lids may dispense better than others, due to the tightly nested nature of the lid stack. For best results, test lid performance before use.

REPLACEMENT PARTS

Lid Door Cover

Item #: 100667



Trim Ring

Item #: X24TR



Lid Holder

Item #: 100668



Mount Ring

Item #: X24MT

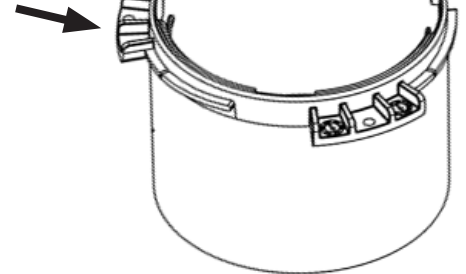

Push Plate

Item #: 100669



NSF Patent Pending

SAN JAMAR®

Smart ♦ Safe ♦ Sanitary

555 Koopman Lane · Elkhorn, Wisconsin 53121 USA

Customer Care: 800.248.9826 · T: 262.723.6133

F: 262.723.4204 · www.sanjamar.com

©2006 San Jamar 100769