

Denomination / Denominación / Dénomination

Item

ECONOMY SLICER

GL250

Skyfo@d  
Equipment LLC

Data/Fecha/Date: 21/07/2015

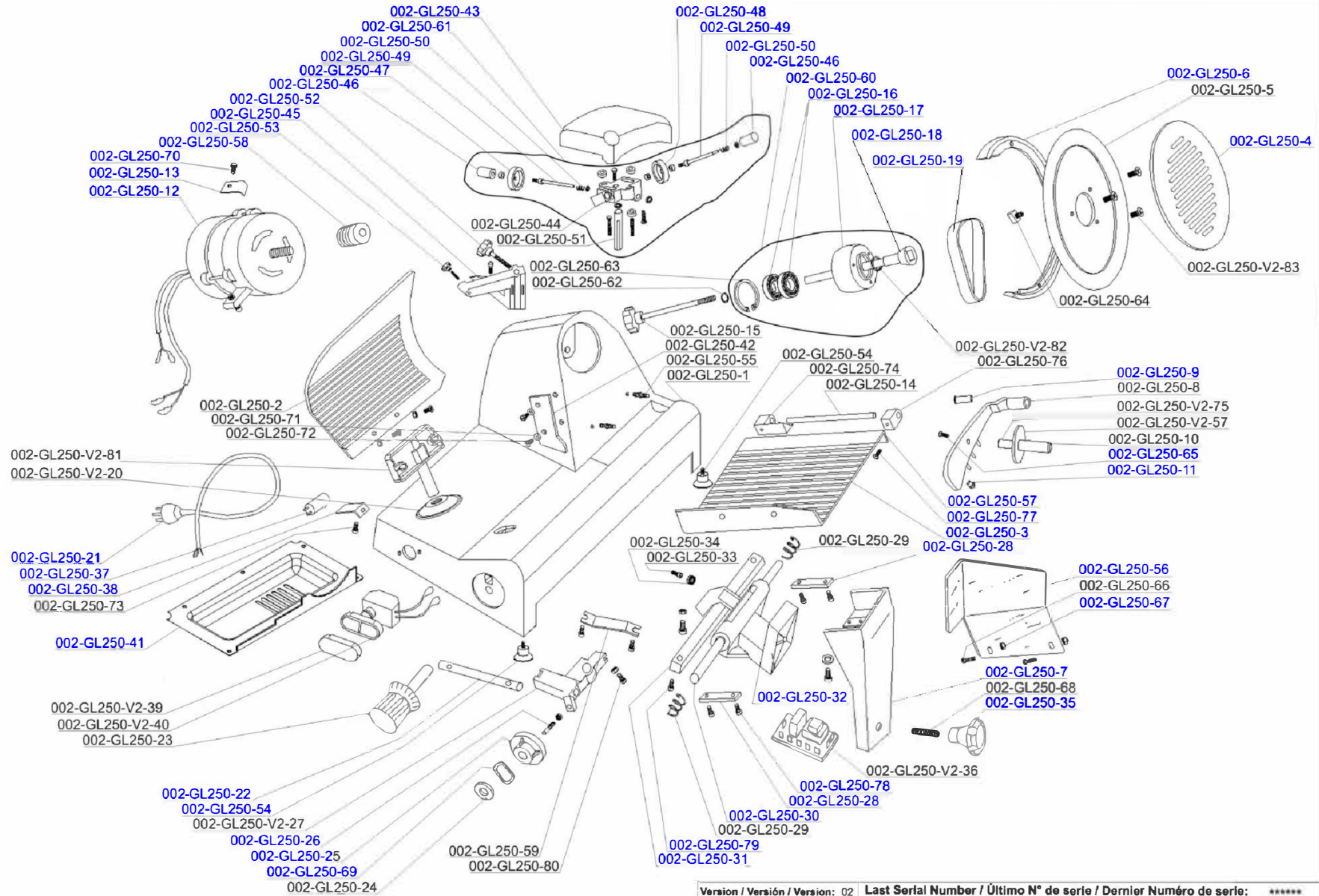



<b>Cód.</b>	<b>Descrição</b>	<b>UM</b>
002-GL250-5	BLADE 250MM	By the each
002-GL250-54	RUBBER FOOT (by each)	By the each
002-GL250-23	KNOB WITH SCALE	By the each
002-GL250-42	MEATSCRAPER	By the each
002-GL250-37	CAPACITOR	By the each
002-GL250-4	BLADE GUARD DISC 250ES	By the each
002-GL250-64	BLADE GUARD DISC SQUARE - HEAD NUT	By the each
002-GL250-56	TRAY FINGER PLATE GUARD	By the each
002-GL250-43	SHARPENER MULCH	By the each
002-GL250-12	MOTOR 250ES	By the each
002-GL250-47	FINE GRINDING WHEEL #45	By the each
002-GL250-48	CRUDE GRINDING WHEEL #45	By the each
002-GL250-9	FIXED-ARM BUSHING	By the each
002-GL250-8	FOOD AND FIXED-ARM	By the each
002-GL250-13	MOTOR BRIQUETTING	By the each
002-GL250-2	ACTIVE CLAPBOARD	By the each
002-GL250-41	MOTHERBOARD	By the each
002-GL250-38	CAPACITOR RETAINER	By the each
002-GL250-73	CAPACITOR FIXATION CLAMP BOLT	By the each
002-GL250-39	BUTTON MULCH	By the each
002-GL250-40	BUTTON SWITCH	By the each
002-GL250-24	SPRING GASKET	By the each
002-GL250-20	SLIDE MULCH	By the each
002-GL250-22	SLIDE AXLE	By the each
002-GL250-58	SMALL BELT WHEEL OF MOTOR	By the each

<b>Cód.</b>	<b>Descrição</b>	<b>UM</b>
002-GL250-46	BUTTON OF SHARPENER	By the each
002-GL250-57	M6X40 HEXAGONAL SCREW	By the each
002-GL250-15	BLADE GUARD BOLTS	By the each
002-GL250-21	POWER LINE	By the each
002-GL250-49	PIN OF RUBBINGSTONE	By the each
002-GL250-53	ACTIVE CLAPBOARD MANDRIL	By the each
002-GL250-71	MEAT SCRAPING SHIM X2	By the each
002-GL250-50	SPRING	By the each
002-GL250-72	MEAT SCRAPER BOLT X2	By the each
002-GL250-55	PIN OF BLADE GUARDING RING X2	By the each
002-GL250-6	BLADE GUARDING RING 250ES	By the each
002-GL250-18	PIN OF BELT WHEEL	By the each
002-GL250-17	BLADE BELT WHEEL	By the each
002-GL250-33	M8X35 HEXAGONAL SCREW	By the each
002-GL250-28	SLIDE AXLE BRIQUETTING	By the each
002-GL250-59	SLIDER DRIVER	By the each
002-GL250-80	SLIDER ADJUST BOLT	By the each
002-GL250-34	BALL BEARING607	By the each
002-GL250-27	SLIDER	By the each
002-GL250-26	CAM OSCULANT STAFF	By the each
002-GL250-25	CAM	By the each
002-GL250-69	UNDEE SPRING GASKET	By the each
002-GL250-32	TOWING BRACKET	By the each
002-GL250-30	TOWING BRACKET AXLE	By the each
002-GL250-29	SPRING OF TOWING BRACKET SLIDE AXLE X2	By the each

<b>Cód.</b>	<b>Descrição</b>	<b>UM</b>
002-GL250-79	QUADRATE AXIS LOCKING SCREW X2	By the each
002-GL250-45	SHARPENER BASE OF ASSEMBLED	By the each
002-GL250-52	SHARPENER TIGHTEN KNOB	By the each
002-GL250-1	ENCLOSER	By the each
002-GL250-44	SHARPENER BASE OF SUBASSEMBLY	By the each
002-GL250-51	PIN OF SHARPENER BRACKET	By the each
002-GL250-16	BALL BEARING 6202 X2	By the each
002-GL250-74	TRAY BEARING COVER A	By the each
002-GL250-14	FIXED-ARM PIN #12X185	By the each
002-GL250-62	#15 SPRING GASKET FOR HOLE	By the each
002-GL250-63	#35 SPRING GASKET FOR HOLE	By the each
002-GL250-19	BELTSV 330	By the each
002-GL250-75	MEAR BOARD BRASKET	By the each
002-GL250-3	FOOD SALVER	By the each
002-GL250-7	TRAY BRACKET	By the each
002-GL250-31	QUADRATE AXIS	By the each
002-GL250-76	TRAY BEARING COVER B	By the each
002-GL250-65	FIXED-ARM HANDLE BOLT	By the each
002-GL250-77	CROSS RECESSED COUNTERSUNK HEAD M6X12	By the each
002-GL250-66	FINGER BAFFLE BOLT X2	By the each
002-GL250-11	PLASTIC GRANULE	By the each
002-GL250-10	FIXED-ARM HANDLE	By the each
002-GL250-67	FINGER BAFFLE NUT X2	By the each
002-GL250-36	RELAY	By the each
002-GL250-35	TOWING BRACKET COVER KNOB	By the each

<b>Cód.</b>	<b>Descrição</b>	<b>UM</b>
002-GL250-68	BRACKET KNOB BOLT	By the each
002-GL250-81	SHARPENER ELEMENT	By the each
002-GL250-61	SHARPENER MODULE	By the each
002-GL250-60	BELT WHEEL MODULE	By the each
002-GL250-70	MOTOR IMPACTED BOLT	By the each
002-GL250-78	SLIDE AXLE BRIQUETTING BOLT	By the each
002-GL250-V2-20	SLIDE MULCH	By the each
002-GL250-V2-27	SLIDER	By the each
002-GL250-V2-36	CIRCUIT BOARD	By the each
002-GL250-V2-39	BUTTON MULCH	By the each
002-GL250-V2-40	BUTTON SWITCH	By the each
002-GL250-V2-57	FOODED-ARM JACKET	By the each
002-GL250-V2-75	FOODED-ARM ALUMINUM TUBE	By the each
002-GL250-V2-81	SUPPORTING BASE	By the each
002-GL250-V2-82	OIL SEAL FOR BELT WHEEL	By the each
002-GL250-V2-83	BLADE SCREW	By the each
002-GL250-83	BLADE SCREW	By the each
002-GL250-82	OIL SEAL FOR BELT WHEEL	By the each