

STAR MANUFACTURING INTERNATIONAL, INC.  
9325 OLIVE BLVD., P.O. Box 8492  
ST. LOUIS, MO 63132

## MODEL 162 STAR ELECTRIC HOTPLATE INSTALLATION AND OPERATING INSTRUCTIONS

THE STAR MODEL 162 ELECTRIC HOTPLATE IS EQUIPPED FOR THE VOLTAGE INDICATED ON THE NAMEPLATE MOUNTED ON THE BOTTOM AT THE CENTER TOWARD THE OPERATOR SIDE. THE TOTAL CONNECTED LOAD IS 4200 WATTS. THIS UNIT IS DESIGNED TO OPERATE ON ALTERNATING CURRENT (AC) TWO WIRE SINGLE PHASE SERVICE ONLY. DO NOT CONNECT TO DIRECT CURRENT (DC).

### INSTALLATION

FOR YOUR PROTECTION, WE RECOMMEND THAT A QUALIFIED ELECTRICIAN INSTALL THIS HOTPLATE. HE SHOULD BE FAMILIAR WITH ELECTRICAL INSTALLATIONS AND YOUR LOCAL ELECTRICAL REQUIREMENTS. THE EXTERNAL WIRING SHOULD BE IN CONDUIT OR AN APPROVED TYPE OF FLEXIBLE CABLE AND OF A SUITABLE SIZE TO CARRY THE LOAD. THE SUPPLY CIRCUIT SHOULD BE PROPERLY FUSED AND EQUIPPED WITH A MEANS OF DISCONNECTING AS REQUIRED BY LOCAL ELECTRICAL CODE. THE BODY OF THE HOTPLATE SHOULD BE GROUNDED. (DO NOT GROUND TO A GAS SUPPLY PIPE). THE CONNECTIONS ARE MADE IN THIS UNIT AT THE TERMINAL BLOCK, WHICH IS LOCATED IN THE REAR PORTION OF THE BODY. TO GAIN ACCESS TO THE TERMINAL BLOCK:

1. OPEN THE FRONT DOOR PANEL BY PULLING ON THE LOUVRE.
2. SLIDE THE MAIN DRIP PAN FORWARD.
3. RAISE THE REAR ELEMENT AND REMOVE ITS DRIP PAN.
4. REMOVE THE SCREW AT THE TO OF THE TERMINAL BLOCK COVER AND PULL FORWARD AND UP TO REMOVE. THE TERMINAL BLOCK IS NOT COMPLETELY ACCESSIBLE.

### LOCKING STRIPS

GREASE-TIGHT LOCKING STRIPS ARE AVAILABLE TO JOIN TWO OR MORE UNITS INTO A SOLID BANK. SPECIFY WHICH MODELS ARE TO BE BANKED AND THEIR ORDER IN THE LINE-UP WHEN ORDERING STRIPS.

### LEVELING UNIT

LEVEL UNIT BY ADJUSTING THE (4) FEET FOR ACCURATE AND PERFECT LINE UP WITH OTHER DESIGNER SERIES UNITS. CAUTION: DO NOT INSTALL WITHOUT FEET. FOUR FOOT EXTENSIONS WITH STUDS ARE PROVIDED AND SHOULD BE INSTALLED FOR EASE OF CLEANING.

### OPERATING PROCEDURE

CAUTION: USE ONLY FLAT BOTTOM POTS AND PANS! DO NOT USE RAISED BOTTOM UTENSILS OR BUCKETS! USE OF OTHER THAN FLAT BOTTOM PANS WILL OVERHEAT THE ELEMENTS AND BURN THEM OUT VOIDING THE WARRANTY ON THE ELEMENTS.

TWO (2) "MICRO-TUBE" HEATING ELEMENTS ARE USED. EACH ELEMENT DRAWS 2100 WATTS, AND IS CONTROLLED BY AN INFINITE POSITION SWITCH. THE RIGHT CONTROL KNOB CONTROLS THE REAR COOKING ELEMENT AND THE LEFT CONTROL KNOB CONTROLS THE FRONT COOKING ELEMENT.

ON "HI" THE ELEMENT DELIVERS UNINTERRUPTED FULL HEAT, BETWEEN "LO" AND "5" ANY DESIRED AMOUNT OF HEAT CAN BE OBTAINED BETWEEN 6% AND 60% OF FULL HEAT. WITH JUST A LITTLE PRACTICE YOU WILL SOON LEARN THE PROPER DIAL SETTINGS FOR VARIOUS COOKING JOBS.

A SIGNAL LIGHT IS PROVIDED BETWEEN THE CONTROL KNOBS TO GIVE A VISUAL CHECK IF EITHER ONE OR BOTH HEATING UNITS ARE TURNED ON.

#### CLEANING

THE EXTERIOR SURFACES CAN BE KEPT CLEAN AND ATTRACTIVE BY REGULARLY WIPING WITH CLEAN SOFT CLOTH. ANY DISCOLORATION CAN BE REMOVED WITH A NON-ABRASIVE CLEANER. THE HEATING ELEMENTS CAN BE RAISED AND THE DRIP PANS CAN BE REMOVED FOR CLEANING AND SERVICING.

TO REMOVE AND CLEAN THE MASTER DRIP PAN, PULL FORWARD ON THE LOUVRE OF THE FRONT PANEL AND THE PANEL WILL HINGE DOWN. JUST SLIDE THE DRIP PAN FORWARD AND REMOVE TO THE SINK FOR CLEANING.

#### MAINTENANCE

FOR ANY ASSISTANCE IN THE OPERATION OR MAINTENANCE OF STAR PRODUCTS, WRITE TO THE SERVICE DEPARTMENT OF THE STAR MANUFACTURING COMPANY. IN ALL CORRESPONDENCE MENTION THE MODEL NUMBER AND THE SERIAL NUMBER OF YOUR STAR UNIT, AND THE VOLTAGE YOU ARE USING.

CK. J.S. DATE 3/21/61  
 LIMITS UNLESS OTHERWISE NOTED  
 FRACTIONS ± 1/64 DECIMALS ± .005

FINISH  
 STAR MANUFACTURING CO.  
 9375 OLIVE BLVD. ST. LOUIS 32 MO

MODEL NO. *nlc* PART NO.  
 TITLE WIRING DIAGRAM — ELECTRIC HOT PLATE  
 CHANGES LTR DATE CHANGE DR

A 11/11/74 WIRE SIZE NOTE.

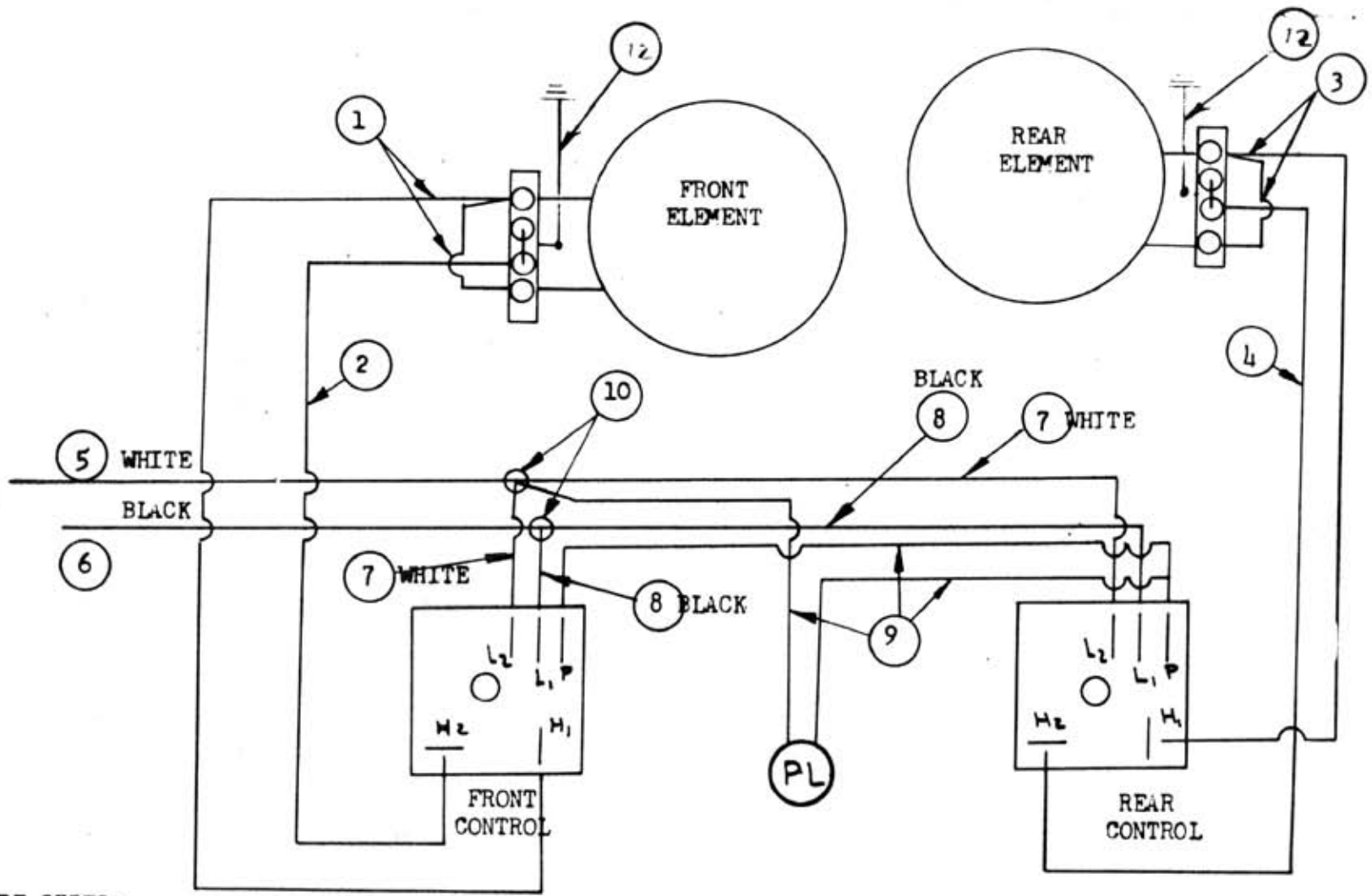

WIRE SIZES:  
 ⑤ #12 GA.  
 ⑥ #12 GA.  
 ⑨ #18 GA.  
 ALL OTHER WIRING IS #14 GA.

CONTROLS VIEW FROM FRONT OF UNIT

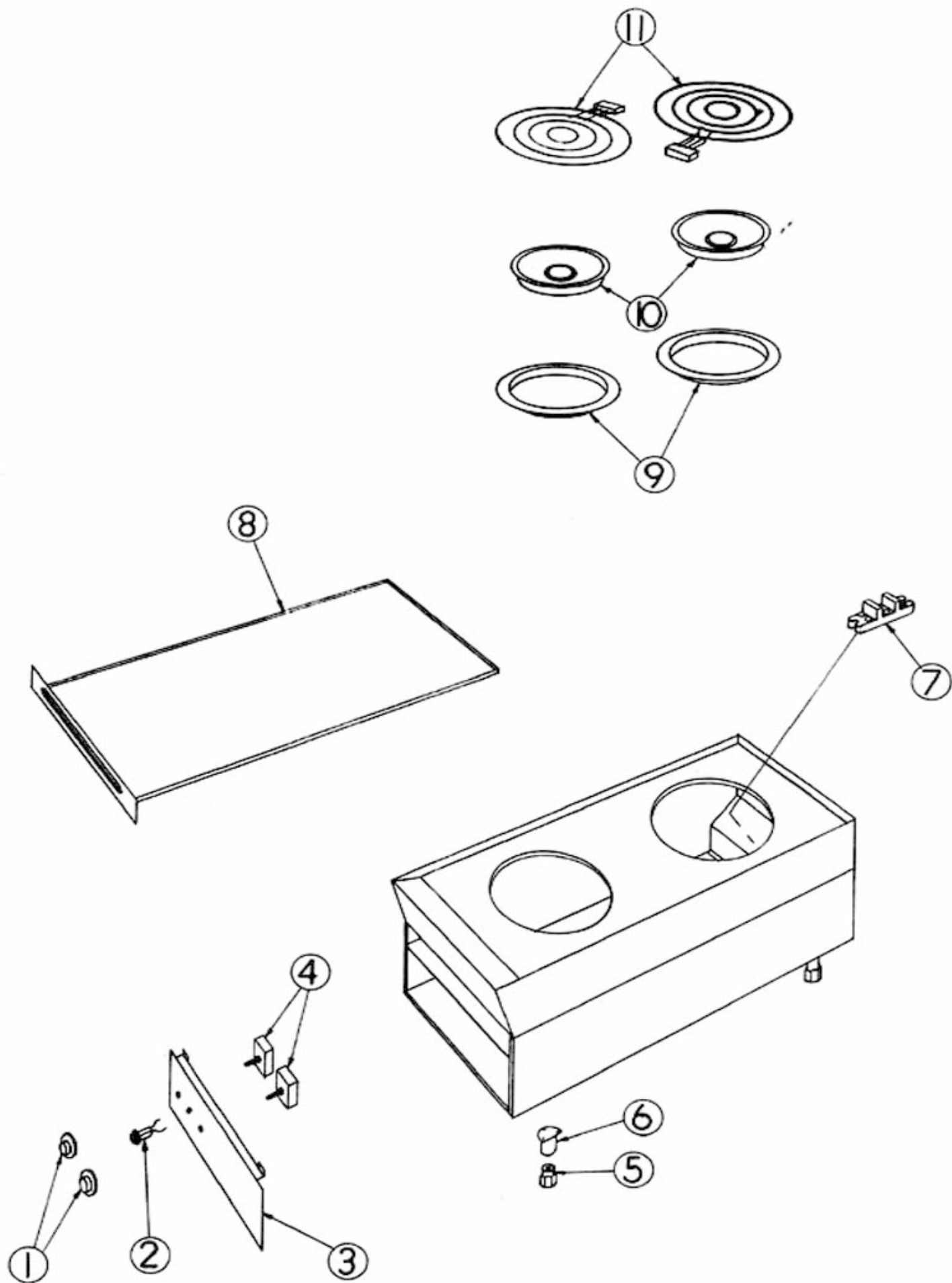

MODEL 162

8I

MODEL 162 & 162F Hotplate

| Key Number | Part Number          | Number Per Unit | Description  |             |
|------------|----------------------|-----------------|--|-------------|
| 1          | 2R-9781              | 2               | Knob - Control   |             |
| 2          | <del>I1-162016</del> | <del>1</del>    | <del>Pilot Light Assembly</del> <b>(Obsolete, No Longer Available)</b> |             |
| 3          | I1-9773              | 1               | Front Panel  |             |
| 4          | 2J-6403              | 2               | Infinite Control <b>(208/240)</b>                                      |             |
| 5          | 2A-7612              | 4               | Foot   |             |
|            | 2A-9347              | 4               | Foot - Extension   |             |
|            | 2C-9348              | 4               | Stud   |             |
| 6          | Z1-115006            | 4               | Leg Assembly <b>(less foot)</b>  |             |
| 7          | 2E-Y2849             | 1               | Terminal Block   |             |
| 8          | I1-162024            | 1               | Drip Tray  | <b>162</b>  |
| 9          | 2P-6468              | 2               | Adaptor Ring   | <b>162</b>  |
| 10         | 2D-6470              | 2               | Reflector Pan  | <b>162</b>  |
| 11         | 2N-Y3301             | 2               | Element <b>(208/240V) (not shown)</b>                                  | <b>162F</b> |
|            | 2N-6463              | 2               | Element <b>(208V - 2100W) (8" Dia. w/ceramic block)</b>                | <b>162</b>  |
|            | 2N-6464              | 2               | Element <b>(240V - 2100W) (8" Dia. w/ceramic block)</b>                | <b>162</b>  |
|            | I1-162117            |                 | Clamp Assembly   |             |

IMPORTANT: WHEN ORDERING, SPECIFY VOLTAGE OR TYPE GAS DESIRED  
INCLUDE MODEL AND SERIAL NUMBER

PAGE 1  
OF 1

Some items are included for illustrative purposes only and in certain instances may not be available.



Star Manufacturing International, Inc.