

STAR MANUFACTURING COMPANY
Division of Peabody International Corporation
9325 Olive Blvd., P.O. Box 8492
St. Louis, Missouri 63132

MODEL NO. 35-S STAR "STEAMRO, JR."
Combination Hot Dog Steamer and Bun Warmer

CAUTION: This equipment is designed and sold for commercial use only by personnel trained and experienced in its operation and is not sold for consumer use in and around the home nor for use directly by the general public in food service locations. For equipment to be used by the general public, please contact the factory.

CONNECTION LOAD: 1000 Watts — A.C. Current Only — Voltage as indicated on nameplate.

INSTALLATION:

Install the Steamro, Jr. in a level position. Connect the lead - in cord to a suitable convenience outlet of the correct voltage.

OPERATING PROCEDURE

1. Pour three to six quarts of water (no more) into the Hot Dog Compartment. (The use of hot water will reduce pre-heat time.)
2. Place Hot Dogs in small compartment and Buns in the wire rack in the large compartment. Arrange the Hot Dogs and Buns so that there is free circulation of steam.
3. Turn the switch to "ON" position, and set the Thermostat Control on "HIGH" until steam is generated.
4. For normal operation set the Thermostat Control in the center of the range between "HIGH" and "LO".
5. To control the amount of steam in the Bun Compartment, use the adjustable humidity control lever located in the Bun Compartment under the center cover.
6. Keep the lids closed when not serving.
7. ADD WATER AS IT BECOMES NECESSARY TO MAINTAIN THE WATER LEVEL. (Add hot water, if available.)

CAUTION: DO NOT ALLOW THE UNIT TO BOIL DRY. ADD WATER WHEN REQUIRED.

AT THE END OF EACH DAY'S OPERATION:

1. Disconnect the lead - in cord from the outlet.
2. Remove any remaining Hot Dogs and Buns.
3. Drain the water through the drain pipe.
4. Remove the perforated tray from the Hot Dog Compartment and the wire rack and steam baffle assembly from the Bun Compartment and THOROUGHLY CLEAN THE ENTIRE UNIT. (Stainless Steel, while corrosion resistant, should be cleaned daily to prevent pitting action.)

TO REPLACE HEATING ELEMENT:

1. Remove the covers and all removable parts inside the unit.
2. Loosen the set screw holding the temperature control knob and remove knob. Remove drain cap. Remove drain cover plate.
3. Remove the 2 screws and lockwashers holding the feet to the bottom of the unit on the control panel side.
4. Remove the 2 screws in front of the feet.
5. Pull the control panel toward you, swinging the bottom of the control panel until it has cleared the sides of the unit. Push up on the control panel and it will come free of the unit.
6. Remove the 2 screws, lockwashers, and nuts holding wires to the element.
7. Remove the 2 compression nuts inside the unit which hold the element in place. Use 2 offset open end wrenches and hold the fittings welded to the unit with a wrench to prevent twisting them and breaking the welds.
8. Push element away from control panel side until it clears the body of the unit and lift from the unit.
9. Reverse the above procedure to install new element.
10. Before replacing the temperature control knob, rotate the control stem full counter-clockwise. Push knob on control stem and locate the word "low" at top of control panel nameplate. Tighten set screw in knob.

POSSIBLE SOURCE OF TROUBLE AND SUGGESTED REMEDIES:

EVIDENCE OF CONDENSATION ON THE OUTSIDE OF THE STEAMRO, JR.

Cool air striking the warm surface of the Steamro, Jr. may cause moisture to collect. Protect the unit against cool drafts of air.

CASING OF HOT DOGS BURST

Too much steam is being generated. Move the thermostat control to a lower setting.

BUNS TOO SOGGY OR TOO DRY

Too much steam or too little steam will produce this condition. Control the amount of steam by adjusting the Thermostat Control as required. Also by adjusting the humidity control lever located in the Bun Compartment under the center cover.

Some buns are better adapted for steaming than others. Experiment with different kinds of buns until you find the one best suited for your trade.

PART NO 8252

10/81

MATERIAL			FINISH		MODEL NO.	PART NO.					
DR. R.T. CK. DATE 1-7-66			STAR MFG. INTERNATIONAL, INC.		35SS, 35S				SK1616		
LIMITS UNLESS OTHERWISE NOTED FRACTIONS ± 1/64 DECIMALS ± .005			9325 OLIVE BOULEVARD ST. LOUIS, MO 63132		TITLE WIRING DIAGRAM						
CHANGES					LTR	DATE	CHANGE			DR	

NOTES:
1. ALL INTERNAL WIRING - #16 GA.

CHANGES	LTR	DATE	CHANGE	DR
A		10-31-74	ADDED WIRE SIZE NOTE.	MM
B		4-28-78	REMOVED WORD "PROBE" BEFORE "THERMOSTAT"	RT
C		10-10-88	ADDED 35SS	TH
D		11-03-98	REDRAWN TO ACAD14, ADDED FUSES	MP

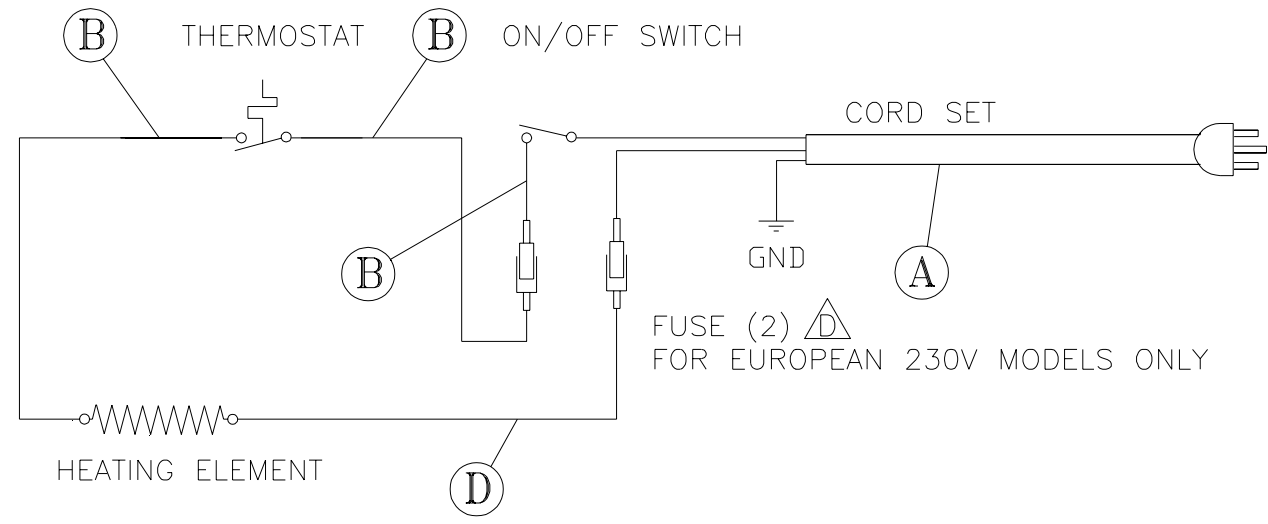
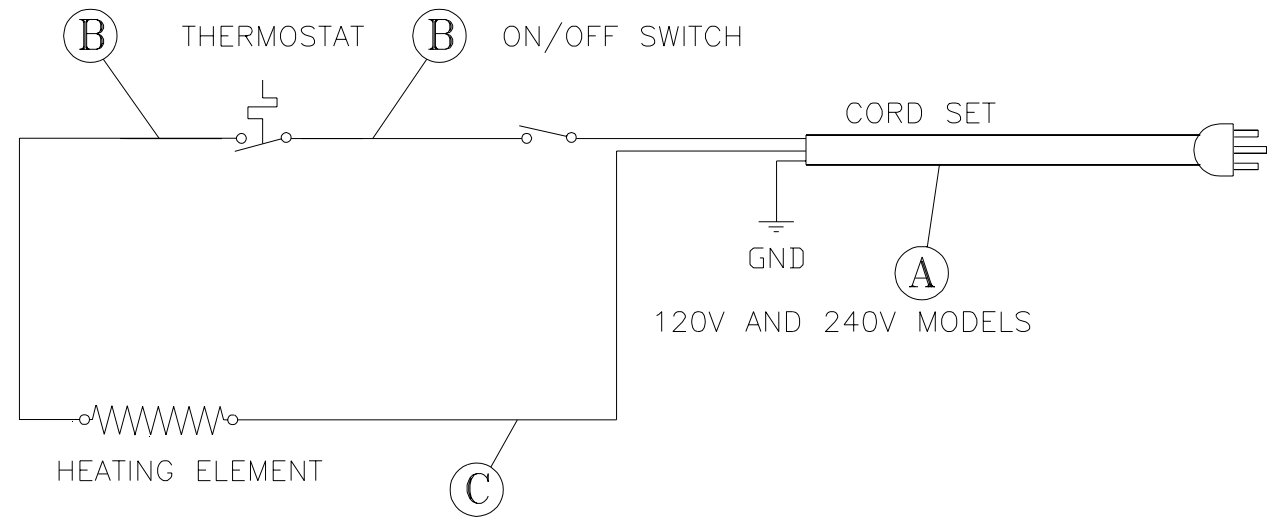

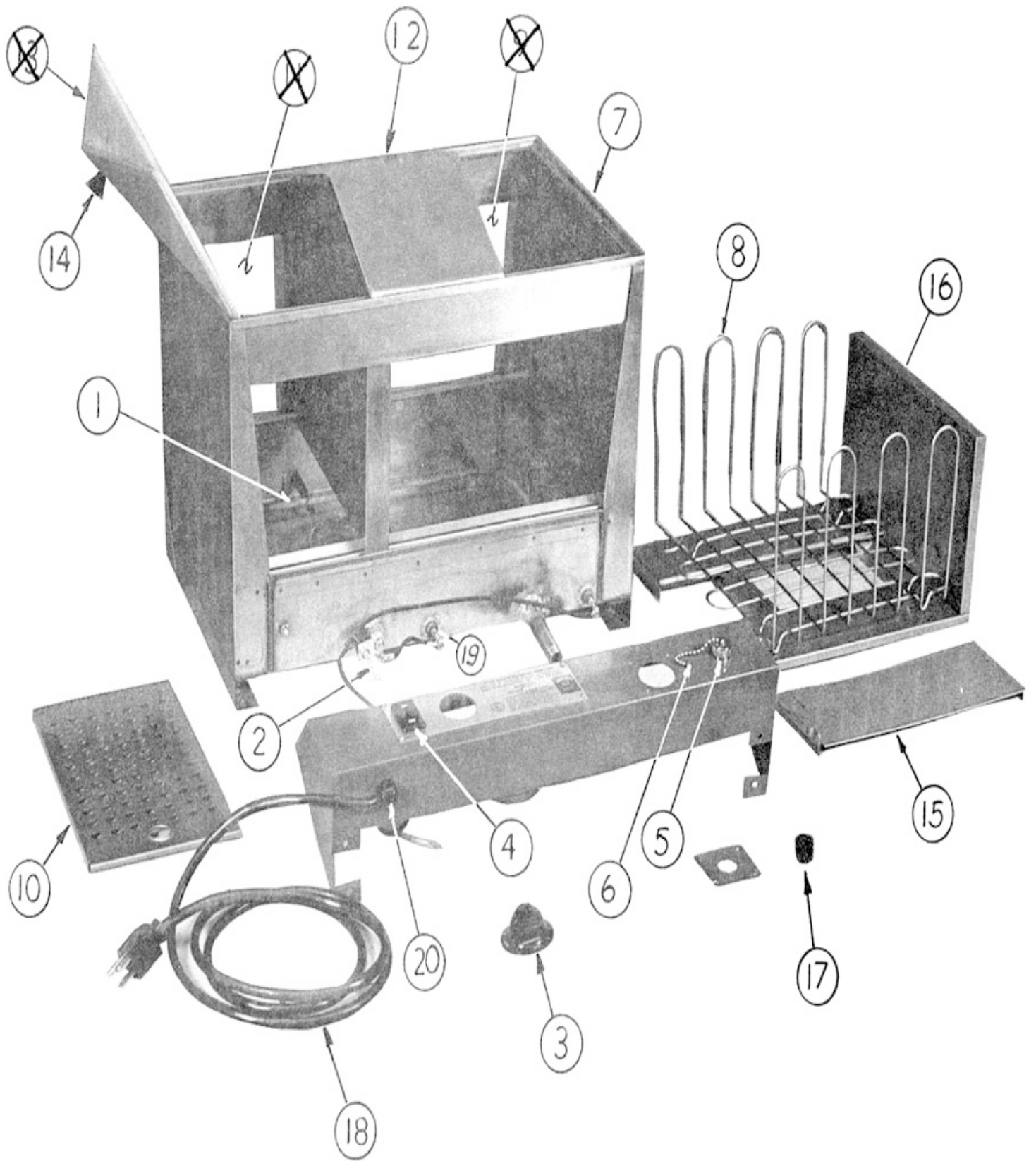

MODEL 35-S

PARTS LIST

MAY 1992

EFFECTIVE—

MODEL 35S (# 3546552 TO # 35179414)

8A

HOT DOG STEAMRO JR.

KEY NUMBER	PART NUMBER	NUMBER PER UNIT	DESCRIPTION
1	A2-178023	1	HEATING ELEMENT ASSEMBLY W/FITTINGS (120V)
	2N-Y2432	1	HEATING ELEMENT (240V)
	2C-Y3302	2	COMPRESSION FITTING
	2C-8004	2	COMPRESSION NUT
2	2T-Y1251	1	THERMOSTAT
	2K-Y1252	1	FITTING - THERMOSTAT (MUST BE WELDED TO BODY)
3	2R-7885	1	KNOB - THERMOSTAT
	2C-3701	1	SCREW - SET (8-32x3)
4	2E-Y3070	1	SWITCH (# 35108615 & UP)
	2E-8343	1	SWITCH (# 3551108 TO # 35108614)
	2E-Y3839	1	SWITCH (# 3546552 TO # 3551107)
5	A3-35219	1	CAP AND CHAIN - DRAIN VALVE (# 3557229 & UP)
	2I-9772	1	GASKET, DRAIN CAP
6	2C-1628	1	SCREW (#4x1/4)
7	A3-35204	1	BODY ASSEMBLY
	A3-4123	2	RAIL - FRONT & BACK
8	A3-35007	1	BUN RACK ASSEMBLY
9	2Q-4156	2	GLASS, BUN COMPARTMENT (PURCHASED LOCALLY) 1/8" X 8-1/2" X 11-1/2"
10	A3-Y2634	1	WIENER TRAY (# 3587324 & UP)
11	2Q-4155	2	GLASS WIENER COMPARTMENT (PURCHASED LOCALLY) 1/8" X 6" X 8-1/4"
12	A3-4139	1	COVER, CENTER
13	A3-4140	2	COVER, END 3 PURCHASE A3-35319 & A3-Y6558 FOR BEST RESULTS
14	2R-H5229	2	KNOB, COVER
15	A3-35006	1	MOVEABLE TRAY ASSEMBLY
16	A3-35002	1	BAFFLE ASSEMBLY
17	2A-Y3405	4	FOOT
18	A3-35223	1	LEAD IN CORD ASSEMBLY (120V)
	A3-09019	1	LEAD IN CORD ASSEMBLY (240V)
20	2K-7889	1	HEYCO BUSHING (STRAIN RELIEF)
21	A3-8253	1	PLATE COVER
	A3-35225	1	HOT DOG JUICE TRAY (HDJT)
	A3-35218	1	RACK ASSEMBLY
	PS-35217	1	PAN ASSEMBLY
	A3-4149	4	CLIP - GLASS
	2C-1487	2	SCREW (6-32x1/4)
	2C-2553	2	NUT (6-32)

*SUGGESTED PARTS STOCKING—

IMPORTANT: WHEN ORDERING SPECIFY VOLTAGE OR TYPE GAS DESIRED
INCLUDE MODEL AND SERIAL NUMBER—(1) MINIMUM PARTS ORDER—\$5.00

PAGE 1
OF 1



Star Manufacturing International, Inc.

9325 Olive Boulevard, P.O. Box 8492, St. Louis, MO 63132
Phone (314) 994-0880 • FAX (314) 994-0406