

# USER GUIDE

SAFETY • INSTALLATION & INTEGRATION • OPERATING INSTRUCTIONS • MAINTENANCE • **SERVICE**

## Parts

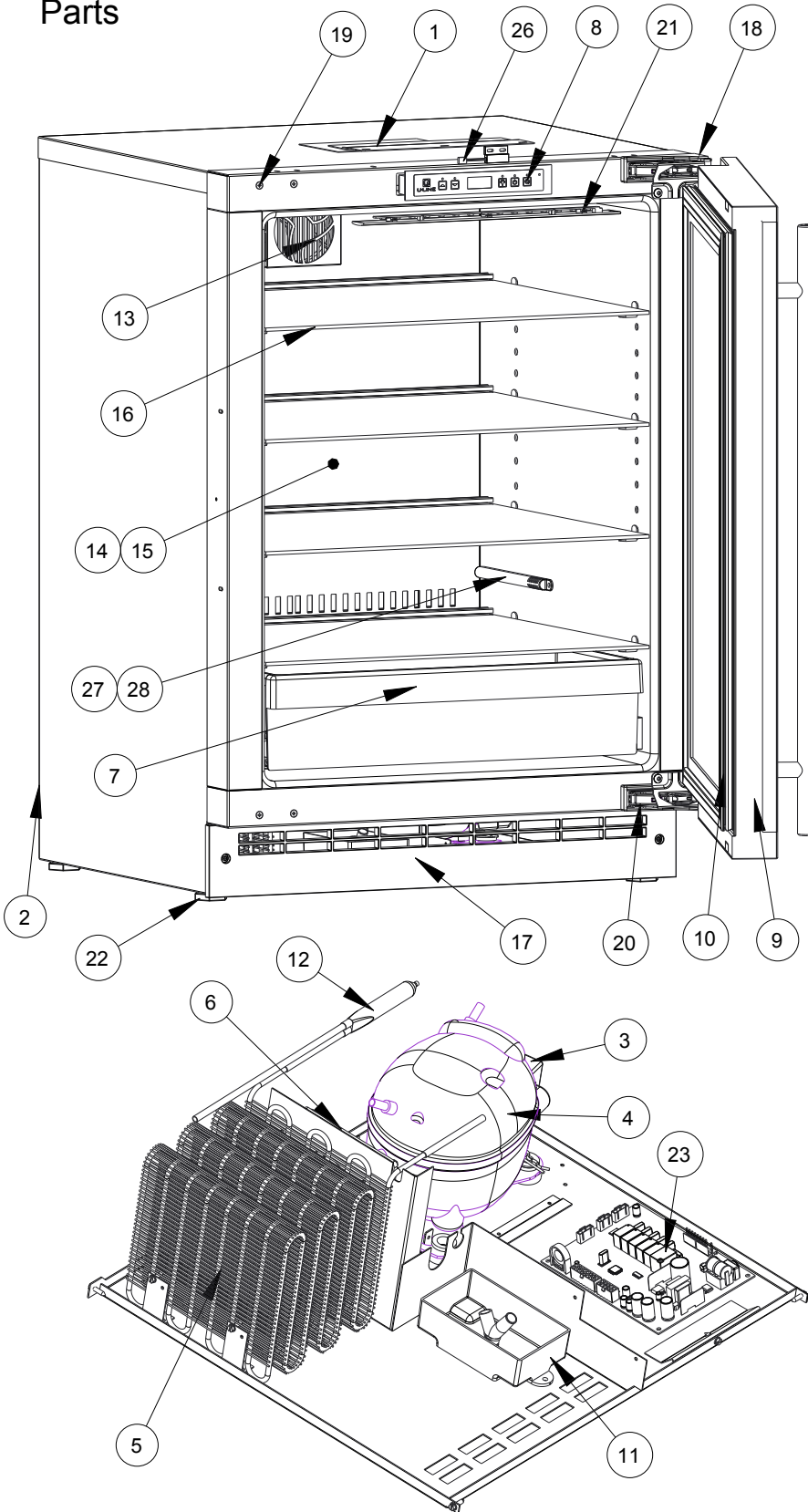

U-2224RS-00B		
Item	Description	U-Line P/N
1	Anti tip bracket w/screws	<a href="#">80-54012-00</a>
2	Back panel	<a href="#">80-54086-00</a>
3	Compressor electricals only	<a href="#">80-54149-00</a>
4	Compressor w/electricals	<a href="#">80-54150-00</a>
5	Condenser	<a href="#">80-54043-00</a>
6	Condenser fan w/screws	<a href="#">80-54014-00</a>
7	Crisper	<a href="#">80-54044-00</a>
8	Display module	<a href="#">80-54007-00</a>
9	Door assembly w/o hinges	<a href="#">80-54194-00</a>
10	Door gasket	<a href="#">80-54039-00</a>
11	Drain pan w/double sided tape	<a href="#">80-54002-00</a>
12	Drier	<a href="#">80-54055-00</a>
13	Evap fan w/cover and screws	<a href="#">80-54151-00</a>
14	Evaporator	<a href="#">80-54057-00</a>
15	Evaporator cover	<a href="#">80-54045-00</a>
16	Glass shelf (1) w/clips	<a href="#">80-54041-00</a>
17	Grille w/screws	<a href="#">80-54040-00</a>
18	Hinge covers(2 pcs)	<a href="#">80-54001-00</a>
19	Hinge mounting hole covers	<a href="#">80-54024-00</a>
20	Hinges(2) w/screws and covers	<a href="#">80-54013-00</a>
21	LED light strip and cover assy	<a href="#">80-54000-00</a>
22	Leg Levelers (4)	<a href="#">80-54019-00</a>
23	Main board (no wires or case)	<a href="#">80-54008-00</a>
24	Packaging	<a href="#">80-54159-00</a>
25	Power cord	<a href="#">80-54171-00</a>
26	Reed switch	<a href="#">80-54134-00</a>
27	Thermistor (1 piece)	<a href="#">80-54006-00</a>
28	Thermistor cover and pin	<a href="#">80-54023-00</a>