

Unit Information	
<b>WCT805</b>	Amps 11.25 • Watts 2700
<b>WCT815</b>	Amps 8.44 • Watts 2025
<b>WCT825</b>	Amps 6.25 • Watts 1500
All the above toaster have a 380 output slices/hr.	

**WARING**  
**COMMERCIAL**

**240 Volt Toasters**

**WCT805**

**Four 1 1/8" Toast Slots**

**WCT815**

**Two 1 1/8" Toast Slots  
Two 1 1/2" Extra Wide Slots**

**WCT825**

**Four 1 1/2" Bagel Slots**

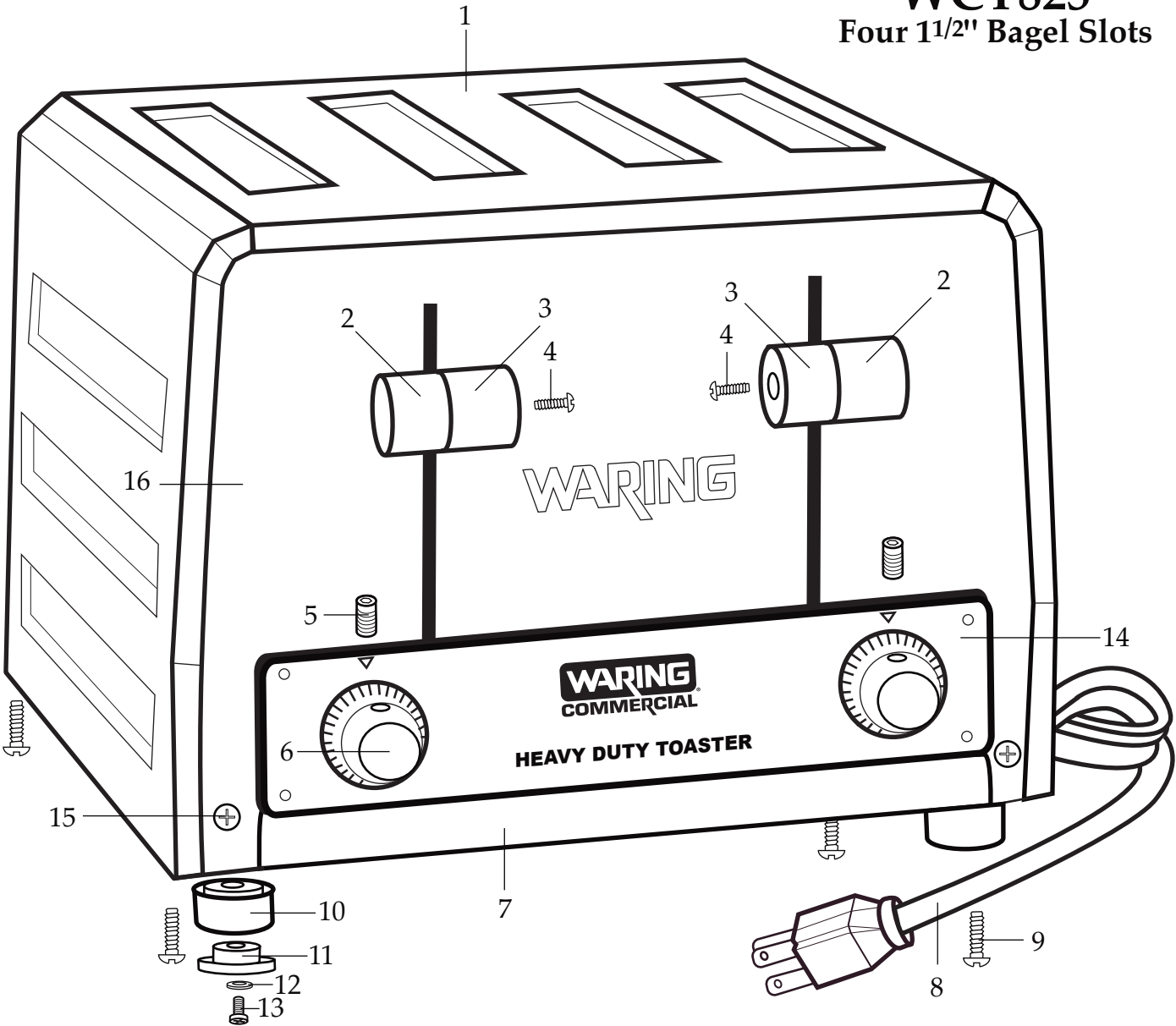

WCT805  
WCT815  
WCT825

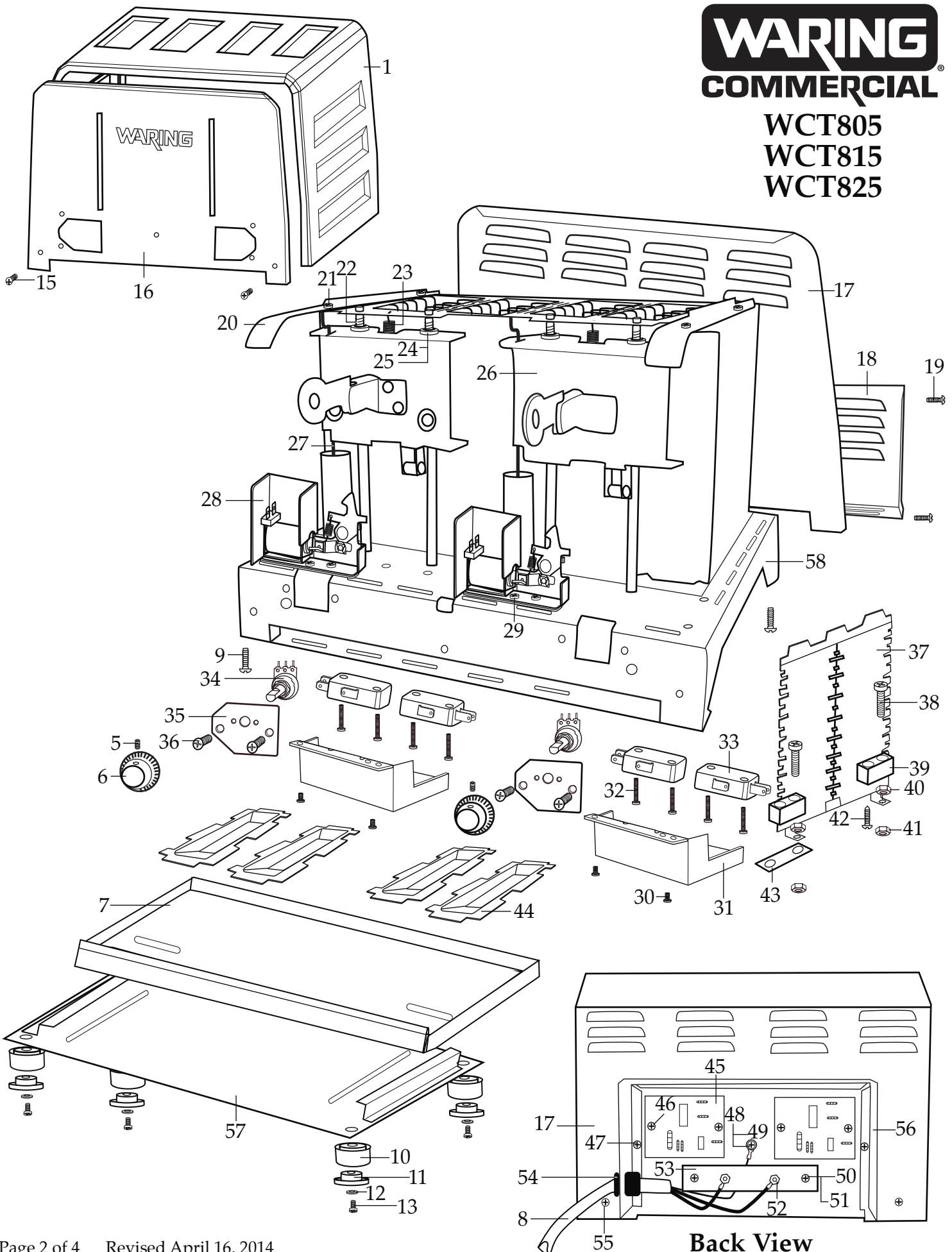

**Catalog#/Model**

WCT805

WCT815

WCT825



<b>Illustration #</b>	<b>Part #</b>	<b>Description</b>
1	027219 027169 029825	WCT805 Top Cover Plate WCT815 Top Cover Plate WCT825 Top Cover Plate
2	027170	Push Knob (2 Required)
3	027171	Push Knob (2 Required)
4	027172	Screw (2 Required)
5	027173	Set Screw (2 Required)
6	027174	Browning Control Knob
7	027175	Crumb Tray
8	027220	Cord Set
9	027177	Screw (4 Required)
10	027178	Foot (4 Required)
11	027179	Rubber Foot (4 Required)
12	027180	Washer (4 Required)
13	027181	Screw (4 Required)
14	502939	Front Panel Assembly
15	027177	Screw (2 Required)
16	027182	Front Cover Plate
17	027183	Back Cover Plate
18	027184	Power Box Cover
19	027177	Screw (4 Required)
20	027185	Housing Support (2 Required)
21	027186	Screw (4 Required)
22	027187	Compression Wire Spring (4 Required)
23	027188	Moving Bracket Spring (2 Required)
24	027189	Bracket Bushing (8 Required)
25	027190	C Ring (4 Required)
26	502940 502940 502941 502941	WCT805 Moving Bracket Assembly (2 Required) WCT815 Moving Bracket Assembly (1 Required) WCT815 Moving Bracket Assembly (1 Required) WCT825 Moving Bracket Assembly (2 Required)
27	027191	Damper Cylinder Rod (2 Required)
28	027192	Locking Mechanism
29	027193	Screw (4 Required)
30	034768	Screw (4 required)
31	034767	Switch Cover (2 required)
32	034769	Screw (8 required)
33	033456	Micro Switch (4 required)

## Catalog#/Model

WCT805

WCT815

WCT825



Illustration #	Part #	Description
34	027198	Rheostat (2 Required)
35	027199	Insulated Bracket Plate (2 Required)
36	027200	Screw (4 Required)
37	027221	WCT805 Elements 17-7269 (8 Required)
	027221	WCT815 Elements 17-7269 (6 Required)
	033548	WCT825 Elements 17-4009 (4 Required)
38	027202	Screw (16 Required)
39	027203	Ceramic Insulator Bracket (16 Required)
40	027204	Hex Nut (16 Required)
41	027205	Hex Nut (16 Required)
42	027206	Screw (16 Required)
43	027207	Jumper Bracket
44	027947	Standard Slot Baffle
	027946	Wide Slot Baffle
45	027289	WCT805 PC Board (2 Required)
	027293	WCT815 PC Board toast side
	027292	WCT815 PC Board bagel side
	027292	WCT825 PC Board (2 Required)
46	027209	Screw (4 Required)
47	027210	Screw (2 Required)
48	027211	Lock Washer (ground)
49	027212	Screw-green (ground)
50	027213	Screw (2 Required)
51	027214	Power PCB Holder (2 Required)
52	027215	Hex Nut (4 Required)
53	027216	Power Terminal Board
54	027224	Strain Relief
55	027177	Screw (2 Required)
56	027218	Power Box Body
57	027225	Bottom Cover
58	502942	Toaster Chassis Assembly for WCT805
	502943	Toaster Chassis Assembly for WCT815
	032426	Toaster Chassis Assembly for WCT825

## Items Not Shown

027214 - Main PCB Holder (4 Required)

027222 - Screw for front panel assembly (5 Required)

## Items No Longer Used

027196 - Washer (4 required)

027197 - Hex Nut (4 required)

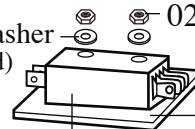

027223 - Insulator (2 required)

027194 - Switch (2 required)

027195 - Screw (4 required)